

RECESSED CONTINUOUS SLOTS

3G-CSLED CONTINUOUS SLOTS GRID

3G
LIGHTING



Trim



Trimless



Surface Madison



Pendant Informa

FEATURES

CONSTRUCTION

- Housing constructed in cold rolled steel and extruded aluminum. Powder coated black or white
- Designed for continuous runs in linear, right angle, square, and rectangular configurations
- Solid aluminum double gimbals. Adjustable and lockable
- Individual heads can slide 12" left or right within the channel. Easily adjusted in the field
- Anodized aluminum reflectors and extruded aluminum heatsinks

ELECTRICAL

- Standard 120-277V, 0-10V dimmable drivers with 100-1% dimming range
- 85% efficiency and 0.9 power factor
- Lutron and eldoLED driver options available with 100-1% dimming range
- Individual sections can be wired independently

LED SYSTEM

- Available in 27K, 30K, 35K, and 40K
- Average rated life of > 50,000 hours
- Color consistency < 2 SDCM
- Standard (80+CRI). Optional (90+ and 97+CRI)
- LED modules carry a 5-year warranty
- Modules are field replaceable

LUMEN MAINTENANCE

- L70 at 60,000 hours

MOUNTING

- New construction housings suspended via 1/4" threaded rod or suspension cables
- Suitable for 6" techzone and various grid ceilings (see mounting details)

LABELS

- ETL listed. Suitable for dry or damp locations

WARRANTY

- 5 Year limited warranty

RECESSED - CONTINUOUS SLOTS | 3G - CSLED | GRID



PROJECT	TYPE	DATE
CATALOG #		

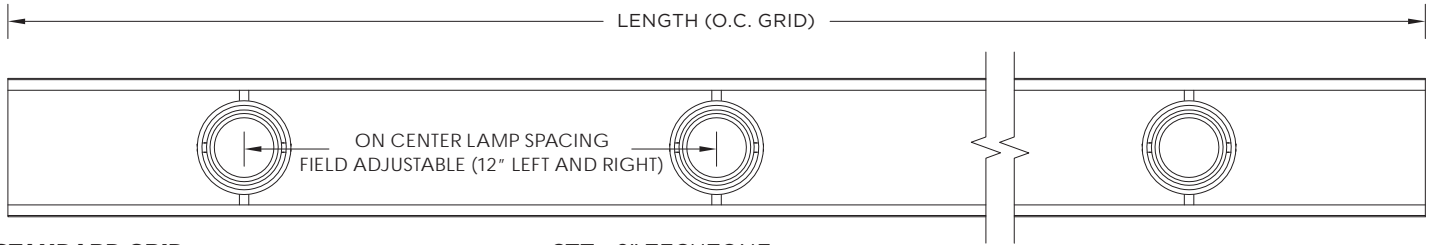

STANDARD GRID

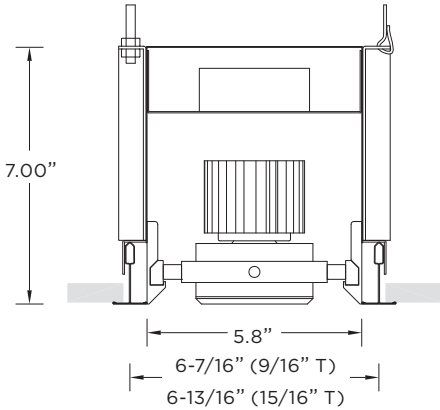

6TZ - 6" TECHZONE

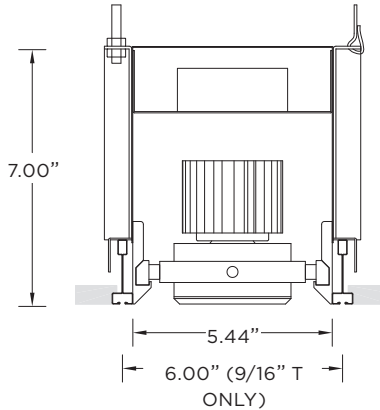

ORDERING INFORMATION

CAT. NO	LUMEN OUTPUT (PER FIXTURE HEAD)	CRI	COLOR TEMP	BEAM ANGLE	VOLTAGE	DRIVER
3G-CSLED	10 - 1000 LUMENS	S80 - 80+CRI (STANDARD)	27K - 2700K	20D - 20°	120 - 120V	DIM - 0-10V (STANDARD 100%-1)
	15 - 1500 LUMENS		30K - 3000K	40D - 40°		277 - 277V
	22 - 2200 LUMENS	H90 - 90+ CRI ¹	35K - 3500K	60D - 60°	347 - 347V (0-10V ONLY)	DALI - DALI (100-1%)
	30 - 3000 LUMENS		H97 - 97+ CRI ²			40K - 4000K
	40 - 4000 LUMENS	LE - FORWARD PHASE (100-1%)				
	50 - 5000 LUMENS					

3G-CSLED					
GRID TYPE	GIMBAL FINISH	HOUSING	OPTIONS	LENGTH (FEET)	LAMP SPACING
GC1 - 9/16 LAYIN	NG - NATURAL ALUMINUM	BK - BLACK	2C - 2 CIRCUIT	S - ___' (STRAIGHT RUN)	12 - 12"
GC1S - 9/16 TEGULAR					
GC2 - 15/16 LAYIN	WG - WHITE	SF70 - SOFTENING LENS	U - ___' X ___' X ___' (U-SHAPE)	24 - 24"	
GC2S - 15/16 TEGULAR					LS70 - LINEAR SPREAD
GC3 - 9/16 SLOT TEE TEGULAR	6TZ - 6 TECHZONE	Maximum 3 optical accessories. See optical accessories page for more options		Available in 6" increments. See reference page	

ORDERING EXAMPLE: **3G-CSLED-15-S80-30K-40D-120-DIM-GC1-NG-BK-S-8'-12**

¹ 90+ CRI available up to 4000lm.
² 97+ CRI available up to 3000lm.
³ 100-10% forward phase driver available up to 1500lm

Copyright 2016 3G Lighting.
 P: 905-850-2305 F: 905-851-6490 | TF: 888-448-0440
 3G reserves the right to change, without notice, specifications or materials for product improvement.



RECESSED CONTINUOUS SLOTS

3G-CSLED CONTINUOUS SLOTS GRID



PERFORMANCE CHARTS

80+ CRI (Based on 40° Beam Angle)

LUMEN OUTPUT	SYSTEM WATTS	DELIVERED LUMENS	EFFICACY LM/W
1000 LUMENS	9.8W	982	100.4
1500 LUMENS	13.7W	1375	100.4
2200 LUMENS	20.7W	2079	100.4
3000 LUMENS	32.1W	2738	85.3
4000 LUMENS	37.8W	3853	101.9
5000 LUMENS	54.3W	4630	85.3
DOWNLOAD			

90+ CRI (Based on 40° Beam Angle)

LUMEN OUTPUT	SYSTEM WATTS	DELIVERED LUMENS	EFFICACY LM/W
1000 LUMENS	9.8 W	835	85.4
1500 LUMENS	13.7W	1169	85.4
2200 LUMENS	20.1W	1719	85.4
3000 LUMENS	32.1W	2406	75.0
4000 LUMENS	44.7 W	3409	76.3
5000LUMENS	N/A	N/A	N/A
DOWNLOAD			

97+ CRI (Based on 40° Beam Angle)

LUMEN OUTPUT	SYSTEM WATTS	DELIVERED LUMENS	EFFICACY LM/W
1000 LUMENS	9.8W	733	75.0
1500 LUMENS	15.6W	1173	75.0
2200 LUMENS	24.2W	1811	75.0
3000 LUMENS	37.2W	2792	75.0
4000LUMENS	N/A	N/A	N/A
5000LUMENS	N/A	N/A	N/A
DOWNLOAD			

GIMBAL ADJUSTABILITY

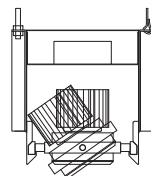
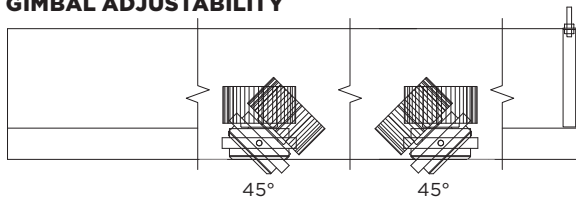

STANDARD GRID -35°
6" TECHZONE - 30°

ADDITIONAL IES FILES FOR THIS PRODUCT FOUND [HERE](#)

MOUNTING

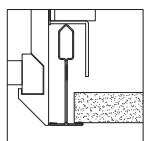

GC1 - 9/16" LAYIN

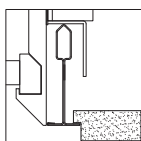

GC1S - 9/16" TEGULAR

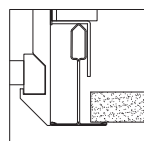

GC2 - 15/16" LAYIN

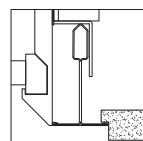

GC2S - 15/16" TEGULAR

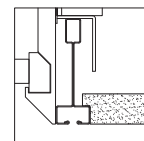

GC3 - 9/16" SLOT TEE TEGULAR

6TZ - 6" TECHZONE

RUN CHART (Begin measurements at start of run, in a clockwise direction)

STRAIGHT (S-___')

ORDERING EXAMPLE:

3G-CSLED-15-S80-30K-40D-120-DIM-GC1-NG-BK-S-8'-12

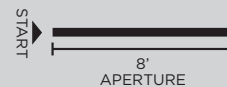

L SHAPE (L-___' x ___')

ORDERING EXAMPLE:

A - 3G-CSLED-15-S80-30K-40D-120-DIM-GC1-NG-BK-L-8'X6'-12

B - 3G-CSLED-15-S80-30K-40D-120-DIM-GC1-NG-BK-L-6'X8'-12

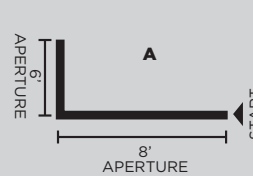

OR

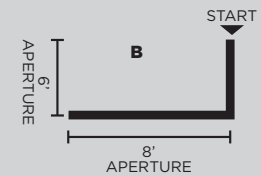

ORDERING EXAMPLE:

U SHAPE (U-___' x ___' x ___')

A - 3G-CSLED-15-S80-30K-40D-120-DIM-GC1-NG-BK-U-4'X8'X6'-12

B - 3G-CSLED-15-S80-30K-40D-120-DIM-GC1-NG-BK-U-6'X8'X4'-12

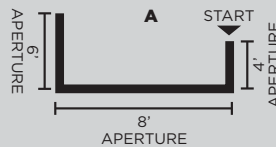

OR

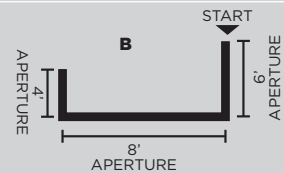

RECTANGLE (R-___' x ___')

ORDERING EXAMPLE:

A - 3G-CSLED-15-S80-30K-40D-120-DIM-GC1-NG-BK-R-8'X6'-12

