

# RECESSED ADJUSTABLE DOWNLIGHT

## 3G-DL4500 TRIM & TRIMLESS

**3G**  
LIGHTING



**Recessed Madison**



**Continuous Slots**



**Surface Madison**



**Pendant Informa**

### FEATURES

#### CONSTRUCTION

- Adjustable hot-aiming from below up to 40° tilt and 360° rotation
- Machined aluminum trim flange and aluminum insert powder coated white
- 4.5" aperture with regressed soft reflector for enhanced glare control
- Anodized aluminum reflectors and extruded aluminum heatsinks
- Maximum ceiling thickness of 1". Consult factory for modifications

#### ELECTRICAL

- Standard 120-277V, 0-10V dimmable drivers with 100-1% dimming range
- 85% efficiency and 0.9 power factor
- Lutron and eldoLED driver options available with 100-1% dimming range
- Fixture is pre-wired, thermally protected, and rated for through branch wiring
- Electrical enclosures easily accessible through fixture aperture
- Emergency Battery: 90 minutes

#### LED SYSTEM

- Available in 27K, 30K, 35K, and 40K
- Average rated life of > 50,000 hours
- Color consistency < 2 SDCM
- Standard (80+CRI). Optional (90+ and 97+CRI)
- LED modules carry a 5-year warranty
- Modules are field replaceable

#### LUMEN MAINTENANCE

- L70 at 60,000 hours

#### MOUNTING

- Remodel, new construction, and IC housing options suitable for drywall, wood, acoustic and metal pan ceilings
- Bar hangers extend from 14" to 26" and can be cut in-field for narrow stud spacing

#### LABELS

- ETL listed. Suitable for dry or damp locations

#### WARRANTY

- 5 Year limited warranty

**RECESSED - DOWNLIGHT | 3G - DL4500 | TRIM & TRIMLESS**



<b>PROJECT</b>	<b>TYPE</b>	<b>DATE</b>
<b>CATALOG #</b>		

**TRIM**

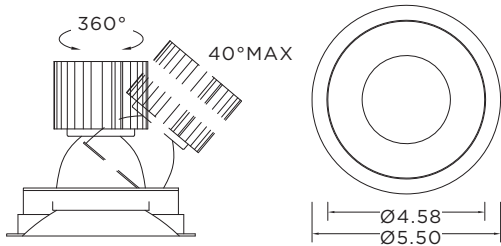

**XTR - TRIMLESS**

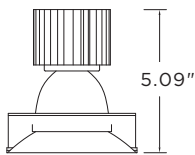
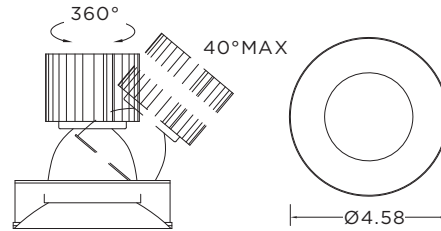

**ORDERING INFORMATION**

CAT. NO	LUMEN OUTPUT PER FIXTURE HEAD	CRI	COLOR TEMP	BEAM ANGLE	VOLTAGE
<b>3G-DL4500</b>	<b>10</b> - 1000 LUMENS	<b>S80</b> - 80+CRI (STANDARD) <b>H90</b> - 90+CRI <b>H97</b> - 97+CRI <sup>1</sup>	<b>27K</b> - 2700K <b>30K</b> - 3000K <b>35K</b> - 3500K <b>40K</b> - 4000K	<b>20D</b> - 20° <b>40D</b> - 40° <b>60D</b> - 60°	<b>120</b> - 120V <b>277</b> - 277V <b>347</b> - 347V (0-10V ONLY)
	<b>15</b> - 1500 LUMENS				
	<b>22</b> - 2200 LUMENS				
	<b>30</b> - 3000 LUMENS				
	<b>40</b> - 4000 LUMENS				

<b>3G-DL4500</b>					
------------------	--	--	--	--	--

DRIVER	FLANGE TYPE	INSERT FINISH	HOUSING TYPE	OPTIONS
<b>DIM</b> - 0-10V (STANDARD 100%-1)	<b>XTR</b> - TRIMLESS <b>WT</b> - WHITE TRIM	<b>WI</b> - WHITE <b>SI</b> - SILVER	<b>RMD</b> - REMODEL (NON IC) <b>NC</b> - NEW CONSTRUCTION (NON IC) <b>IC</b> - IC HOUSING <sup>3</sup> <b>CP</b> - CHICAGO PLENUM <b>SH</b> - SHALLOW HOUSING <sup>4</sup> <b>ICSH</b> - IC SHALLOW HOUSING <sup>5</sup>	<b>FXD</b> - FIXED (NON-ADJUSTABLE) <b>SB70</b> - SANDBLASTED LENS <b>SF70</b> - SOFTENING LENS <b>LS70</b> - LINEAR SPREAD <b>HXB70</b> - BLACK HEXELL LOUVER <b>EM</b> - EMERGENCY BATTERY <sup>6</sup>
<b>DHL2</b> - LUTRON (ECO SYSTEM 100-1%)				
<b>DALI</b> - DALI (100-1%)				
<b>LE10</b> - FORWARD PHASE (100-10%) <sup>2</sup>				
<b>LE</b> - FORWARD PHASE (100-1%)				

Maximum 2 optical accessories.

--	--	--	--	--

ORDERING EXAMPLE: **3G-DL4500-15-S80-30K-40D-120-DIM-WT-WI-NC**

<sup>1</sup> 97+ CRI available up to 3000lm.  
<sup>2</sup> 100-10% forward phase driver available up to 2200lm  
<sup>3</sup> IC Housing available up to 2200lm  
<sup>4</sup> Shallow Housing available up to 1500lm, fixed (non-adjustable)  
<sup>5</sup> IC Shallow Housing available up to 1500lm (fixed non-adjustable) with 80+CRI. Maximum 1000lm with 90+CRI and 97+CRI  
<sup>6</sup> Emergency battery installed remotely by others. Not accessible through the inside of the fixture

# RECESSED ADJUSTABLE DOWNLIGHT

**3G-DL4500**  
**TRIM & TRIMLESS**



## PERFORMANCE CHARTS

**80+ CRI** (Based on 40° Beam Angle)

LUMEN OUTPUT	SYSTEM WATTS	DELIVERED LUMENS	EFFICACY LM/W
1000 LUMENS	9.8W	910	93
1500 LUMENS	15.6W	1457	93
2200 LUMENS	24.2W	2249	93
3000 LUMENS	31.2W	2905	93
4000 LUMENS	41.4W	3856	93
<b>DOWNLOAD</b>			

**90+ CRI** (Based on 40° Beam Angle)

LUMEN OUTPUT	SYSTEM WATTS	DELIVERED LUMENS	EFFICACY LM/W
1000 LUMENS	13.7W	1091	80
1500 LUMENS	19.6W	1559	80
2200 LUMENS	26.4W	2105	80
3000 LUMENS	31.2W	2487	80
4000 LUMENS	41.4W	3301	80
<b>DOWNLOAD</b>			

**97+ CRI** (Based on 40° Beam Angle)

LUMEN OUTPUT	SYSTEM WATTS	DELIVERED LUMENS	EFFICACY LM/W
1000 LUMENS	13.7W	958	70
1500 LUMENS	19.6W	1369	70
2200 LUMENS	30.3W	2121	70
3000 LUMENS	41.4W	2898	70
4000 LUMENS	N/A	N/A	N/A
<b>DOWNLOAD</b>			

ADDITIONAL IES FILES FOR THIS PRODUCT FOUND [HERE](#)

### RMD - REMODEL

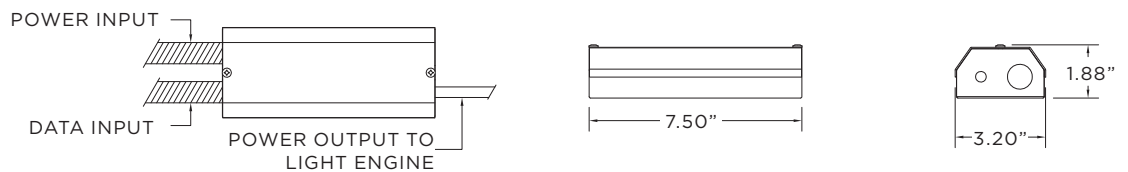

### NC - NEW CONSTRUCTION (NON-IC)

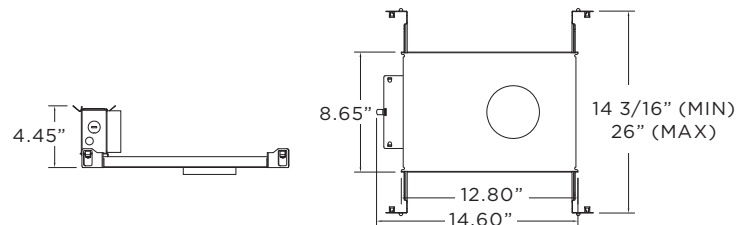

### IC - IC HOUSING

### CP - CHICAGO PLENUM HOUSING

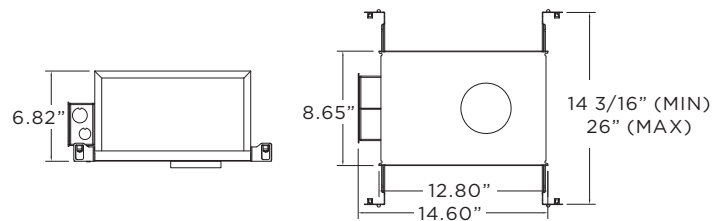

### SH - SHALLOW HOUSING

### ICSH - IC SHALLOW HOUSING

