

# RECESSED RUBO

**3G-RRU2401**  
**24" ROUND**

**3G**  
LIGHTING



**24" Recessed Kubo**



**24" Pendant Kubo**



**24" Surface Kubo**



**Surface Kubo**

## FEATURES

### CONSTRUCTION

- White sandblasted acrylic diffuser. Fabricated with mitered corners
- 20 gauge cold rolled steel housing powder coated matte white
- 24 gauge LED reflector powder coated matte white

### ELECTRICAL

- Standard 120-277V, 0-10V dimmable driver with 100-1% dimming range.
- 85% efficiency and 0.9 power factor
- Lutron driver options available with 100-1% dimming range
- eldoLED Dali driver available with 100-1% dimming range
- Emergency Battery: 90 minute

### LED SYSTEM

- Available in 27K, 30K, 35K, and 40K
- Average rated life > 50,000 hours
- Color consistency < 3 SDCM
- CRI > 80 for 27K, 30K, 35K, and 40K

### LUMEN MAINTENANCE

- L70 at 50,000 hours

### MOUNTING

- Suitable for various grid ceiling applications (see mounting details)
- Suitable for drywall and wood ceilings (see mounting details)

### FINISH

- Polyester powder coated matte white with 95% reflectance.

### LABELS

- ETL listed. Suitable for dry or damp locations.

### WARRANTY

- 5 Year limited warranty.

PROJECT

TYPE

DATE

CATALOG #

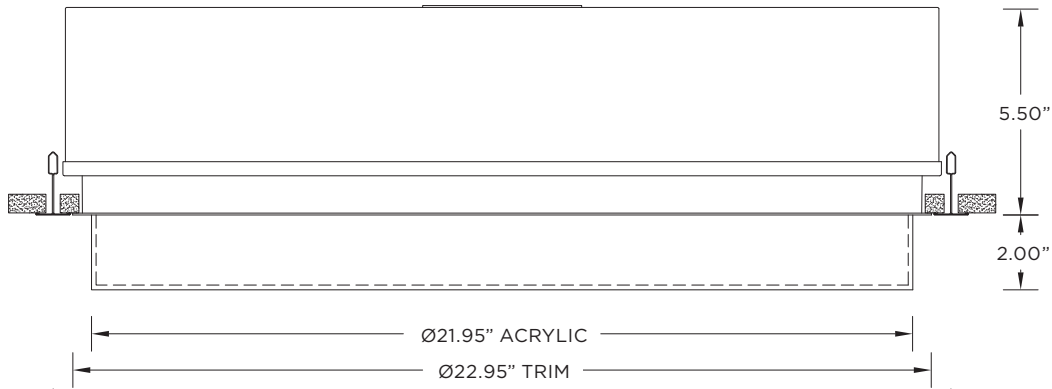

**LENS OPTIONS**

**FL - FLUSH**

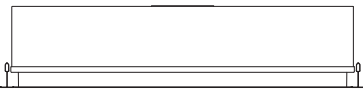

**DD1 - 1" DROP**

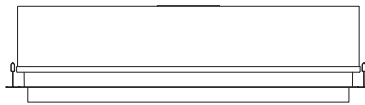

**DD2 - 2" DROP**

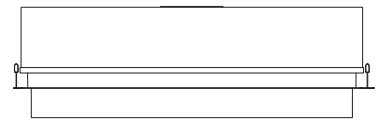

**DD3 - 3" DROP**

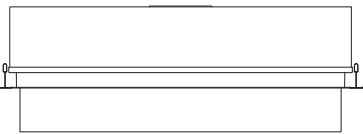

**DD4 - 4" DROP**

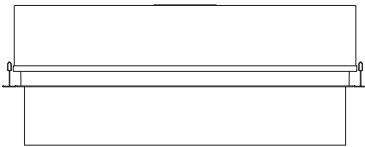

**DD5 - 5" DROP**

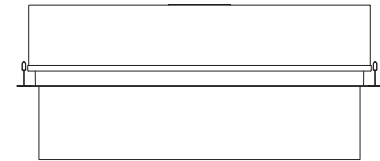

**ORDERING INFORMATION**

CAT. NO	LED SYSTEM	COLOR TEMP	VOLTAGE	DRIVER	FLANGE TYPE	LENS OPTIONS	OPTIONS
<b>3G-RRU2401</b>	<b>L2</b> - STANDARD OUTPUT	<b>27K</b> - 2700K	<b>120</b> - 120V	<b>DIM</b> - 0-10V (STANDARD 100-1%)	<b>GC1</b> - 9/16 LAYIN	<b>FL</b> - FLUSH	<b>CP</b> - CHICAGO PLENUM
	<b>L4</b> - HIGH OUTPUT	<b>30K</b> - 3000K <b>35K</b> - 3500K <b>40K</b> - 4000K	<b>277</b> - 277V <b>347</b> - 347V (0-10V ONLY)	<b>DHL</b> - LUTRON (3-WIRE - 100-1%) <b>DHL2</b> - LUTRON (ECOSYSTEM - 100-1%) <b>DALI</b> - DALI (100-1%)	<b>GC1S</b> - 9/16 TEGULAR <b>GC2</b> - 15/16 LAYIN <b>GC2S</b> - 15/16 TEGULAR <b>GC3</b> - 9/16 SLOT TEE TEGULAR <b>WT</b> - WHITE TRIM (DRYWALL)	<b>DD1</b> - 1" DROP <b>DD2</b> - 2" DROP <b>DD3</b> - 3" DROP <b>DD4</b> - 4" DROP <b>DD5</b> - 5" DROP	<b>EM</b> - EMERGENCY BATTERY
Consult 3G for custom outputs							

**3G-RRU2401**

ORDERING EXAMPLE

**3G-RRU2401-L2-30K-120-DIM-GC1-DD2**

# RECESSED RUBO

**3G-RRU2401**  
**24" ROUND**

**3G**  
LIGHTING

## PERFORMANCE CHART (Based on 3500K)

LENS OPTIONS	LED SYSTEM	SYSTEM WATTS	DELIVERED LUMENS	EFFICACY LM/W	IES FILES
<b>FLUSH</b>	L2 - STANDARD OUTPUT	29W	2742	95	<a href="#">DOWNLOAD</a>
	L4 - HIGH OUTPUT	46W	4426	96	<a href="#">DOWNLOAD</a>
<b>1" DROP</b>	L2 - STANDARD OUTPUT	29W	2810	97	<a href="#">DOWNLOAD</a>
	L4 - HIGH OUTPUT	46W	4538	99	<a href="#">DOWNLOAD</a>
<b>2" DROP</b>	L2 - STANDARD OUTPUT	29W	2896	100	<a href="#">DOWNLOAD</a>
	L4 - HIGH OUTPUT	46W	4673	102	<a href="#">DOWNLOAD</a>
<b>3" DROP</b>	L2 - STANDARD OUTPUT	29W	2859	99	<a href="#">DOWNLOAD</a>
	L4 - HIGH OUTPUT	46W	4614	100	<a href="#">DOWNLOAD</a>
<b>4" DROP</b>	L2 - STANDARD OUTPUT	29W	2915	101	<a href="#">DOWNLOAD</a>
	L4 - HIGH OUTPUT	46W	4702	102	<a href="#">DOWNLOAD</a>
<b>5" DROP</b>	L2 - STANDARD OUTPUT	29W	2974	103	<a href="#">DOWNLOAD</a>
	L4 - HIGH OUTPUT	46W	4797	104	<a href="#">DOWNLOAD</a>

## MOUNTING

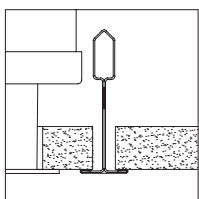

**GC1** - 9/16" LAYIN

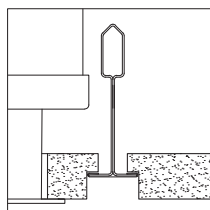

**GC1S** - 9/16" TEGULAR

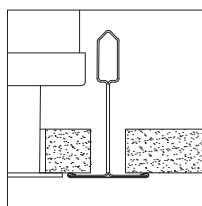

**GC2** - 15/16" LAYIN  
TEE TEGULAR

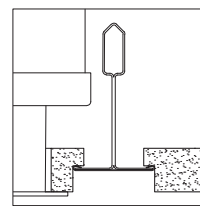

**GC2S** - 15/16" TEGULAR

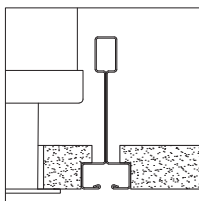

**GC3** - 9/16" SLOT  
TEE TEGULAR

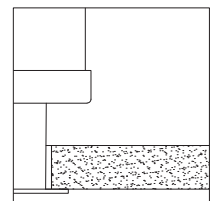

**WT** - WHITE TRIM  
(DRYWALL)

## NOTES