

# 3G LIGHTING

## 3G-58RMSL

5.8" RECESSED MINI MADISON SLOT  
DYNAMIC WHITE



5.8" recessed slot designed for continuous runs in various configurations  
Suitable for drywall, wood, and other architectural ceiling applications  
Suitable for grid ceiling and 6" techzone applications  
Machined aluminum double gimbals. Adjustable and lockable  
Individual fixture heads can slide left or right within the channel (up to 18")  
Easily adjustable in the field for maximum flexibility  
Dim to Warm and Tunable White LED options up to 2000lm (90+ CRI)  
1% dimming standard with several integral driver options

**3GD 3GT**

<b>PROJECT:</b>		<b>TYPE:</b>	
<b>CATALOG#:</b>		<b>DATE:</b>	<b>QTY:</b>

CAT. NO	LED SOURCE	LUMEN OUTPUT	CRI	BEAM ANGLE	VOLTAGE
<b>3G-58RMSL</b>	<b>DW</b> - DIM TO WARM (1800K-3000K) <b>TW</b> - TUNABLE WHITE <sup>1</sup> (2700K-6500K)	<b>08</b> - 800 LUMENS <b>12</b> - 1200 LUMENS <b>20</b> - 2000 LUMENS	<b>H90</b> - 90+ CRI	<b>10D</b> - 10° <sup>2</sup> <b>20D</b> - 20° <b>40D</b> - 40° <b>60D</b> - 60° <b>90D</b> - 90°	<b>UNV</b> - 120/277V <b>120</b> - 120V <b>347</b> - 347V <sup>3</sup>

DRIVER	FLANGE TYPE	GIMBAL FINISH	HOUSING INTERIOR
<b>DIM</b> - 0-10V (100-1%) <b>LE</b> - PHASE DIM <sup>4</sup> (TRIAC/ELV, 100-1%) <b>DO1</b> - 0-10V (100-0.1%) <sup>1</sup> <b>DALI</b> - DALI (100-1%) <sup>1,5</sup> <b>DHL2</b> - LUTRON HI-LUME (1% ECOSYSTEM) <b>DMX</b> - DMX (100-0%) <sup>1</sup>	<b>WT</b> - WHITE TRIM <b>XTR</b> - TRIMLESS (MUD-IN DRYWALL) <b>FX</b> - FLANGELESS <b>GCX</b> - GRID CEILING* (UNIVERSAL MOUNT) <b>6TZ</b> - 6" TECHZONE (AVAILABLE IN STRAIGHT RUNS ONLY) <small>*Universal mounting brackets used for all grid ceiling types only. See mounting section for details</small>	<b>NG</b> - NATURAL ALUMINUM <b>BG</b> - BLACK GIMBAL <b>WG</b> - WHITE GIMBAL	<b>BK</b> - BLACK <b>WH</b> - WHITE

OPTIONS	HOUSING TYPE	FIXTURE HEAD SPACING
<b>2C</b> - 2 CIRCUIT OPERATION <b>3C</b> - 3 CIRCUIT OPERATION <b>HXB</b> - BLACK HEXCELL LOUVER <b>LS</b> - LINEAR SPREAD LENS <b>SB</b> - SANDBLASTED LENS <b>SF</b> - SOFTENING LENS <b>STB</b> - BLACK SNOOT <b>STN</b> - NATURAL SNOOT <b>STW</b> - WHITE SNOOT <b>CP</b> - CHICAGO PLENUM  <small>*Maximum 3 optical accessories</small>	<b>S</b> - ____' (STRAIGHT) <b>L</b> - ____'X ____' (L-SHAPE) <b>U</b> - ____'X ____'X ____' (U-SHAPE) <b>R</b> - ____'X ____' (RECTANGLE/SQUARE)  <small>U-Shape and R-Rectangle/Square not available with grid ceiling applications Continuous runs available in 6" increments</small>	<b>12"</b> - 12" ON CENTER <b>18"</b> - 18" ON CENTER <b>24"</b> - 24" ON CENTER <b>36"</b> - 36" ON CENTER <b>48"</b> - 48" ON CENTER <b>CUS</b> - CUSTOM (FIXTURE HEADS)

<sup>1</sup> Tunable White option available with DO1, DALI and DMX drivers  
<sup>2</sup> 10D reflector available with 800 lumen output only  
<sup>3</sup> 347 available in "DIM" 0-10V only (100-1%)  
<sup>4</sup> Phase dimming options available in 120V only  
<sup>5</sup> DALI-2 (Type 6) provided as standard. Please consult factory for DALI (Type 8) options

**3GD** - Warm Dim  
**3GT** - Tunable White

BASED ON 60° BEAM ANGLE AND 3000K (PER FIXTURE HEAD)

LUMEN OUTPUT	90+ CRI (3000K)		
	DELIVERED LUMENS	SYSTEM WATTS	EFFICACY (LPW)
<b>800LMs</b>	N/A	N/A	N/A
<b>1200LMs</b>	1136	15.4	74
<b>2000LMs</b>	1593	23.2	69

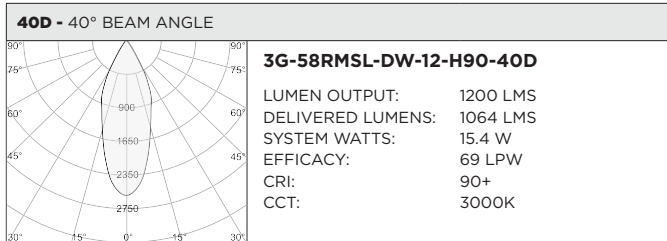
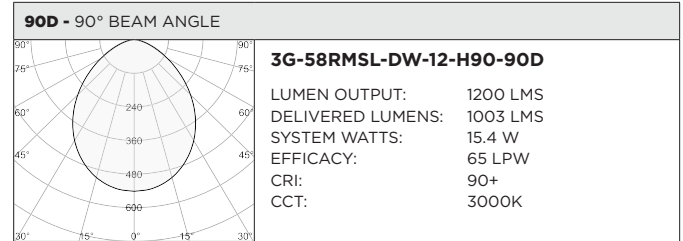
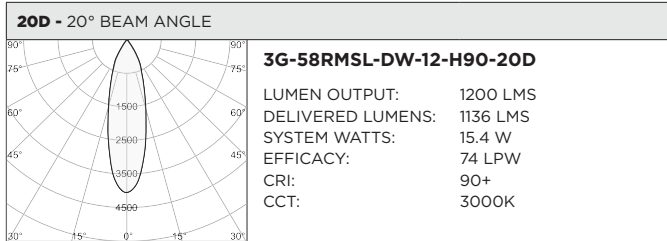
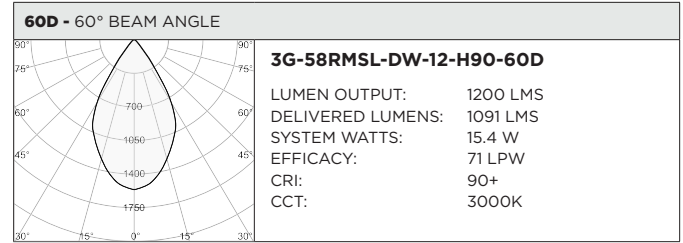
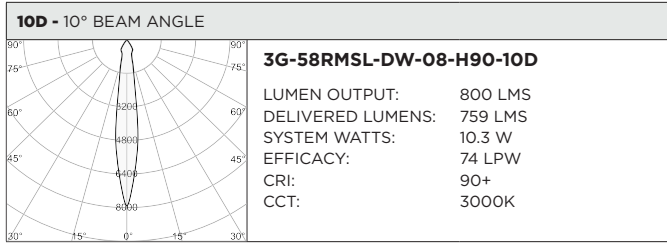

BASED ON 60° BEAM ANGLE (PER FIXTURE HEAD)

LUMEN OUTPUT	90+ CRI (2700K)			90+ CRI (3500K)			90+ CRI (6500K)		
	DELIVERED LUMENS	SYSTEM WATTS	EFFICACY (LPW)	DELIVERED LUMENS	SYSTEM WATTS	EFFICACY (LPW)	DELIVERED LUMENS	SYSTEM WATTS	EFFICACY (LPW)
<b>800LMs</b>	N/A	N/A	N/A	N/A	N/A	N/A	N/A	N/A	N/A
<b>1200LMs</b>	1066	16.6	64	1091	16.6	66	1221	16.6	74
<b>2000LMs</b>	1491	24.5	61	1561	24.5	64	1684	24.5	69

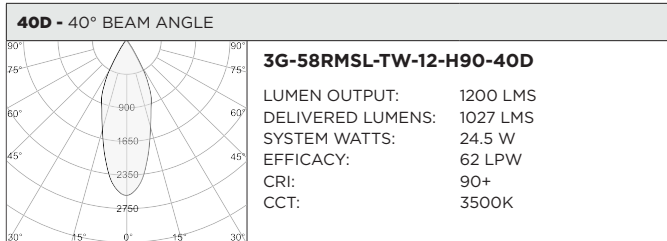
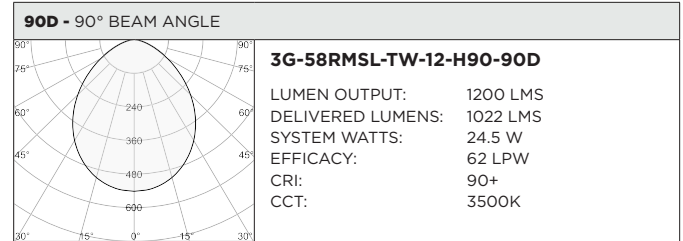
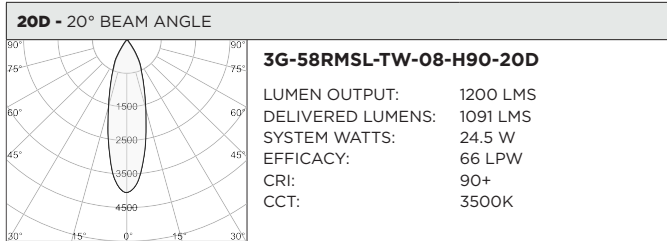
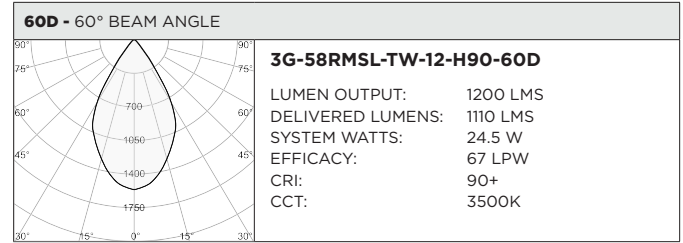
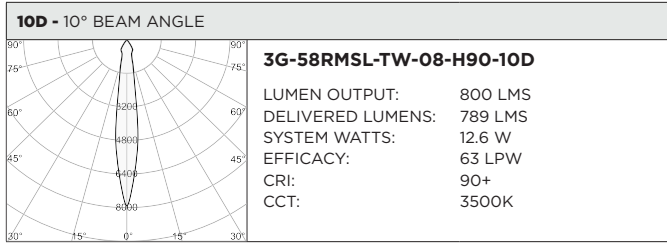

## HOUSING

Housing constructed in extruded aluminum and cold rolled steel  
Designed for continuous runs in various configurations. Available in 6" increments  
Maximum ceiling thickness of 1.75". Consult factory for modifications  
Standard matte black powder coated finish with optional matte white finish  
Trim flange with matte white powder coated finish and minimal 0.400" overlap  
Trimless model features a satin coat mudding flange for seamless ceiling integration

## ADJUSTABILITY

Solid aluminum, 70mm double gimbals with dual axis adjustability (45°x45°)  
Individual fixture heads can slide left or right within the channel (up to 18")  
Easily adjustable in the field for maximum flexibility  
Each double gimbal can be locked in place

## OPTICS

Regressed LED source for enhanced glare control  
Proprietary anodized, aluminum reflectors are field replaceable  
(10° reflector not interchangeable)  
Available in 10°, 20°, 40°, 60° and 90°

## LISTING

ETL listed and conforms to UL1598 standard. Certified to CSA22.2  
NO.250.0. Rated for indoor dry or damp locations

## WARRANTY

5 Year Warranty on LED and drivers  
Manufacturer 1 Year Warranty for defects in material and workmanship  
under normal use  
Ambient temperature at fixture should not exceed 25°C

## ELECTRICAL

Standard 0-10V, constant current drivers with 100-1% dimming range  
and >0.9 power factor  
Standard 120/277V universal voltage drivers. Optional 347V, 0-10V driver  
Lutron EcoSystem and eldoLED DALI options available with 100-1% dimming  
eldoLED 0-10V, 100-0.01% dimming range available (D01)  
DMX drivers available with 100-0% dimming range  
120V Forward Phase/Reverse Phase driver option with 100-1% dimming  
Individual fixture sections can be wired independently  
All drivers are integral and easily accessible through the channel aperture

## LED SYSTEM

Bridgelux LED module (field replaceable)  
Color consistency <3 SDCM  
Standard 90+ CRI  
Dim to Warm (1800K-3000K)  
Tunable White (2700K-6500K)  
L70 >50,000 hours  
5 Year Warranty

## MOUNTING

New construction housing suspended via 1/4" threaded rod or  
suspension cables (by others)  
Fixture housing suitable for IC applications  
Trim fixture designed for use in drywall, wood, and other architectural  
ceiling materials  
Trimless fixture designed for use in drywall, mud-in ceiling applications  
Flangeless fixture designed for use in wood ceilings  
Suitable for various grid ceiling applications (see mounting details)

**HARD CEILING**

**WT - TRIM**

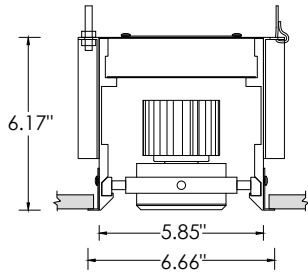

RECOMMENDED CEILING OPENING 6.30"

**XTR - TRIMLESS**

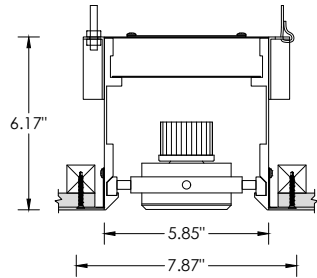

RECOMMENDED CEILING OPENING 6.20"

**FX - FLANGELESS**

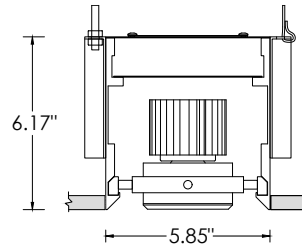

RECOMMENDED CEILING OPENING 5.95"

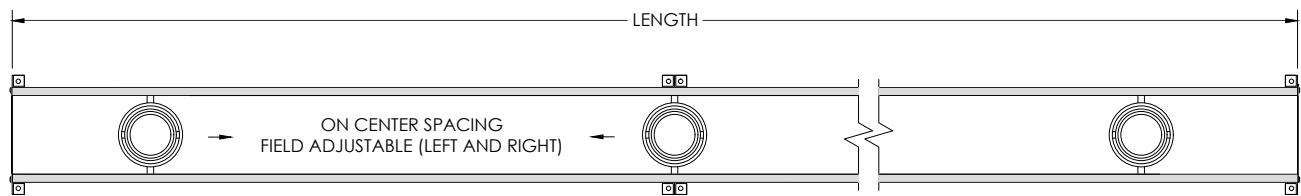

**HARD CEILING : MOUNTING DETAILS**

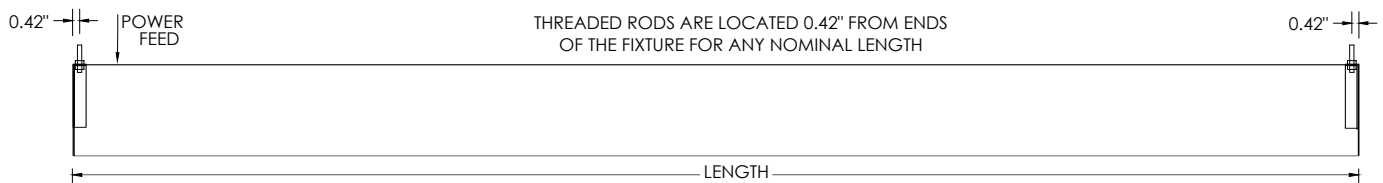

**GRID CEILING**

**9L - 9/16" LAYIN**

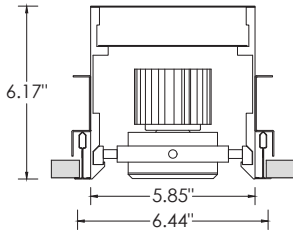

**9TG - 9/16" TEGULAR**

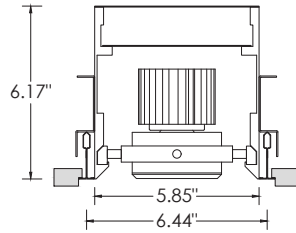

**15L - 15/16" LAYIN**

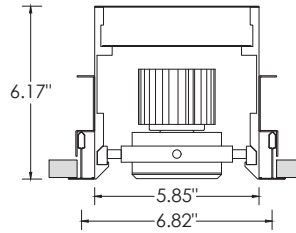

**15TG - 15/16" TEGULAR**

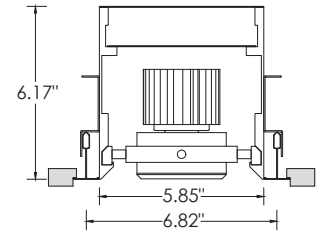

**9ST - 9/16" SLOT TEE TEGULAR**

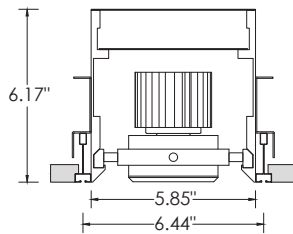

**6TZ - TECHZONE**

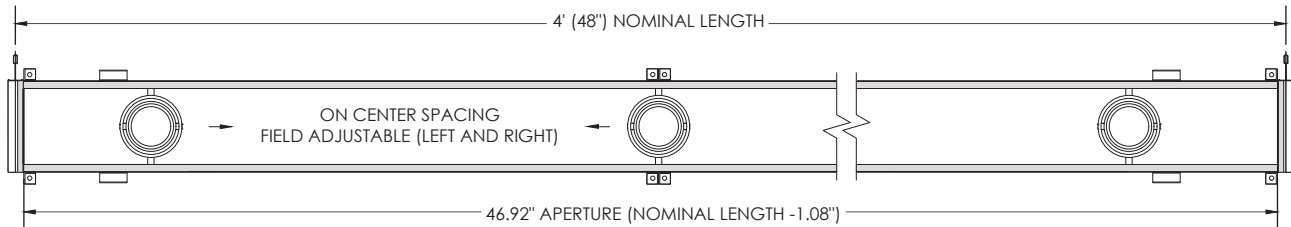
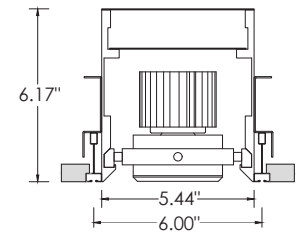

**GRID CEILING : MOUNTING DETAILS**

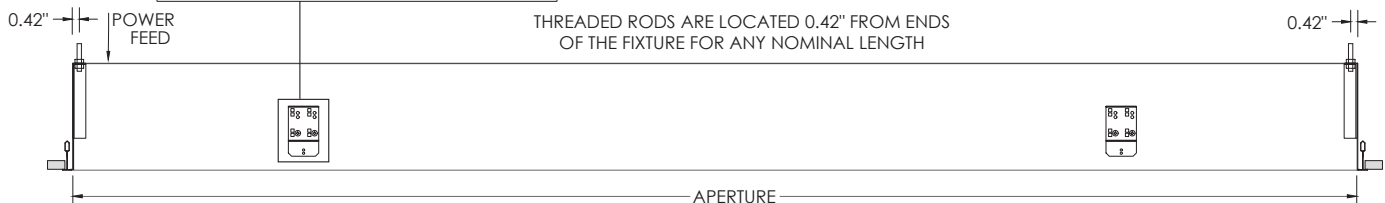
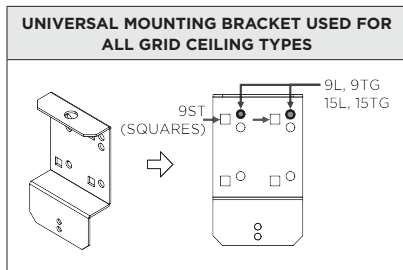

**GIMBAL ADJUSTABILITY**

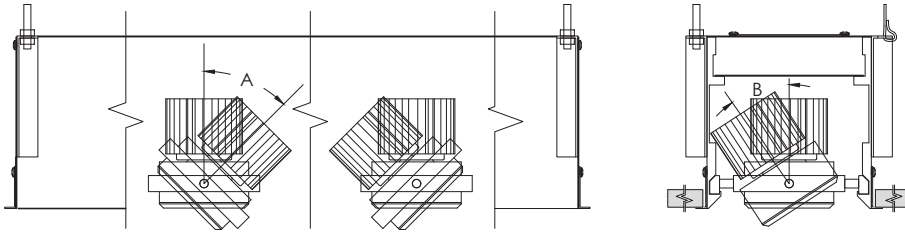

LUMEN OUTPUT	A	B
Up to 1500lm	45°	45°
2200lm/3000lm	45°	35°
4000lm	45°	20°

**PATTERNS**

Specify pattern shape and overall dimensions as shown below  
 Patterns are connected with 12"x12" mitered corner sections (Fixture heads not available)  
 Please consult factory for custom patterns and shapes not shown below

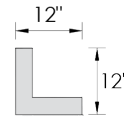

L-SHAPE	U-SHAPE	RECTANGLE/SQUARE
Provide dimensions of AxB Example: <b>L</b> - 6'x8'	Provide dimensions of AxBxC Example: <b>U</b> - 8'x10'x6'	Provide dimensions of AxB Example: <b>R</b> - 10'x8'