

# 3G LIGHTING

## 3G-58RMSL

5.8" RECESSED  
MADISON SLOT

Solid aluminum double gimbals with dual axis adjustability  
Individual fixture heads can be repositioned in either direction (up to 18")  
Standard 95+ CRI LED system with performance up to 132 LPW  
Delivered lumen range up to 4000lm at 95+ CRI  
Regressed LED source for enhanced glare control  
10° to 90° beam angle options suitable for various applications  
Companion to 3G's Madison product family



### WT - TRIM

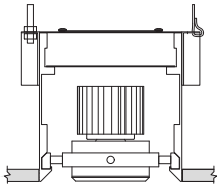

### XTR - TRIMLESS

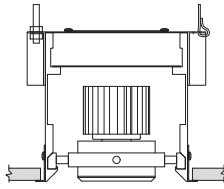

### FX - FLANGELESS

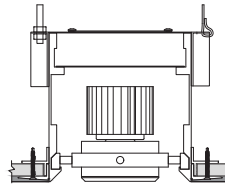

### GCX - GRID CEILING

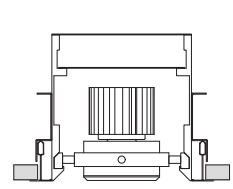

### OPTICS

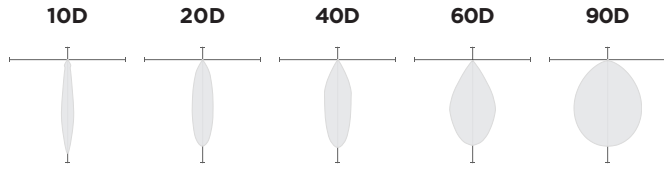

### PERFORMANCE

| LUMEN OUTPUT | DELIVERED LUMENS | SYSTEM WATTS | EFFICACY (LPW) |
|--------------|------------------|--------------|----------------|
| 1000         | 1000             | 8.1          | 123            |
| 1500         | 1500             | 12.3         | 122            |
| 2000         | 2000             | 16.2         | 123            |
| 2500         | 2500             | 20.5         | 122            |
| 3000         | 3000             | 25.8         | 116            |
| 4000         | 4000             | 30.1         | 117            |

BASED ON 95+ CRI, 35K, 40D OPTIC  
Lumen output and actual wattage may vary +/- 5%

### PATTERNS

Specify pattern shape and overall dimensions as shown below. Patterns are connected with 12"x12" mitered corner sections (Fixture heads not available)  
Please consult factory for custom patterns and shapes not shown below.

| L-SHAPE  | U-SHAPE  | RECTANGLE/SQUARE  |
|--|--|---|
| Provide dimensions of AxB<br>Example: <b>L</b> - 6'x8' | Provide dimensions of AxBxC<br>Example: <b>U</b> - 8'x10'x6" | Provide dimensions of AxB<br>Example: <b>R</b> - 10'x8' |
|  |  |   |

|                  |  |              |  |
|------------------|--|--------------|--|
| <b>PROJECT:</b>  |  | <b>TYPE:</b> |  |
| <b>CATALOG#:</b> |  | <b>DATE:</b> |  |
|                  |  | <b>QTY:</b>  |  |

| CAT. NO   | LUMEN OUTPUT**          | CRI                  | COLOR TEMP         | BEAM ANGLE   | VOLTAGE  |
|---|-------------------------|----------------------|--------------------|--|--|
| <b>3G-58RMSL</b>                                  | <b>10</b> - 1000 LUMENS | <b>H95</b> - 95+ CRI | <b>27K</b> - 2700K | <b>10D</b> - 10° <sup>1</sup>  | <b>UNV</b> - 120/277V<br><b>120</b> - 120V<br><b>347</b> - 347V <sup>2</sup> |
|   | <b>15</b> - 1500 LUMENS |                      | <b>30K</b> - 3000K | <b>20D</b> - 20°   |  |
|   | <b>20</b> - 2000 LUMENS |                      | <b>35K</b> - 3500K | <b>40D</b> - 40°   |  |
|   | <b>25</b> - 2500 LUMENS |                      | <b>40K</b> - 4000K | <b>60D</b> - 60°   |  |
|   | <b>30</b> - 3000 LUMENS |                      |                    | <b>90D</b> - 90° *   |  |
|   | <b>40</b> - 4000 LUMENS |                      |                    |  |  |
| All lumen outputs are delivered lumens at 95+ CRI |                         |                      |                    | *90D optic supplied with lens<br>Not available with other lens options |  |

| DRIVER   | TRIM FLANGE   | GIMBAL FINISH  | HOUSING FINISH                                    |
|--|---|--|---|
| <b>DIM</b> - 0-10V (100-1%)<br><b>LE</b> - PHASE DIM <sup>3</sup><br>(TRIAC/ELV, 100-1%)<br><b>DO1</b> - 0-10V (100-0.1%)<br><b>DALI</b> - DALI (100-1%) <sup>4</sup><br><b>DHL2</b> - LUTRON HI-LUME<br>(1% ECOSYSTEM)<br><b>DMX</b> - DMX (100-0%) | <b>WT</b> - WHITE TRIM (STANDARD)<br><b>BT</b> - BLACK TRIM<br><b>XTR</b> - TRIMLESS (MUD-IN DRYWALL)<br><b>FX</b> - FLANGELESS<br><b>GCX</b> - GRID CEILING *<br>(UNIVERSAL MOUNT)<br><b>6TZ</b> - 6" TECHZONE<br><br><small>*Universal mounting brackets used for all grid ceiling types only. See mounting details</small> | <b>NG</b> - NATURAL ALUMINUM<br><b>BG</b> - BLACK GIMBAL<br><b>WG</b> - WHITE GIMBAL | <b>BK</b> - BLACK (STANDARD)<br><b>WH</b> - WHITE |

| OPTIONS   | RUN TYPE   | FIXTURE HEAD SPACING  |
|---|--|---|
| <b>2C</b> - 2 CIRCUIT<br><b>3C</b> - 3 CIRCUIT<br><b>SF</b> - SOFTENING LENS<br><b>LS</b> - LINEAR SPREAD LENS<br><b>SB</b> - SANDBLASTED LENS<br><b>HXB</b> - BLACK HEXCELL LOUVER<br><b>CP</b> - CHICAGO PLENUM<br><b>EMR</b> - REMOTE EMERGENCY <sup>5</sup><br>BATTERY<br><br><small>*Lens options not available with 90D optic<br/>Maximum 3 optical accessories</small> | <b>S</b> - ____' (STRAIGHT)<br><b>L</b> - ____'x ____' (L-SHAPE)<br><b>U</b> - ____'x ____'x ____' (U-SHAPE)<br><b>R</b> - ____'x ____' (RECTANGLE/SQUARE)<br><br><small>Continuous runs available in 1" increments<br/>Patterns not available with grid ceiling</small> | <b>12"</b> - 12" ON CENTER<br><b>18"</b> - 18" ON CENTER<br><b>24"</b> - 24" ON CENTER<br><b>36"</b> - 36" ON CENTER<br><b>48"</b> - 48" ON CENTER<br><b>CUS</b> - CUSTOM SPACING<br>SPECIFY NUMBER OF<br>DOWNLIGHTS " <b>CUS(XX)</b> " |

- <sup>1</sup> 10D reflector available up to 2000lm
- <sup>2</sup> 347 available in "DIM" 0-10V only (100-1%)
- <sup>3</sup> Phase dimming options available in 120V only
- <sup>4</sup> DALI-2 (Type 6) provided as standard. Please consult factory for DALI (Type 8) options
- <sup>5</sup> Supplied with enclosure with Emergency Battery and driver. Installed remotely by others.  
Not accessible through fixture aperture

**\*\*** 3G has upgraded our LED system and overall performance at no additional cost. We now offer 95+CRI as standard. All lumen outputs are delivered lumens. This upgraded LED system is more efficient than our previous 80CRI, 90CRI, and 97CRI options. Please see the last page of this spec sheet to cross-reference old lumen outputs with our new, 95+CRI lumen output options

**PERFORMANCE**

| LUMEN OUTPUT | DELIVERED LUMENS | SYSTEM WATTS | EFFICACY (LPW) |
|--------------|------------------|--------------|----------------|
| 1000         | 1000             | 8.1          | 123            |
| 1500         | 1500             | 12.3         | 122            |
| 2000         | 2000             | 16.2         | 123            |
| 2500         | 2500             | 20.5         | 122            |
| 3000         | 3000             | 25.8         | 116            |
| 4000         | 4000             | 30.1         | 117            |

BASED ON 95+ CRI, 35K, 40D OPTIC  
Lumen output and actual wattage may vary +/- 5%

**MULTIPLIERS**

| BEAM ANGLE |      |
|------------|------|
| 10D        | 1.05 |
| 20D        | 1.03 |
| 40D        | 1.00 |
| 60D        | 1.00 |
| 90D        | 0.90 |

| COLOR TEMP |      |
|------------|------|
| 2700K      | 0.98 |
| 3000K      | 1.00 |
| 3500K      | 1.00 |
| 4000K      | 1.02 |

**HOUSING**

Housing constructed in extruded aluminum and cold rolled steel  
Designed for continuous runs in various configurations  
Maximum ceiling thickness of 1.75". Consult factory for modifications  
Standard matte black powder coated housing finish  
Trim flange with power coated finish and 0.400" overlap  
Trimless model features a perforated galvanized mudding flange

**ADJUSTABILITY**

Solid aluminum double gimbal with dual axis adjustability  
Individual fixture heads can be repositioned in either direction (up to 18")  
Each double gimbal can be locked in place

**OPTICS**

Proprietary anodized, aluminum reflectors  
Beam angle available in 10°, 20°, 40° and 60°, and 90°  
Reflectors are field replaceable (10° and 20° reflectors not interchangeable)

**LED SYSTEM**

Standard 95+ CRI  
Color consistency <2 SDCM  
Available in 27K, 30K, 35K, and 40K  
L90 > 50,000 hours

**ELECTRICAL**

Standard 0-10V, constant current drivers  
100-1% dimming range and >0.9 power factor  
Standard 120/277V universal voltage with several driver options  
120V Forward Phase/Reverse Phase driver option (100-1%)  
Integral drivers are easily accessible through luminaire aperture

**EMERGENCY**

7W output for 90 minutes (One fixture head +/- 850lm at 95+ CRI)  
Title 24 Certified  
Remote emergency battery not accessible through fixture aperture  
Maximum remote mounting distance:  
3000lm or below - 50ft (12AWG) or 25ft (14AWG)  
Above 3000lm - 30ft (12AWG) or 20ft (14AWG)  
Caution: Emergency Battery utilizes more than one power source and servicing should be performed by qualified personnel

**MOUNTING**

New construction housing suspended via 1/4" threaded rod or suspension cables (by others)  
Trim fixture designed for use in drywall, wood, and other architectural ceiling materials  
Trimless fixture designed for use in drywall, mud-in ceiling applications  
Flangeless fixture designed for use in wood ceilings  
Suitable for various grid ceiling applications (see mounting details)

**LISTING**

ETL listed and conforms to UL1598 standard  
Certified to CSA22.2 No.250.0.  
Rated for dry or damp locations

**WARRANTY**

5 year limited warranty  
LED system rated for operation in ambient environments up to 25°C

**HARD CEILING**

**WT - TRIM**

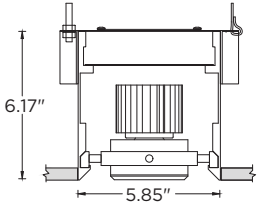

RECOMMENDED CEILING  
CUT-OUT 5.20"

**XTR - TRIMLESS**

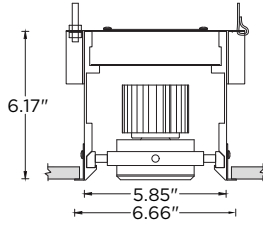

RECOMMENDED CEILING  
CUT-OUT 5.20"

**FX - FLANGELESS**

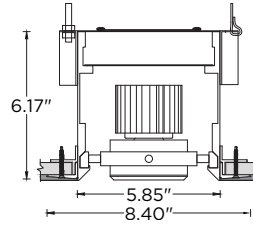

RECOMMENDED CEILING  
CUT-OUT 4.90"

**TRIM**

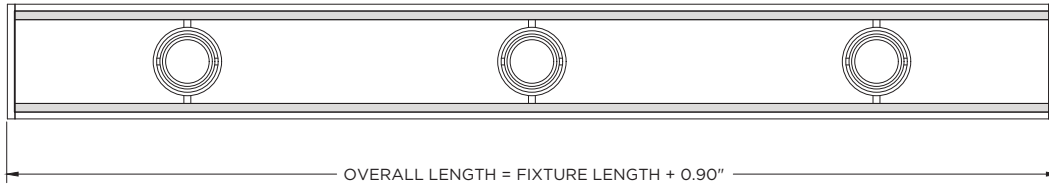

**TRIMLESS (MUD-IN DRYWALL)**

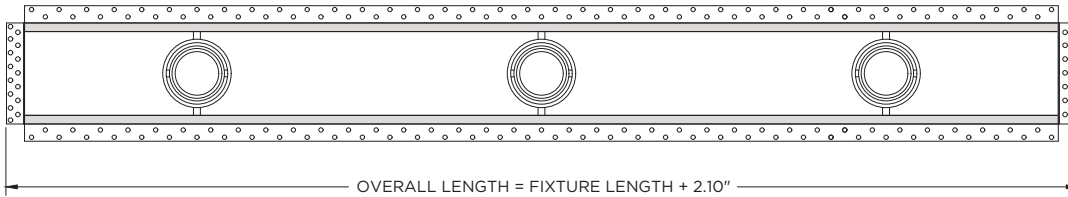

**FLANGELESS**

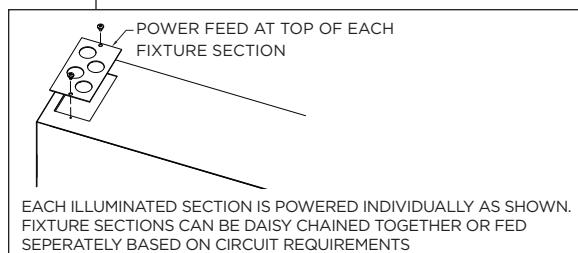
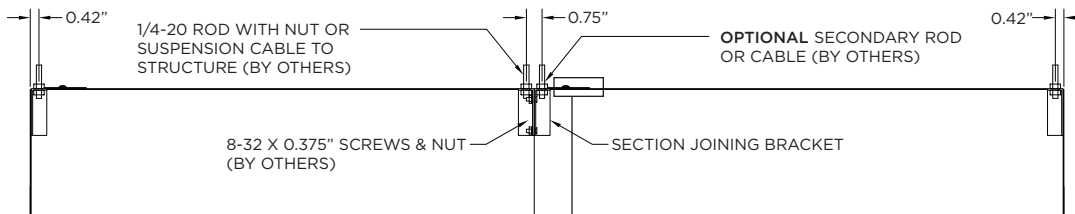
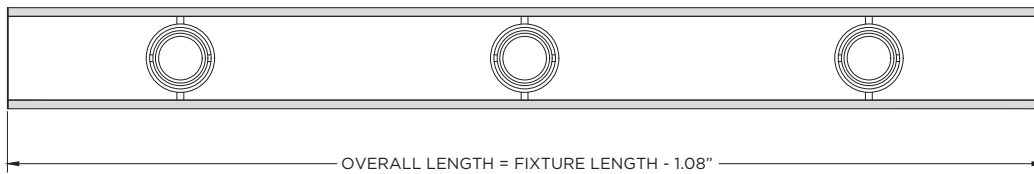

**GRID CEILING**

**9L - 9/16" LAYIN**

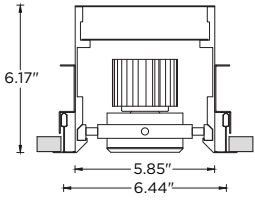

**9TG - 9/16" TEGULAR**

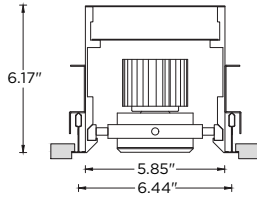

**15L - 15/16" LAYIN**

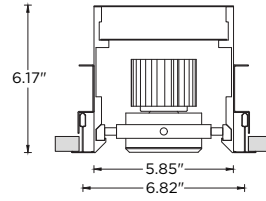

**15TG - 15/16" TEGULAR**

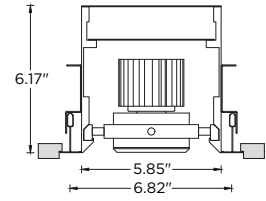

**9ST - 9/16" SLOT TEE TEGULAR**

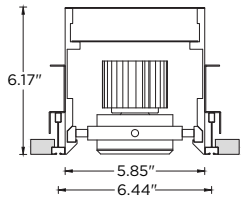

**6TZ - TECHZONE**

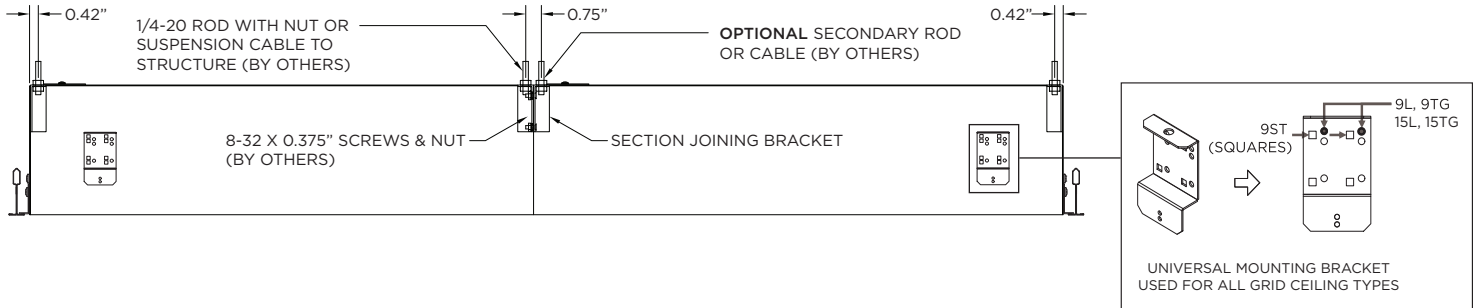
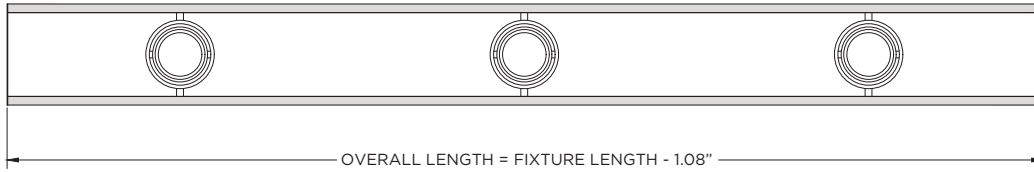
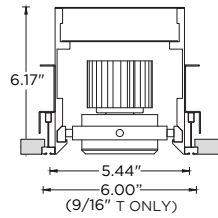

**GIMBAL ADJUSTABILITY**

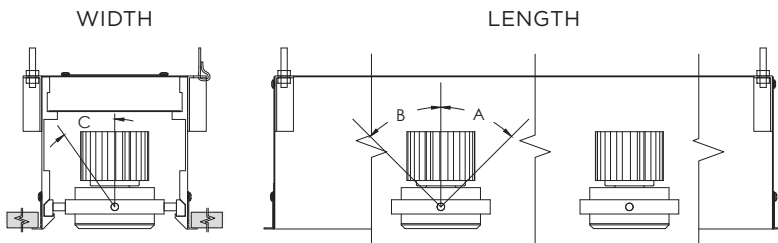

| LUMEN OUTPUT | A   | B   | C   |
|--------------|-----|-----|-----|
| Up to 3000lm | 45° | 45° | 30° |
| 4000lm       | 45° | 45° | 20° |

**LUMEN OUTPUT REFERENCE CHART**

3G has upgraded our LED system and overall performance at no additional cost. We now offer 95+CRI as standard. All lumen outputs are delivered lumens. This new LED system is more efficient than our previous 80CRI, 90CRI, and 97CRI options. Please use these charts to cross-reference old lumen outputs with our new, 95+CRI lumen output options

**80CRI REFERENCE CHARTS**

MATCH THE GRADIENT SHADE FROM THE OLD LUMEN OUTPUT CHART TO THE NEW LUMEN OUTPUT OPTION

| OLD 80CRI SPECS |                  |              |                |
|-----------------|------------------|--------------|----------------|
| LUMEN OUTPUT    | DELIVERED LUMENS | SYSTEM WATTS | EFFICACY (LPW) |
| 1000            | 1080             | 10.3         | 105            |
| 1500            | 1444             | 14.0         | 103            |
| 2200            | 2089             | 22.0         | 95             |
| 3000            | 2815             | 31.1         | 90             |
| 4000            | 3958             | 43.0         | 92             |

| NEW 95+CRI SPECS |                  |              |                |
|------------------|------------------|--------------|----------------|
| LUMEN OUTPUT     | DELIVERED LUMENS | SYSTEM WATTS | EFFICACY (LPW) |
| 1000             | 1000             | 8.1          | 123            |
| 1500             | 1500             | 12.3         | 122            |
| 2000             | 2000             | 16.2         | 123            |
| 2500             | 2500             | 20.5         | 122            |
| 3000             | 3000             | 25.8         | 116            |
| 4000             | 4000             | 30.1         | 117            |

**90CRI REFERENCE CHARTS**

MATCH THE GRADIENT SHADE FROM THE OLD LUMEN OUTPUT CHART TO THE NEW LUMEN OUTPUT OPTION

| OLD 90CRI SPECS |                  |              |                |
|-----------------|------------------|--------------|----------------|
| LUMEN OUTPUT    | DELIVERED LUMENS | SYSTEM WATTS | EFFICACY (LPW) |
| 1000            | 951              | 10.3         | 92             |
| 1500            | 1271             | 14.0         | 91             |
| 2200            | 1838             | 22.0         | 84             |
| 3000            | 2477             | 31.1         | 79             |
| 4000            | 3483             | 43.0         | 81             |

| NEW 95+CRI SPECS |                  |              |                |
|------------------|------------------|--------------|----------------|
| LUMEN OUTPUT     | DELIVERED LUMENS | SYSTEM WATTS | EFFICACY (LPW) |
| 1000             | 1000             | 8.1          | 123            |
| 1500             | 1500             | 12.3         | 122            |
| 2000             | 2000             | 16.2         | 123            |
| 2500             | 2500             | 20.5         | 122            |
| 3000             | 3000             | 25.8         | 116            |
| 4000             | 4000             | 30.1         | 117            |