

3G LIGHTING

3G-4RPE

3.75" RECESSED PERIMETER

Narrow 3.75" aperture with one piece extruded aluminum housing
 Designed for continuous runs in 1' increments and various configurations
 Adjustable end filler option available for odd lengths (field cuttable)
 Lens position available in flush, 1", 2" and 3" regressed options
 Suitable for drywall, grid, wood, and various architectural ceilings
 Low, standard and high lumen output options
 1% dimming standard with several driver options



ORDERING INFORMATION

PROJECT:	<input type="text"/>	TYPE:	<input type="text"/>
CATALOG #:	<input type="text"/>	DATE:	<input type="text"/>

CAT. NO	LUMEN OUTPUT	CRI	COLOR TEMP	VOLTAGE	DRIVER
3G-4RPE	L250 - LOW OUTPUT (250LM/FT)	S80 - 80+CRI (STANDARD)	27K - 2700K	UNV - 120/277V	DIM - 0-10V (STANDARD 100-1%) DHL2 - LUTRON HI-LUME LDE (100-1% ECOSYSTEM) DALI - DALI (100-1%) D01 - 0-10V (100-0.1%)
	L500 - MEDIUM OUTPUT (500LM/FT)		30K - 3000K		
	L750 - HIGH OUTPUT (750LM/FT)	H90 - 90+CRI	35K - 3500K		
				40K - 4000K	

FLANGE TYPE	LENS POSITION	OPTIONS	LENGTH (FEET)
XTR - TRIMLESS WT - WHITE TRIM FX - FLANGELESS GC1 - 9/16 LAYIN GC1S - 9/16 TEGULAR GC2 - 15/16 LAYIN GC2S - 15/16 TEGULAR GC3 - 9/16 SLOT TEE TEGULAR <small>See mounting section for grid details</small>	FL - FLUSH RG1 - 1" REGRESSED RG2 - 2" REGRESSED RG3 - 3" REGRESSED	EF - END FILLER ¹ EM - INTEGRAL EMERGENCY BATTERY (4' SECTION) CP - CHICAGO PLENUM	S - ___' (STRAIGHT RUN)* L - ___' X ___' (L-SHAPE) U - ___' X ___' X ___' (U-SHAPE)

*Individual units available in 3', 4', 5', 6' and 8'
 Continuous runs available in 1' increments

¹ Adjustable end fillers used for odd lengths. End fillers are fully illuminated and cuttable

PERFORMANCE CHART (Based on 3500K, 4' length)

LENS POSITION	LUMEN OUTPUT	SYSTEM WATTS (PER FT)	DELIVERED LUMENS (PER FT)	EFFICACY (LM/W)
FLUSH	L250 - LOW OUTPUT (250LM/FT)	3.3	396	118
	L500 - MEDIUM OUTPUT (500LM/FT)	4.8	584	120
	L750 - HIGH OUTPUT (750LM/FT)	8.6	990	115
1" REGRESSED	L250 - LOW OUTPUT (250LM/FT)	3.3	377	112
	L500 - MEDIUM OUTPUT (500LM/FT)	4.8	550	112
	L750 - HIGH OUTPUT (750LM/FT)	8.6	971	113
2" REGRESSED	L250 - LOW OUTPUT (250LM/FT)	3.3	381	112
	L500 - MEDIUM OUTPUT (500LM/FT)	4.8	560	116
	L750 - HIGH OUTPUT (750LM/FT)	8.6	982	114
3" REGRESSED	L250 - LOW OUTPUT (250LM/FT)	3.3	385	114
	L500 - MEDIUM OUTPUT (500LM/FT)	4.8	564	116
	L750 - HIGH OUTPUT (750LM/FT)	8.6	986	115

LUMEN OUTPUT ADJUSTMENT FACTORS: (27K=0.94) (30K=0.97) (35K=1.00) (40K=1.01)

EDITION 02/20

TECHNICAL**HOUSING**

Extruded aluminum housing with narrow 3.75" aperture
Designed for continuous runs in 1' increments
Adjustable end fillers available for odd lengths (field cuttable)
Lens position available in flush, 1", 2", and 3" regressed options
Extruded acrylic lens with a satin finish designed for optimal performance and glare control
Trim flange with matte white powder coated finish and minimal 0.400" overlap
Trimless model features a white powder coated beveled mudding flange
24 gauge LED reflector with high reflectance white powder coated finish
Standard polyester powder coated matte white finish

ELECTRICAL

Standard 0-10V, 100-1% dimming and 0.9 power factor
Standard 120/277V universal voltage drivers. Optional 347V 0-10V driver
Lutron EcoSystem and eldoLED Dali options available with 100-1% dimming
All drivers are integral and easily accessible through the aperture
Emergency Battery: 90 minutes

LED SYSTEM

Proprietary LED system
Color consistency < 3 SDCM
Standard (80+CRI)
Available in 27K, 30K, 35K, and 40K
Average rated life of > 50,000 hours
5-year warranty

MOUNTING

Trim fixture designed for use in drywall, wood, and other architectural ceiling materials
Trimless fixture designed for use in drywall, mud-in ceiling applications
Flangeless fixture designed for use in wood ceilings
Suitable for various grid ceilings applications (see mounting details)

LABELS

ETL listed and tested to UL standards. Suitable for dry and damp locations

WARRANTY

5 Year warranty on LED and drivers
Manufacturer 1-year warranty for defects in material and workmanship under normal use
Ambient temperature at fixture should not exceed 25°C

DRAWINGS AND DIMENSIONS

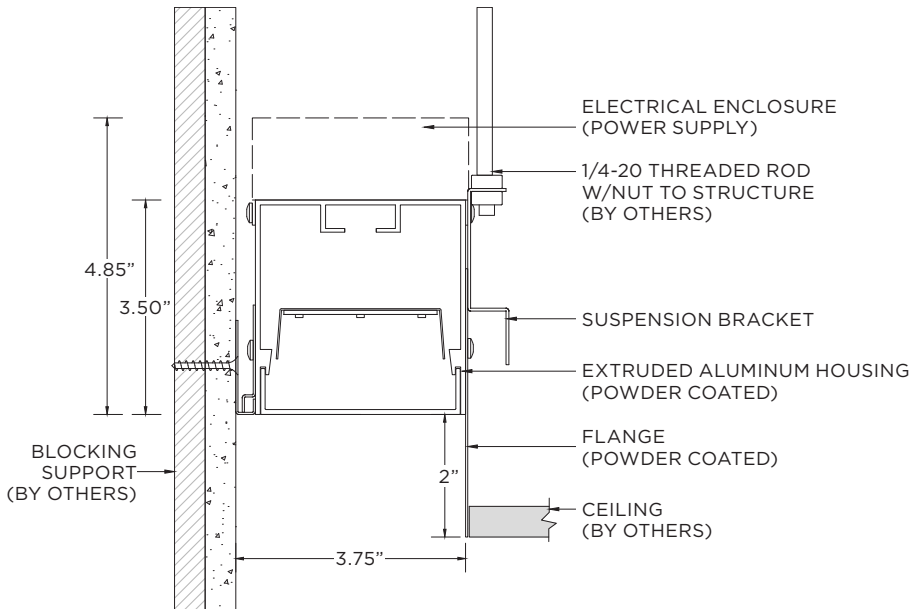

POWER FEED ENCLOSURE LOCATED AT BEGINNING OF RUN ONLY

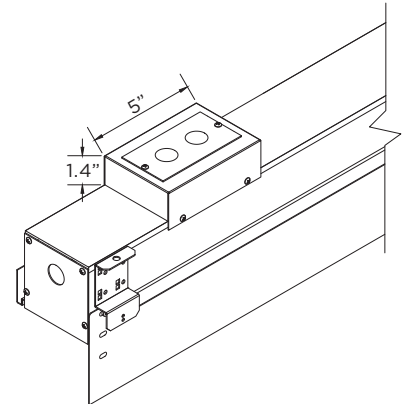

LENS POSITION

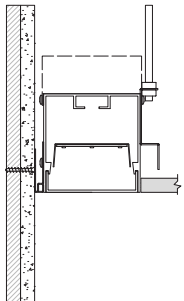

FL - FLUSH

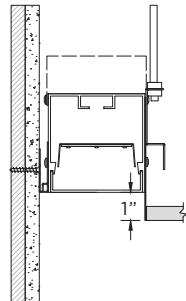

RG1 - 1" REGRESSED

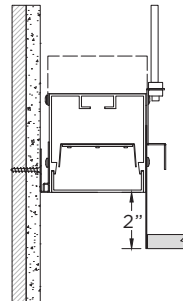

RG2 - 2" REGRESSED

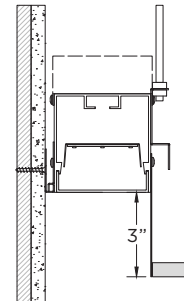

RG3 - 3" REGRESSED

MOUNTING

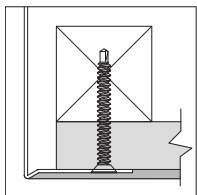

XTR - TRIMLESS

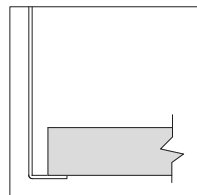

WT - TRIM

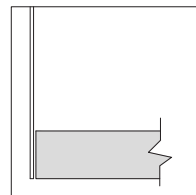

FX - FLANGELESS

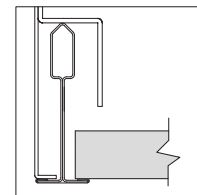

GC1 - 9/16" LAYIN

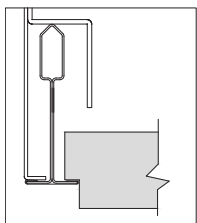

GC1S - 9/16" TEGULAR

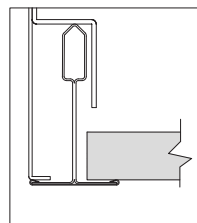

GC2 - 15/16" LAYIN

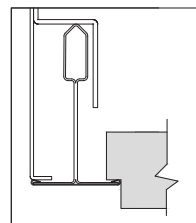

GC2S - 15/16" TEGULAR

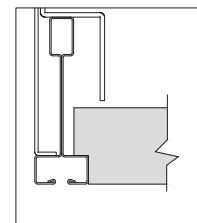

GC3 - 9/16" SLOT TEE TEGULAR