

# 3G LIGHTING

## 3G-4RPE

3.5" RECESSED PERIMETER

Extruded aluminum housing with narrow 3.5" aperture  
 Designed for continuous runs in various configurations  
 12" fully illuminated end filler option is field cuttable for odd lengths  
 Standard 80+ CRI and 90+ CRI LED system  
 Delivered lumen range up to 1500lm/FT with performance up to 144 LPW  
 Lens position available in flush, 1", 2", and 3" regressed options  
 High performance asymmetric optic provides room side distribution



**WT - TRIM**

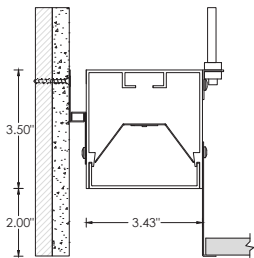

**XTR - TRIMLESS**

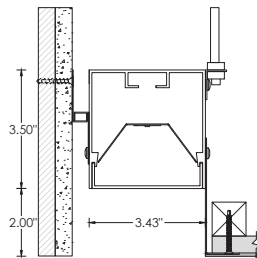

**FX - FLANGELESS**

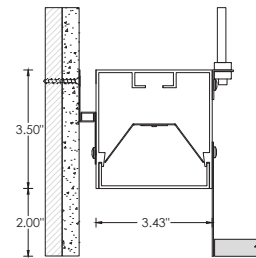

**GCX - GRID CEILING**

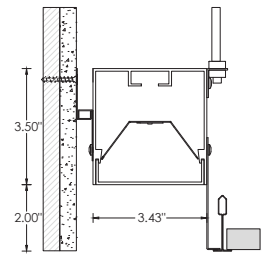

### OPTICS

**FLUSH**

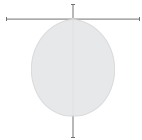

**1" REGRESSED**

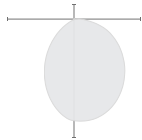

**2" REGRESSED**

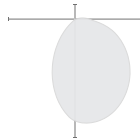

**3" REGRESSED**

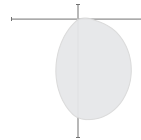

**FLUSH ASYMMETRIC**

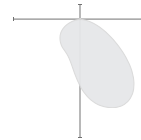

**1" REGRESSED ASYMMETRIC**

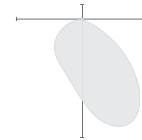

### PATTERNS

Specify pattern shape and overall dimensions as shown below. Patterns are connected with fully illuminated 12"x12" L and U-shaped sections  
 Please consult factory for custom patterns and shapes not shown below.

L-SHAPE	U-SHAPE	RECTANGLE/SQUARE
Provide dimensions of AxB Example: <b>L</b> - 6'x8'	Provide dimensions of AxBxC Example: <b>U</b> - 8'x10'x6"	Provide dimensions of AxB Example: <b>R</b> - 10'x8'

<b>PROJECT:</b>		<b>TYPE:</b>	
<b>CATALOG#:</b>		<b>DATE:</b>	<b>QTY:</b>

CAT. NO	LUMEN OUTPUT	CRI	COLOR TEMP
<b>3G-4RPE</b>	<b>D250</b> - 250 LM/FT <sup>1</sup> <b>D500</b> - 500 LM/FT <b>D750</b> - 750 LM/FT <b>D1000</b> - 1000 LM/FT <b>D1250</b> - 1250 LM/FT <b>D1500</b> - 1500 LM/FT <b>DC___</b> - CUSTOM OUTPUT (SPECIFY LM/FT) *  *Specify custom lumen outputs in 50lm increments (ie: DC600, DC650, DC700) Custom output cannot exceed D1500	<b>S80</b> - 80+ CRI <b>H90</b> - 90+ CRI	<b>27K</b> - 2700K <b>30K</b> - 3000K <b>35K</b> - 3500K <b>40K</b> - 4000K

VOLTAGE	DRIVER	FLANGE TYPE	LENS OPTION
<b>UNV</b> - 120/277V <b>347</b> - 347V <sup>2</sup>	<b>DIM</b> - 0-10V (100-1%) <b>D01</b> - 0-10V (100-0.1%) <b>DALI</b> - DALI (100-1%) <sup>3</sup> <b>DHL2</b> - LUTRON HI-LUME (1% ECOSYSTEM) <b>DMX</b> - DMX (100-0%)	<b>GCX</b> - GRID CEILING * (UNIVERSAL MOUNT) <b>WT</b> - WHITE TRIM FLANGE <b>XTR</b> - TRIMLESS (MUD-IN DRY WALL) <b>FX</b> - FLANGELESS  *Universal mounting brackets used for all grid ceiling types only. See mounting section for details	<b>FL</b> - FLUSH <b>RG1</b> - 1" REGRESSED <b>RG2</b> - 2" REGRESSED <b>RG3</b> - 3" REGRESSED

OPTIONS	RUN TYPE
<b>DASY</b> - ASYMMETRIC LENS <sup>4</sup> (ROOM SIDE DISTRIBUTION) <b>EF</b> - 12" END FILLER (FOR ODD LENGTHS) <b>CP</b> - CHICAGO PLENUM <b>EMB</b> - EMERGENCY BATTERY * (INTEGRAL) <b>EMC</b> - EMERGENCY CIRCUIT  *Minimum 4' and maximum 6' section	<b>S</b> - ___' (STRAIGHT) * <b>L</b> - ___'X ___' (L-SHAPE) <b>U</b> - ___'X ___'X ___' (U-SHAPE) <b>R</b> - ___'X ___' (RECTANGLE/SQUARE)  *Individual units available from 2' to 8' Use "EF" (End Filler) options for continuous runs with odd lengths Example: 12'4" long fixture run specified as EF-S-12'

- <sup>1</sup> D250 (250LM/FT) not available in 2' and 3' lengths (Specify minimum DC400 when outputs lower than 500LM/FT are required)
- <sup>2</sup> 347 available in "DIM" 0-10V only (100-1%)
- <sup>3</sup> DALI-2 (Type 6) provided as standard. Please consult factory for DALI (Type 8) options
- <sup>4</sup> Asymmetric lens option only available with Flush and 1" Regressed lens position

**ILLUMINATED END FILLERS AND CORNERS**

Optional, 12" fully illuminated, telescoping end filler is designed to be easily cut in field. Suitable for straight, L-shape, and U-shape run lengths  
 Rectangular runs lengths are provided with "joiner" section fillers (x4)

**PERFORMANCE**

DELIVERED LUMENS	FLUSH		1" REGRESSED		2" REGRESSED		3" REGRESSED		FLUSH ASYMMETRIC		1" REGRESSED ASYMMETRIC	
	SYSTEM WATTS	EFFICACY (LPW)	SYSTEM WATTS	EFFICACY (LPW)	SYSTEM WATTS	EFFICACY (LPW)	SYSTEM WATTS	EFFICACY (LPW)	SYSTEM WATTS	EFFICACY (LPW)	SYSTEM WATTS	EFFICACY (LPW)
250	1.8	142	1.9	130	2.0	128	2.0	127	1.7	144	1.9	130
500	3.5	142	3.8	130	3.9	128	3.9	127	3.5	144	3.8	130
750	5.4	138	5.9	127	6.0	125	6.1	124	5.3	141	5.7	132
1000	7.4	135	8.1	124	8.2	122	8.3	121	7.3	138	7.8	128
1250	9.7	129	10.6	118	10.8	116	10.8	116	9.3	134	9.9	126
1500	11.8	127	12.9	117	13.1	115	13.2	114	11.3	132	11.9	126

DELIVERED LUMENS PER FOOT BASED ON 80+ CRI, 3500K  
Lumen output and actual wattage may vary +/- 5%

**LUMEN OUTPUT MULTIPLIERS**

80+ CRI COLOR TEMP		90+ CRI COLOR TEMP	
2700K	N/A	2700K	0.78
3000K	0.97	3000K	0.83
3500K	1.00	3500K	0.86
4000K	1.02	4000K	0.88

**HOUSING**

Extruded aluminum housing with 3.5" aperture  
Designed for continuous runs in various configurations  
12" fully illuminated end filler option is field cuttable for odd lengths  
Trim flange with power coated finish and 0.400" overlap  
Trimless model features a perforated galvanized mudding flange  
24-gauge LED reflector with high reflectance white finish  
Standard polyester powder coated matte white finish

**OPTICS**

Extruded, acrylic lens provides optimal performance and glare control  
High performance asymmetric lens provides room side distribution  
Lens option available in flush, 1", 2", and 3" regressed options

**LED SYSTEM**

Standard 80+ CRI. Optional 90+ CRI  
Color consistency <3 SDCM  
Available in 27K, 30K, 35K, and 40K  
R9 value of 56 for 90+CRI  
L90 > 60,000 hours

**ELECTRICAL**

Standard 0-10V, constant current drivers  
100-1% dimming range and >0.9 power factor  
Standard 120/277V universal voltage with several driver options  
Luminaires are pre-wired with factory installed quick connects and branch circuit wiring  
Integral drivers are easily accessible through luminaire aperture

**EMERGENCY**

Integral emergency battery (Minimum 4' and maximum 6' length)  
10W output for 90 minutes (+/- 350lm/ft at 80+ CRI for 4' section)  
Title 24 Certified  
Integral emergency battery accessible through fixture aperture  
Caution: Emergency Battery utilizes more than one power source and servicing should be performed by qualified personnel

**MOUNTING**

New construction housing suspended via 1/4" threaded rod or suspension cables (by others)  
Trim fixture designed for use in drywall, wood, and other architectural ceiling materials  
Trimless fixture designed for use in drywall, mud-in ceiling applications  
Flangeless fixture designed for use in wood ceilings  
Suitable for various grid ceiling applications (see mounting details)  
Standard mounting available in flush and regressed options up to 3"  
Fixture weight: +/- 5 lbs/ft. Consult 3G for modifications

**LISTING**

ETL listed and conforms to UL1598 standard  
Certified to CSA22.2 No.250.0.  
Rated for dry or damp locations

**WARRANTY**

5 Year Warranty on LED and drivers  
LED system rated for operation in ambient environments up to 25°C

**HARD CEILING (SHOWN WITH 2" REGRESSED LENS OPTION)**

**WT - TRIM**

**XTR - TRIMLESS**

**FX - FLANGELESS**

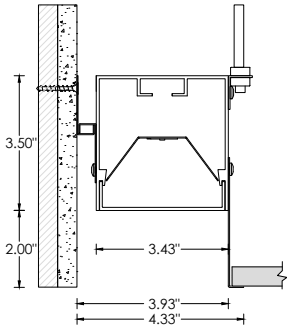

RECOMMENDED CEILING  
OPENING 4.10"

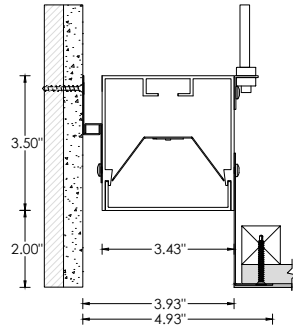

RECOMMENDED CEILING  
OPENING 4.25"

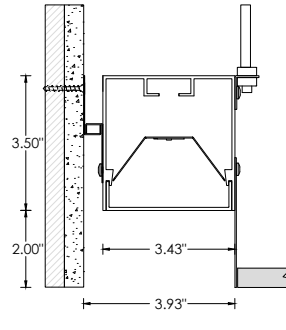

RECOMMENDED CEILING  
OPENING 4.00"

**GRID CEILING (SHOWN WITH 2" REGRESSED LENS OPTION)**

**9L - 9/16" LAYIN**

**9TG - 9/16" TEGULAR**

**9ST - 9/16" SLOT TEE  
TEGULAR**

**15TG - 15/16" TEGULAR**

**15L - 15/16" LAYIN**

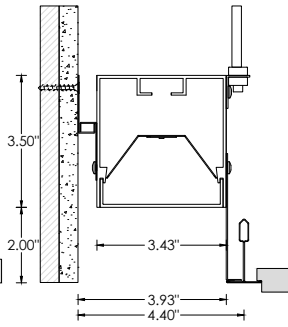
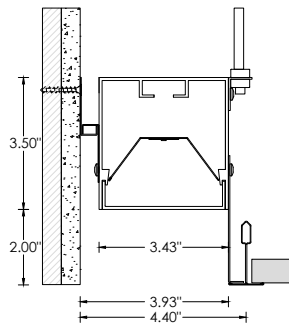
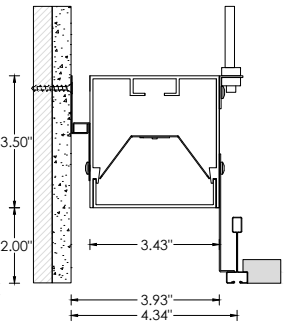
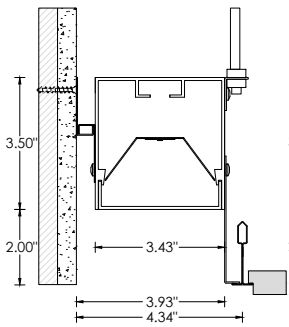
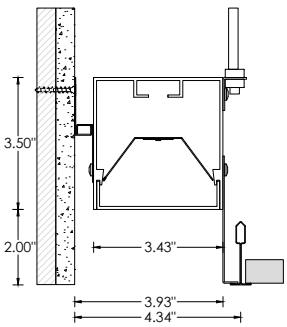

**LENS OPTION**

**FL - FLUSH**

**RG1 - 1" REGRESSED**

**RG2 - 2" REGRESSED**

**RG3 - 3" REGRESSED**

**FL - FLUSH  
ASYMMETRIC OPTIC  
ROOM SIDE**

**RG1 - 1" REGRESSED  
ASYMMETRIC OPTIC  
ROOM SIDE**

