

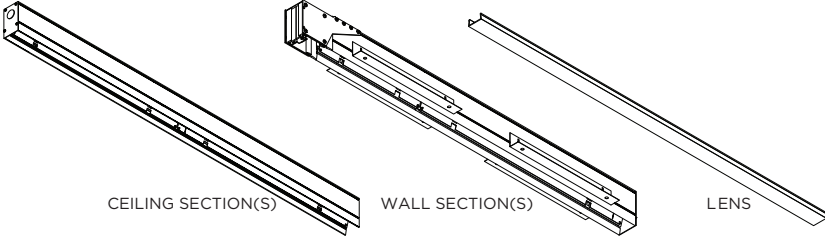

3G-2RLI-WC, and 3G-4RLI-WC
2", and 3.5" RECESSED LINIA WALL TO CEILING
GRID CEILING



⚠ FOR **NEW CONSTRUCTION** INSTALLATION ONLY
❗ THE IMAGES SHOWN ARE FOR ILLUSTRATION PURPOSES ONLY AND MAY NOT BE AN EXACT REPRESENTATION OF THE PRODUCT

FIXTURE TYPES		INCLUDED COMPONENTS
2RLI PROFILE	4RLI PROFILE	

INSTRUCTION KEY	INFORMATION
⚠ ADDITIONAL	INSTALLATION SHOULD ONLY BE PERFORMED BY A CERTIFIED ELECTRICIAN REFER TO LOCAL/NATIONAL CODES FOR PROPER INSTALLATION FAILURE TO FOLLOW INSTALLATION INSTRUCTION MAY VOID THE WARRANTY DO NOT TOUCH LEDS. LEDS MUST BE PROTECTED FROM MECHANICAL STRESS OR DEBRIS TURN OFF POWER DURING INSTALLATION OR SERVICING
❗ ATTENTION	
⚡ POWER ON	
⏻ POWER OFF	

OVERVIEW

3G-2RLI, 4RLI - GRID CEILING - GCX

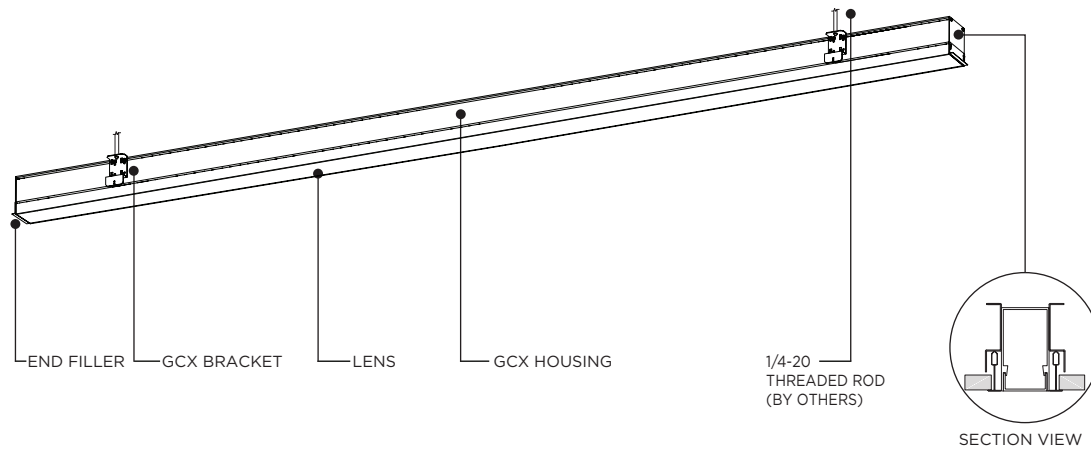

GRID CEILING - GCX - CEILING SECTION

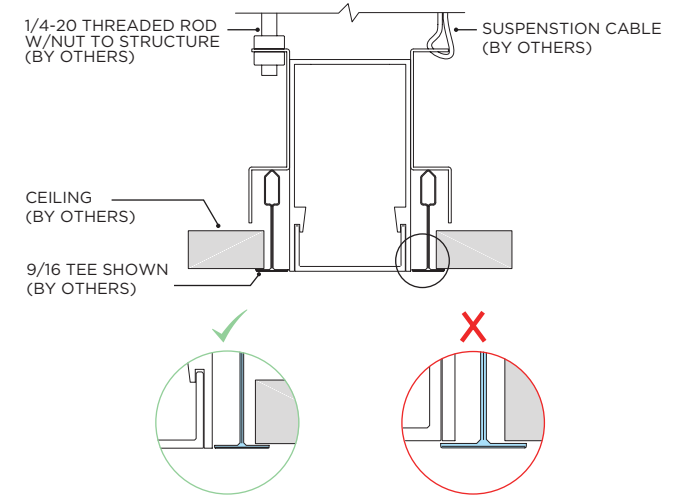

i FIXTURE EDGE MUST SIT ALONG SIDE TEE

3G-2RLI, 3G-4RLI MOUNTING BRACKET

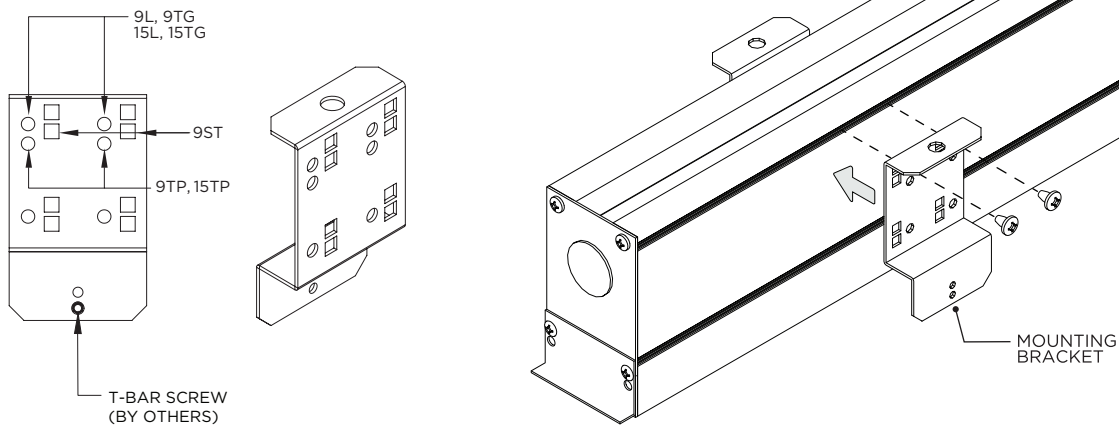

i UNIVERSAL MOUNTING BRACKET FOR ALL GRID CEILING TYPES

GRID CEILING - GCX - WALL SECTION

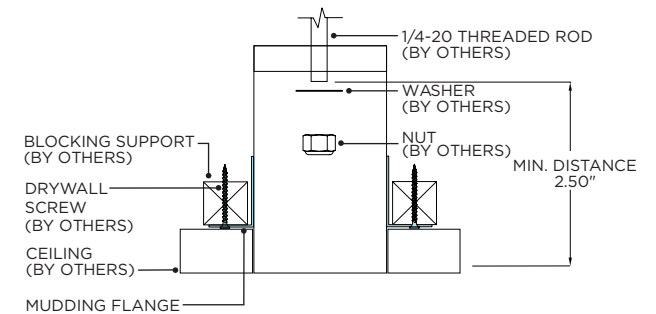

FLANGELESS - FX - CEILING CUT-OUT DIMENSIONS

FIXTURE TYPE	WIDTH	LENGTH
3G-2RLI	2.063"	LENGTH + 0.125"
3G-4RLI	3.490"	LENGTH + 0.125"

ASYMMETRIC LENS ORIENTATION

3G-2RLI-ASYMMETRIC LENS

ROOM SIDE DISTRIBUTION

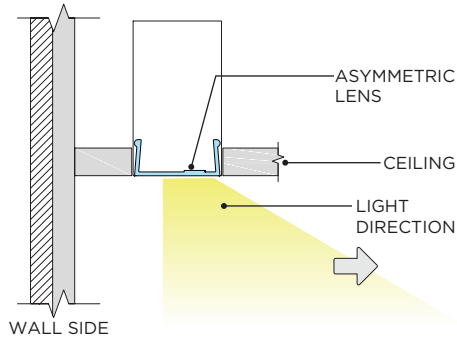

ASYMMETRIC LENS

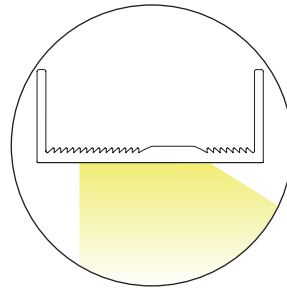

WALL GRAZING DISTRIBUTION

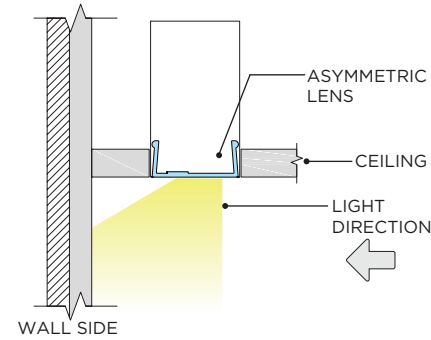

ASYMMETRIC LENS

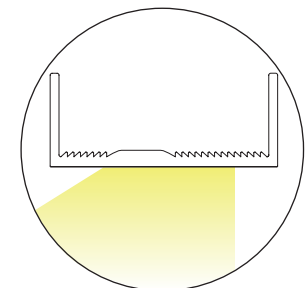

3G-4RI-ASYMMETRIC LENS/REFLECTOR ORIENTATION

ROOM SIDE DISTRIBUTION

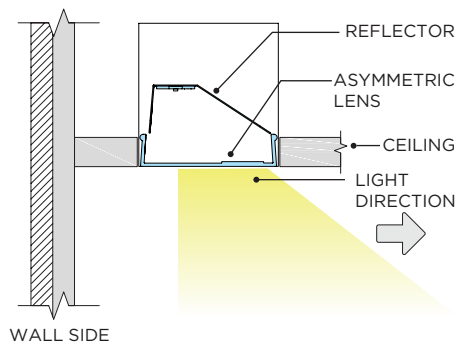

ASYMMETRIC LENS

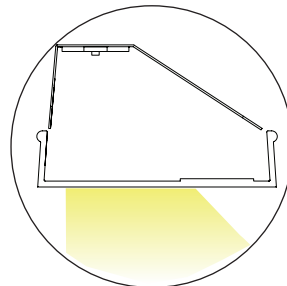

WALL GRAZING DISTRIBUTION

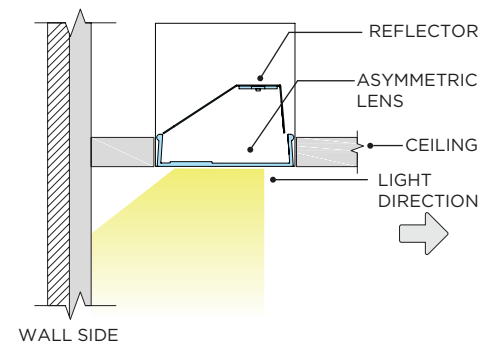

ASYMMETRIC LENS

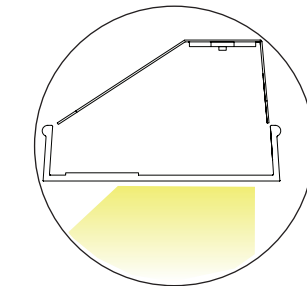

MOUNTING TYPES & T-BAR WIDTH

3G-2RLI-GCX

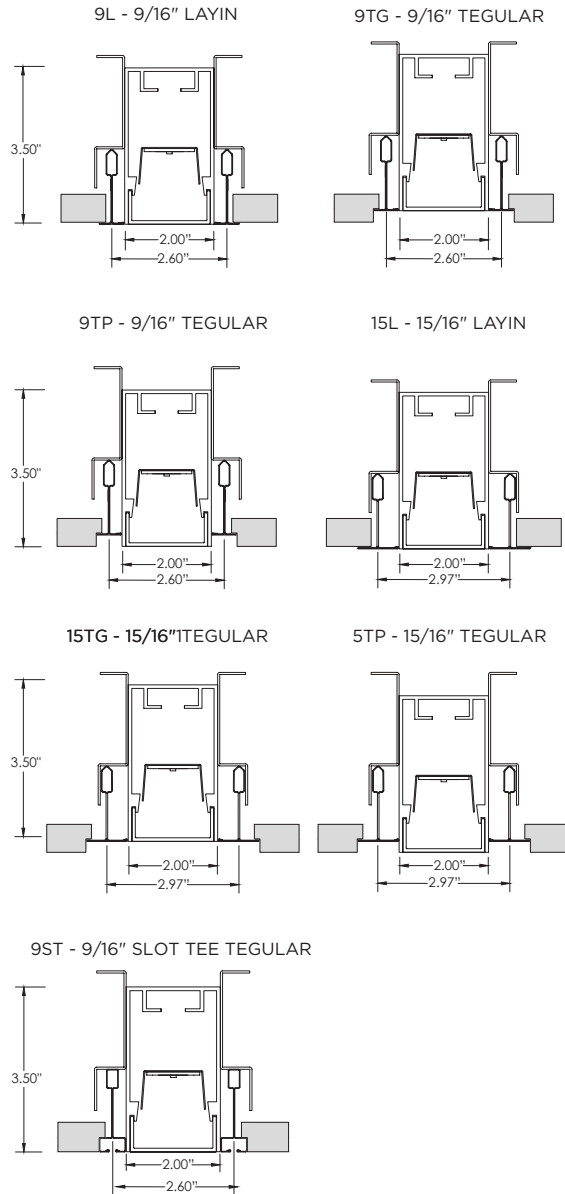

3G-4RLI-GCX

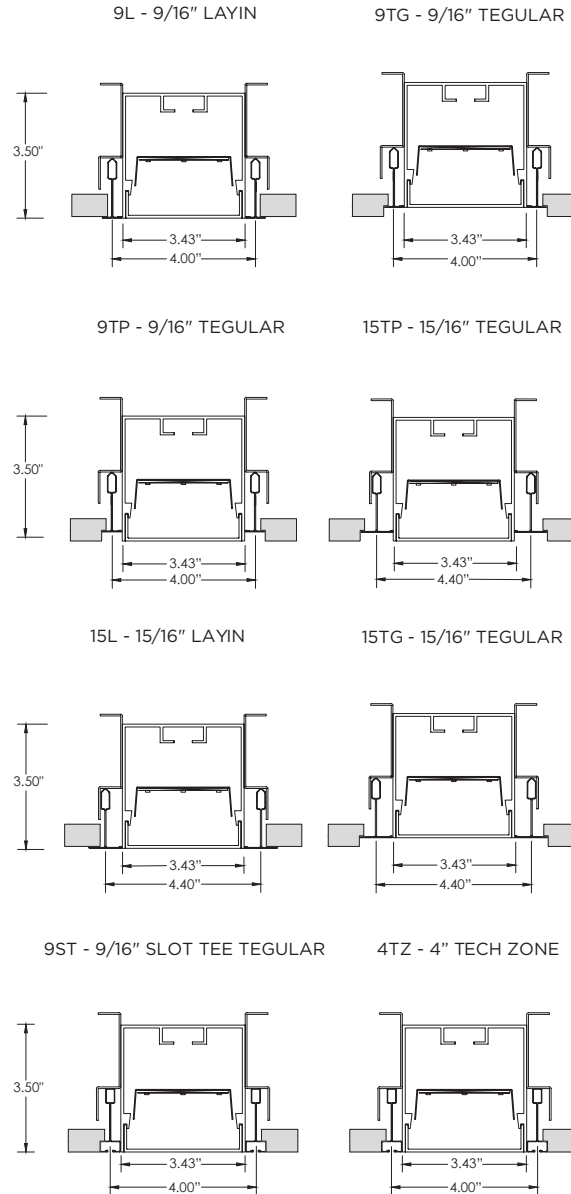

3G-2RLI, 3G-4RLI MOUNTING BRACKET LOCATION

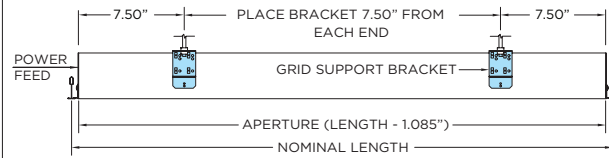

i APERTURE = (LENGTH - 1.085") APPLIED ONLY ON STARTER SECTION OR STANDALONE FIXTURE.

IDENTIFICATION AND PREPARATION

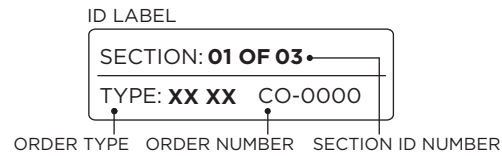

i IDENTIFY FIXTURE SECTIONS BY THE ID LABELS FOUND ON THE BOX INSIDE THE SECTIONS

ID LABEL

SECTION: **01 OF 03**
TYPE: **XX XX** CO-0000

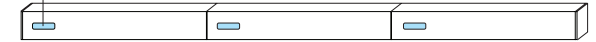

STARTER

JOINER

ENDER

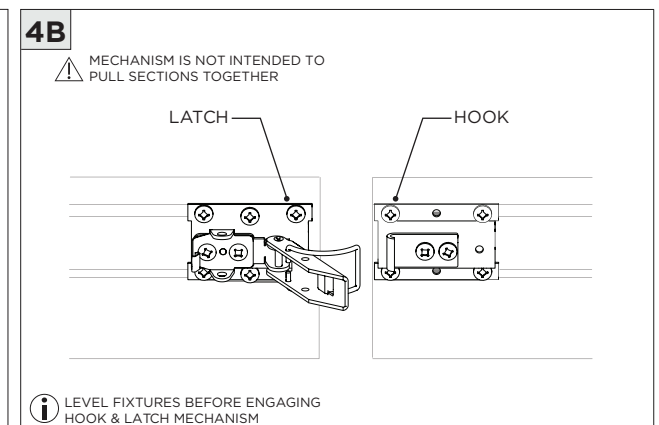
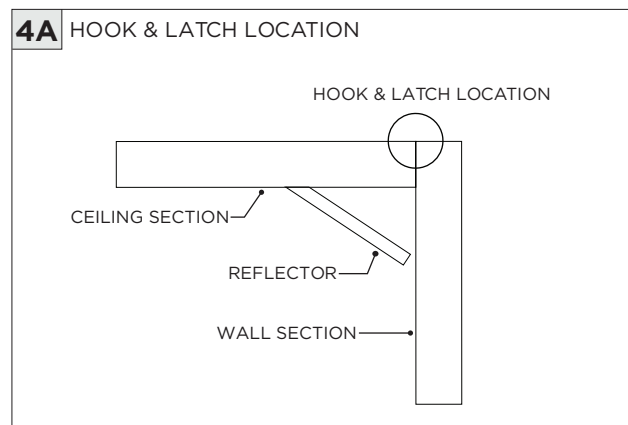
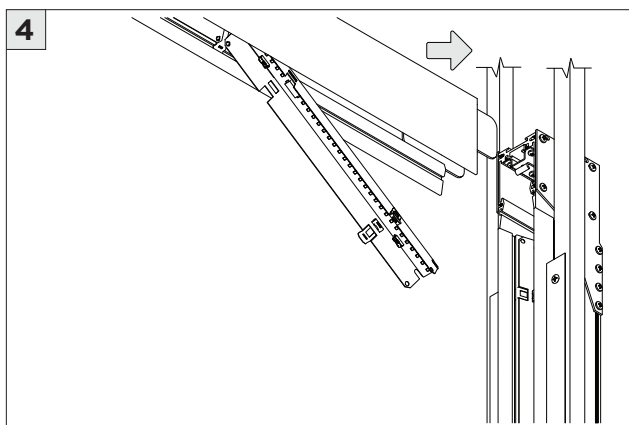
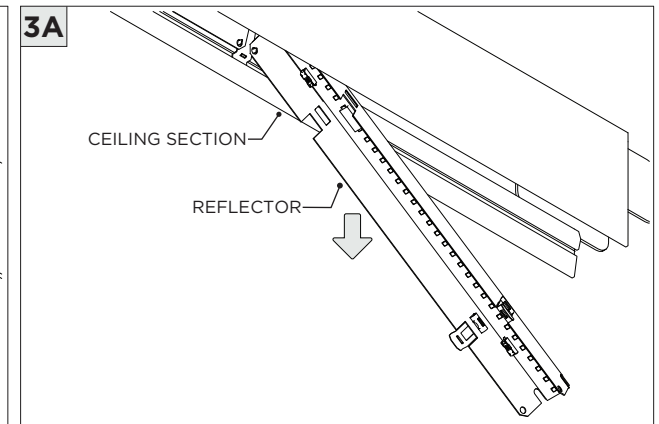
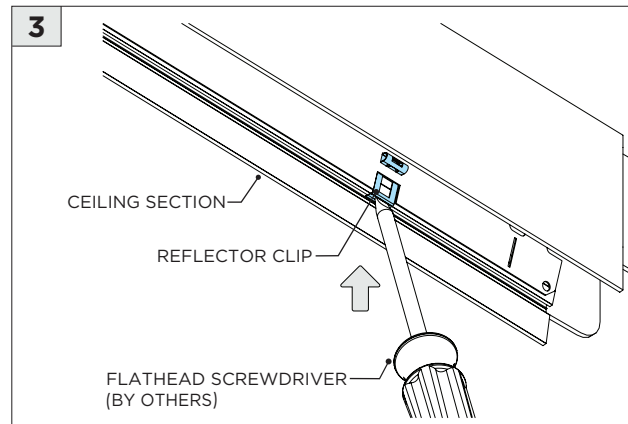
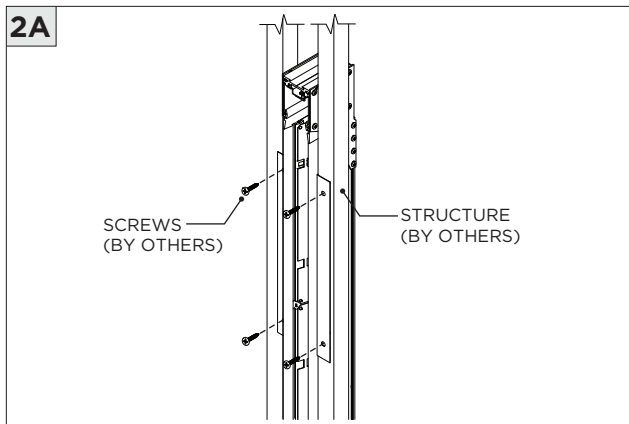
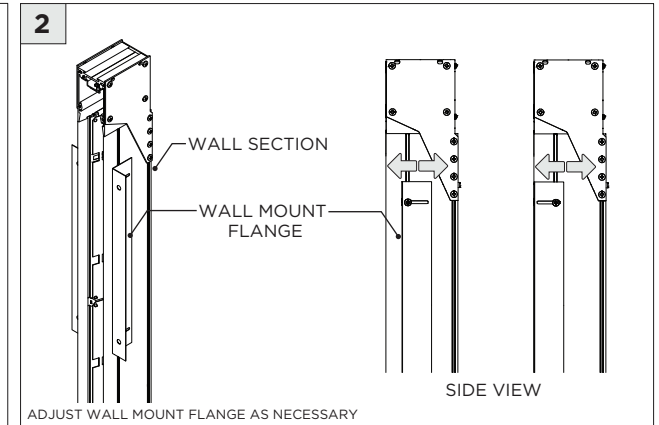
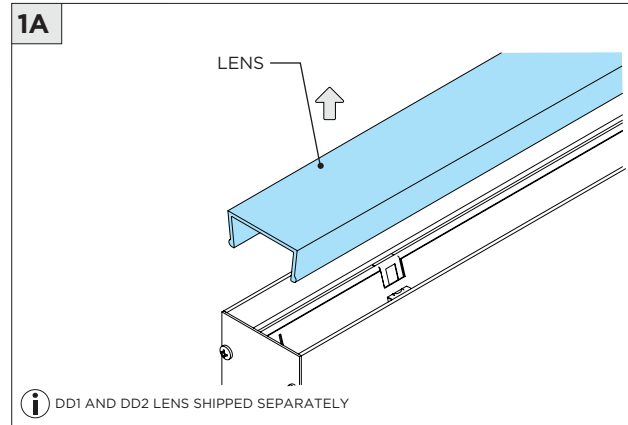
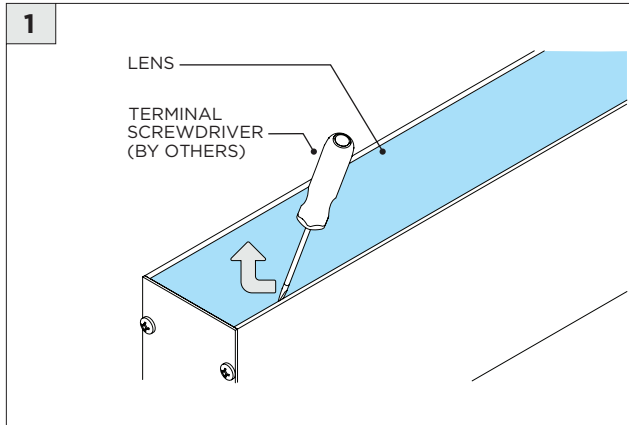

4C

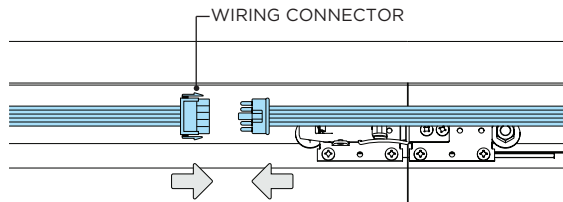

5

SECURE TO STRUCTURE

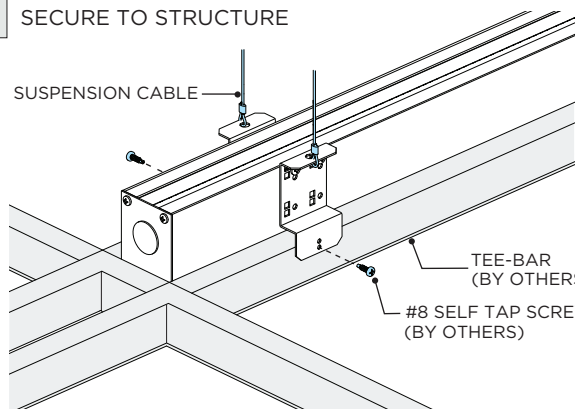

6

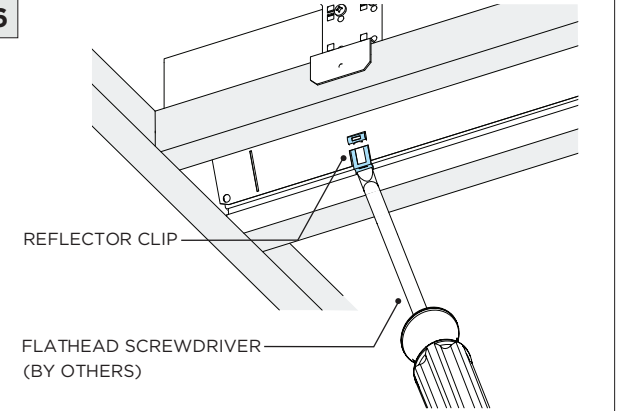

6A

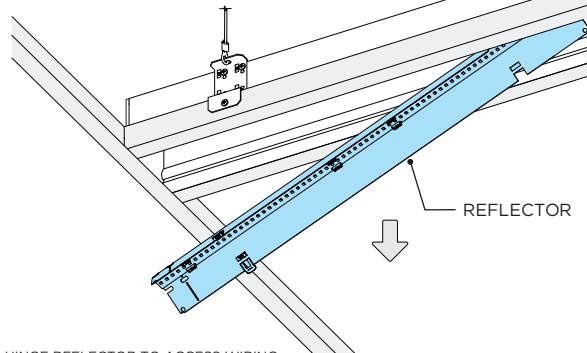

HINGE REFLECTOR TO ACCESS WIRING

7

WIRING LEGEND

BLACK	HOT/LINE
WHITE	NEUTRAL
GREEN	GROUND
ORANGE	(DIM+)
PURPLE	(DIM-)



CONNECT CONDUIT TO SECTION 01 OF THE FIXTURE

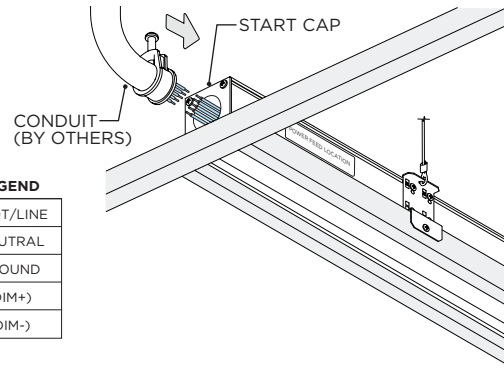

8

CONNECTING MULTIPLE SECTIONS

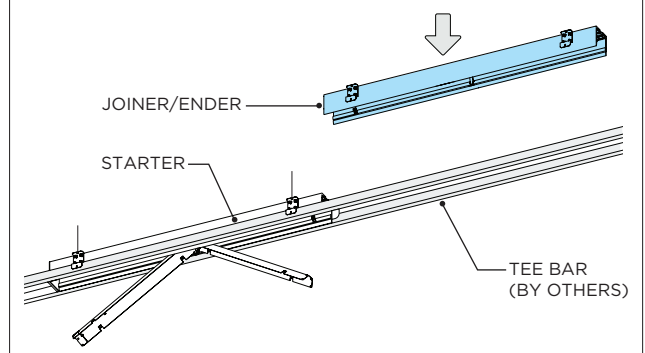

8A

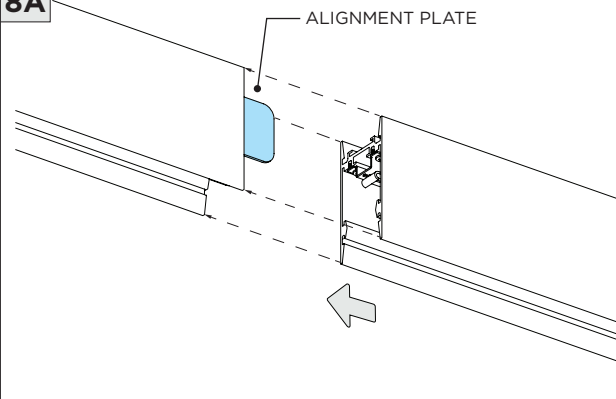

8B

HOOK & LATCH LOCATION

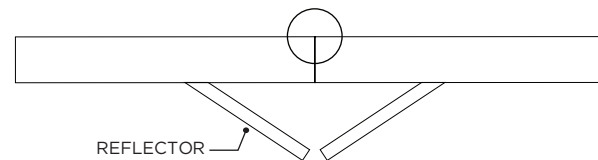

8C

⚠ MECHANISM IS NOT INTENDED TO PULL SECTIONS TOGETHER

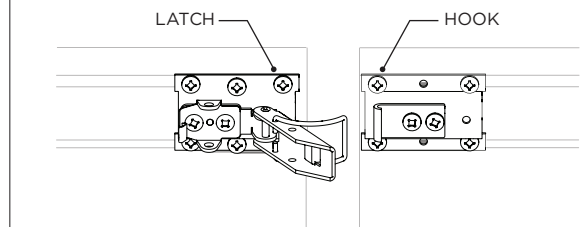

LEVEL FIXTURES BEFORE ENGAGING HOOK & LATCH MECHANISM

8D

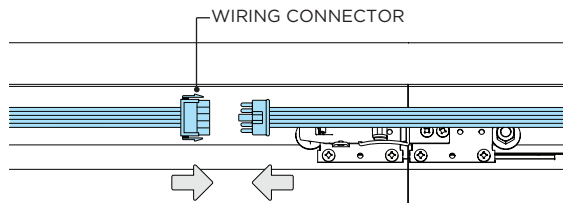

9

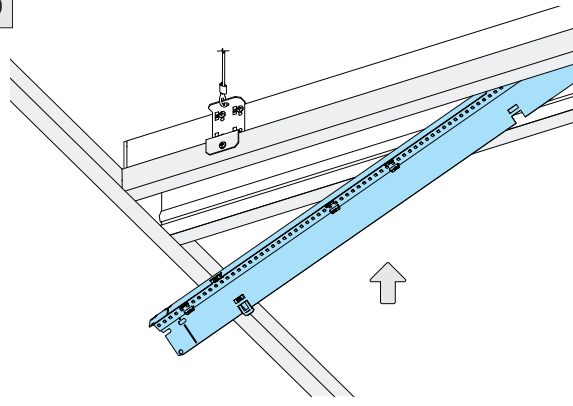

10

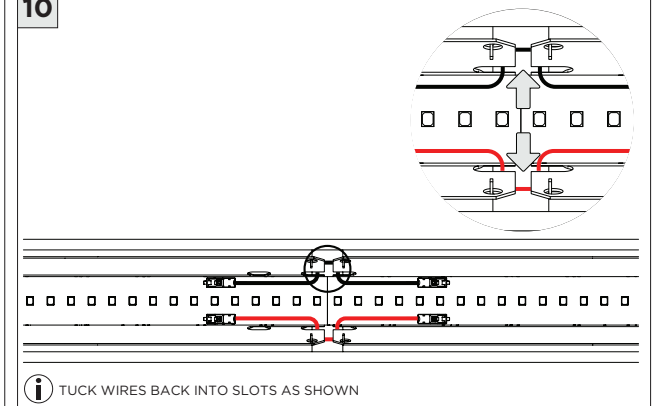

11

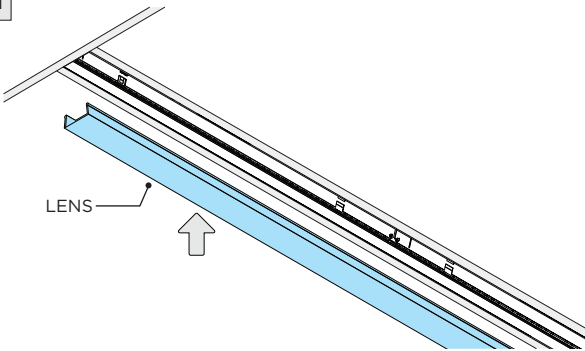

i FOR ASYMMETRIC LENS SEE ASYMMETRIC LENS ORIENTATION (PAGE 3)

DRIVER SERVICING

1 FLUSH LENS REMOVAL

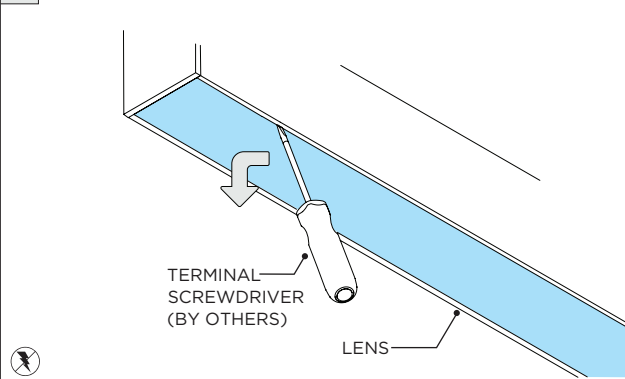

2

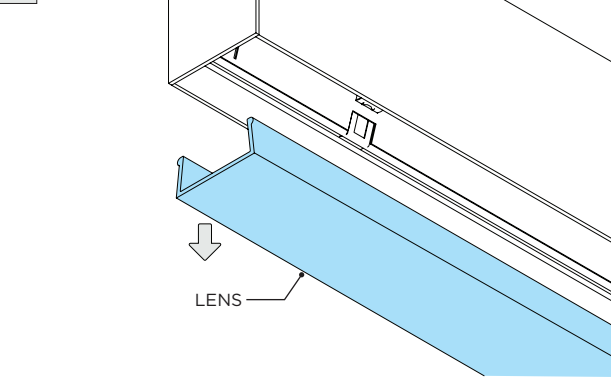

2A DROP LENS REMOVAL

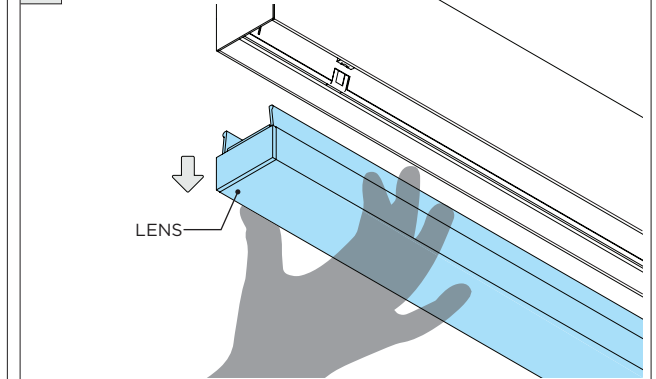

3

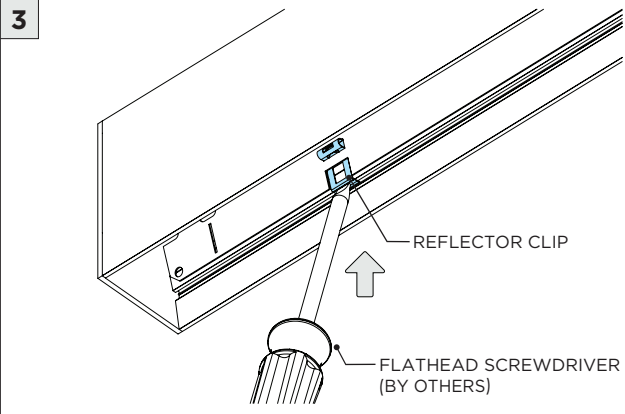

4

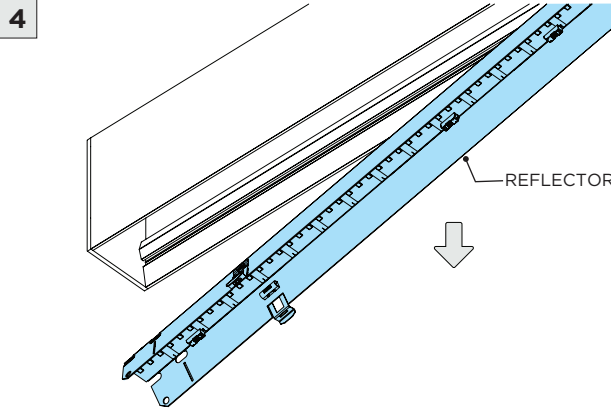

5

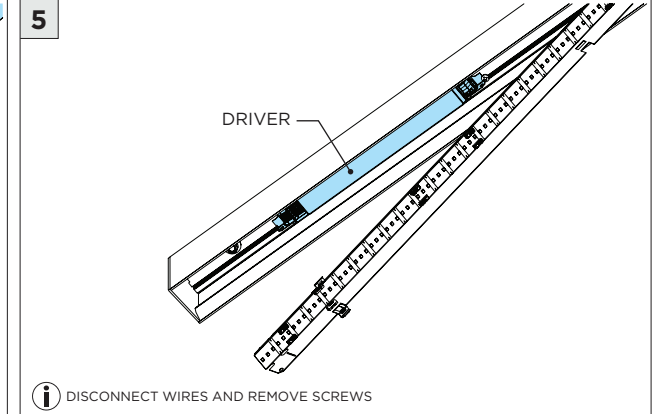

6

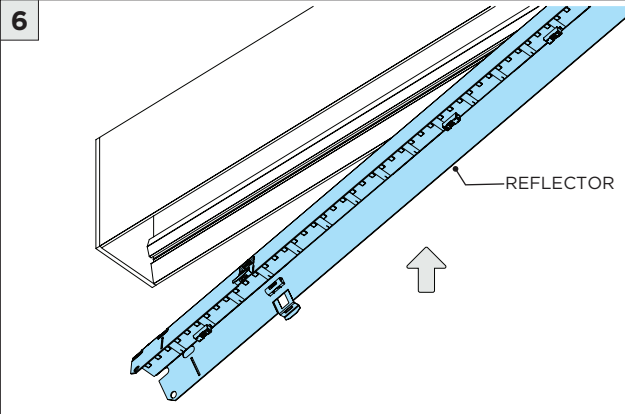

7

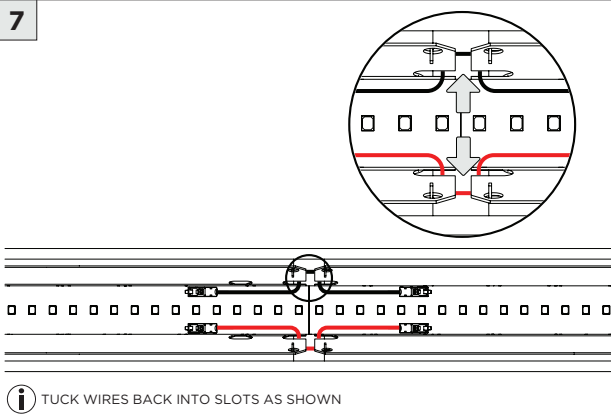

8

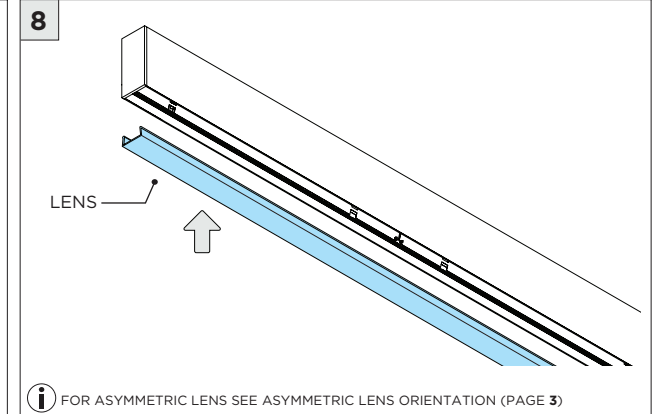

LED SERVICING

1 FLUSH LENS REMOVAL

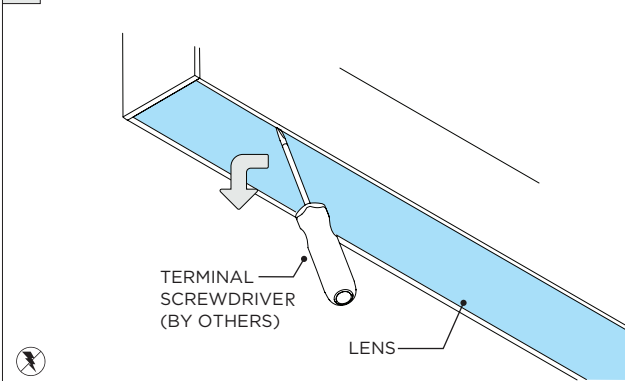

2

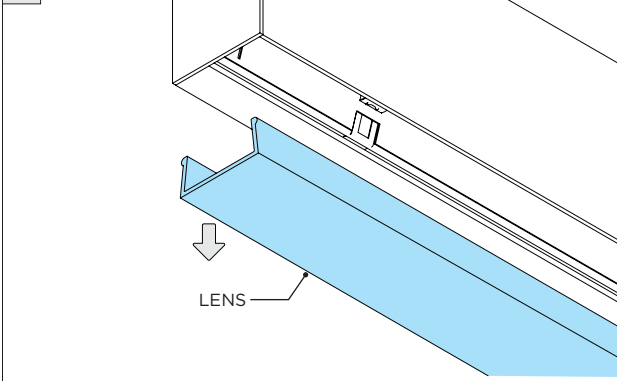

2A DROP LENS REMOVAL

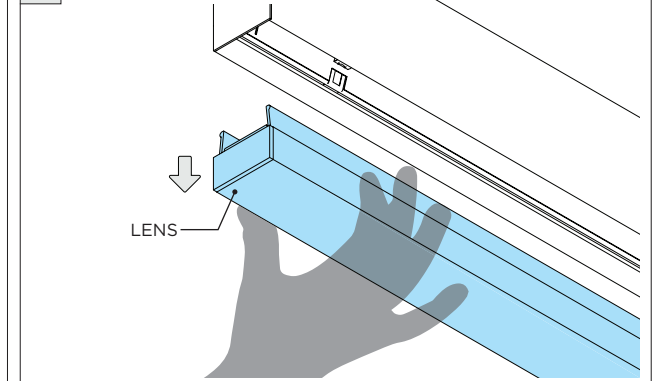

3

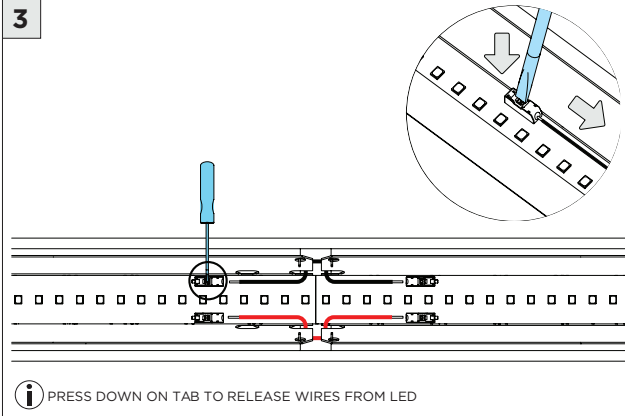

4

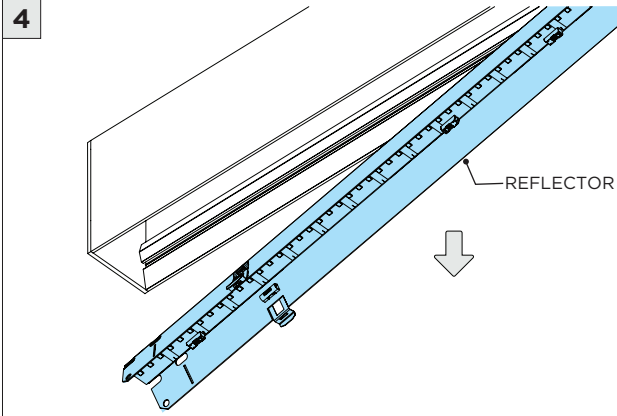

5

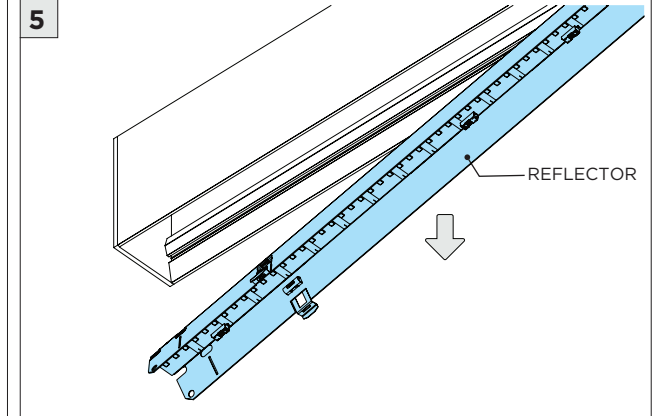

6

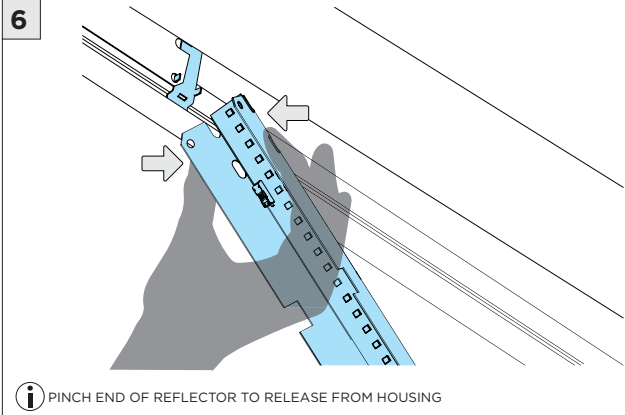

7

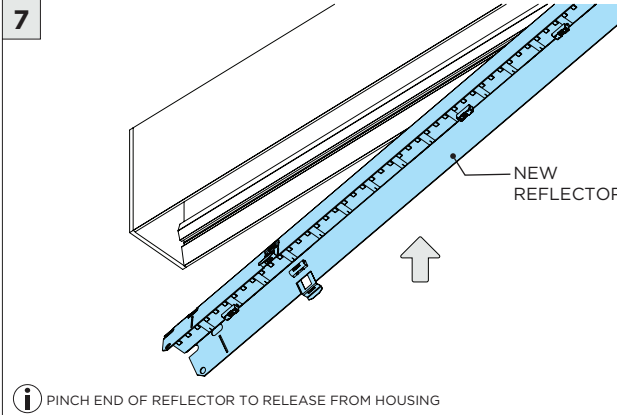

8

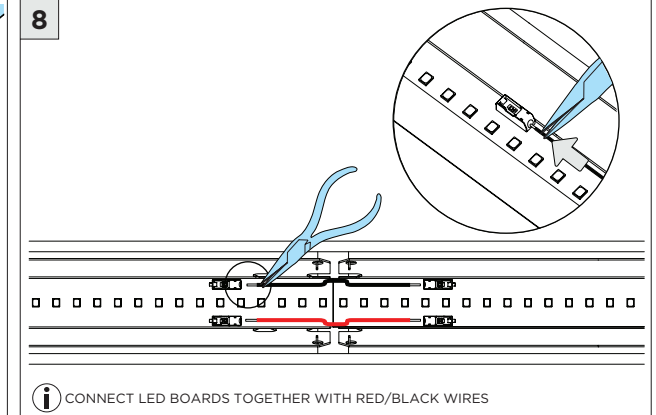

LED SERVICING

9

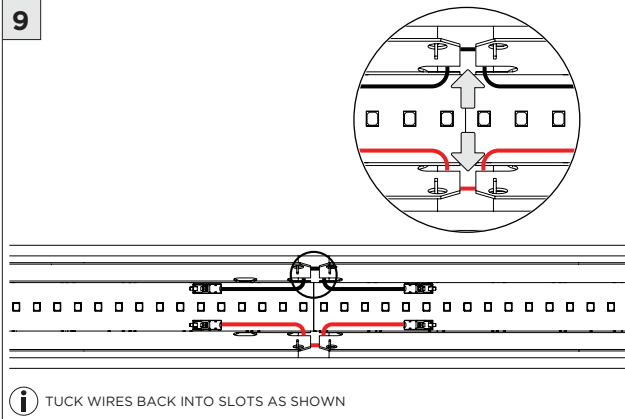

10

