

3G

LIGHTING

3G-1RLI

1.5" RECESSED LINIA

GRID CEILING



⚠ FOR **NEW CONSTRUCTION** INSTALLATION ONLY

FIXTURE TYPES	INCLUDED COMPONENTS
<div>1RLI PROFILE</div>	<div>Standalone Fixtures (2' to 8')</div> <div>INDIVIDUAL LENS</div>
<div>Continuous Runs (9' to 16')</div> <div>STARTER ENDER LENS</div>	<div>Continuous Runs (17' and longer)</div> <div>STARTER JOINER ENDER LENS</div>

INSTRUCTION KEY	INFORMATION
<div>⚠ ADDITIONAL</div> <div>ⓘ ATTENTION</div> <div>⚡ POWER ON</div> <div>⏻ POWER OFF</div>	<div>INSTALLATION SHOULD ONLY BE PERFORMED BY A CERTIFIED ELECTRICIAN</div> <div>REFER TO LOCAL/NATIONAL CODES FOR PROPER INSTALLATION</div> <div>FAILURE TO FOLLOW INSTALLATION INSTRUCTION MAY VOID THE WARRANTY</div> <div>DO NOT TOUCH LEDS. LEDS MUST BE PROTECTED FROM MECHANICAL STRESS OR DEBRIS</div> <div>TURN OFF POWER DURING INSTALLATION OR SERVICING</div>

OVERVIEW

3G-1RLI - GRID CEILING -GCX

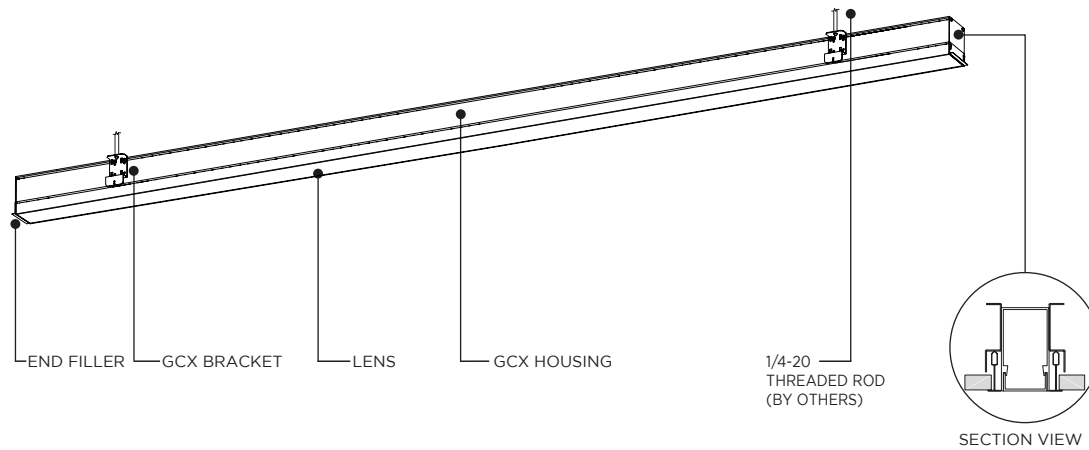

GRID CEILING FLANGE - GCX

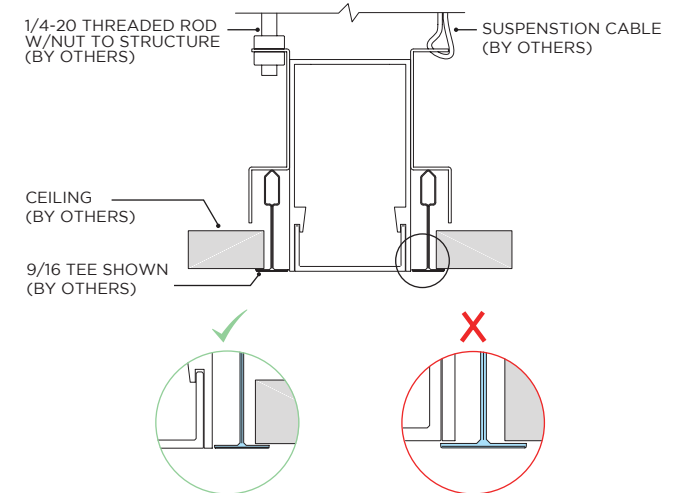

i FIXTURE EDGE MUST SIT ALONG SIDE TEE

3G-1RLI MOUNTING BRACKET

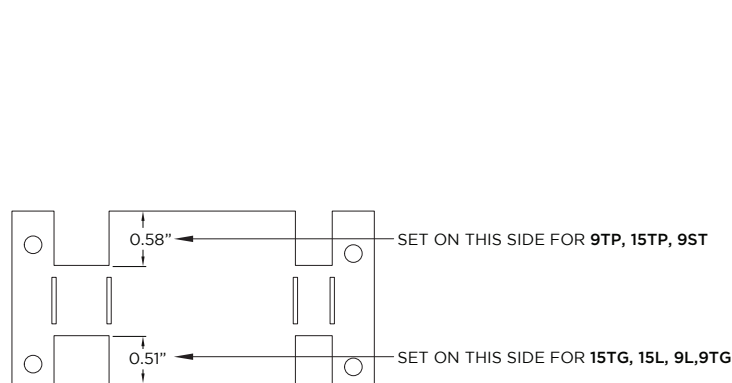

FOLD FOR 15" TEE BAR

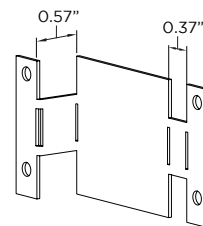

FOLD FOR 9" TEE BAR

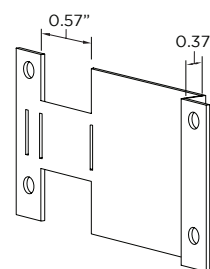

i UNIVERSAL MOUNTING BRACKET FOR ALL GRID CEILING TYPES

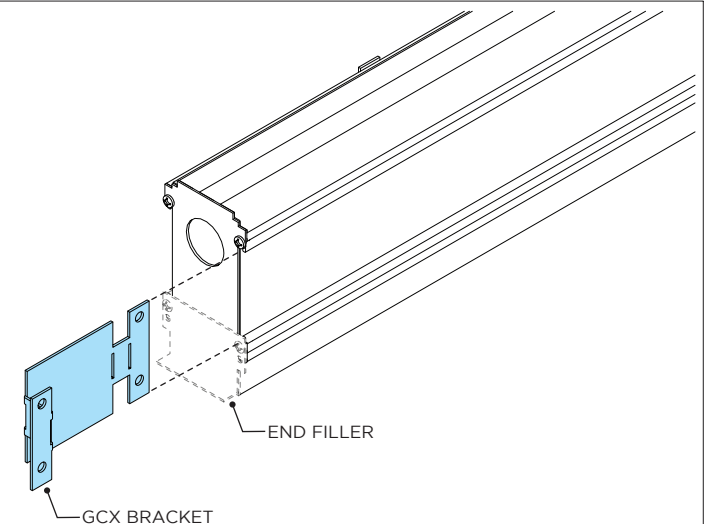

SLIDE GCX BRACKETS INTO HOUSING EXTRUSION

i FOR START/END SECTIONS, REMOVE END FILLER BEFORE GCX BRACKET INSTALLATION

ASYMMETRIC LENS ORIENTATION

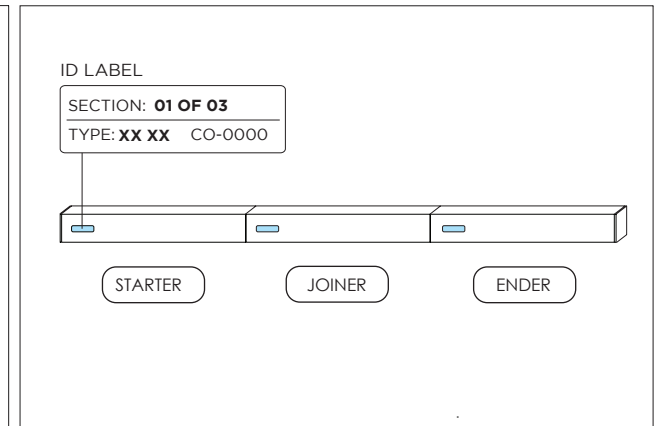
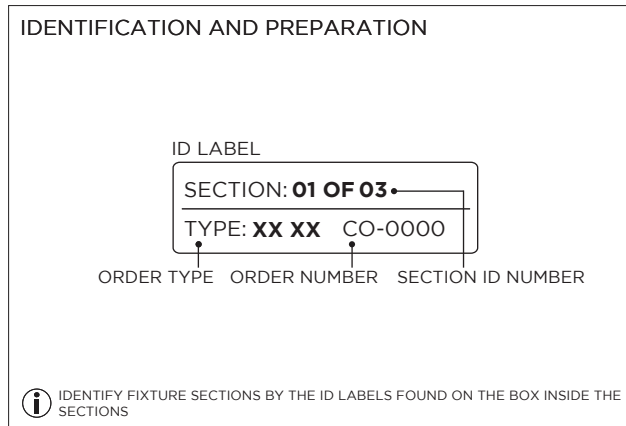
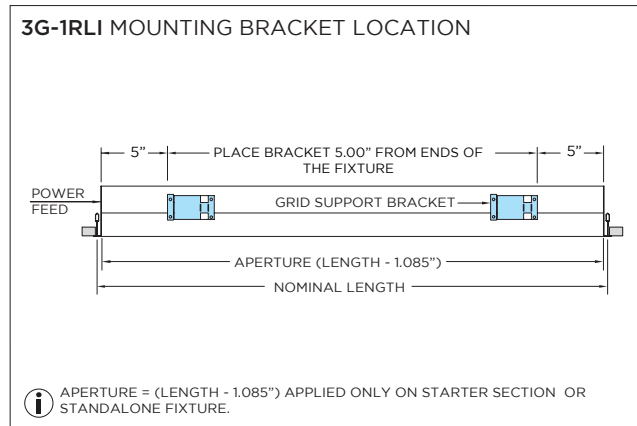
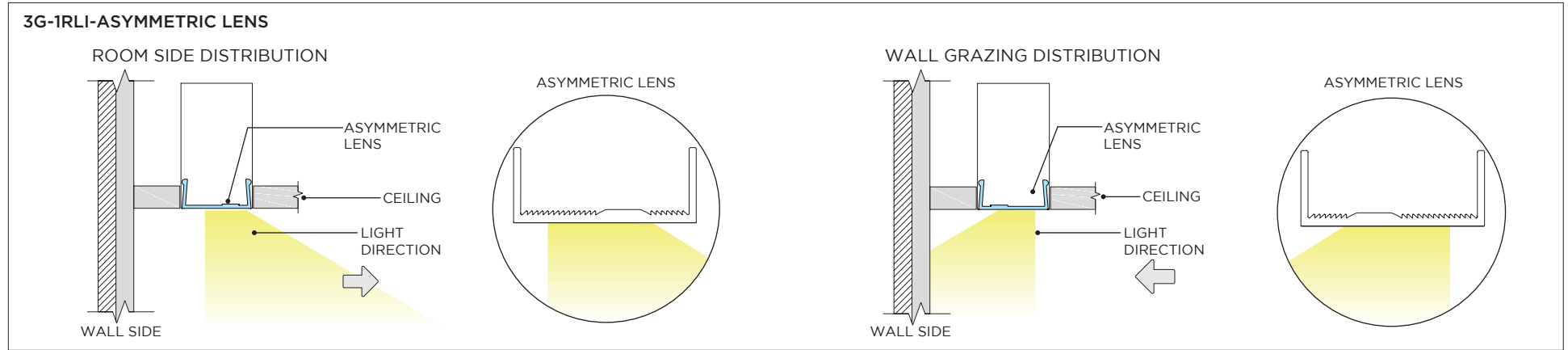

MOUNTING TYPES & T-BAR WIDTH

3G-1RLI-GCX

9L - 9/16" LAYIN

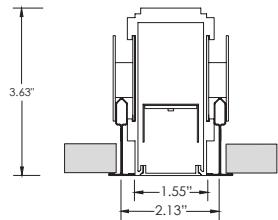

9TG - 9/16" TEGULAR

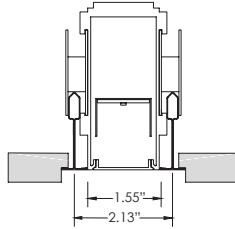

9TP - 9/16" TEGULAR

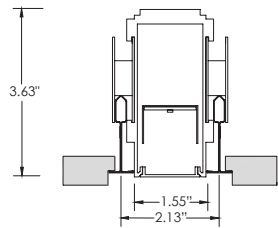

15L - 15/16" LAYIN

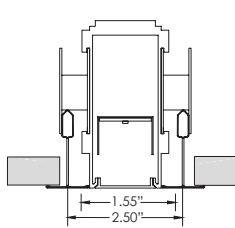

15TG - 15/16" TEGULAR

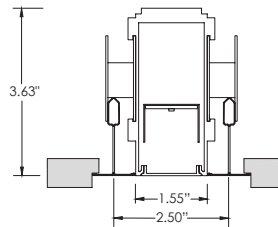

15TP - 15/16" TEGULAR

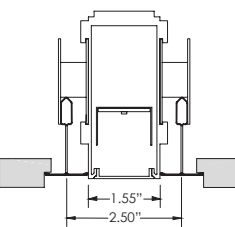

9ST - 9/16" SLOT TEE TEGULAR

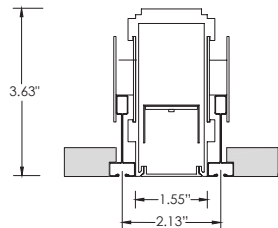

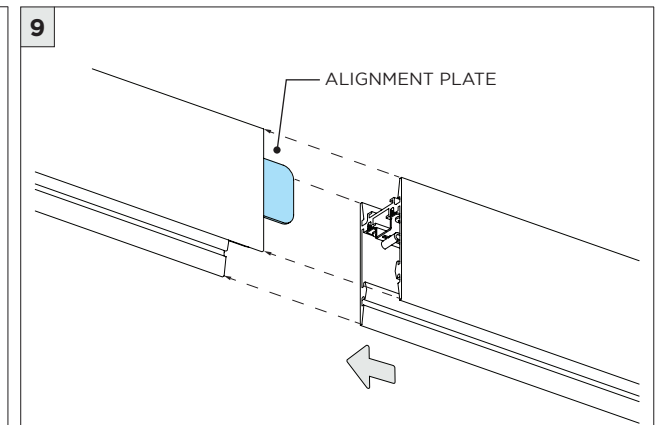
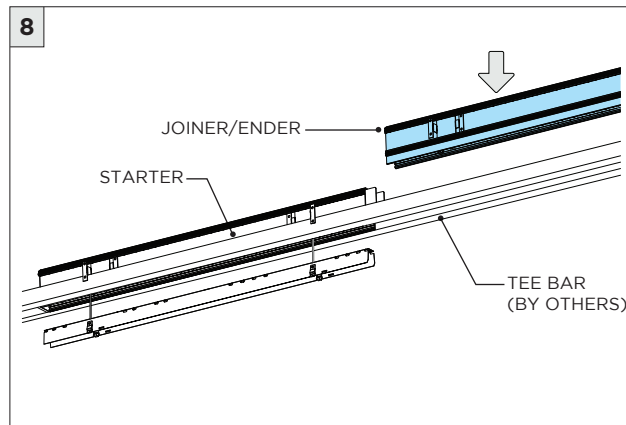
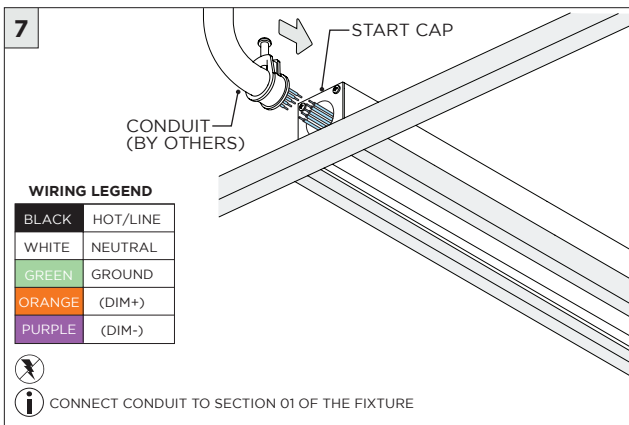
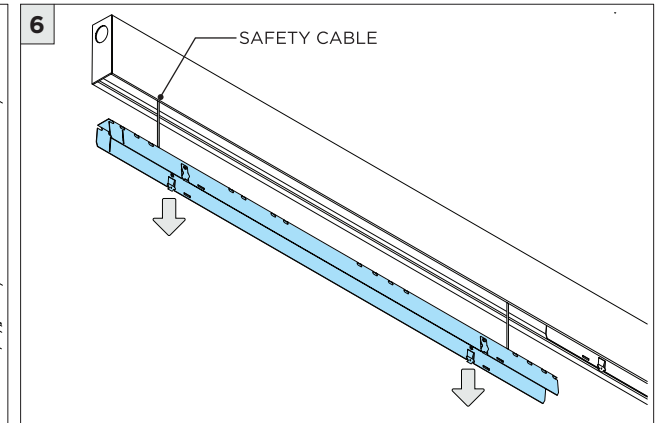
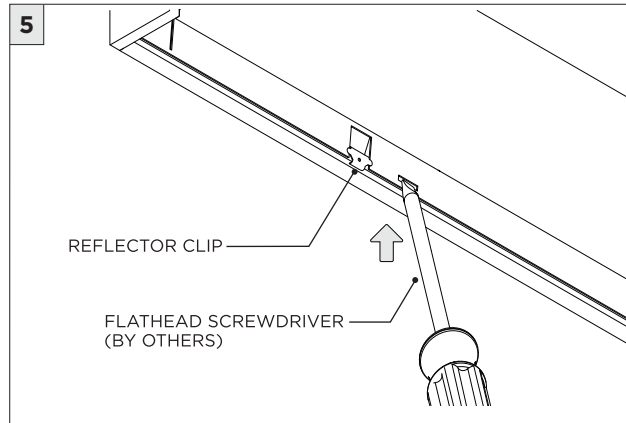
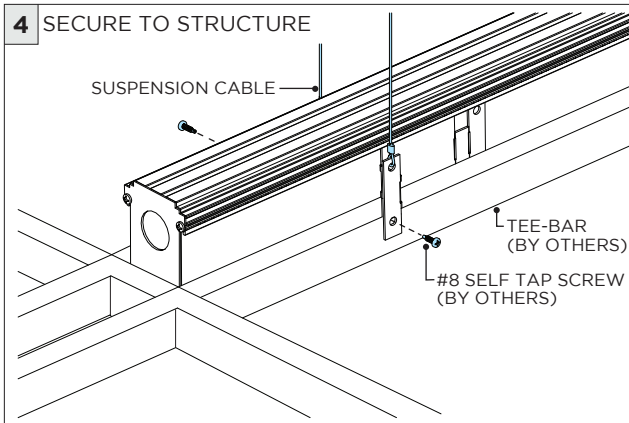
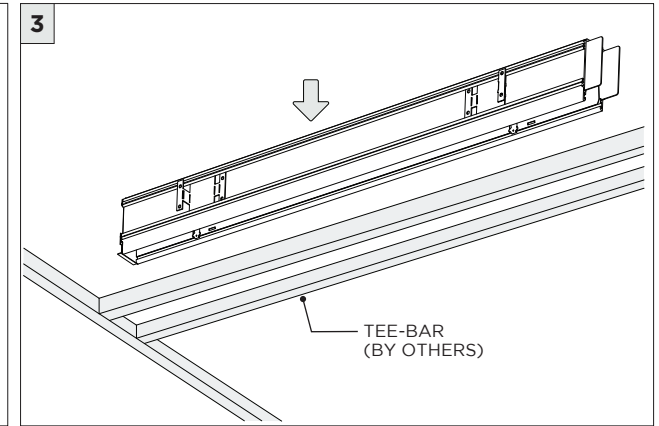
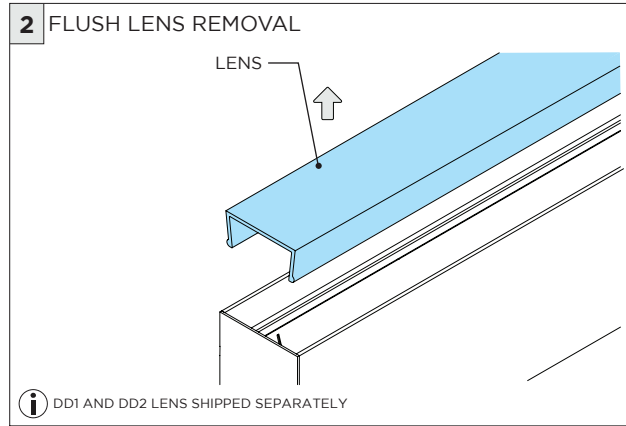
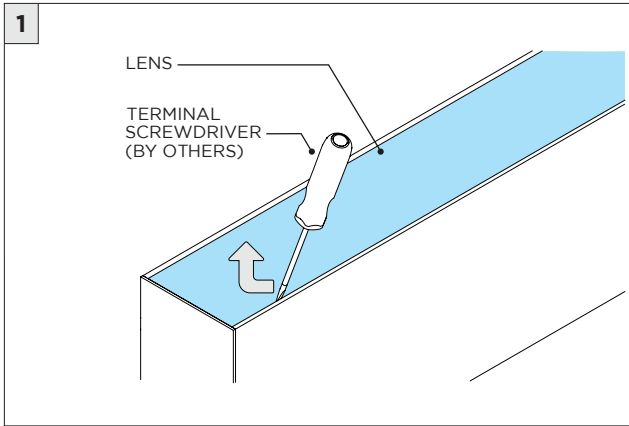

10

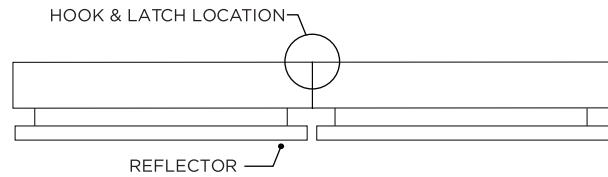

i REMOVE BOTH REFLECTORS TO ACCESS HOOK AND LATCH MECHANISM

11

⚠ MECHANISM IS NOT INTENDED TO
PULL SECTIONS TOGETHER

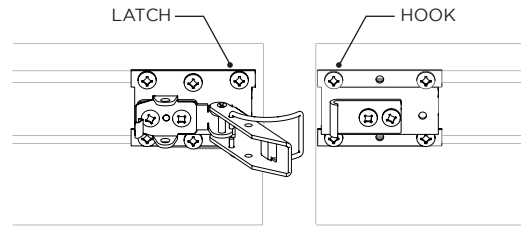

i LEVEL FIXTURES BEFORE ENGAGING
HOOK & LATCH MECHANISM

12

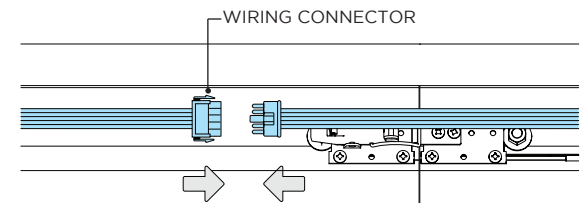

⊗

13

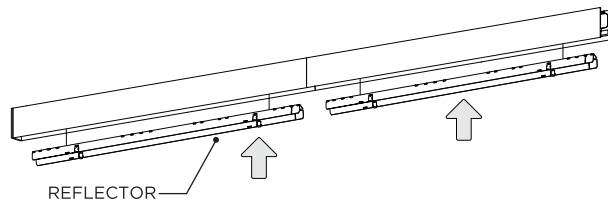

14

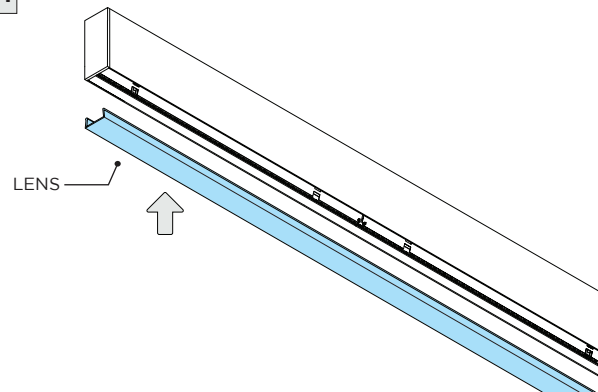

DRIVER SERVICING

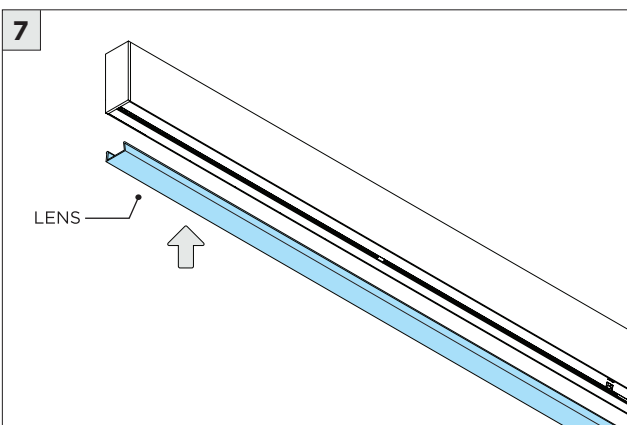
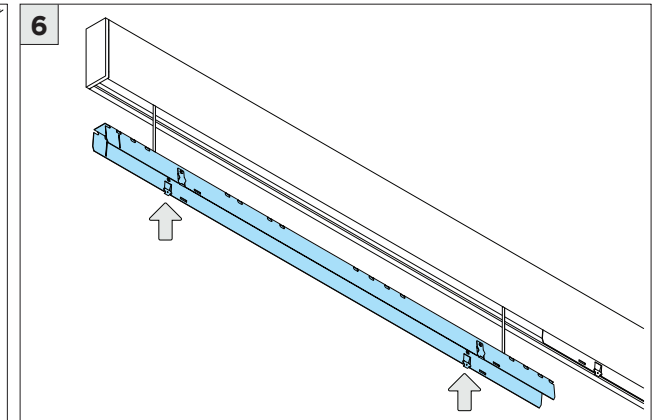
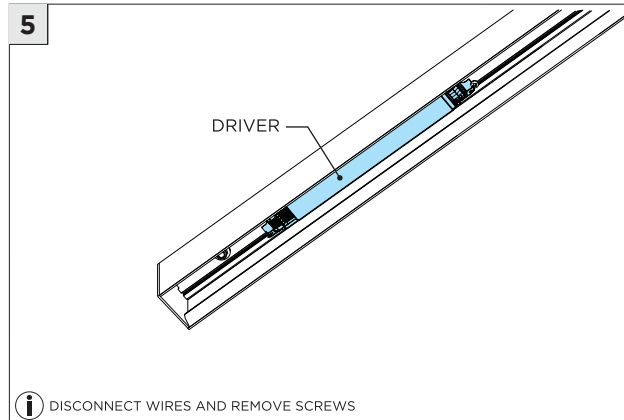
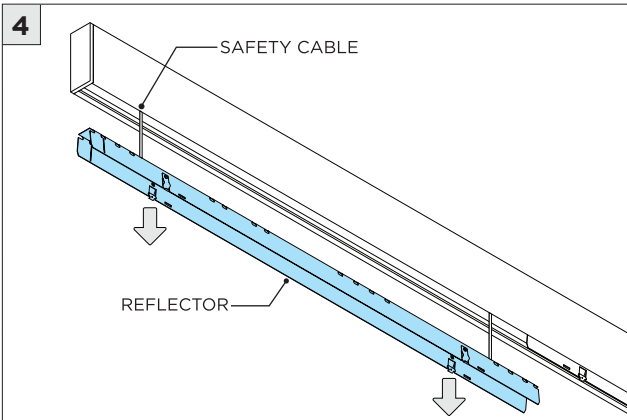
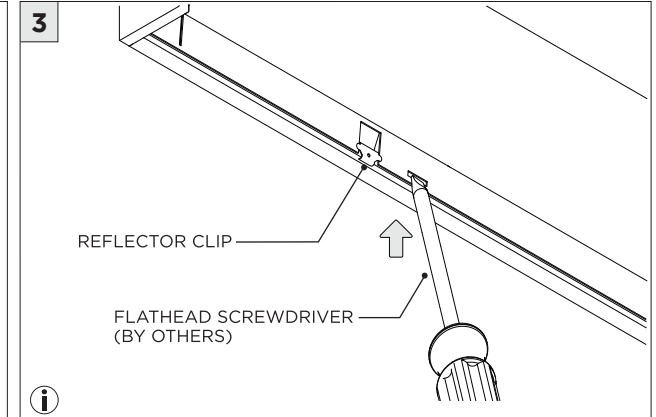
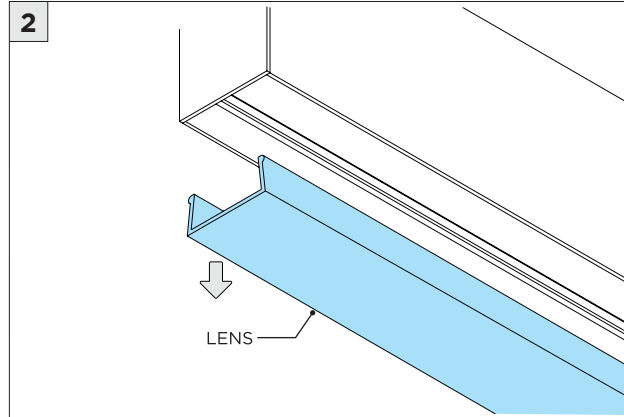
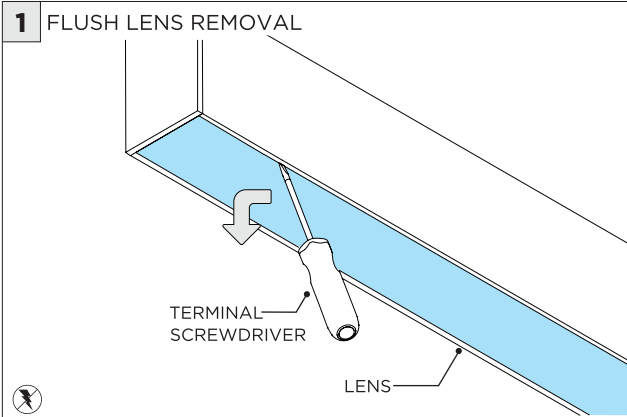

LED SERVICING - DIRECT

