

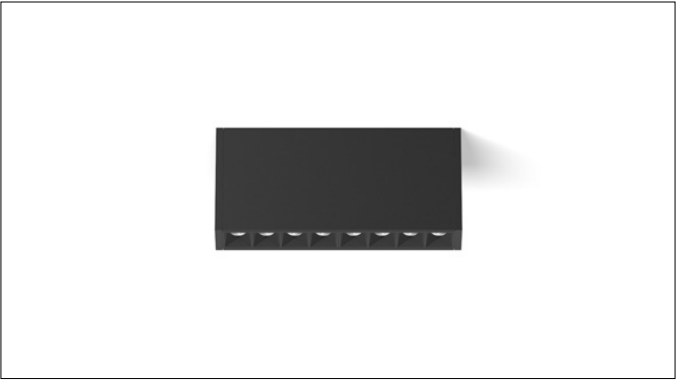

3G-SMZ8, 3G-SMZ12
SURFACE ZOIE



- ⚠ FOR **NEW CONSTRUCTION** INSTALLATION ONLY
- ℹ THE IMAGES SHOWN ARE FOR ILLUSTRATION PURPOSES ONLY AND MAY NOT BE AN EXACT REPRESENTATION OF THE PRODUCT

INCLUDED COMPONENTS

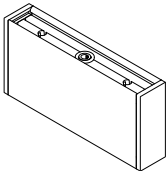

SURFACE ZOIE

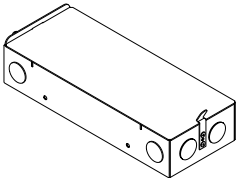

DRIVER ENCLOSURE
(IF APPLICABLE)

INSTRUCTION KEY	INFORMATION
⚠ ADDITIONAL	INSTALLATION SHOULD ONLY BE PERFORMED BY A CERTIFIED ELECTRICIAN
ℹ ATTENTION	REFER TO LOCAL/NATIONAL CODES FOR PROPER INSTALLATION
⚡ POWER ON	FAILURE TO FOLLOW INSTALLATION INSTRUCTION MAY VOID THE WARRANTY
🚫 POWER OFF	DO NOT TOUCH LEDS. LEDS MUST BE PROTECTED FROM MECHANICAL STRESS OR DEBRIS
	TURN OFF POWER DURING INSTALLATION OR SERVICING

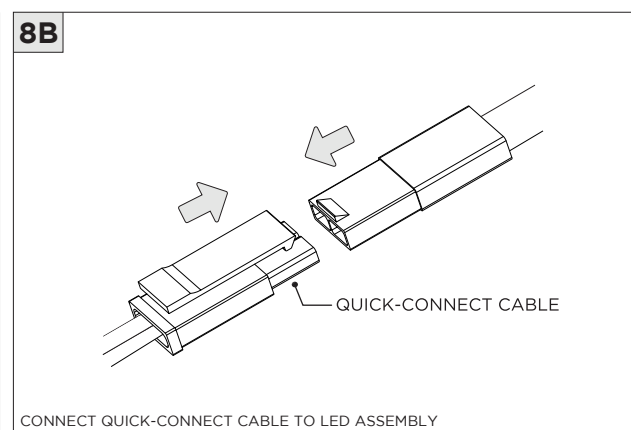
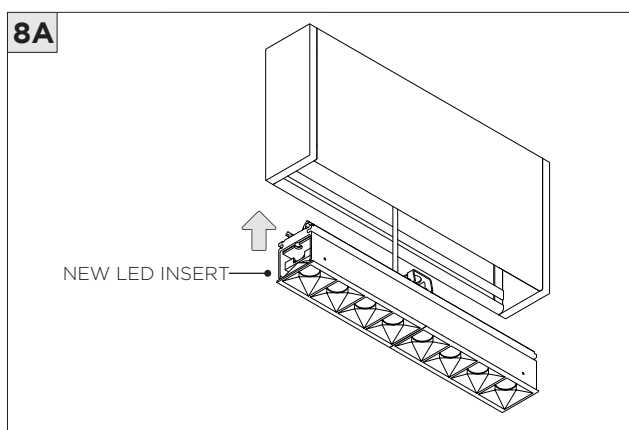
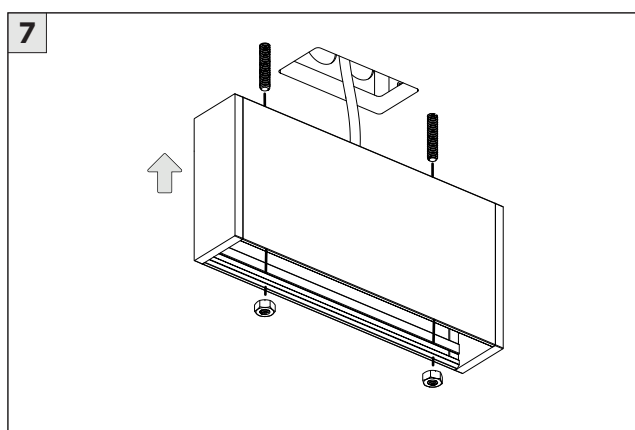
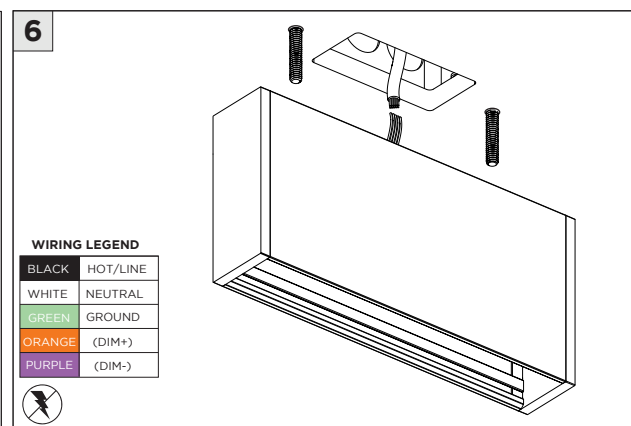
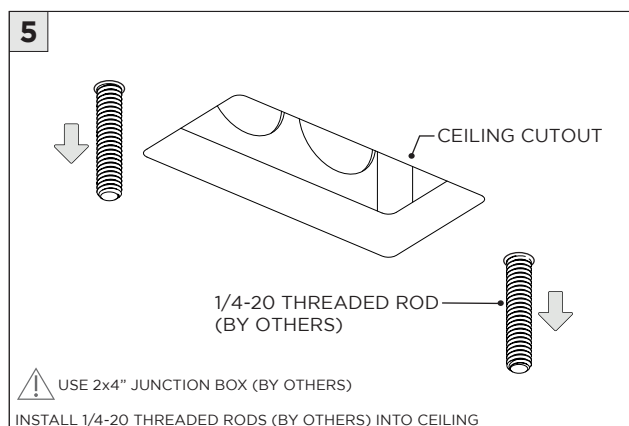
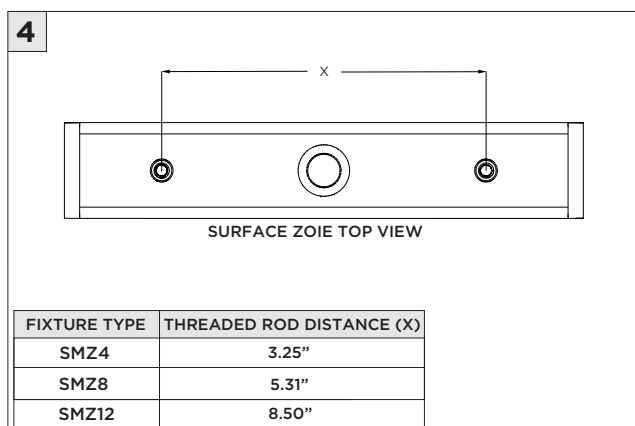
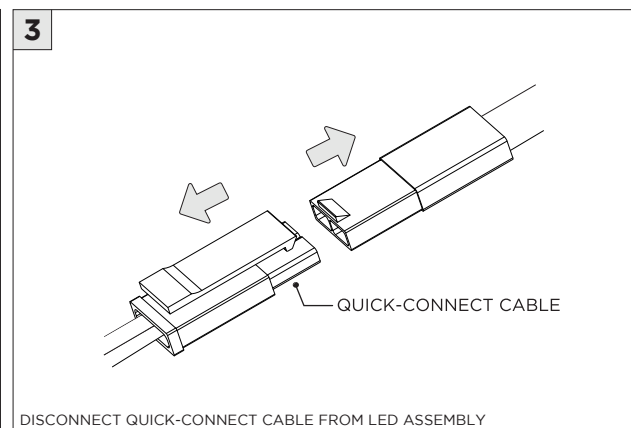
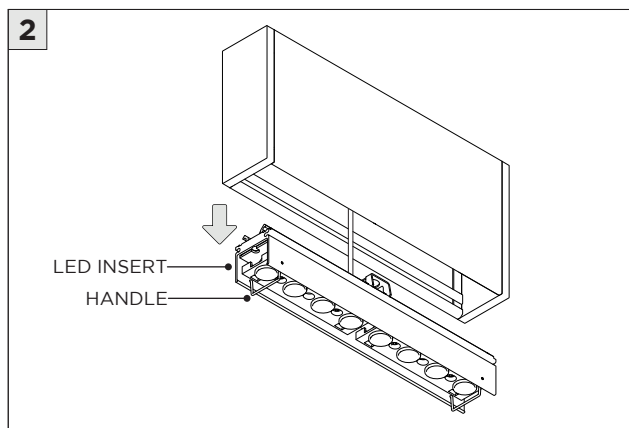
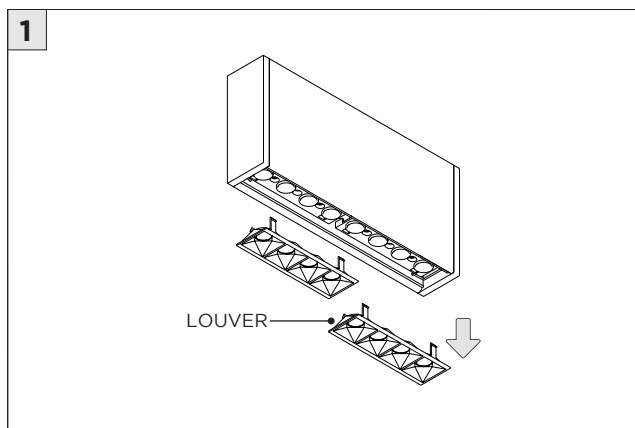

LED SERVICING

1

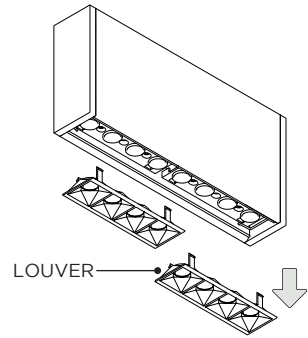

DISCONNECT POWER BEFORE SERVICING

2A

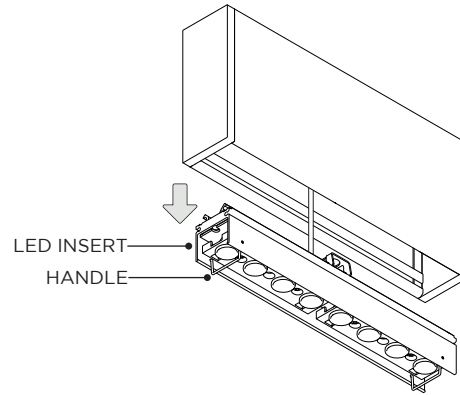

2B

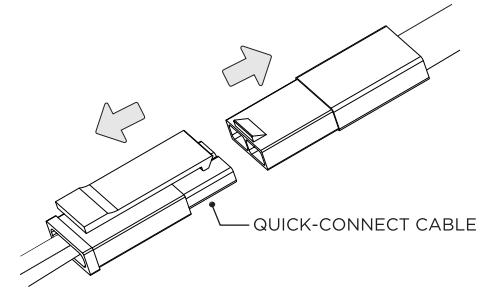

DISCONNECT QUICK-CONNECT CABLE FROM LED ASSEMBLY

3A

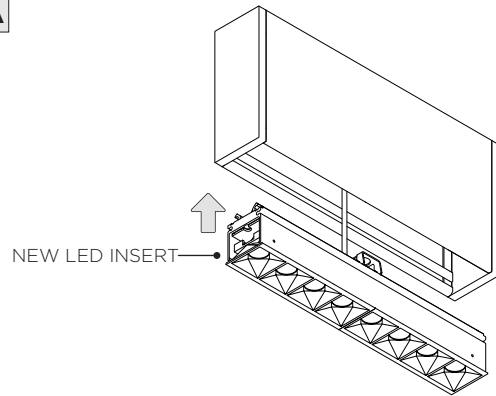

3B

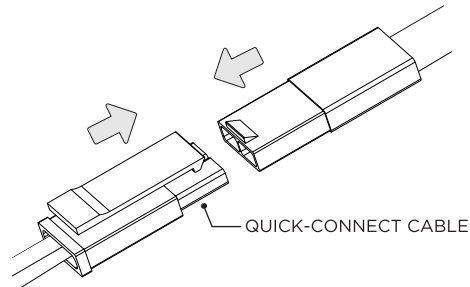

CONNECT QUICK-CONNECT CABLE TO LED ASSEMBLY

DRIVER SERVICING

1

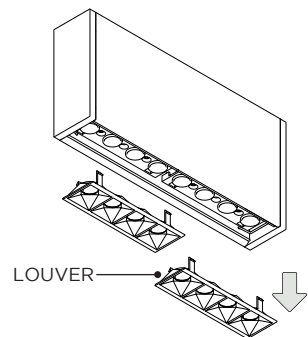

DISCONNECT POWER BEFORE SERVICING

2A

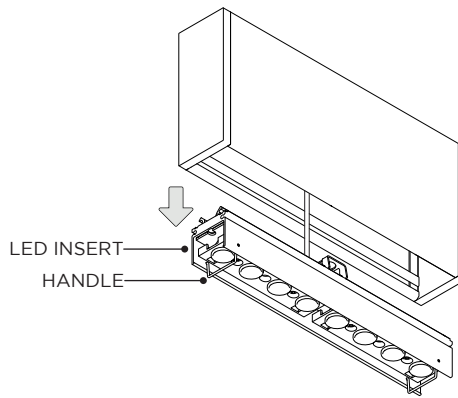

2B

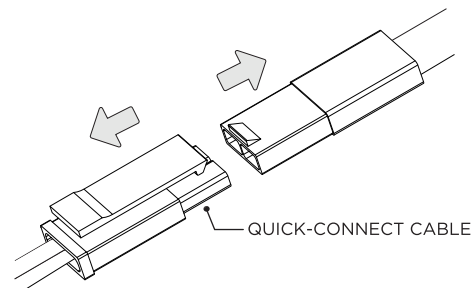

DISCONNECT QUICK-CONNECT CABLE FROM LED ASSEMBLY

3A

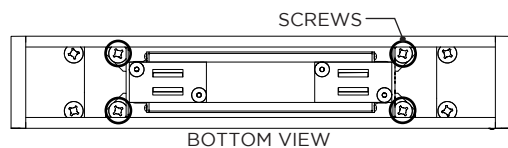

REMOVE 4 HIGHLIGHTED SCREWS

3B

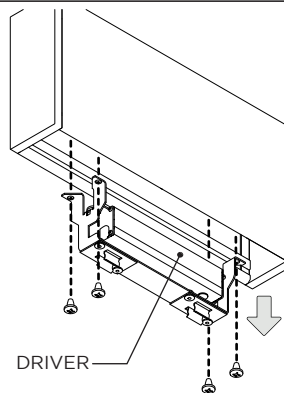

4

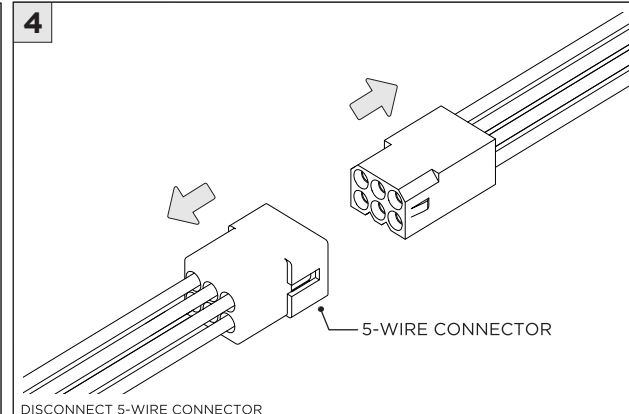

DISCONNECT 5-WIRE CONNECTOR