

# 3G LIGHTING

## 3G-SDZ33RA

3.3" ADJUSTABLE ZONE CYLINDER  
3", 7" AND 11" HEIGHT

3.3" diameter adjustable Zoie cylinder with 0-90° tilt and 360° rotation  
Companion to 3G-DZ33R Round Zoie Downlight  
Regressed LED source provides maximum visual comfort, UGR <10  
High gloss black or white louvers with proprietary optics and no glare  
Extruded aluminum housing with powder coated finish  
Lumen range from 1000lm to 2000lm (80+ and 90+ CRI options)  
100-1% dimming range standard with integral driver options



<b>PROJECT:</b>		<b>TYPE:</b>	
<b>CATALOG#:</b>		<b>DATE:</b>	<b>QTY:</b>

CAT. NO	FIXTURE HEIGHT	LUMEN OUTPUT	CRI	COLOR TEMP
<b>3G-SDZ33RA</b>	<b>3H</b> - 3" HEIGHT * <b>7H</b> - 7" HEIGHT * <b>11H</b> - 11" HEIGHT  <small>*3H &amp; 7H up to 1750lm (80+CRI)                      *3H &amp; 7H up to 1500lm (90+CRI)                      *3H &amp; 7H available with remote driver only (RDIM)</small>	<b>10</b> - 1000 LUMENS <b>15</b> - 1500 LUMENS <b>17</b> - 1750 LUMENS <b>20</b> - 2000 LUMENS  <small>Lumen outputs are delivered lumens based on 80+ CRI, 3000K source. See performance chart for all options</small>	<b>S80</b> - 80+ CRI <b>H90</b> - 90+ CRI	<b>27K</b> - 2700K <sup>1</sup> <b>30K</b> - 3000K <b>35K</b> - 3500K <b>40K</b> - 4000K <sup>1</sup>

BEAM ANGLE	VOLTAGE	DRIVER	HOUSING FINISH	LOUVER FINISH
<b>20D</b> - 20° <b>40D</b> - 40° <b>60D</b> - 60°	<b>UNV</b> - 120/277V <b>347</b> - 347V <sup>2</sup>	<b>DIM</b> - 0-10V (100-1%) <b>DO1</b> - 0-10V (100-0.1%) <b>DALI</b> - DALI (100-1%) <sup>3</sup> <b>DHL2</b> - LUTRON HI-LUME (1% ECOSYSTEM) <b>DMX</b> - DMX (100-0%) <b>RDIM</b> - REMOTE 0-10V (100-1%)	<b>BK</b> - BLACK TRIM <b>WH</b> - WHITE TRIM <b>SV</b> - SILVER TRIM	<b>BLV</b> - BLACK <b>WLV</b> - WHITE

OPTIONS
<b>CFB</b> - BLACK CONDUIT FEED CANOPY <b>CFW</b> - WHITE CONDUIT FEED CANOPY <b>CFS</b> - SILVER CONDUIT FEED CANOPY <b>FXC</b> - SEAMLESS CANOPY OPTION * <b>EMR</b> - EMERGENCY BATTERY (REMOTE) <sup>4</sup>  <small>*Seamless canopy mount (FXC) must be installed prior to ceiling installation.</small>

1 2700K only available in 90CRI and 4000K only available in 80CRI  
 2 347 available in "DIM" 0-10V only (100-1%). Not available with 3" height and 7" height  
 3 DALI-2 (Type 6) provided as standard. Consult factory for DALI Type 8 option  
 4 Emergency battery installed remotely by others. Not accessible through the inside of the fixture

**PERFORMANCE**

LUMEN OUTPUT	DELIVERED LUMENS	SYSTEM WATTS	EFFICACY (LPW)
1000	1000	8.4	122.4
1500	1500	13.2	117.4
1750	1750	15.4	116.8
2000	2000	18.4	111.7

BASED ON 80+ CRI, 3000K WITH 20D OPTIC  
Lumen output and actual wattage may vary +/- 5%

**MULTIPLIERS**

COLOR TEMP	80+ CRI
2700K	N/A
3000K	1.00
3500K	0.97
4000K	1.16

COLOR TEMP	90+ CRI
2700K	0.77
3000K	0.86
3500K	0.86
4000K	N/A

BEAM ANGLE	
20D	1.00
40D	0.97
60D	0.94

**HOUSING**

Extruded aluminum housing with powder coated finish  
Twist and lock construction with no visible hardware  
Adjustable housing with 0-90° tilt and 360° rotation features proprietary swivel mechanism

**OPTICS**

3.3" aperture with regressed LED source for maximum visual comfort  
High gloss black or white louvers with proprietary optics and no glare  
Polycarbonate multi-faceted reflectors  
Available in 20°, 40° and 60°  
UGR <10

**LISTING**

ETL listed and conforms to UL1598 standard. Certified to CSA22.2 No.250.0. Rated for indoor locations

**WARRANTY**

5 Year Warranty on LED and drivers  
Manufacturer 1 Year Warranty for defects in material and workmanship under normal use  
Ambient temperature at fixture should not exceed 25°C

**MOUNTING**

All hardware included for mounting to 4" octagonal junction box  
Twist and lock mechanism  
Seamless canopy option designed to mount to 4" octagonal junction box for new construction only  
Conduit feed cut-out canopy option designed to mount to 4" octagonal junction box

**ELECTRICAL**

Standard 0-10V, constant current drivers with 100-1% dimming range and >0.9 power factor  
Standard 120/277V universal voltage with several driver options  
11" model available with integral drivers that are easily accessible through luminaire aperture  
3" & 7" models available with remote, 0-10V driver within enclosure.  
Maximum remote mounting distance of 100ft (12AWG) or 50ft (14AWG)

**EMERGENCY**

Remote emergency battery installed by others (not accessible through fixture aperture)  
7W output for 90 minutes (+/- 700lm at 80+ CRI)  
CA Title 24 Certified  
Maximum remote mounting distance:  
50ft (12AWG) or 25ft (14AWG) for fixtures operating at 3000lm or below  
30ft (12AWG) or 20ft (14AWG) for fixtures operating above 3000lm  
Caution: Emergency Battery utilizes more than one power source and servicing should be performed by qualified personnel

**LED SYSTEM**

Osram LED source  
Color consistency <2 SDCM  
80+ and 90+ CRI  
Available in 27K, 30K, 35K, and 40K  
L90 >60,000 hours  
5 year warranty

**RECESSED 4" OCTAGONAL JUNCTION BOX BY OTHERS**  
STANDARD CANOPY MOUNT

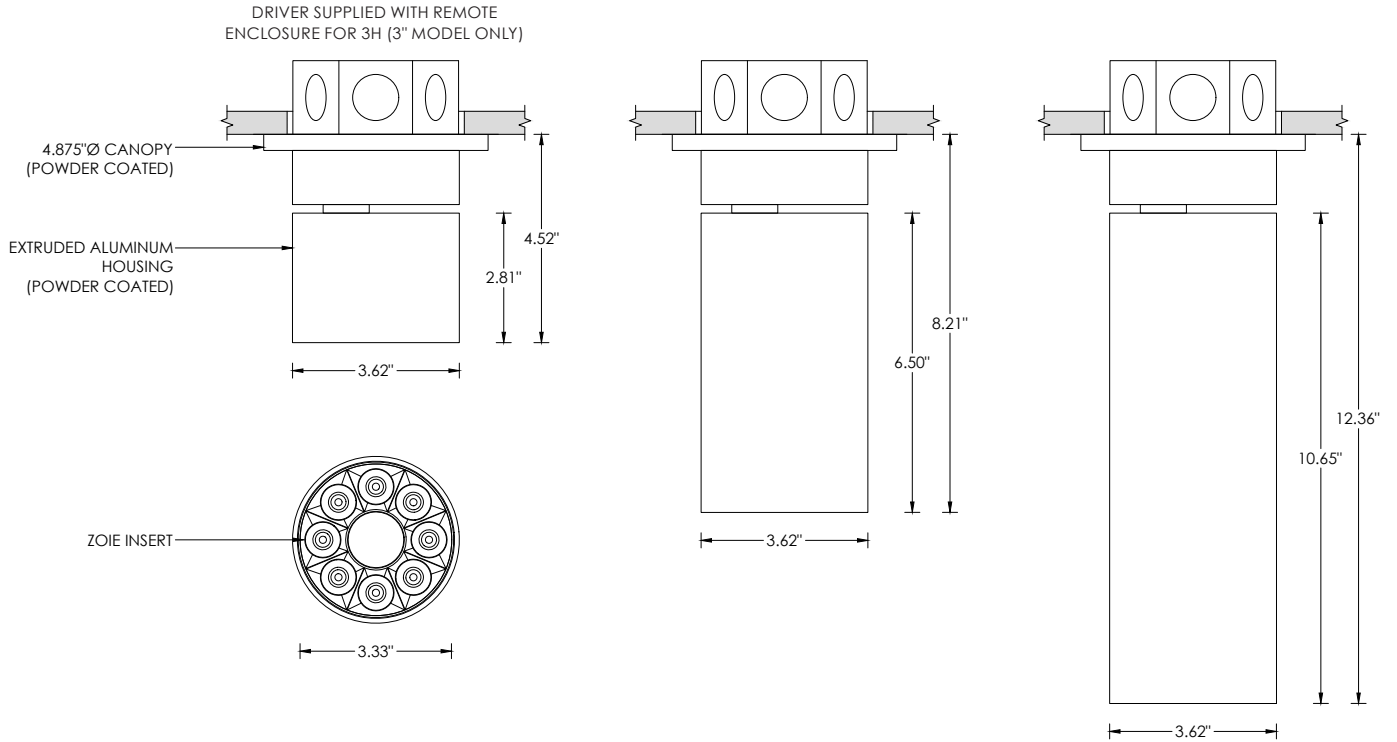

**RECESSED 4" OCTAGONAL JUNCTION BOX BY OTHERS**  
SEAMLESS CANOPY MOUNT (FXC OPTION) FOR NEW CONSTRUCTION ONLY

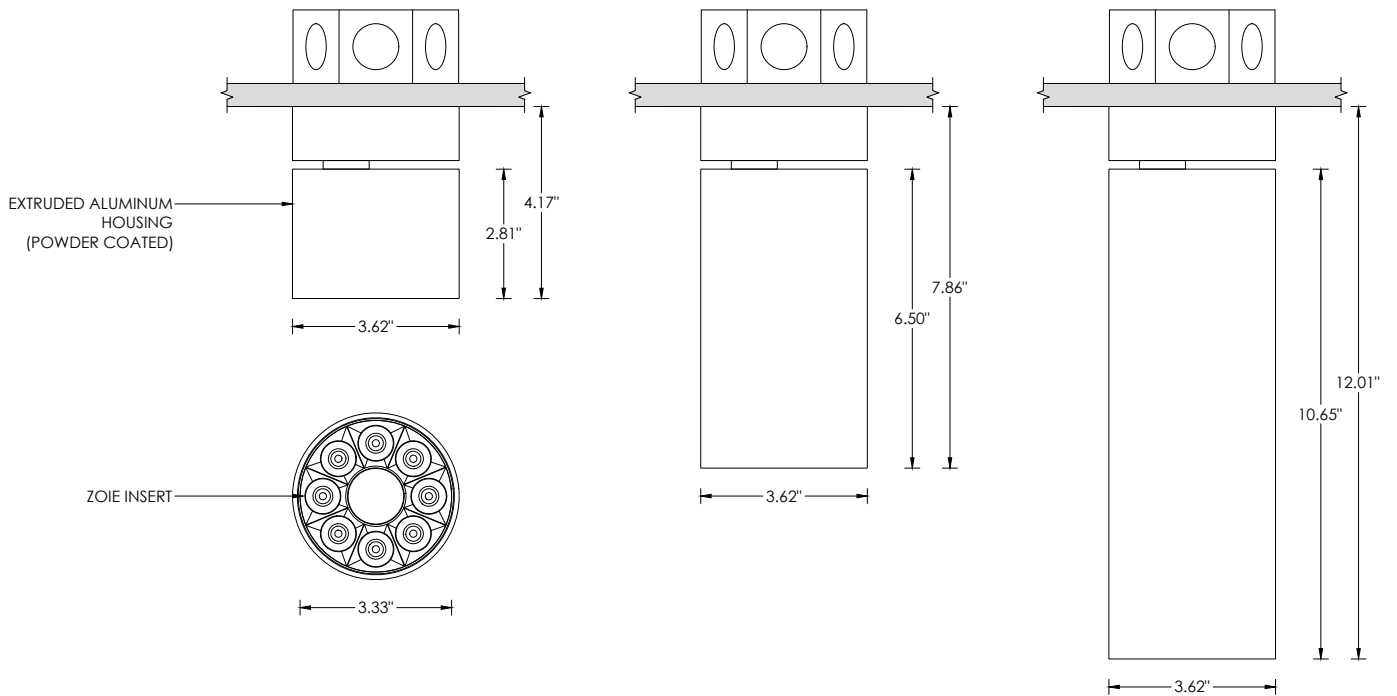

**SURFACE 4" OCTAGONAL X 1.5" DEEP JUNCTION BOX BY OTHERS**  
CONDUIT FEED CANOPY MOUNT (CFX OPTION)

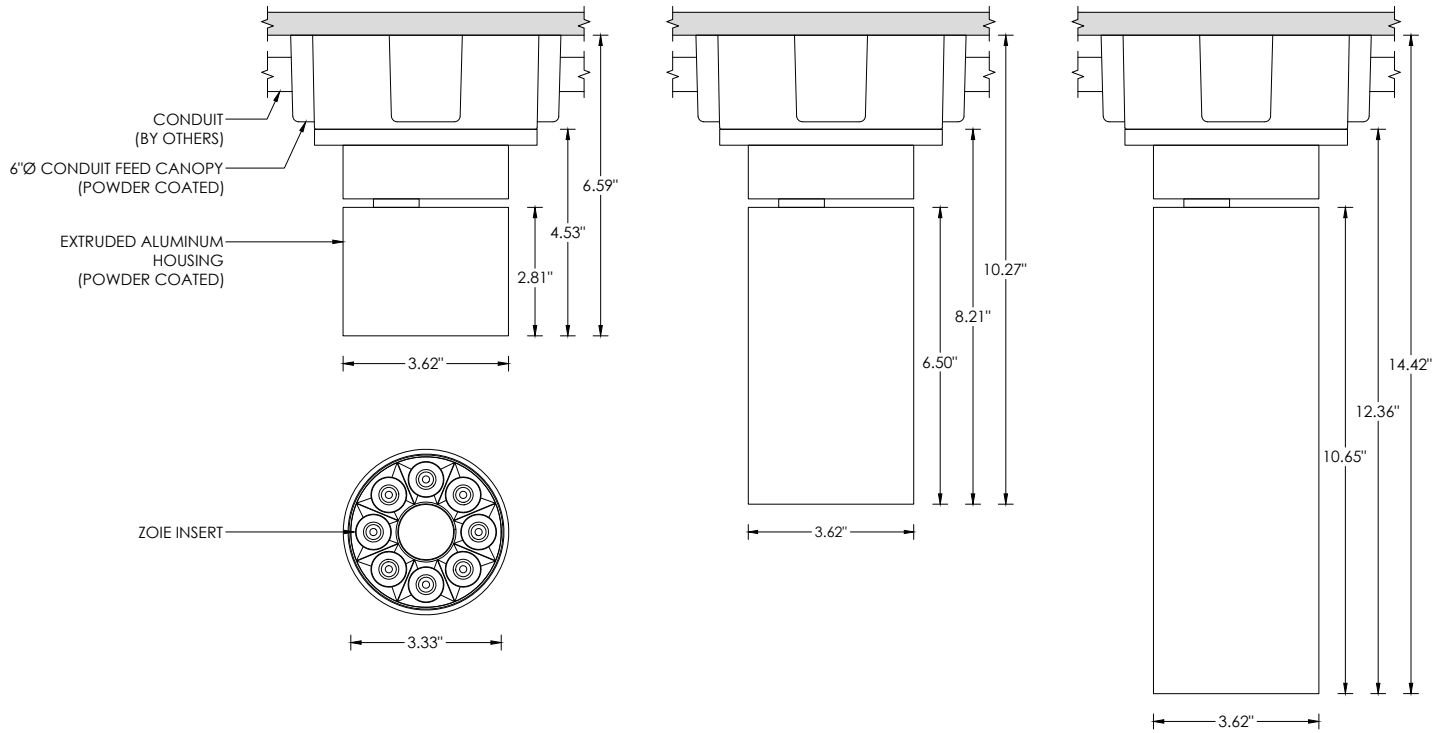

**CONDUIT FEED CANOPY MOUNTING OPTIONS**

