



3Gi-1RSL

1.5" INTEGRATED RECESSED SLOT

SPECIFY PRODUCT USING ONLINE CONFIGURATOR

1.5" aperture with one piece extruded aluminum housing
Individual or continuous runs available. See online configurator
Direct distribution with multiple source options and various lumen outputs
Integrated options include Linia, Zoie, Zoie Wall Wash and non-illuminated faceplates
Extruded acrylic lens with optimal performance and glare control
Suitable for drywall, wood, grid ceiling, and other architectural ceiling applications
Asymmetric optics available
1% dimming standard with several driver options

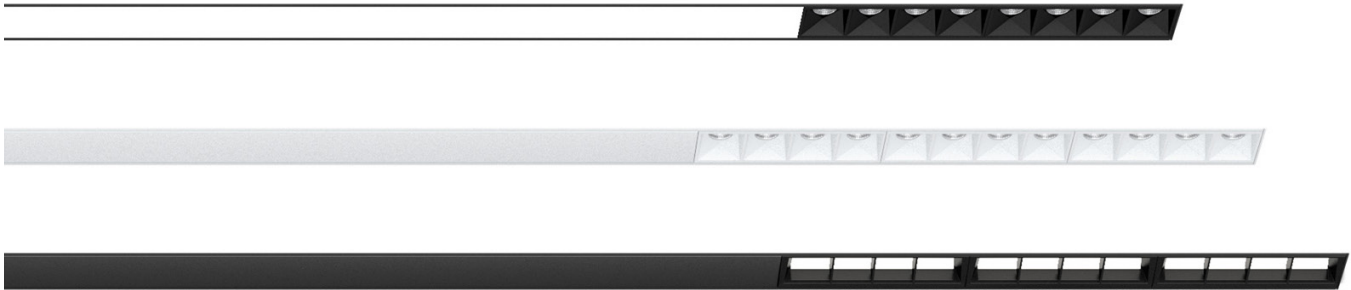

INTEGRATED OPTIONS

1.5" LINIA



NON ILLUMINATED FACEPLATE



LINEAR ZOIE



ZOIE WALL WASH



CONFIGURATION OPTIONS (SPECIFY PRODUCT USING ONLINE CONFIGURATOR)

SE - START- END

Integrated options located at start and end of run only. Available in 1' increments starting at 4'. See online configurator for length options

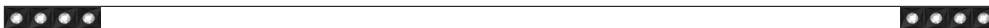

OC - ON CENTER SPACING

Integrated options with on center spacing starting at 4' (OC4) through 8' (OC8). See online configurator for run length options



1LI - 1.5" LINIA



1N - NON ILLUMINATED

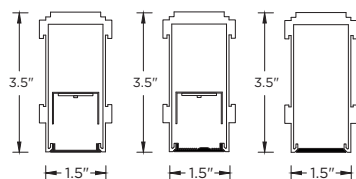

APERTURE SIZE: 1.5"
COLOR TEMP: 27K, 30K, 35K, 40K
CRI: 90+
R9 VALUE: 56

DELIVERED LUMENS: 250 - 1000 LM/FT
EFFICACY: 91 - 100 LPW *
WATTAGE: 2.5 - 10.9 W/FT *

OPTICS: FLUSH, ASYMMETRIC

* Based on 90+ CRI and 3500K

Z4 - 4" ZOIE



Z8 - 8" ZOIE



Z12 - 12" ZOIE

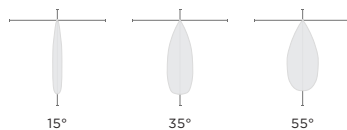
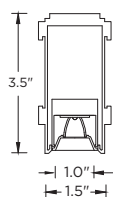

APERTURE SIZE: 1.0"
COLOR TEMP: 27K, 30K, 35K, 40K
CRI: 90+

DELIVERED LUMENS: 400 - 2400 LM
EFFICACY: 84 - 92 LPW *
WATTAGE: 4.4 - 28.7 W *

OPTICS: 15°, 35°, 55°

* Based on 90+ CRI, 35° and 3500K

Z4WW - 4" ZOIE WALL WASH



Z8WW - 8" ZOIE WALL WASH



Z12WW - 12" ZOIE WALL WASH

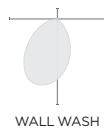
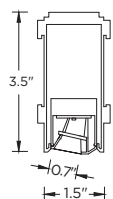

APERTURE SIZE: 0.7"
COLOR TEMP: 27K, 30K, 35K, 40K
CRI: 90+

DELIVERED LUMENS: 400 - 2400 LM
EFFICACY: 63 - 73 LPW *
WATTAGE: 5.5 - 37.8 W *

OPTICS: WALL WASH

* Based on 90+ CRI and 3500K

OPTICS**1.5" LINIA**

Extruded, satin acrylic lens designed for optimal performance and glare control
High performance asymmetric optics

LINEAR ZOIE

4", 8", and 12" high performance Zoie downlights
1" apertures with matte black or matte white multi-faceted louvers
Regressed LED source for enhanced glare control
Proprietary polycarbonate multi-faceted reflectors
Available in 15°, 35° and 55°
UGR <16

ZOIE WALL WASH

4", 8", and 12" high performance Zoie Wall Wash downlight
0.7" aperture with matte black or matte white louver finish
Regressed LED source for enhanced glare control
Proprietary high performance wall wash optic and lens
Smooth, direct and uniform illumination across the top and down the wall

HOUSING

Extruded aluminum housing with narrow 1.5" aperture
Trim flange with matte white powder coated finish and minimal 0.400" overlap
Trimless model features a satin coat mudding flange for seamless ceiling integration
24-gauge LED reflector with high reflectance white powder coated finish
Standard polyester powder coated matte white finish
Non-illuminated option features an extruded aluminum faceplate with powder coated finish

MOUNTING

Housing suspended via 1/4" threaded rod or suspension cables (by others)
Toolless installation with 3G's proprietary mounting system
Internal, toolless joiner system (latch and hook) easily connects multiple sections together
LED reflectors remain in each section during installation with 3G's locking spring system
Trim fixture designed for use in drywall, wood, and other architectural ceiling materials
Trimless fixture designed for use in drywall, mud-in ceiling applications
Flangeless fixture designed for use in wood ceilings. New construction only
Suitable for various grid ceiling applications (see mounting details)
Fixture weight: +/- 3 lb/ft

LED SYSTEM**1.5" LINIA**

Proprietary LED system with color consistency < 3 SDCM
Available in 27K, 30K, 35K, and 40K
Standard 90+ CRI with R9 value of 56
L90 > 60,000 hours

LINEAR ZOIE

Osram LED source
Available in 27K, 30K, 35K, and 40K
Standard 90+ CRI
Color consistency < 2 SDCM
L90 > 60,000 hours

ZOIE WALL WASH

Cree LED source
Available in 27K, 30K, 35K, and 40K
Standard 90+ CRI
Color consistency < 2 SDCM
L90 > 60,000 hours

ELECTRICAL

Luminaires are pre-wired with factory installed quick connects and branch circuit wiring
Standard 0-10V, constant current drivers with 100-1% dimming range and >0.9 power factor
120V Forward Phase/Reverse Phase driver option with 100-1% dimming range
Standard 120/277V universal voltage with several driver options
All drivers are integral and easily accessible through luminaire aperture

LISTING

ETL listed and conforms to UL1598 standard. Certified to CSA22.2 NO.250.0.
Rated for indoor dry or damp locations

WARRANTY

5 Year Warranty on LED and drivers Manufacturer
1 Year Warranty for defects in material and workmanship under normal use
Ambient temperature at fixture should not exceed 25°C

HARD CEILING

WT - TRIM

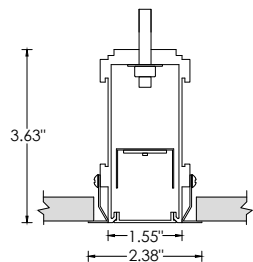

RECOMMENDED CEILING OPENING 2.20"

XTR - TRIMLESS (DRYWALL)

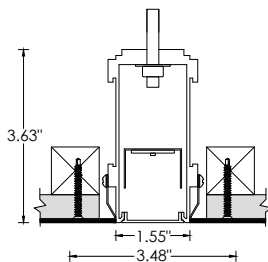

RECOMMENDED CEILING OPENING 2.25"

FX - FLANGELESS (NEW CONSTRUCTION)

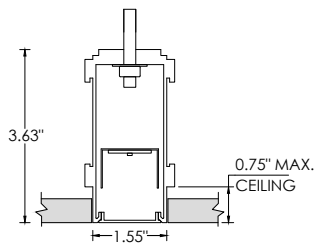

RECOMMENDED CEILING OPENING 1.60"

HARD CEILING : MOUNTING DETAILS

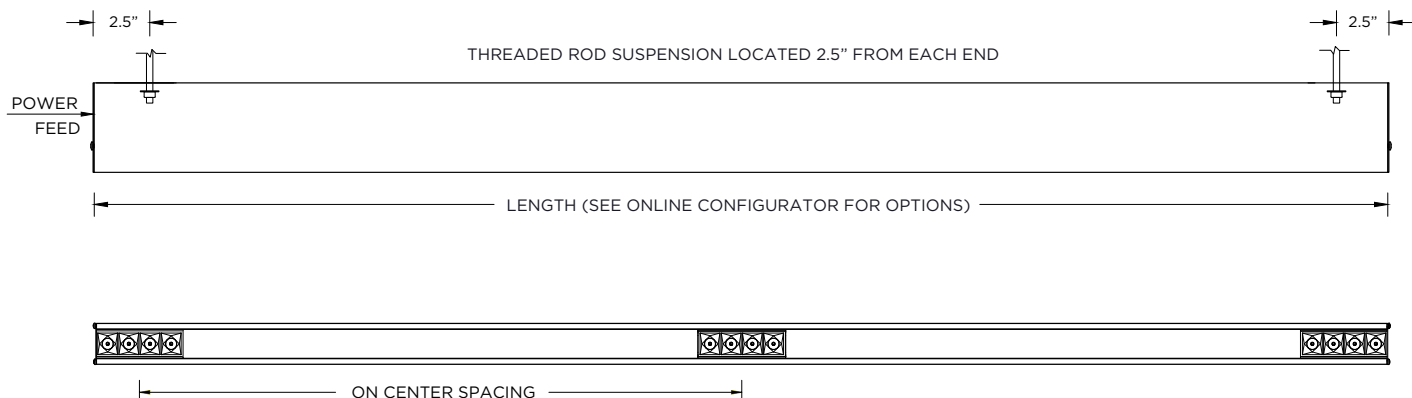
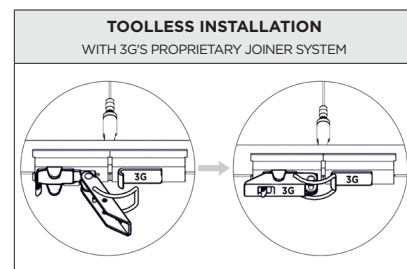

GRID CEILING

9L - 9/16" LAYIN

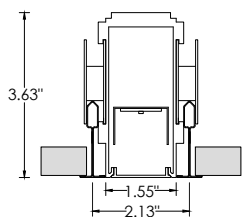

9TG - 9/16" TEGULAR

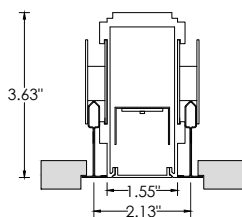

15L - 15/16" LAYIN

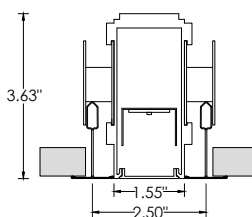

15TG - 15/16" TEGULAR

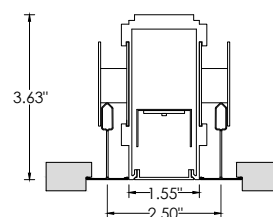

9TP - 9/16" TEGULAR

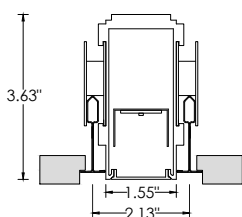

15TP - 15/16" TEGULAR

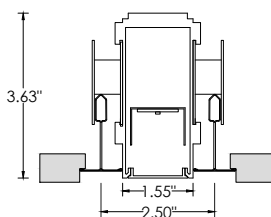

9ST - 9/16" SLOT TEE TEGULAR

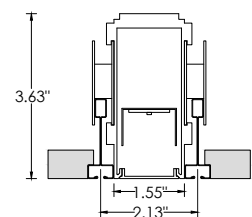

GRID CEILING : MOUNTING DETAILS

UNIVERSAL MOUNTING BRACKET USED FOR ALL GRID CEILING TYPES

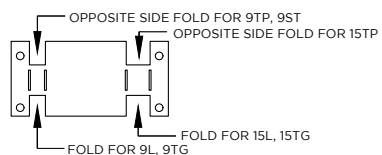

TOOLLESS INSTALLATION

WITH 3G'S PROPRIETARY JOINER SYSTEM

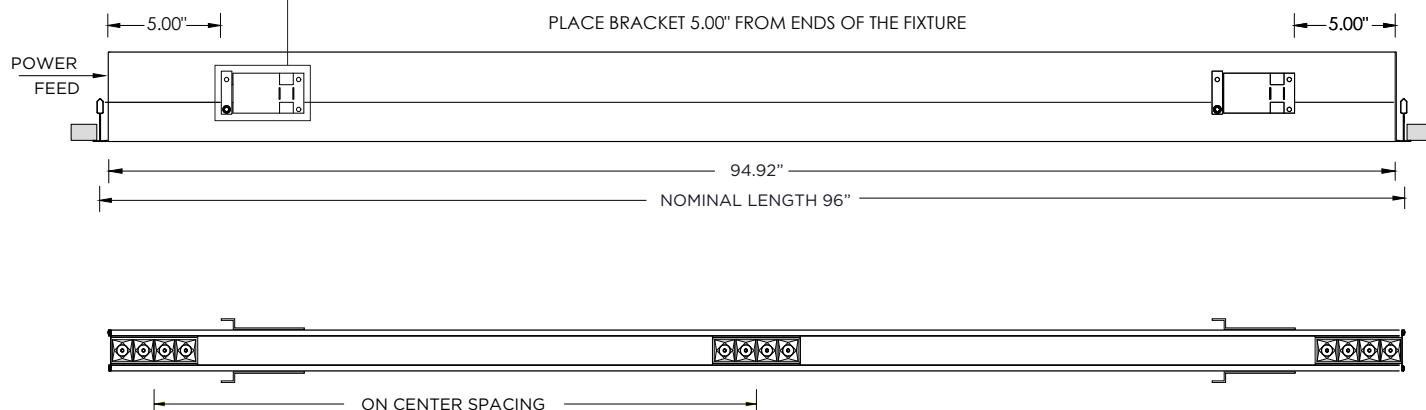
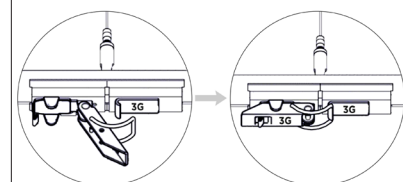

1.5" LINIA - BASED ON 90+ CRI AND 3500K SOURCE

LENS OPTION	DELIVERED LUMENS (LM/FT)	SYSTEM WATTS (W/FT)	EFFICACY (LPW)
FLUSH	250	2.5	99
	500	5.0	100
	750	7.9	95
	1000	10.9	91
ASYMMETRIC	250	2.5	96
	500	5.0	95
	750	7.9	93
	1000	10.9	89

LUMEN OUTPUT MULTIPLIER: 27K=0.94, 30K=0.97, 35K=1.00, 40K=1.01

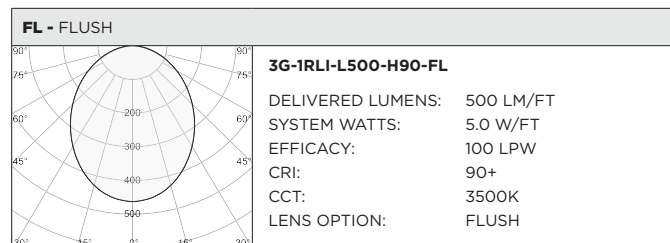

LINEAR ZOIE - BASED ON 35°, 90+ CRI AND 3500K SOURCE

FIXTURE TYPE	DELIVERED LUMENS	SYSTEM WATTS	EFFICACY (LPW)
Z4 - 4" ZOIE	400	4.4	91
	800	9.2	87
Z8 - 8" ZOIE	800	8.8	91
	1600	18.7	86
Z12 - 12" ZOIE	1200	13.1	92
	2400	28.7	84

LUMEN OUTPUT MULTIPLIER: 27K=0.93, 30K=0.96, 35K=1.00, 40K=1.02

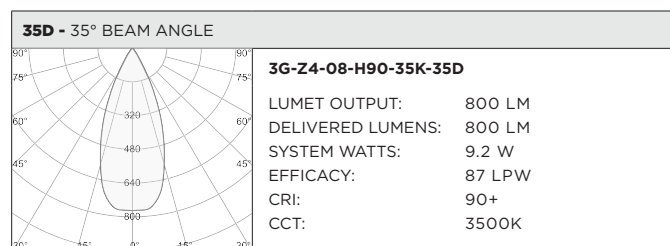

ZOIE WALL WASH - BASED ON WALL WASH OPTIC, 90+ CRI, AND 3500K SOURCE

FIXTURE TYPE	DELIVERED LUMENS	SYSTEM WATTS	EFFICACY (LPW)
Z4WW - 4" ZOIE WW	400	5.5	73
	800	12.3	65
Z8WW - 8" ZOIE WW	800	11.3	71
	1600	25.3	63
Z12WW - 12" ZOIE WW	1200	17.1	70
	2400	37.8	63

LUMEN OUTPUT MULTIPLIER: 27K=0.93, 30K=0.96, 35K=1.00, 40K=1.02

