

3G LIGHTING

3G-48RDSL-S

4.8" RECESSED DOWNLIGHT SLOT
3.3" SQUARE DOWNLIGHTS

4.8" Recessed Downlight Slot designed for continuous runs
Machined aluminum faceplate with square, trimless downlight integration
3.3" square adjustable or 3.3" square fixed downlight option
Standard 95+ CRI LED system with performance up to 133 LPW
Delivered lumen range up to 3000lm at 95+ CRI
20° to 90° beam angle options suitable for various applications
Companion to 3G-DL33S downlight and cylinder families

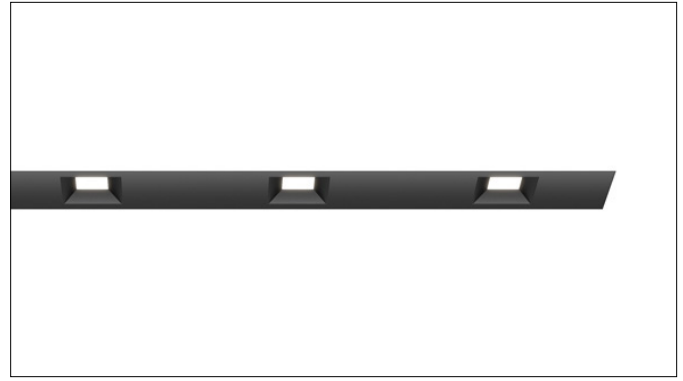

WT - TRIM

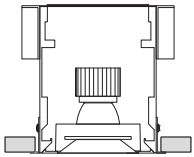

XTR - TRIMLESS

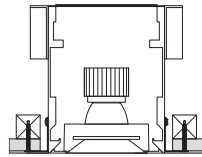

FX - FLANGELESS

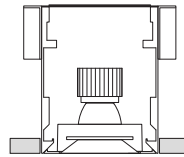

GCX - GRID CEILING

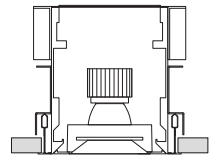

OPTICS

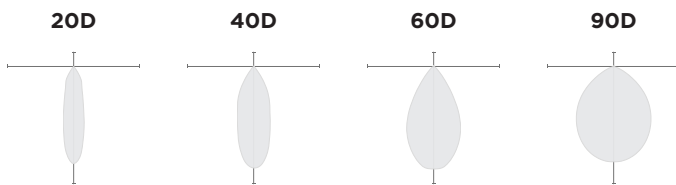

PERFORMANCE

| LUMEN OUTPUT | DELIVERED LUMENS | SYSTEM WATTS | EFFICACY (LPW) |
|--------------|------------------|--------------|----------------|
| 1000 | 1000 | 9.3 | 114 |
| 1500 | 1500 | 13.6 | 112 |
| 2000 | 2000 | 18.4 | 109 |
| 2500 | 2500 | 23.9 | 104 |
| 3000 | 3000 | 34.2 | 102 |

BASED ON FIXED DOWNLIGHT OPTION
WITH 95+ CRI, 35K, 40D OPTIC AND SOFTENING LENS
Lumen output and actual wattage may vary +/- 5%

PATTERNS

Specify pattern shape and overall dimensions as shown below. Patterns are connected with 12"x12" mitered corner sections (Downlights not available). Please consult factory for custom patterns and shapes not shown below.

| L-SHAPE | U-SHAPE | RECTANGLE/SQUARE |
|---|---|--|
| <p>Provide dimensions of AxB Example: L - 6'x8'</p> | <p>Provide dimensions of AxBxC Example: U - 8'x10'x6"</p> | <p>Provide dimensions of AxB Example: R - 10'x8'</p> |

| | | | |
|------------------|--|--------------|-------------|
| PROJECT: | | TYPE: | |
| CATALOG#: | | DATE: | QTY: |

| CAT. NO | DOWNLIGHT TYPE | LUMEN OUTPUT (DELIVERED) | CRI |
|--------------------|--|--|----------------------|
| 3G-48RDSL-S | 33SF - 3.3" SQUARE FIXED 33SA - 3.3" SQUARE ADJUSTABLE 33SA (adjustable) option available up to 2500lm | 10 - 1000 LUMENS 15 - 1500 LUMENS 20- 2000 LUMENS 25 - 2500 LUMENS 30- 3000 LUMENS All lumen outputs are delivered lumens at 95+ CRI | H95 - 95+ CRI |

| COLOR TEMP | BEAM ANGLE | VOLTAGE | DRIVER |
|--|---|--|--|
| 27K - 2700K 30K - 3000K 35K - 3500K 40K - 4000K | 20D - 20° ¹ 40D - 40° 60D - 60° 90D - 90° * *90D optic supplied with lens Not available with other lens options Not available with 33RA (adjustable) | UNV - 120/277V 120 - 120V 347 - 347V ² | DIM - 0-10V (100-1%) LE - PHASE DIM ³ (TRIAC/ELV, 100-1%) D01 - 0-10V (100-0.1%) DALI - DALI (100-1%) ⁴ DHL2 - LUTRON HI-LUME (1% ECOSYSTEM) DMX - DMX (100-0%) |

| FLANGE TYPE | HOUSING AND FACEPLATE | DOWNLIGHT INSERT | OPTIONS |
|--|--|---|--|
| WT - WHITE TRIM (STANDARD) BT - BLACK TRIM XTR - TRIMLESS (MUD-IN DRYWALL) FX - FLANGELESS GCX - GRID CEILING * (UNIVERSAL MOUNT) *Universal mounting brackets used for grid ceiling types only. See mounting details | BK - BLACK (STANDARD) WH- WHITE | BI - BLACK WI- WHITE SI - SILVER | SF - SOFTENING LENS * (SUPPLIED STANDARD) LS - LINEAR SPREAD LENS SB - SANDBLASTED LENS 2C - 2 CIRCUIT 3C - 3 CIRCUIT CP - CHICAGO PLENUM EMR - EMERGENCY BATTERY ⁵ (REMOTE) *Softening lens not provided with 90D optic Maximum 1 optical accessory |

| RUN TYPE | DOWNLIGHT SPACING |
|---|---|
| S - ____' (STRAIGHT) L - ____'X ____' (L-SHAPE) U - ____'X ____'X ____' (U-SHAPE) R - ____'X ____' (RECTANGLE/SQUARE) U-Shape and R-Rectangle/Square not available with grid ceiling applications Continuous runs available in 6" increments | 12 - 12" ON CENTER 18 - 18" ON CENTER 24 - 24" ON CENTER 36 - 36" ON CENTER 48 - 48" ON CENTER CUS(xx)- CUSTOM SPACING * *Specify number of downlights (XX) |

- ¹ 20D reflector available up to 2000lm
- ² 347 available in "DIM" 0-10V only (100-1%)
- ³ Phase dimming options available in 120V only
- ⁴ DALI-2 (Type 6) provided as standard. Please consult factory for DALI (Type 8) options
- ⁵ Supplied with enclosure with Emergency Battery and driver. Installed remotely by others. Not accessible through fixture aperture

PERFORMANCE

3.3" SQUARE FIXED DOWNLIGHT

| LUMEN OUTPUT | DELIVERED LUMENS | SYSTEM WATTS | EFFICACY (LPW) |
|--------------|------------------|--------------|----------------|
| 1000 | 1000 | 9.3 | 114 |
| 1500 | 1500 | 13.6 | 112 |
| 2000 | 2000 | 18.4 | 109 |
| 2500 | 2500 | 23.9 | 104 |
| 3000 | 3000 | 34.2 | 102 |

BASED ON 95+ CRI, 3500K, 40D OPTIC WITH SOFTENING LENS
Lumen output and actual wattage may vary +/- 5%

3.3" SQUARE ADJUSTABLE DOWNLIGHT

| LUMEN OUTPUT | DELIVERED LUMENS | SYSTEM WATTS | EFFICACY (LPW) |
|--------------|------------------|--------------|----------------|
| 1000 | 1000 | 9.6 | 104 |
| 1500 | 1500 | 15.6 | 96 |
| 2000 | 2000 | 22.0 | 91 |
| 2500 | 2500 | 30.1 | 83 |

BASED ON 95+ CRI, 3500K, 40D OPTIC WITH SOFTENING LENS
Lumen output and actual wattage may vary +/- 5%

MULTIPLIERS

| BEAM ANGLE | |
|------------|------|
| 20D | 1.17 |
| 40D | 1.00 |
| 60D | 0.97 |
| 90D | 0.85 |

| COLOR TEMP | |
|------------|------|
| 2700K | 0.98 |
| 3000K | 1.00 |
| 3500K | 1.00 |
| 4000K | 1.02 |

| BEAM ANGLE | |
|------------|------|
| 20D | 1.25 |
| 40D | 1.00 |
| 60D | 0.98 |

| COLOR TEMP | |
|------------|------|
| 2700K | 0.98 |
| 3000K | 1.00 |
| 3500K | 1.00 |
| 4000K | 1.02 |

HOUSING

Housing constructed in extruded aluminum and cold rolled steel
Designed for continuous runs in various configurations
Maximum ceiling thickness of 1.75". Consult factory for modifications
Machined aluminum faceplates with trimless downlight integration
Standard matte black powder coated housing and faceplate finish
Trim flange with power coated finish and 0.400" overlap
Trimless model features a perforated galvanized mudding flange

DOWNLIGHT INSERT

Cast aluminum beveled insert with matte powder coated finish
3.3" aperture with regressed LED source for enhanced glare control

ADJUSTABILITY

Adjustable downlight option with 40 degree tilt along length of channel and 30 degree tilt across the width
Proprietary hot aiming mechanism with sliding center beam optimization and 360° rotation

OPTICS

Proprietary anodized, aluminum reflectors
Beam angle available in 20°, 40°, 60° and 90°
Reflectors are field replaceable (20° reflector not interchangeable)
Softening lens supplied standard

LED SYSTEM

Standard 95+ CRI
Color consistency <2 SDCM
Available in 27K, 30K, 35K, and 40K
L90 > 50,000 hours

ELECTRICAL

Standard 0-10V, constant current drivers
100-1% dimming range and > 0.9 power factor
Standard 120/277V universal voltage with several driver options
120V Forward Phase/Reverse Phase driver option (100-1%)
Integral drivers are easily accessible through channel aperture

EMERGENCY

Title 24 Certified. 7W output for 90 minutes
800lm at 95+ CRI (fixed DL) and 765lm at 95+ CRI (adjustable DL)
Remote emergency battery (not accessible through fixture aperture)
Maximum remote mounting distance:
3000lm or below - 50ft (12AWG) or 25ft (14AWG)
Caution: Emergency Battery utilizes more than one power source and servicing should be performed by qualified personnel

MOUNTING

New construction housing suspended via 1/4" threaded rod or suspension cables (by others)
Trim fixture designed for use in drywall, wood, and other architectural ceiling materials
Trimless fixture designed for use in drywall, mud-in ceiling applications
Flangeless fixture designed for use in wood ceilings
Suitable for various grid ceiling applications (see mounting details)

LISTING

ETL listed and conforms to UL1598 standard
Certified to CSA22.2 No.250.0.
JA8 certified
Rated for dry or damp locations

WARRANTY

5 Year Warranty on LED and drivers
LED system rated for operation in ambient environments up to 25°C

HARD CEILING

WT - TRIM

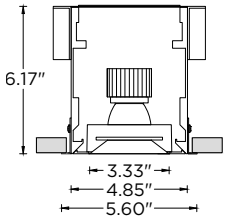

RECOMMENDED CEILING
CUT-OUT 5.20"

XTR - TRIMLESS

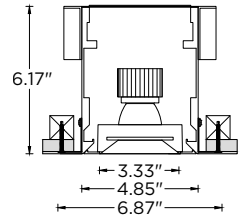

RECOMMENDED CEILING
CUT-OUT 5.20"

FX - FLANGELESS

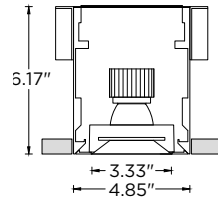

RECOMMENDED CEILING
CUT-OUT 4.90"

TRIM

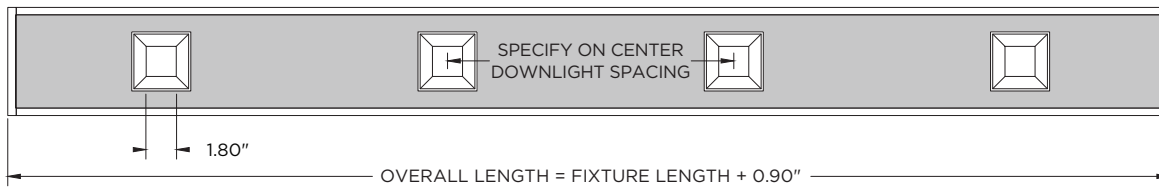

TRIMLESS (MUD-IN DRYWALL)

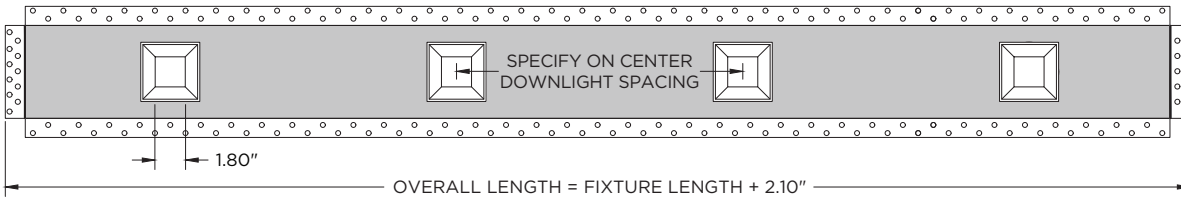

FLANGELESS

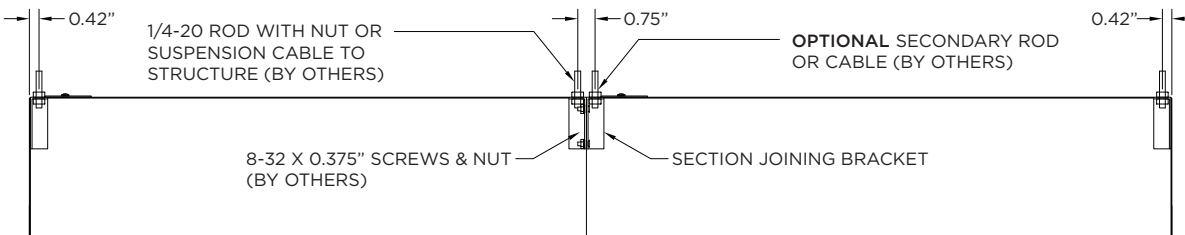
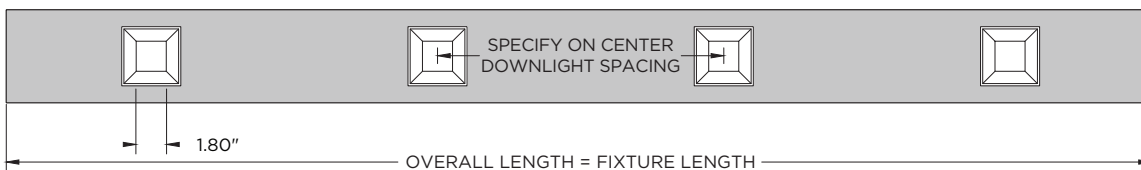

GRID CEILING

9L - 9/16" LAYIN

9TG - 9/16" TEGULAR

15L - 15/16" LAYIN

15TG - 15/16" TEGULAR

9ST - 9/16" SLOT TEE TEGULAR

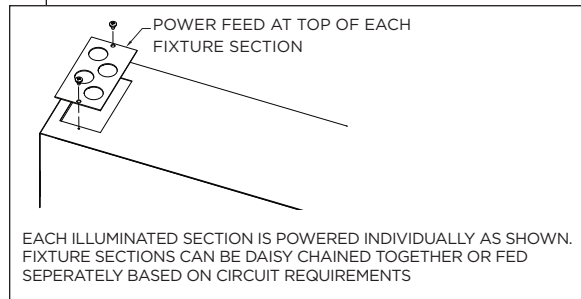
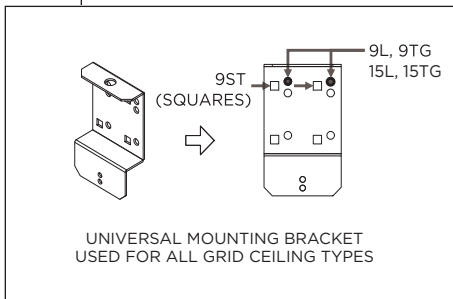
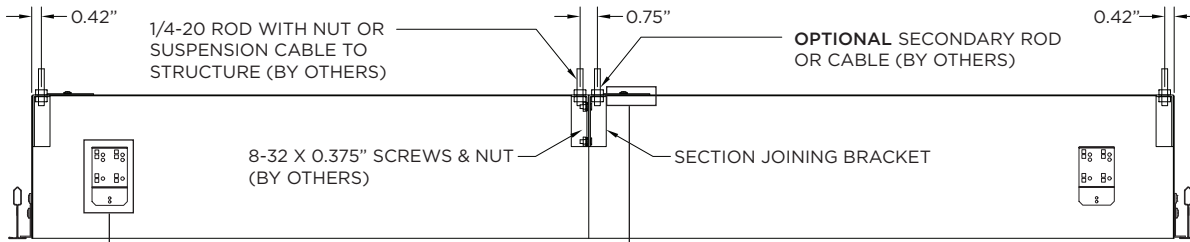
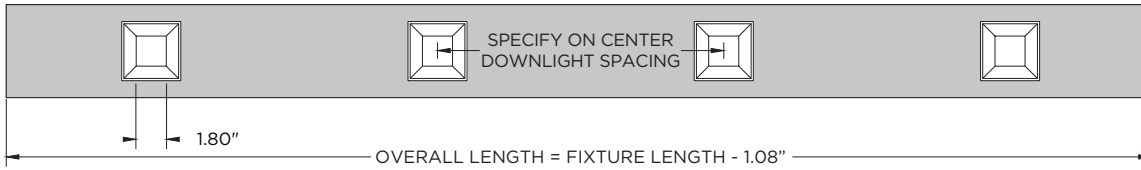
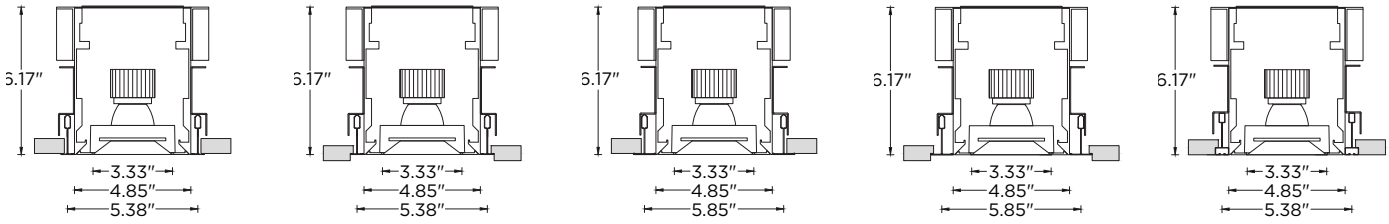

DOWNLIGHT ADJUSTABILITY

WIDTH

LENGTH

ROTATION

