



**3G-1RLI**  
**1.5" RECESSED LINIA**  
FLANGELESS/TRIM FLANGE



⚠ FOR **NEW CONSTRUCTION** INSTALLATION ONLY

FIXTURE TYPES	INCLUDED COMPONENTS
<p>1RLI PROFILE</p>	<p><b>Standalone Fixtures (2' to 8')</b></p> <p>INDIVIDUAL      LENS</p>
<p><b>Continuous Runs (9' to 16')</b></p> <p>STARTER      ENDER      LENS</p>	<p><b>Continuous Runs (17' and longer)</b></p> <p>STARTER      JOINER      ENDER      LENS</p>

INSTRUCTION KEY	INFORMATION
⚠ ADDITIONAL	INSTALLATION SHOULD ONLY BE PERFORMED BY A CERTIFIED ELECTRICIAN
i ATTENTION	REFER TO LOCAL/NATIONAL CODES FOR PROPER INSTALLATION
⚡ POWER ON	FAILURE TO FOLLOW INSTALLATION INSTRUCTION MAY VOID THE WARRANTY
⏻ POWER OFF	DO NOT TOUCH LEDS. LEDS MUST BE PROTECTED FROM MECHANICAL STRESS OR DEBRIS
	TURN OFF POWER DURING INSTALLATION OR SERVICING

OVERVIEW

**3G-1RLI - FLANGELESS - FX**



**FLANGELESS - FX**

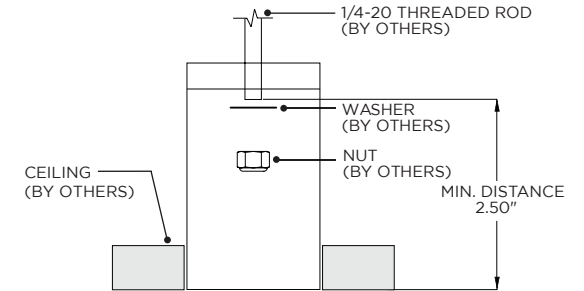

**FLANGELESS - FX - CEILING CUT-OUT DIMENSIONS**

FIXTURE TYPE	WIDTH	LENGTH
3G-1RLI	1.600"	LENGTH + 0.125"

**3G-1RLI - WHITE TRIM FLANGE - WT**

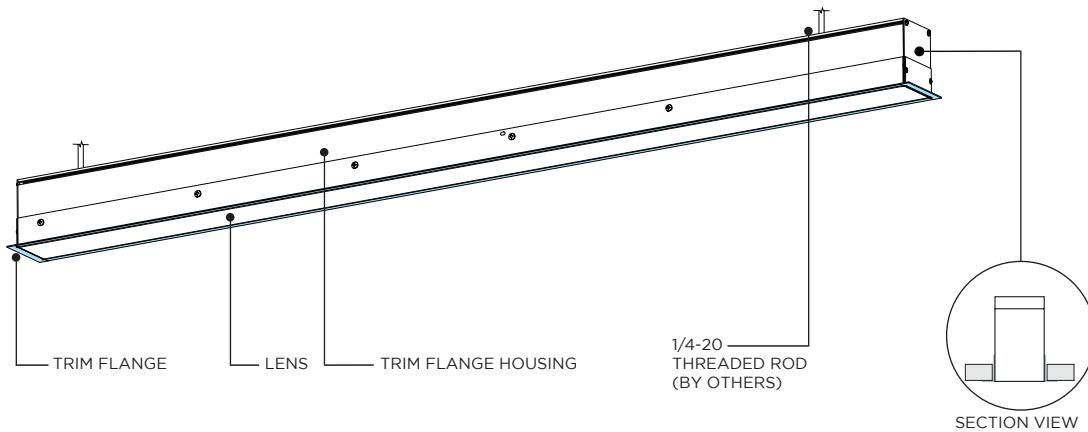

**WHITE TRIM FLANGE - WT**

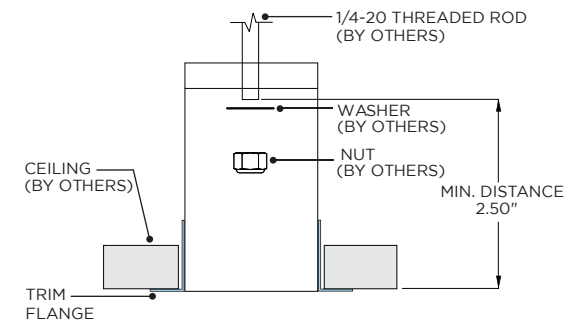

**WHITE TRIM FLANGE - WT - CEILING CUT-OUT DIMENSIONS**

FIXTURE TYPE	WIDTH	LENGTH
3G-1RLI	2.150"	LENGTH + 0.380"

ASYMMETRIC LENS ORIENTATION

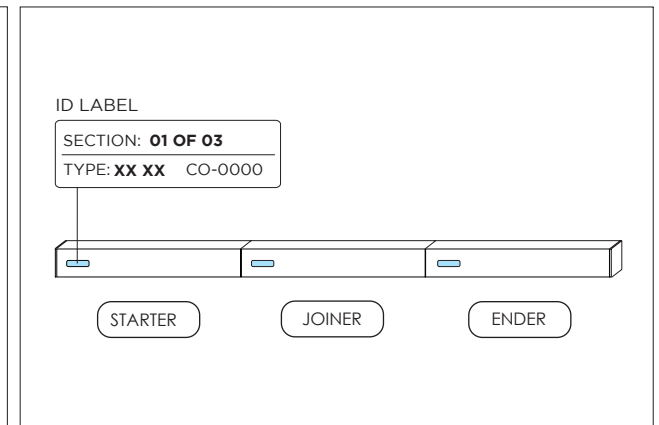
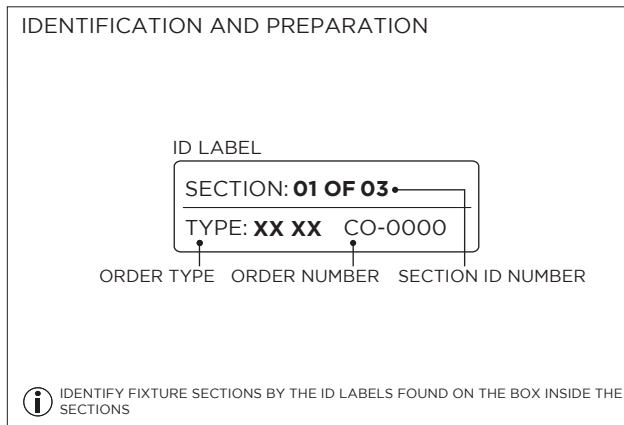
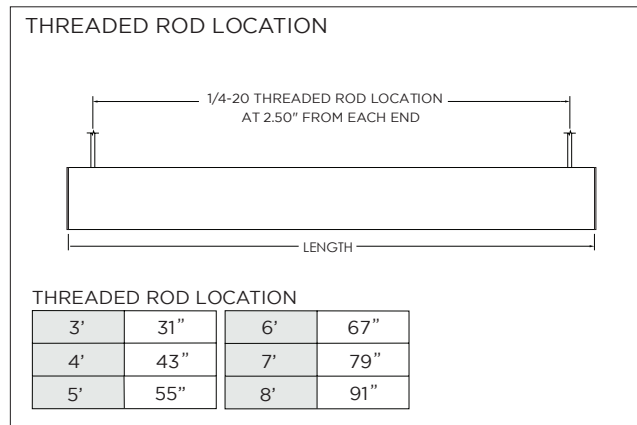
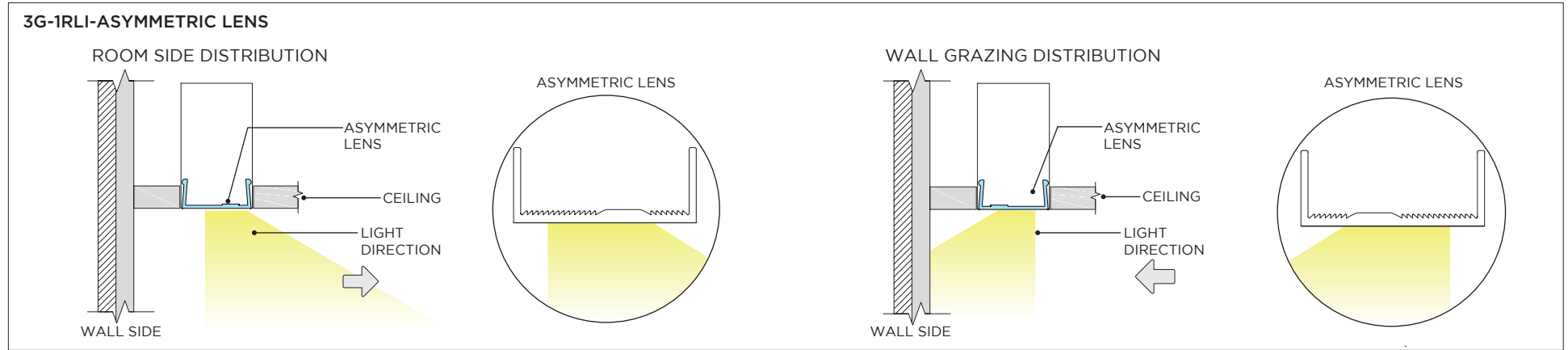

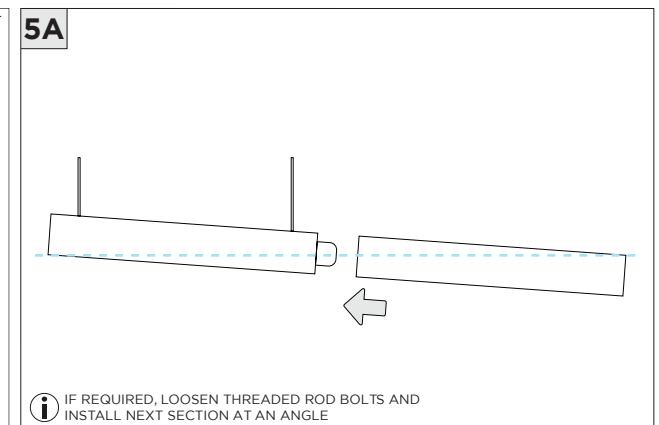
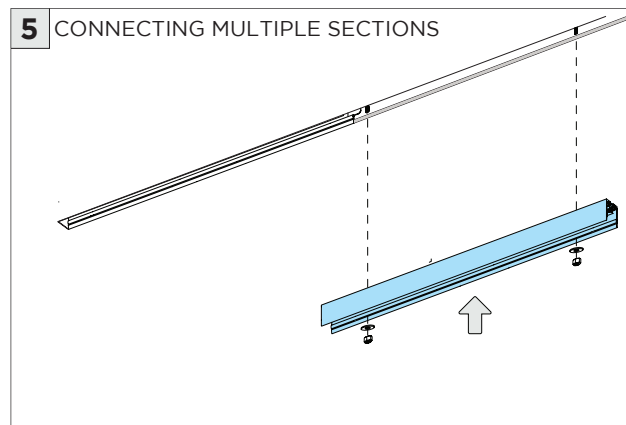
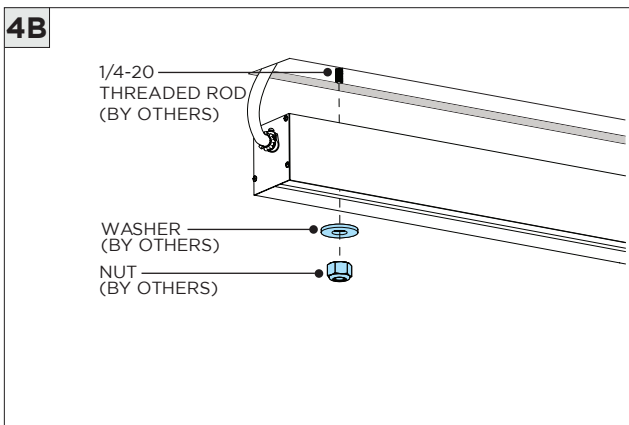
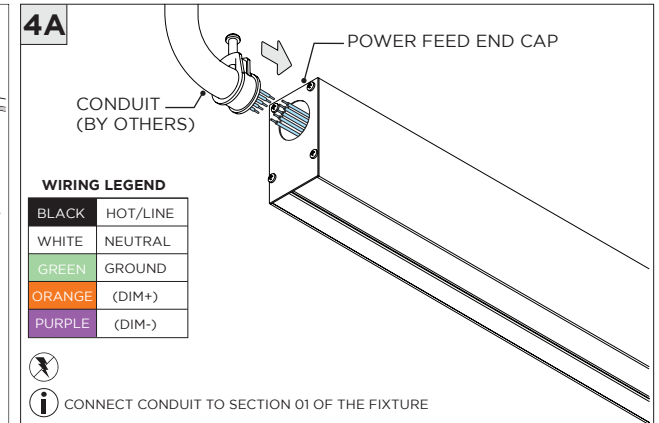
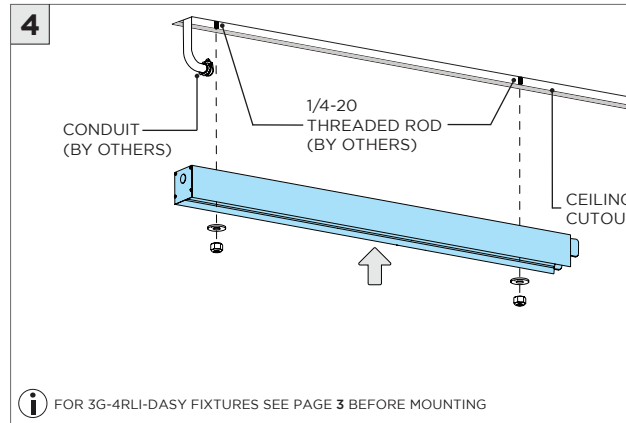
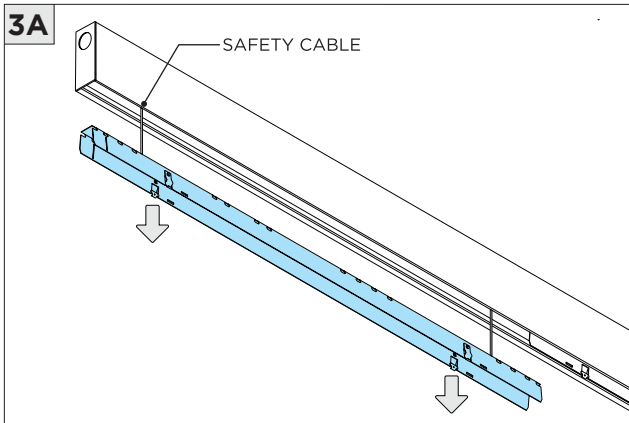
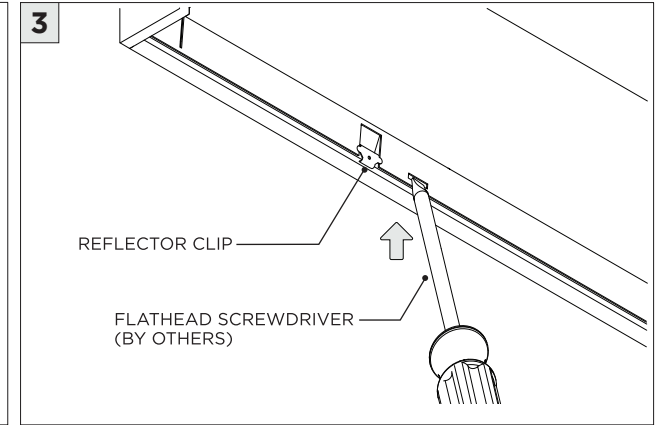
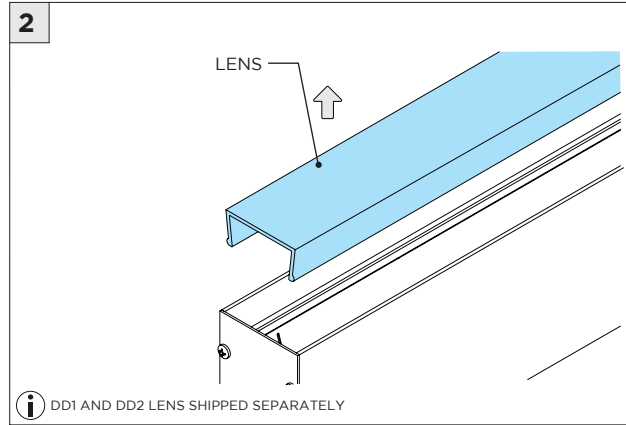
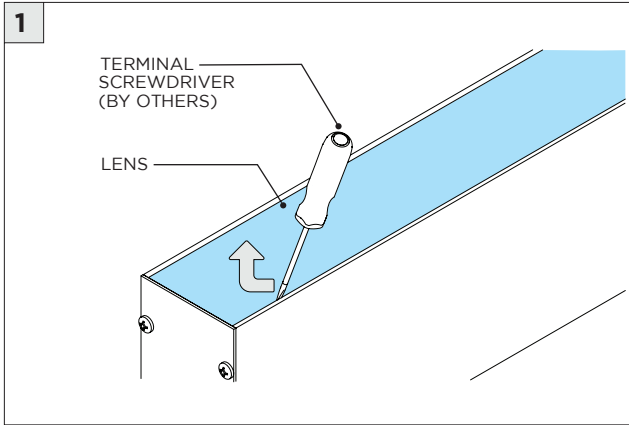

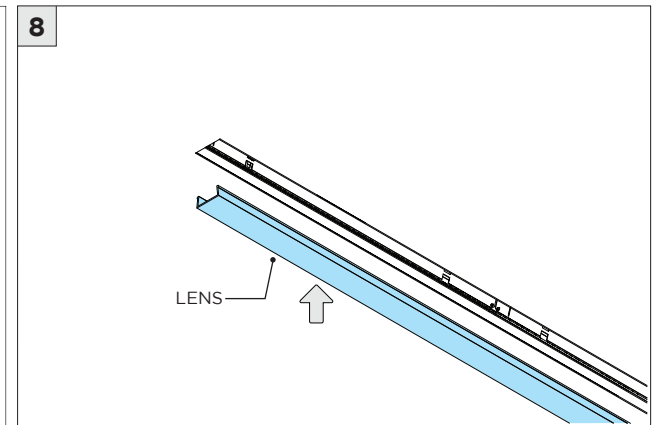
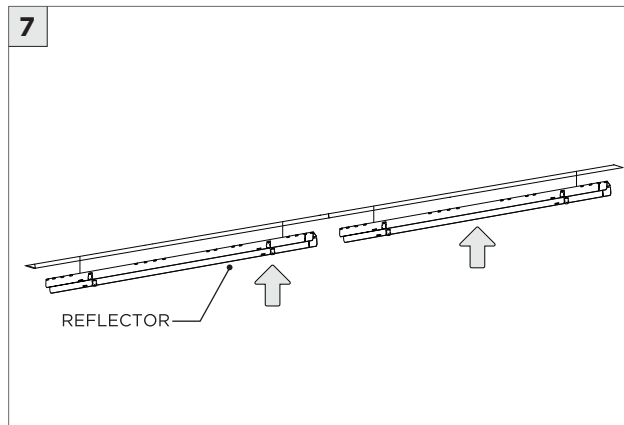
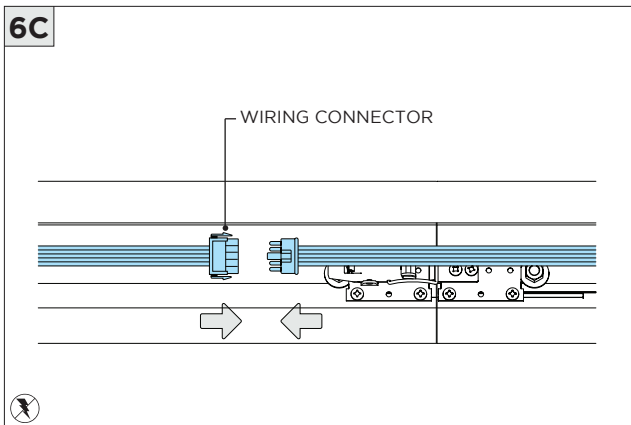
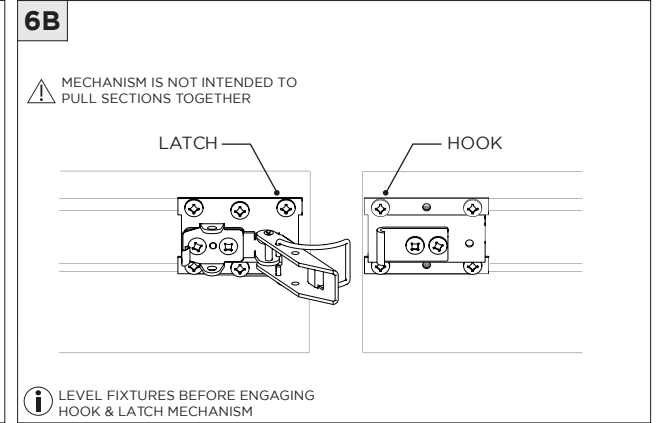
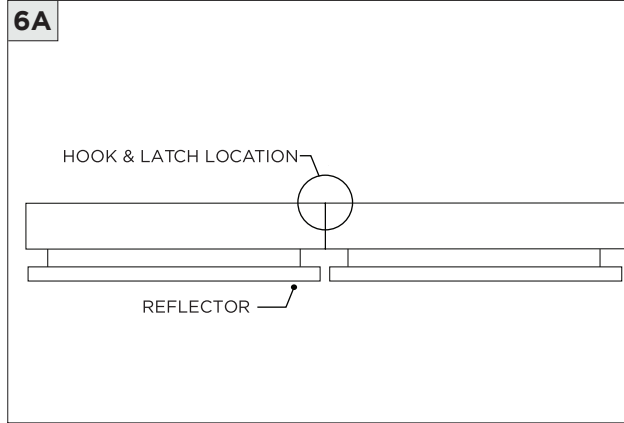
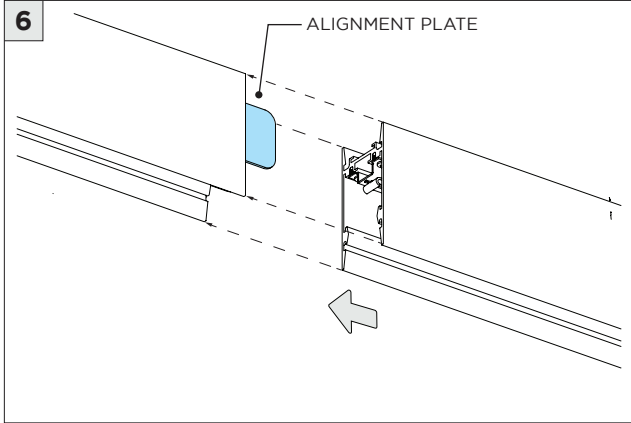

**DRIVER SERVICING**

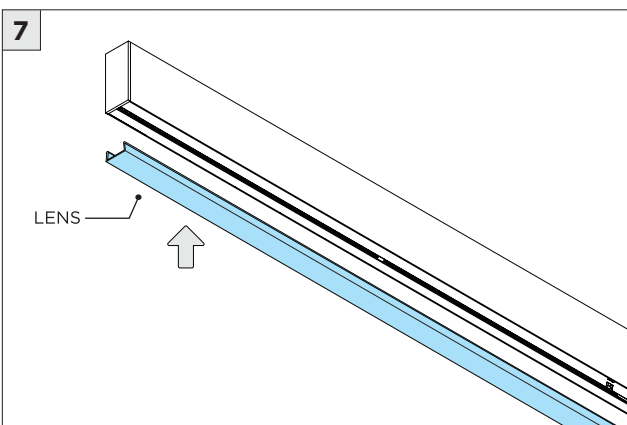
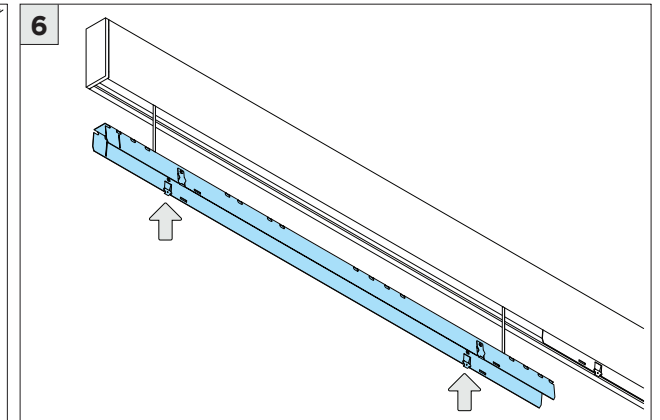
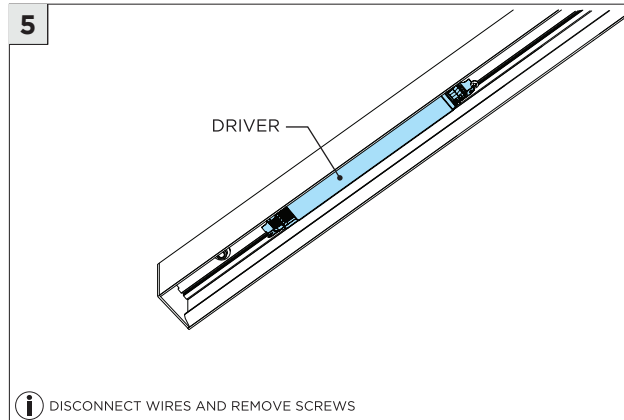
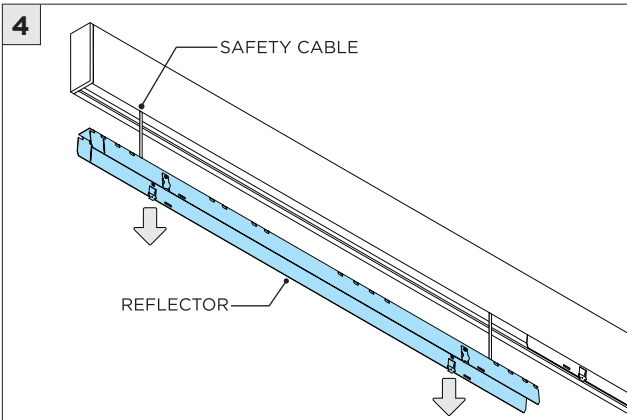
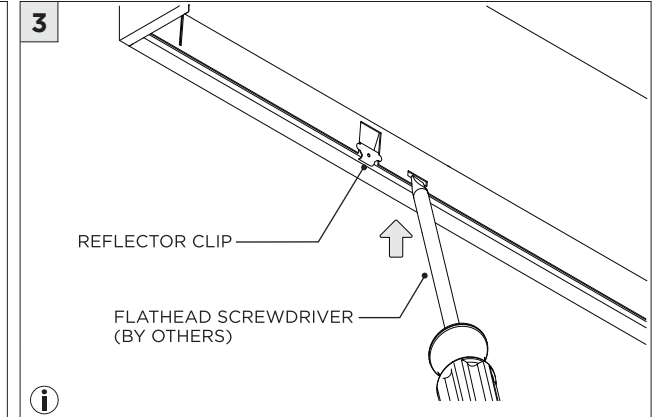
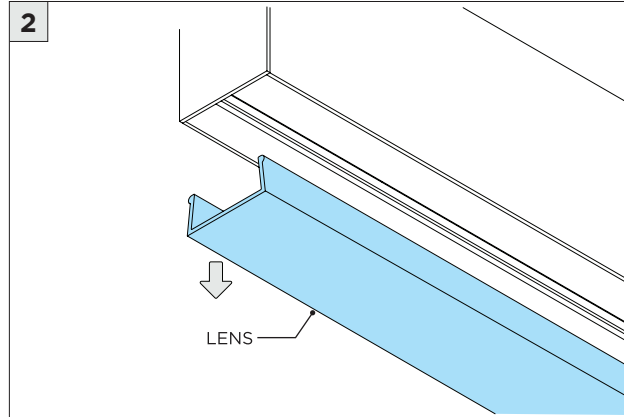
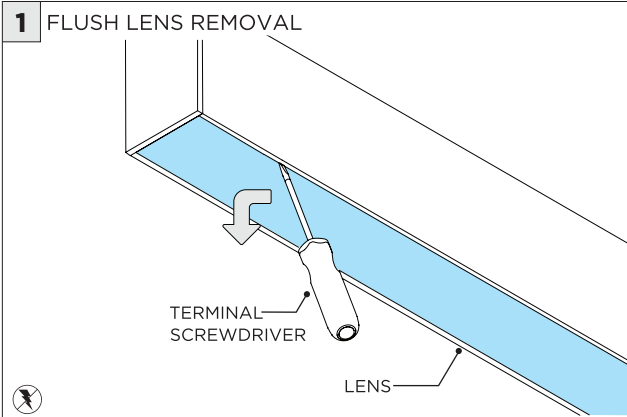

**LED SERVICING - DIRECT**

