



## 3G-1PLI-I

1.5" LINEAR PENDANT  
INDIRECT ONLY  
TUNABLE WHITE & RGBW

Narrow 1.5" aperture with one piece extruded aluminum housing  
Individual or continuous runs available in multiple run configurations  
Indirect distribution with multiple lumen output options  
LED system with performance up to 145 lumens per watt  
Extruded acrylic lens with optimal performance and glare control  
Widespread and Asymmetric optics available  
1% dimming standard with several driver options



**3GT** **3GB**

### ORDERING INFORMATION

PROJECT:		TYPE:	
CATALOG #:		DATE:	

CAT. NO	LED SOURCE	LUMEN OUTPUT	CRI	VOLTAGE
3G-1PLI-I	<b>TW</b> - TUNABLE WHITE (2700K-6500K) <b>RGBW</b> - INFINITE COLOUR <sup>1</sup> (3500K WHITE)	<b>L250</b> - LOW OUTPUT (250 LM/FT) <sup>2</sup> <b>L500</b> - MEDIUM OUTPUT (500 LM/FT) <b>L750</b> - HIGH OUTPUT (750 LM/FT) <b>L1000</b> - VERY HIGH OUTPUT (1000 LM/FT) <sup>3</sup> <b>LC___</b> - CUSTOM OUTPUT (SPECIFY LM/FT)*  *Specify custom lumen outputs in 50lm increments (ie: LC600, LC650, LC700) Custom output cannot exceed LC1000	<b>S80</b> - 83+ CRI <b>H90</b> - 93+ CRI <sup>1</sup>	<b>UNV</b> - 120/277V

DRIVER	LENS OPTION	FINISH	CABLE LENGTH
<b>DO1</b> - 0-10V (100-0.1%) <b>DALI</b> - DALI (eidoLED, 100-1%) <sup>3</sup> <b>DHLT</b> - LUTRON T SERIES (100-0.1%) (2 CHANNEL TUNABLE WHITE) <b>DMX</b> - DMX (100-1%)	<b>FL</b> - FLUSH LENS <b>WSO</b> - WIDESPREAD OPTIC <sup>1</sup> <b>ASY</b> - ASYMMETRIC OPTIC <sup>1,3</sup>	<b>WH</b> - WHITE (STANDARD) <b>SV</b> - SILVER <b>BK</b> - BLACK  All mounting canopies provided in white as standard	<b>60"</b> - 60" (STANDARD) <b>120"</b> - 120"

OPTIONS	LENGTH (FEET)
<b>EMC</b> - EMERGENCY CIRCUIT <sup>4</sup>	<b>S</b> - ___' (STRAIGHT RUN)* <b>L</b> - ___'X ___' (L-SHAPE) <b>U</b> - ___'X ___' X ___' (U-SHAPE) <b>R</b> - ___'X ___' (RECTANGLE/SQUARE)  *Individual units available from 2' to 8' Continuous runs available in 1' increments

- <sup>1</sup> RGBW LED source available with S80 (83+CRI) and DMX driver option only. Not available with asymmetric optic or EM options  
<sup>2</sup> L250 (250LM/FT) not available in 2' and 3' lengths. Specify LC400 for 2' and 3' fixture lengths when outputs lower than 500LM/FT are required  
<sup>3</sup> L1000 (1000LM/FT) not available for H90 (93+ CRI) or indirect asymmetric option  
<sup>4</sup> EMC (emergency circuit) options available for tunable white LED source only. Not available with RGBW

**3GT** - Tunable White  
**3GB** - RGBW

JANUARY 4, 2024



### PERFORMANCE CHART BASED ON 4' LENGTH WITH FLUSH LENS (TUNABLE WHITE AND 83+ CRI)

FLUSH	DELIVERED LUMENS (LM/FT)	SYSTEM WATTS (W/FT)	EFFICACY (LPW)
2700K	250	1.9	120
	500	4.2	116
	750	6.1	115
	1000	8.6	114
3500K	250	1.9	129
	500	4.2	128
	750	6.1	123
	1000	8.6	118
6500K	250	1.9	145
	500	4.2	144
	750	6.1	141
	1000	8.6	132
EFFICACY (LPW) ADJUSTMENT FACTOR	CRI	Multiplier	
	93+	0.88	

### PHOTOMETRY BASED ON 4' LENGTH (83+ CRI AND 3500K SOURCE)

#### FL - FLUSH

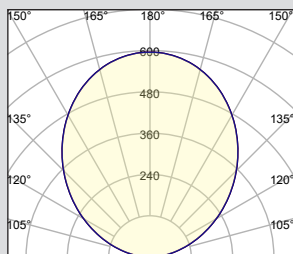

#### 3G-1PLI-I-TW-L500-FL

DELIVERED LUMENS: 500LM/FT (2000LM)  
SYSTEM WATTS: 4.2W/FT (16.8W)  
EFFICACY: 128LPW  
CRI: 83+  
CCT: 3500K  
LENS OPTION: FLUSH

#### ASY - ASYMMETRIC OPTIC

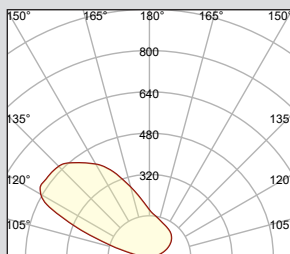

#### 3G-1PLI-I-TW-L500-ASY

DELIVERED LUMENS: 500LM/FT (2000LM)  
SYSTEM WATTS: 4.2W/FT (16.8W)  
EFFICACY: 58LPW  
CRI: 83+  
CCT: 3500K  
LENS OPTION: ASYMMETRIC

#### WSO - WIDESPREAD OPTIC

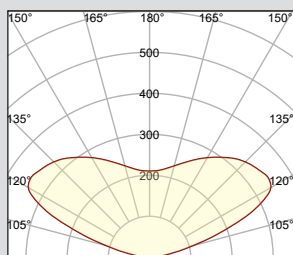

#### 3G-1PLI-I-TW-L500-WSO

DELIVERED LUMENS: 500LM/FT (2000LM)  
SYSTEM WATTS: 4.2W/FT (16.8W)  
EFFICACY: 94LPW  
CRI: 83+  
CCT: 3500K  
LENS OPTION: WIDESPREAD

### PERFORMANCE CHART BASED ON 4' LENGTH (RGBW WITH 83+ CRI AND 3500K SOURCE)

FLUSH	DELIVERED LUMENS (LM/FT)	SYSTEM WATTS (W/FT)	EFFICACY (LPW)
3500K	250	1.8	136
	500	3.8	134
	750	6.2	121
	1000	9.1	110
LUMINOUS INTENSITY PER LED	RGB	INTENSITY Min - Max (mcd)	
	RED	355 - 805	
	GREEN	710 - 1400	
	BLUE	140 - 355	

### PHOTOMETRY BASED ON 4' LENGTH (83+ CRI AND 3500K SOURCE)

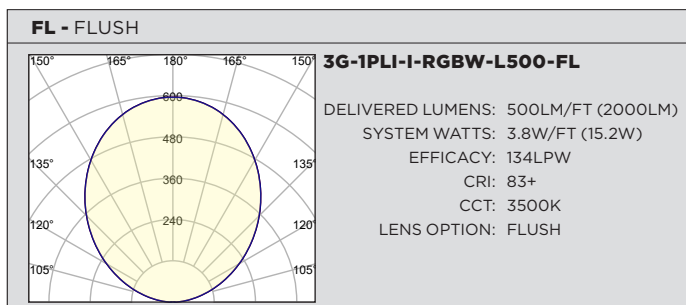

**TECHNICAL****HOUSING**

Extruded aluminum housing with narrow 1.5" aperture  
Machined aluminum end caps add 1/4" to each end of luminaire  
Individual units and continuous runs available in 1' increments  
24-gauge LED reflector with high reflectance white powder coated finish  
Standard polyester powder coated matte white finish. Optional finishes available

**OPTICS**

Extruded, satin acrylic lens designed for optimal performance and glare control  
High performance widespread and asymmetric optics available  
Widespread Optic peak intensity at 120° with optimal mounting distance of 12" to 30" from ceiling

**ELECTRICAL**

Luminaires are pre-wired with factory installed quick connects and branch circuit wiring  
Multiple driver options available for tunable white LED system  
DMX driver option for RGBW system with RDM control and 100-0% dimming range  
All drivers are integral and easily accessible through luminaire aperture

**LED SYSTEM FOR TUNABLE WHITE (TW)**

Proprietary LED system with color consistency <3 SDCM  
2700K-6500K CCT range  
Standard 83+CRI. Optional 93+CRI. (R9 value of 56 for 93+CRI)  
L90 >60,000 hours  
5 Year Warranty

**LED SYSTEM FOR RGBW**

Proprietary LED system with color consistency <3 SDCM  
White LED available in 35K with 83+ CRI  
L80 >72,000 hours  
Red (335-805 mcd)  
Green (710-1400 mcd)  
Blue (140-355 mcd)  
5 Year Warranty

**MOUNTING**

Toolless installation with 3G's proprietary mounting system  
Internal, toolless joiner system (latch and hook) easily connects multiple sections together  
Adjustable aircraft cable suspension with locking fasteners (60" length standard)  
White cable and white mounting canopies provided as standard  
Suitable for various architectural ceilings (see mounting details)  
Fixture weight: +/- 2 lbs/ft

**LISTING**

ETL listed and tested to cUL standards. Suitable for dry and damp locations

**WARRANTY**

5 Year Warranty on LED and drivers  
Manufacturer 1 Year Warranty for defects in material and workmanship under normal use  
Ambient temperature at fixture should not exceed 25°C

### DRAWINGS AND DIMENSIONS

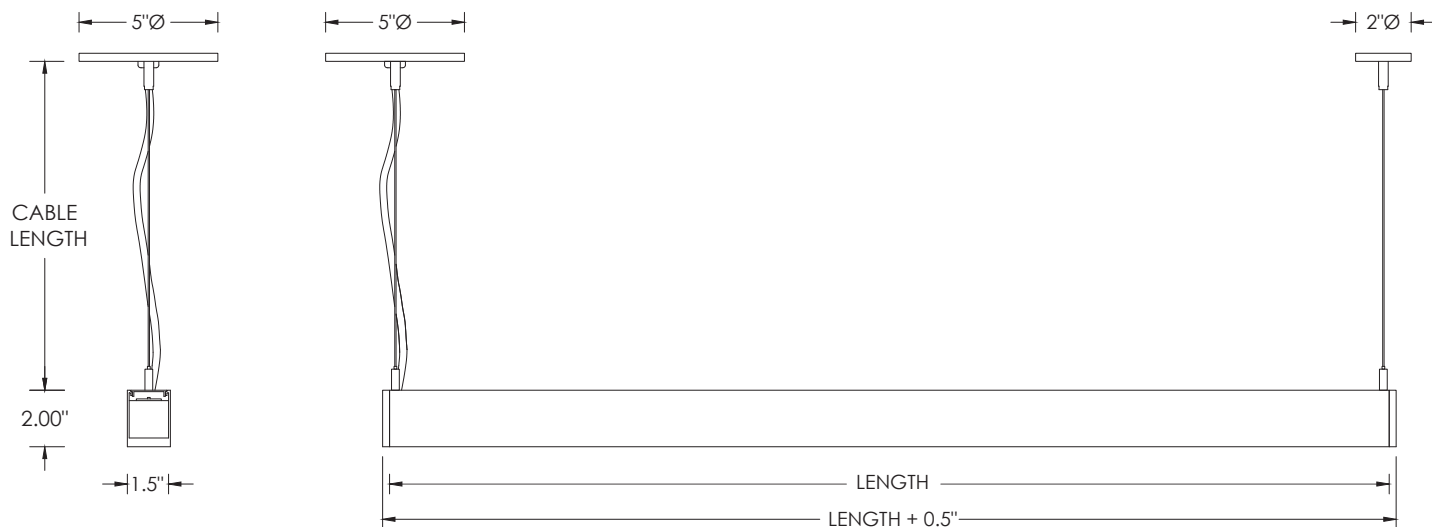

### LENS OPTION

**FL - FLUSH**    **WSO - WIDESPREAD**    **ASY - ASYMMETRIC**

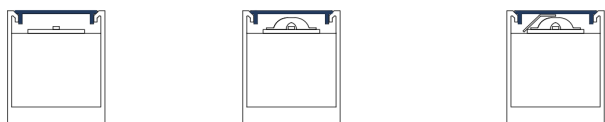

### PATTERNS

Specify pattern shape and overall dimensions as shown below  
 Patterns are connected with 12"x12" L-shaped sections  
 Please consult factory for custom patterns not shown below



L-SHAPE	U-SHAPE	RECTANGLE/SQUARE
Provide dimensions of AxB Example: <b>L</b> - 6'x8'	Provide dimensions of AxBxC Example: <b>U</b> - 8'x10'x6'	Provide dimensions of AxB Example: <b>R</b> - 10'x8'

### TYPICAL SECTION MOUNTING (AVAILABLE IN 1' INCREMENTS AS STANDARD)

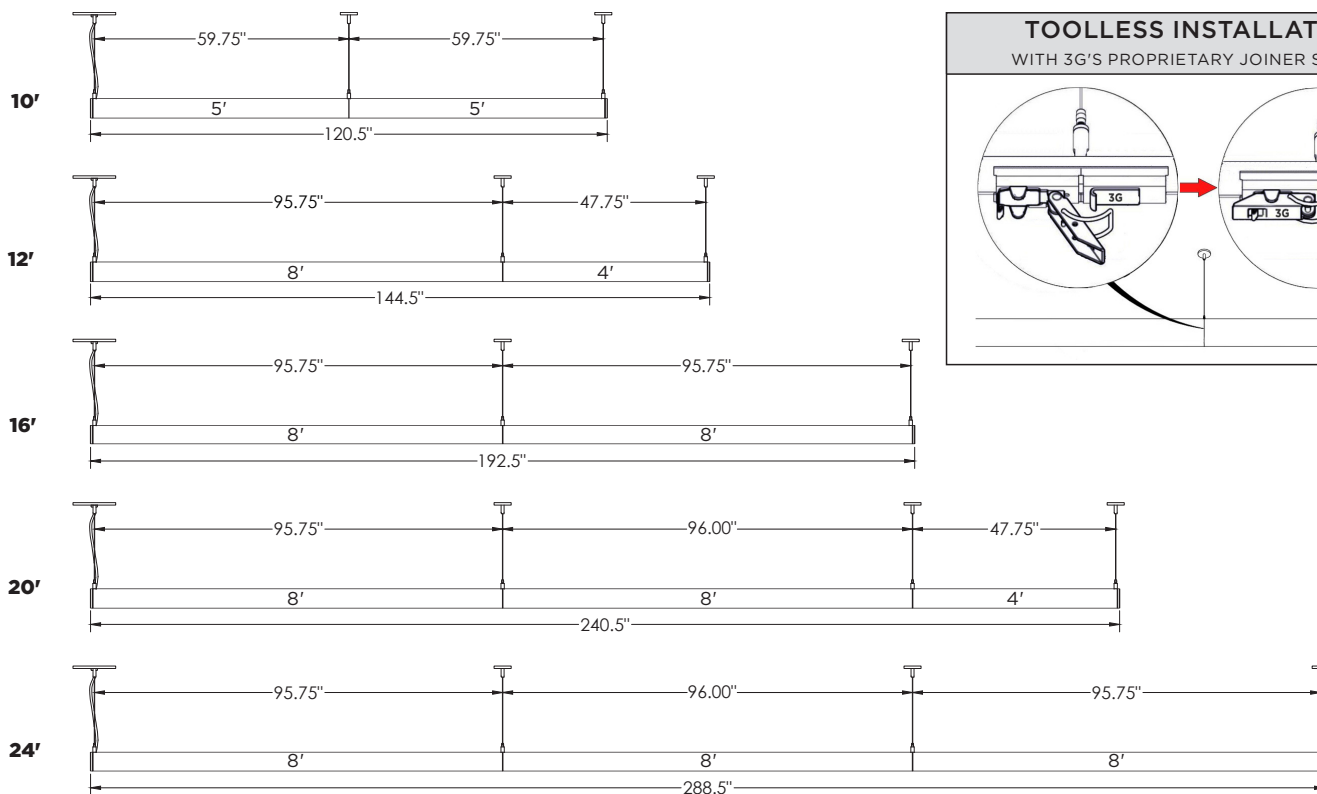

### TOOLLESS INSTALLATION

WITH 3G'S PROPRIETARY JOINER SYSTEM

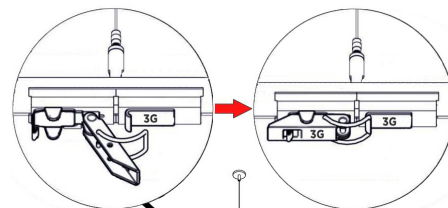

### MOUNTING DETAILS

