



## 3G-RMZ12WW

12" ZOIE WALL WASH DOWNLIGHT  
RECESSED

12" linear wall wash downlight with narrow 1.14" aperture  
Standard 90+ CRI LED system with performance up to 91 LPW  
Delivered lumen range up to 2500lm at 90+ CRI  
Proprietary wall wash optic and lens with enhanced glare control  
Matte black and matte white louver finish  
Companion to 3G's Zoie product family



PROJECT:					TYPE:			
CATALOG#:					DATE:		QTY:	

CAT. NO	LUMEN OUTPUT	CRI	COLOR TEMP	BEAM ANGLE	VOLTAGE
3G-RMZ12WW	10 - 1000 LUMENS 15 - 1500 LUMENS 20 - 2000 LUMENS 25 - 2500 LUMENS <sup>1</sup>  All lumen outputs are delivered lumens at 90+ CRI	H90 - 90+ CRI	27K - 2700K 30K - 3000K 35K - 3500K 40K - 4000K	WW - WALL WASH	UNV - 120/277V 120 - 120V 347 - 347V <sup>2</sup>

DRIVER	FLANGE TYPE & LOUVER FINISH	HOUSING TYPE
DIM - 0-10V (100-1%) LE - PHASE DIM (TRIAC/ELV, 100-1%) <sup>3</sup> D01 - 0-10V (100-0.1%) DALI - DALI (100-1%) <sup>4</sup> DHL2 - LUTRON HI-LUME (1% ECOSYSTEM) DMX - DMX (100-0%)	WT - WHITE TRIM & WHITE LOUVER BT - BLACK TRIM & BLACK LOUVER XTRW - TRIMLESS & WHITE LOUVER XTRB - TRIMLESS & BLACK LOUVER  *Trimless option is for mud-in drywall	RMD - REMODEL HOUSING SH - SHALLOW HOUSING

OPTIONS
CP - CHICAGO PLENUM

<sup>1</sup> 2500lm available with RMD (Remodel Housing) only  
<sup>2</sup> 347 available in "DIM" 0-10V only (100-1%)  
<sup>3</sup> Phase dimming option available in 120V only  
<sup>4</sup> DALI-2 (Type 6) provided as standard. Please consult factory for DALI (Type 8) options

## PERFORMANCE

LUMEN OUTPUT	DELIVERED LUMENS	SYSTEM WATTS	EFFICACY (LPW)
1000	1000	10.9	91
1500	1500	17.0	88
2000	2000	22.9	87
2500	2500	29.0	86

BASED ON 90+ CRI, 3500K, WALL WASH OPTIC  
Lumen output and actual wattage may vary +/- 5%

## HOUSING

Remodel, new construction frame, and shallow housing options available  
IC rated and Chicago Plenum options available  
Maximum ceiling thickness of 1". Consult factory for modifications  
Housing rated for #12 AWG (4 in, 4 out), 90°C conductors and through branch wiring

## TRIM FLANGE

Aluminum trim flange with matte powder coated finish and minimal 0.300" overlap

## TRIMLESS

Mudding flange features a perforated surface for easy mud-in application  
Integral blocking support provided to ensure fixture is properly secured within ceiling structure

## OPTICS

Proprietary high performance wall wash optic and lens  
Uniform illumination across the top and down the wall  
1.14" apertures with enhanced glare control  
Matte black or matte white faceted louver finish

## LED SYSTEM

Standard 90+ CRI  
Color consistency <2 SDCM  
Available in 27K, 30K, 35K, and 40K  
L90 > 60,000 hours

## MULTIPLIERS

COLOR TEMP	
2700K	0.92
3000K	0.97
3500K	1.00
4000K	0.98

## ELECTRICAL

Standard 0-10V, constant current drivers  
100-1% dimming range and >0.9 power factor  
120V Forward Phase/Reverse Phase driver option (100-1%)  
Integral drivers are easily accessible through luminaire aperture  
Remote 120/277V universal voltage driver options

## MOUNTING

Trim fixture designed for use in drywall, wood, acoustic, and other architectural ceilings  
Trimless fixture designed for use in drywall, mud-in ceiling applications  
Recommended ceiling cut-out for remodel fixture: 1.500" x 12.375"  
Adjustable bar hangers extend from 14" to 26"

## LISTING

ETL listed and conforms to UL1598 standard  
Certified to CSA22.2 NO.250.0.  
Rated for dry locations

## WARRANTY

5 year limited warranty  
LED system rated for operation in ambient environments up to 25°C

**RMD - REMODEL FIXTURE (NON-IC) WITH ENCLOSURE (INTEGRAL DRIVER)**

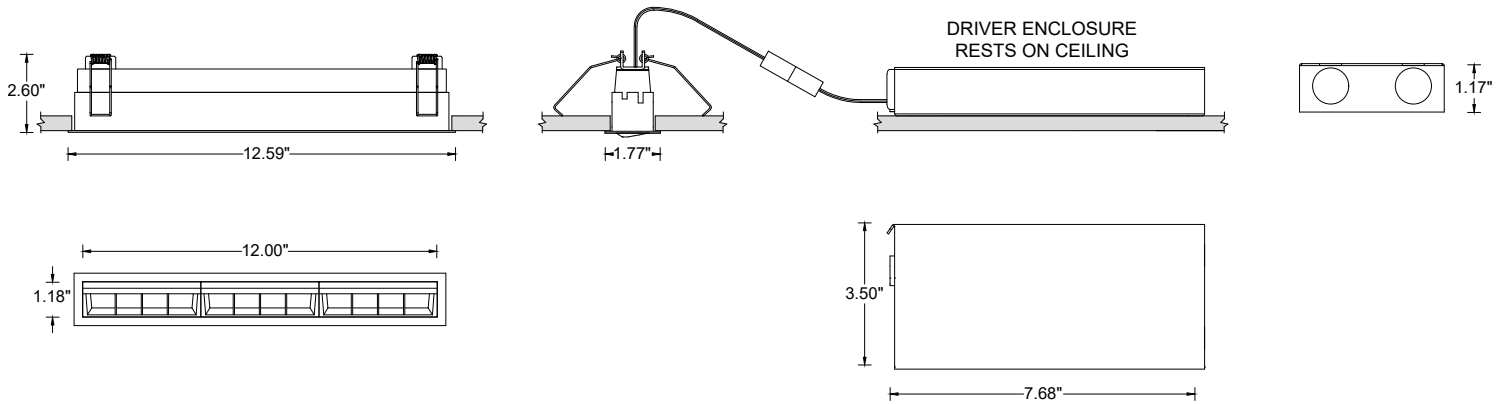

Recommended ceiling cut-out: 1.500" x 12.375"

**SH - SHALLOW HOUSING (INTEGRAL DRIVER) (IC RATED AND CP RATED)**

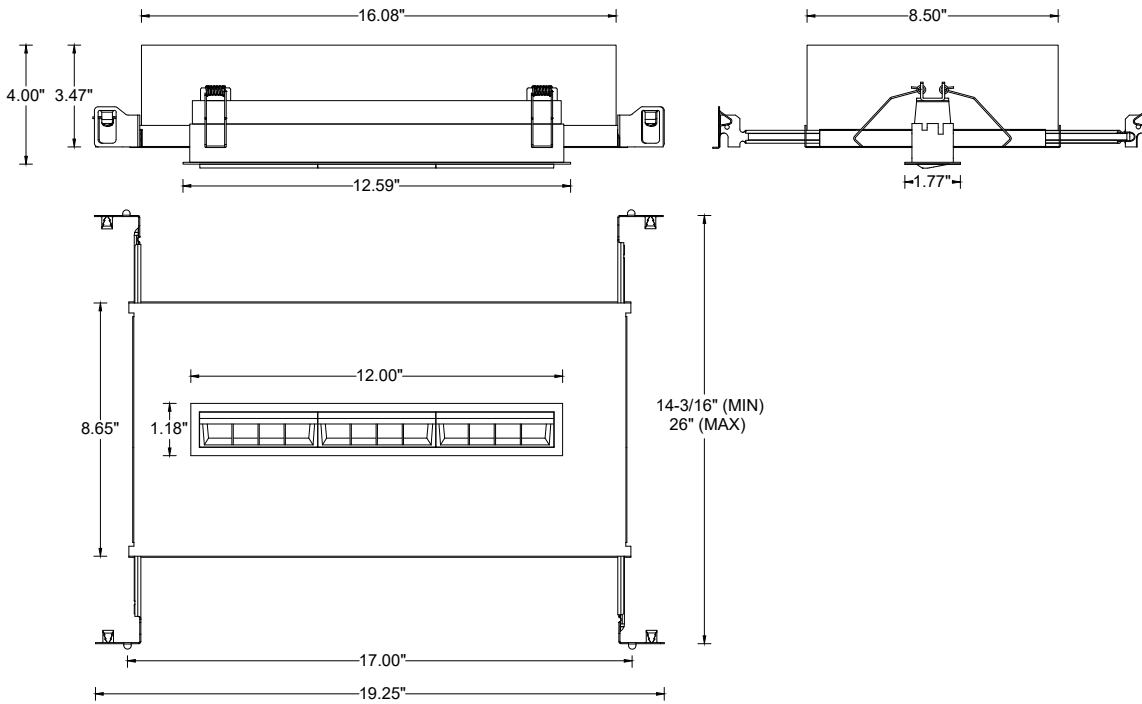

**RMD - REMODEL FIXTURE (NON-IC) WITH ENCLOSURE (INTEGRAL DRIVER)**

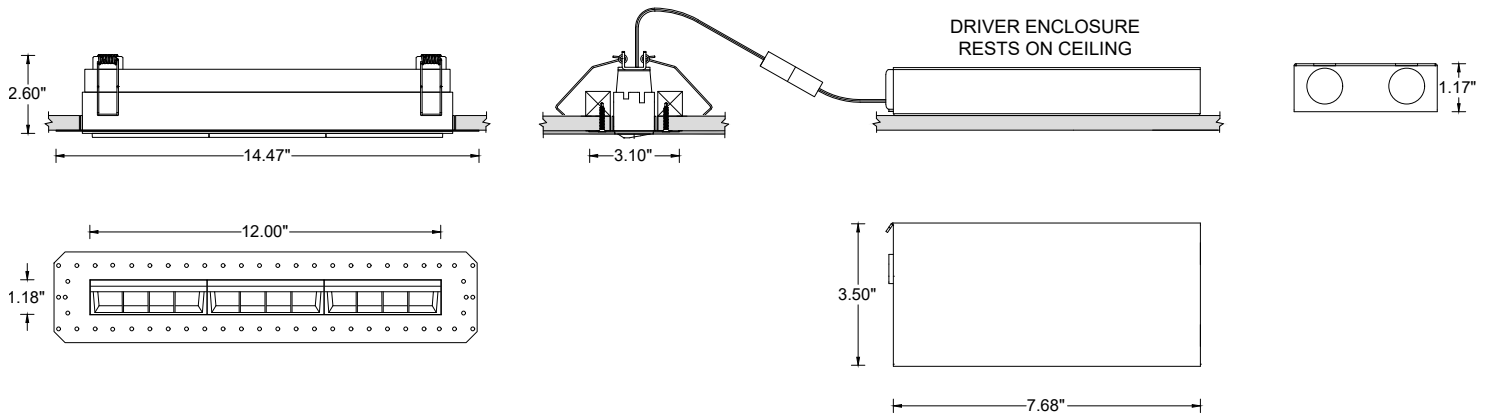

Recommended ceiling cut-out: 15.00" x 12.375"

**SH - SHALLOW HOUSING (INTEGRAL DRIVER) (IC RATED AND CP RATED)**

