

3.3" DOWNLIGHT CYLINDER DEEP REGRESS

SURFACE MOUNT



COMPONENTS

STANDARD CANOPY

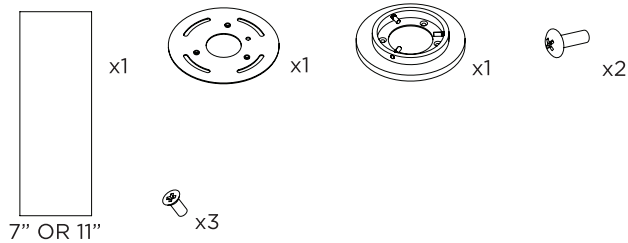

CONDUIT FEED CANOPY

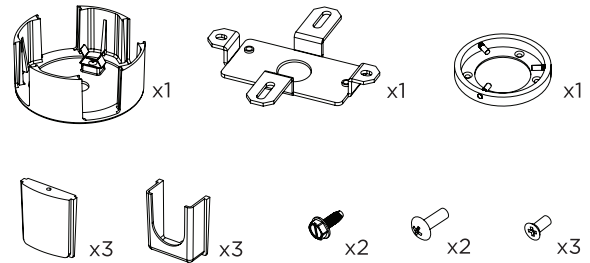

SEAMLESS CANOPY (FOR NEW CONSTRUCTION ONLY)

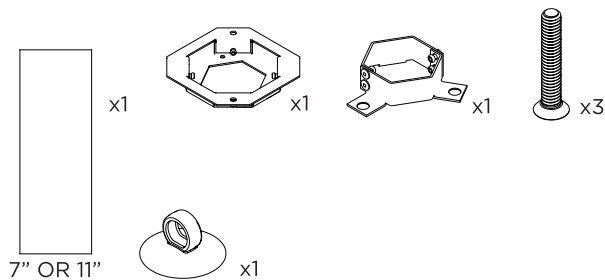

4" OCTAGONAL J-BOX REQUIRED FOR INSTALLATION

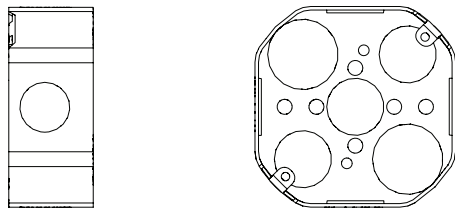

JUNCTION BOX (BY OTHERS)

INSTRUCTION KEY	INFORMATION
⚠ ADDITIONAL	INSTALLATION SHOULD ONLY BE PERFORMED BY A CERTIFIED ELECTRICIAN
ⓘ ATTENTION	REFER TO LOCAL/NATIONAL CODES FOR PROPER INSTALLATION
⚡ POWER ON	FAILURE TO FOLLOW INSTALLATION INSTRUCTION MAY VOID THE WARRANTY
⚡ POWER OFF	DO NOT TOUCH LEDS. LEDS MUST BE PROTECTED FROM MECHANICAL STRESS OR DEBRIS
	TURN OFF POWER DURING INSTALLATION OR SERVICING

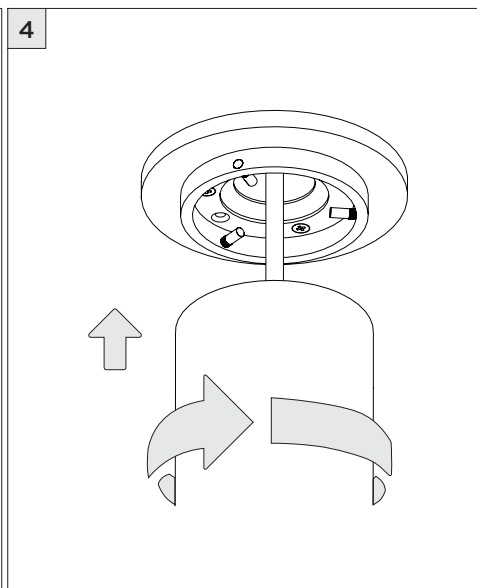
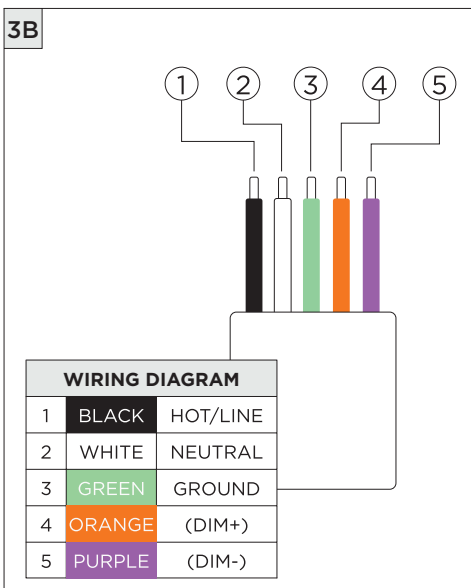
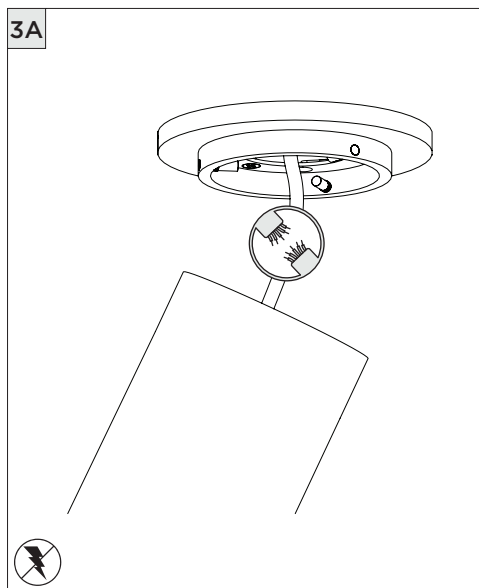
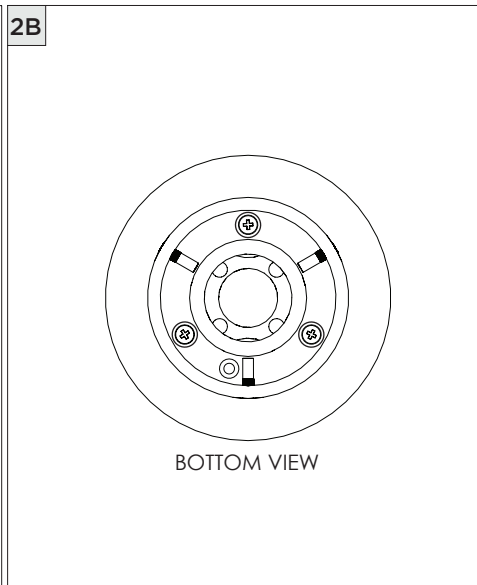
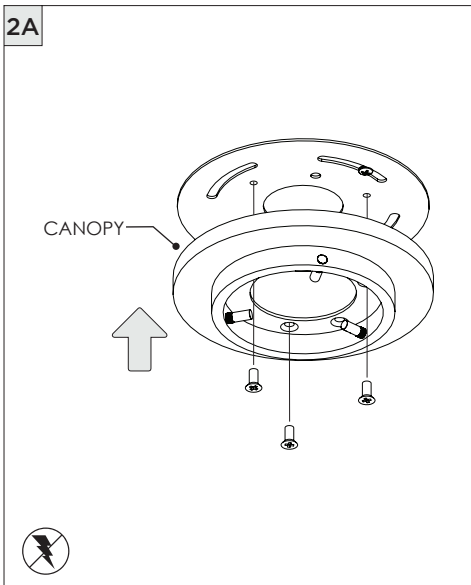
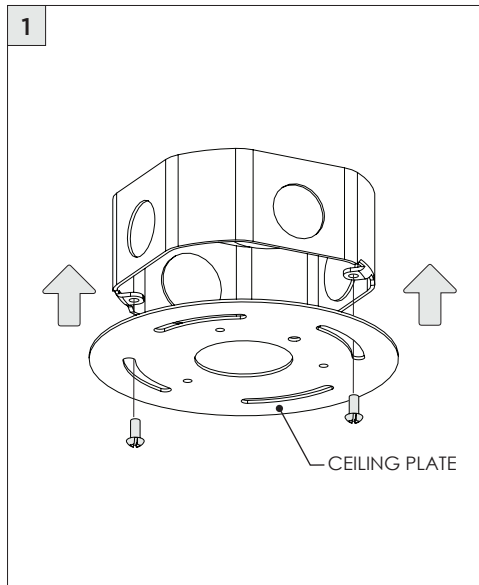

1

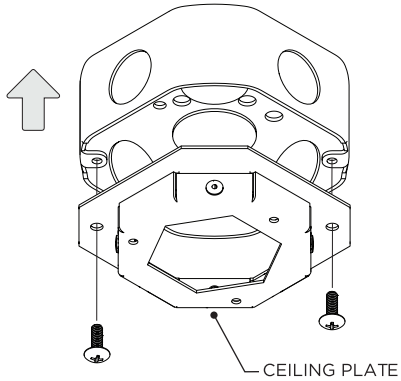

MUST BE INSTALLED PRIOR TO CEILING

1A CEILING CUTOUT

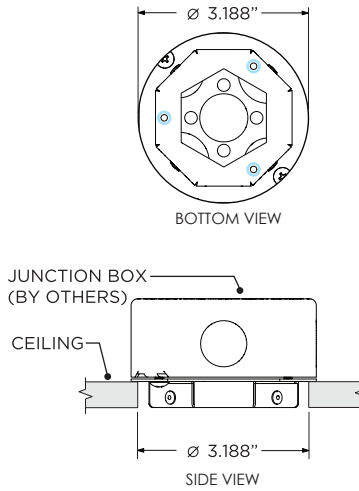

2A

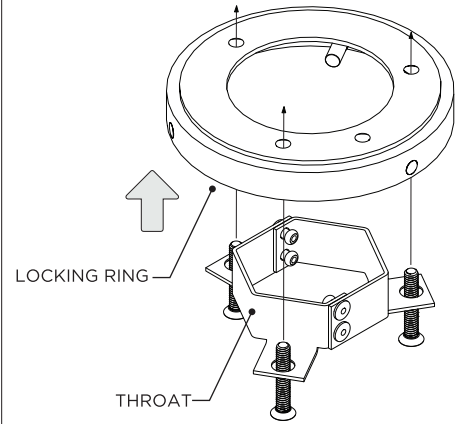

2B

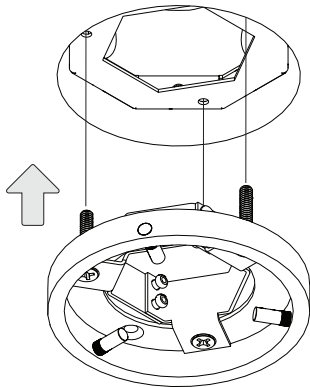

3A

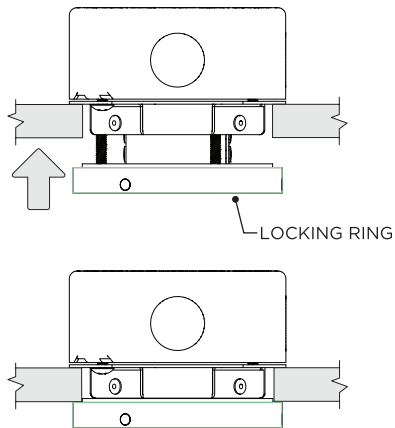

TIGHTEN SCREWS UNTIL LOCKING RING IS FLUSH WITH CEILING

3B

WIRING LEGEND

BLACK	HOT/LINE
WHITE	NEUTRAL
GREEN	GROUND
ORANGE	(DIM+)
PURPLE	(DIM-)

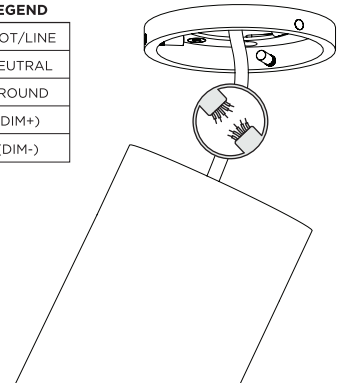

4

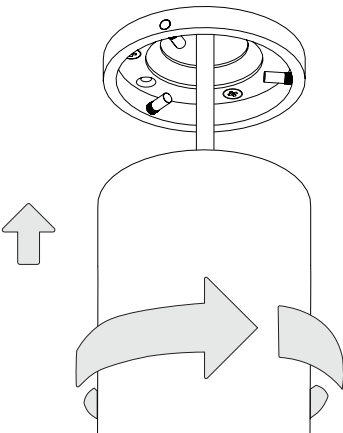

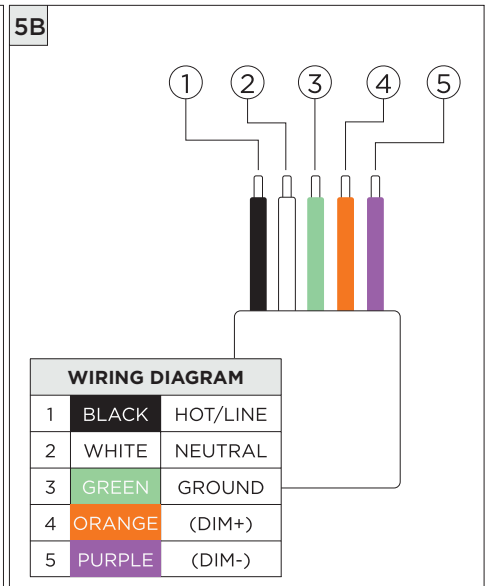
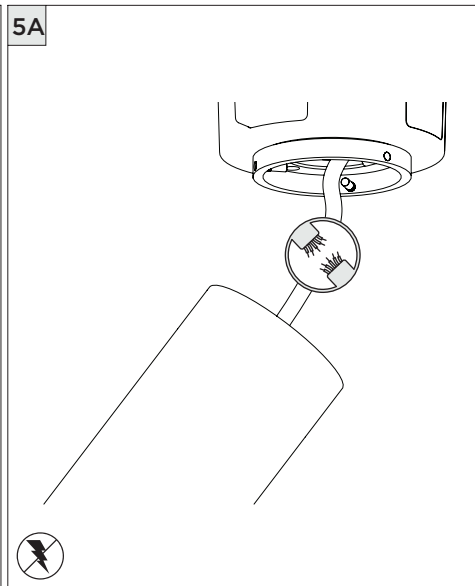
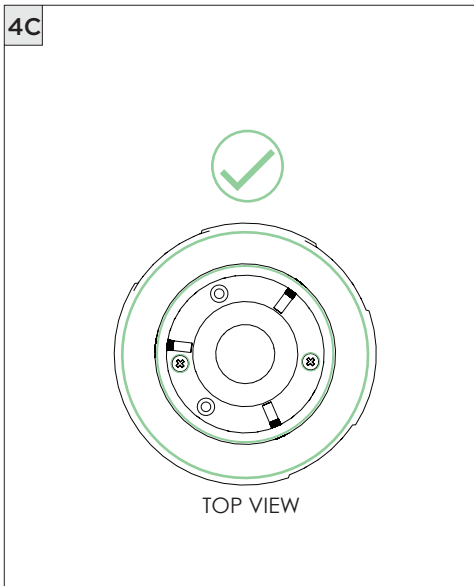
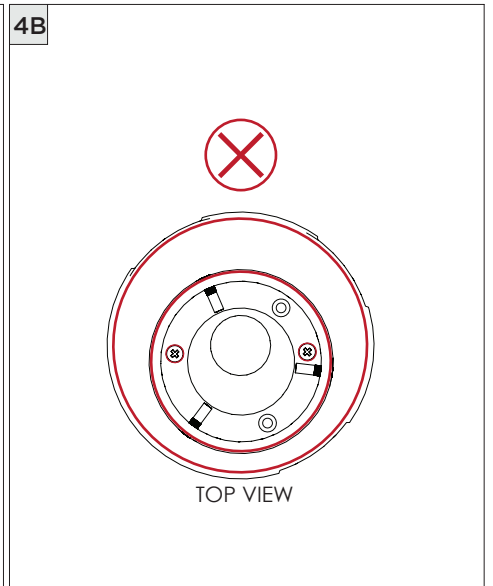
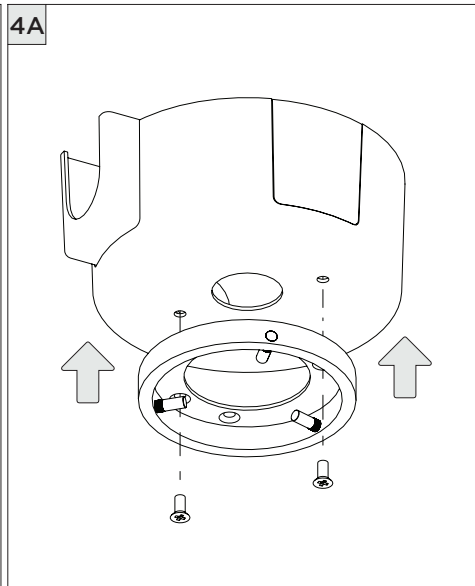
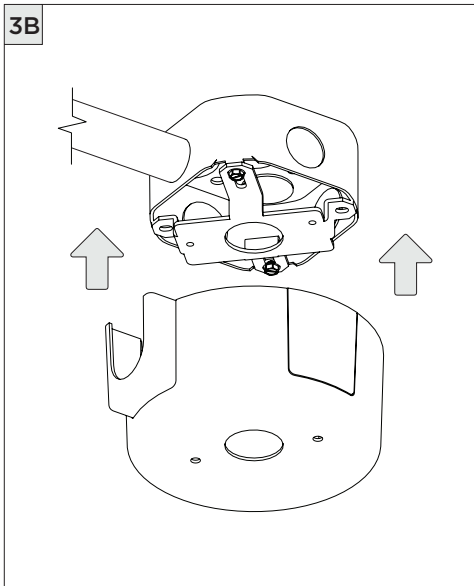
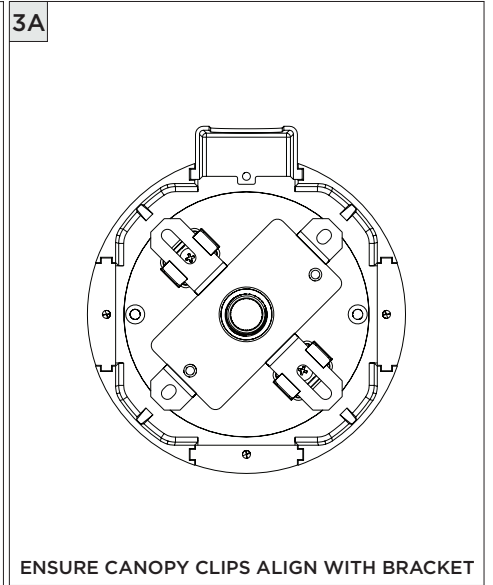
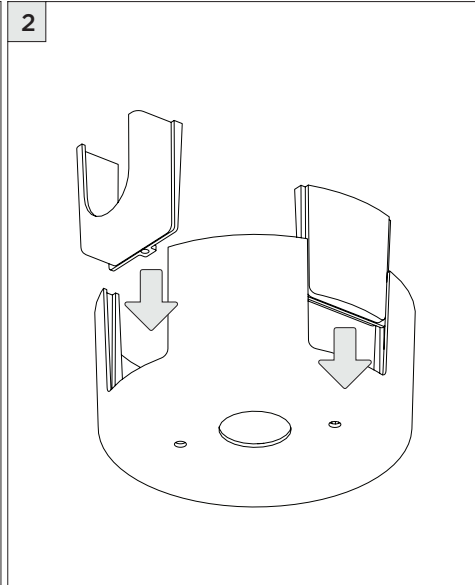
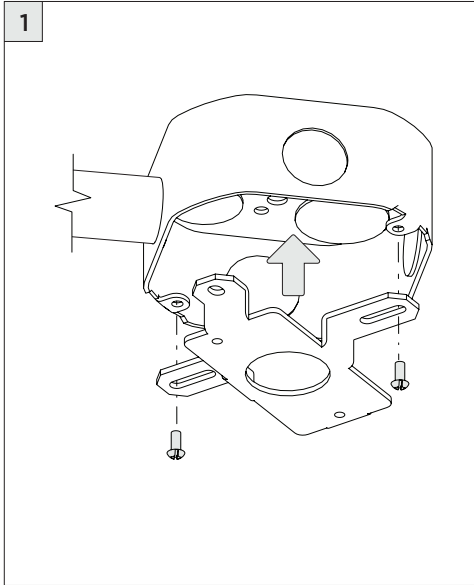

6

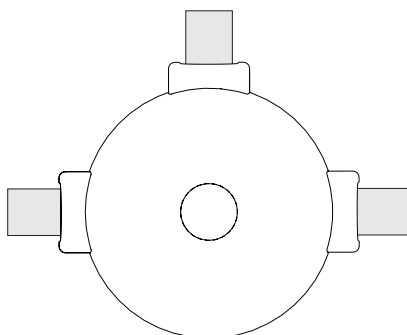
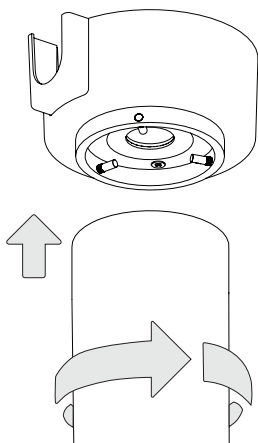

CANOPY IS SUITABLE FOR
MAXIMUM 3 CONDUIT FEEDS

DRIVER SERVICING

1

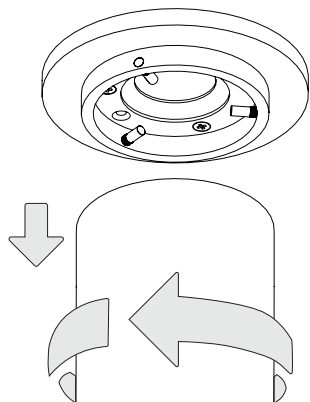

2

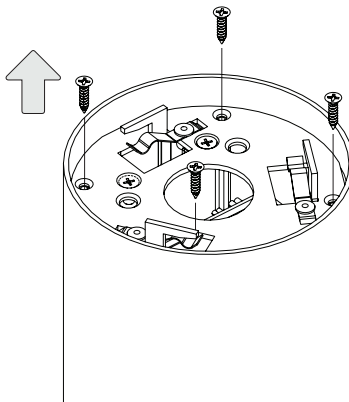

3

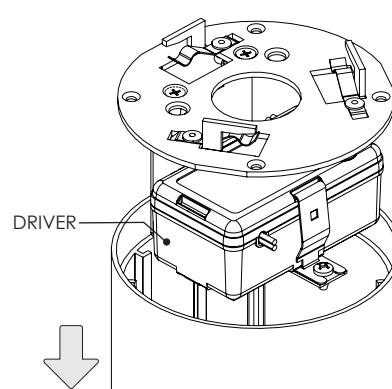

LED SERVICING

1

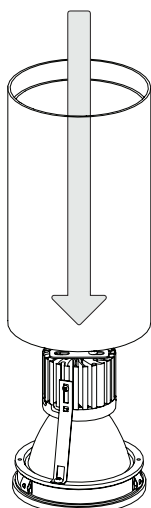

REPEAT DRIVER SERVICING STEPS
DISCONNECT LED WIRES AND REMOVE LED INSERT

2

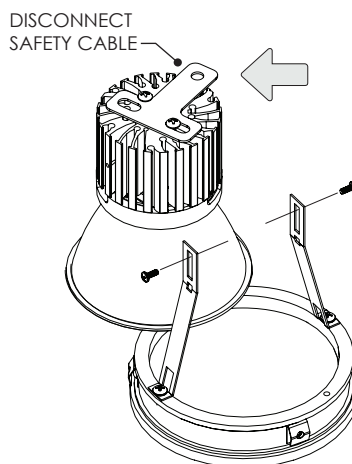

3

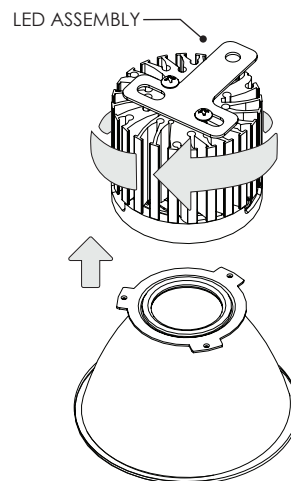

DRIVER SERVICING

1

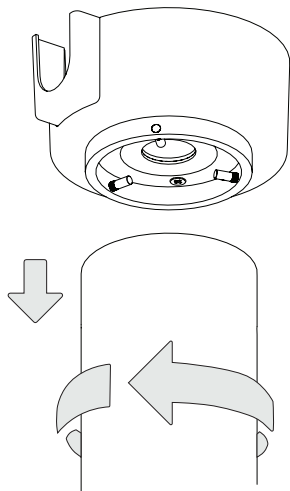

2

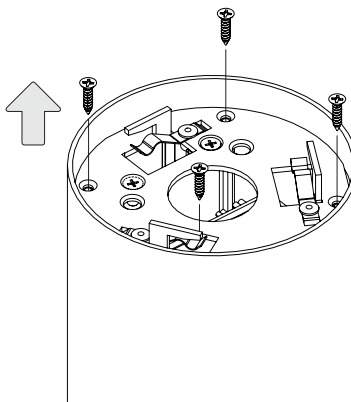

3

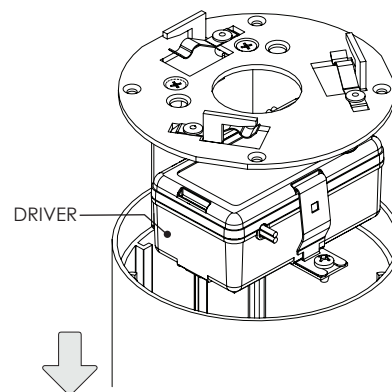

LED SERVICING

1

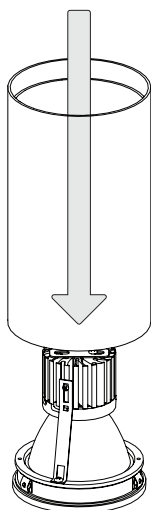

REPEAT DRIVER SERVICING STEPS
DISCONNECT LED WIRES AND REMOVE LED INSERT

2

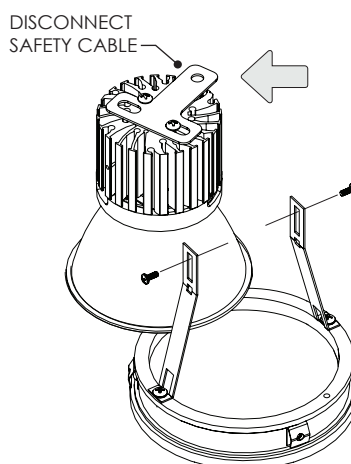

3

