

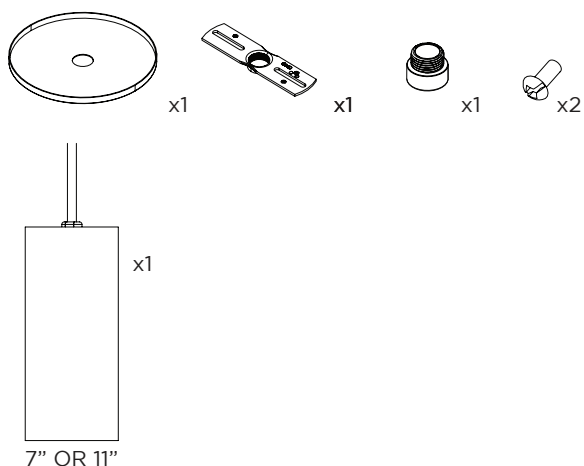

THE IMAGES SHOWN ARE FOR ILLUSTRATION ONLY AND MAY NOT BE AN EXACT REPRESENTATION OF THE PRODUCT

COMPONENTS

STANDARD CANOPY



CONDUIT FEED CANOPY

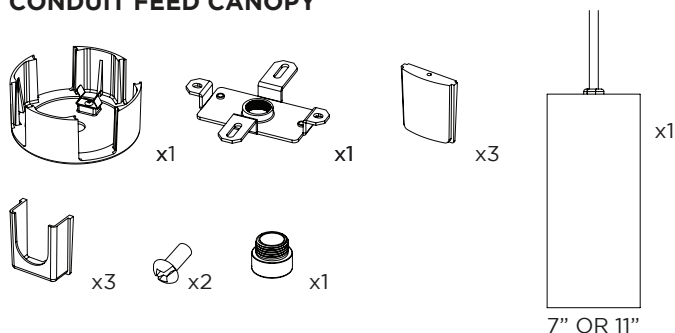

POWER CANOPY

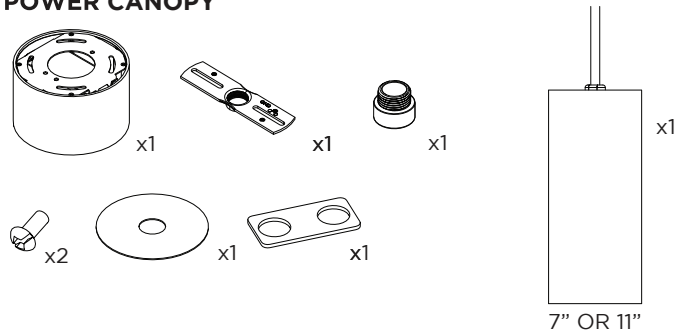

4" OCTAGONAL J-BOX REQUIRED FOR INSTALLATION

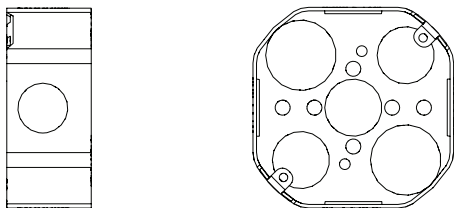

JUNCTION BOX (BY OTHERS)

INSTRUCTION KEY	INFORMATION
⚠ ADDITIONAL	INSTALLATION SHOULD ONLY BE PERFORMED BY A CERTIFIED ELECTRICIAN
ⓘ ATTENTION	REFER TO LOCAL/NATIONAL CODES FOR PROPER INSTALLATION
⚡ POWER ON	FAILURE TO FOLLOW INSTALLATION INSTRUCTION MAY VOID THE WARRANTY
⏻ POWER OFF	DO NOT TOUCH LEDS. LEDS MUST BE PROTECTED FROM MECHANICAL STRESS OR DEBRIS
	TURN OFF POWER DURING INSTALLATION OR SERVICING

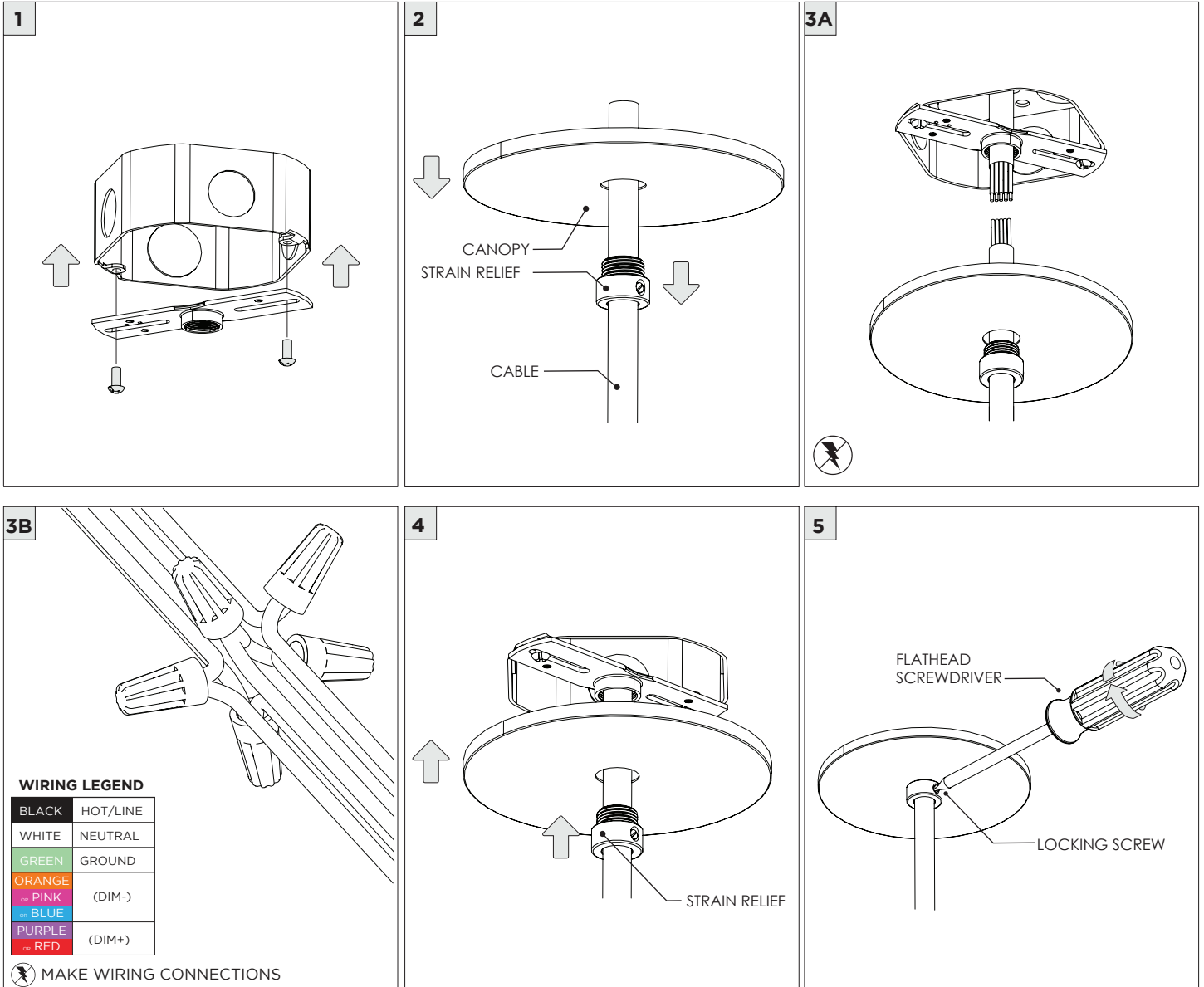

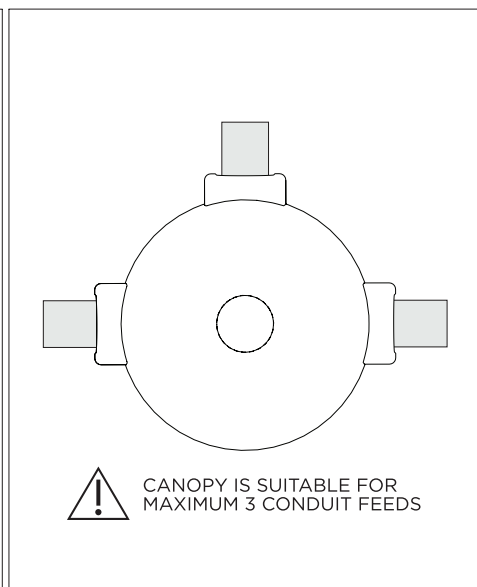
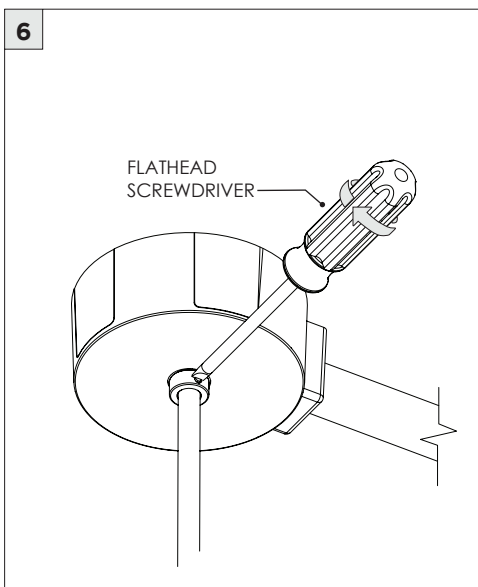
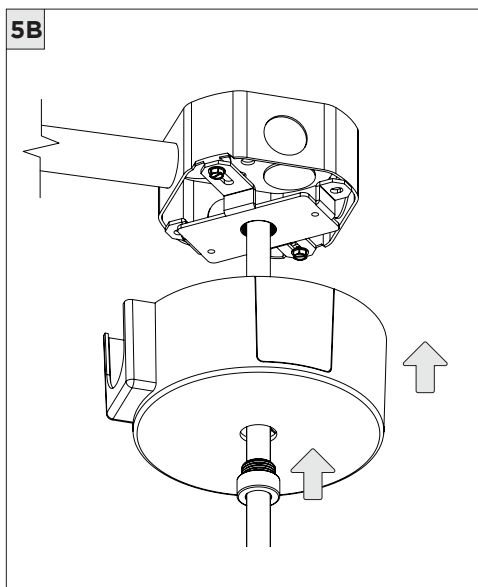
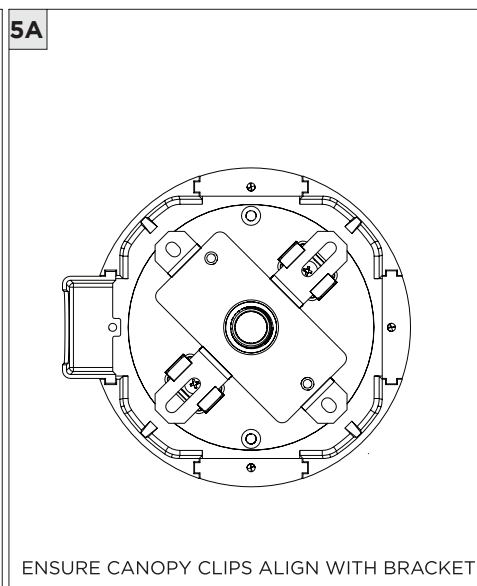
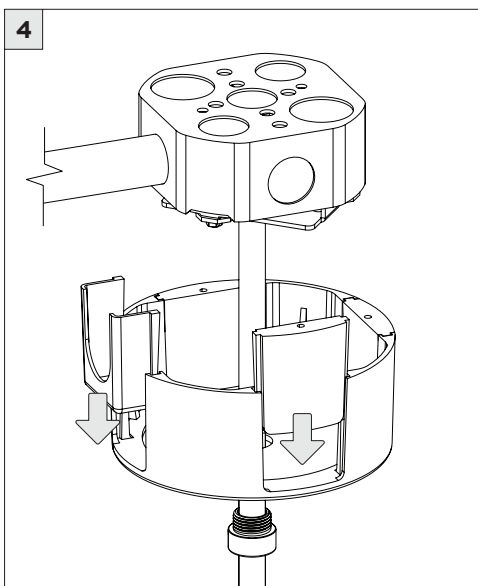
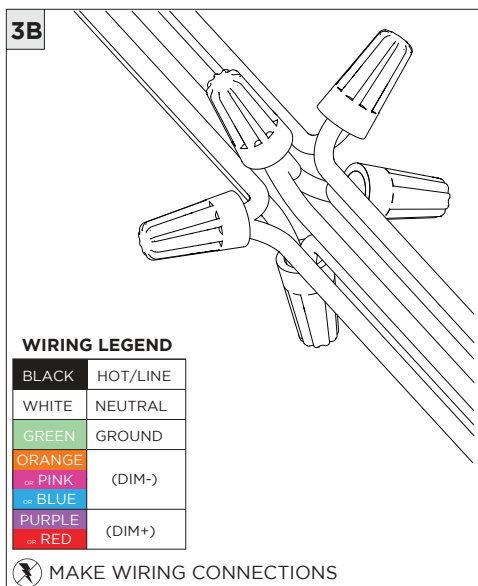
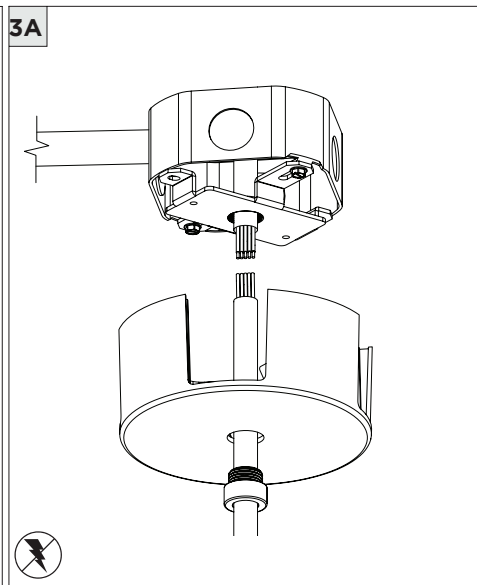
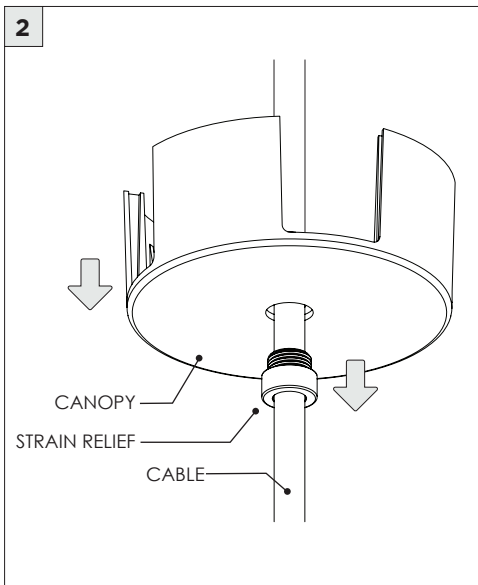
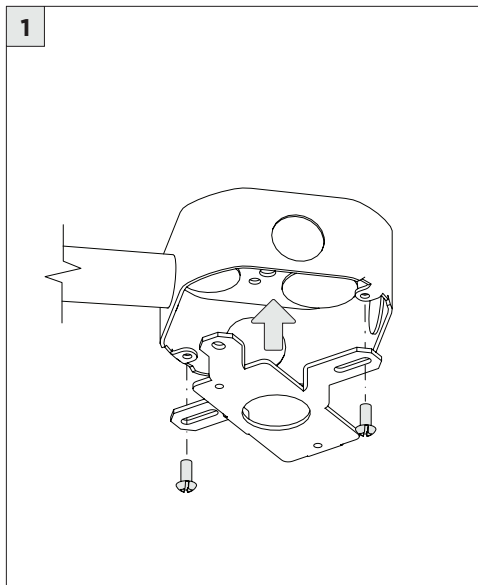

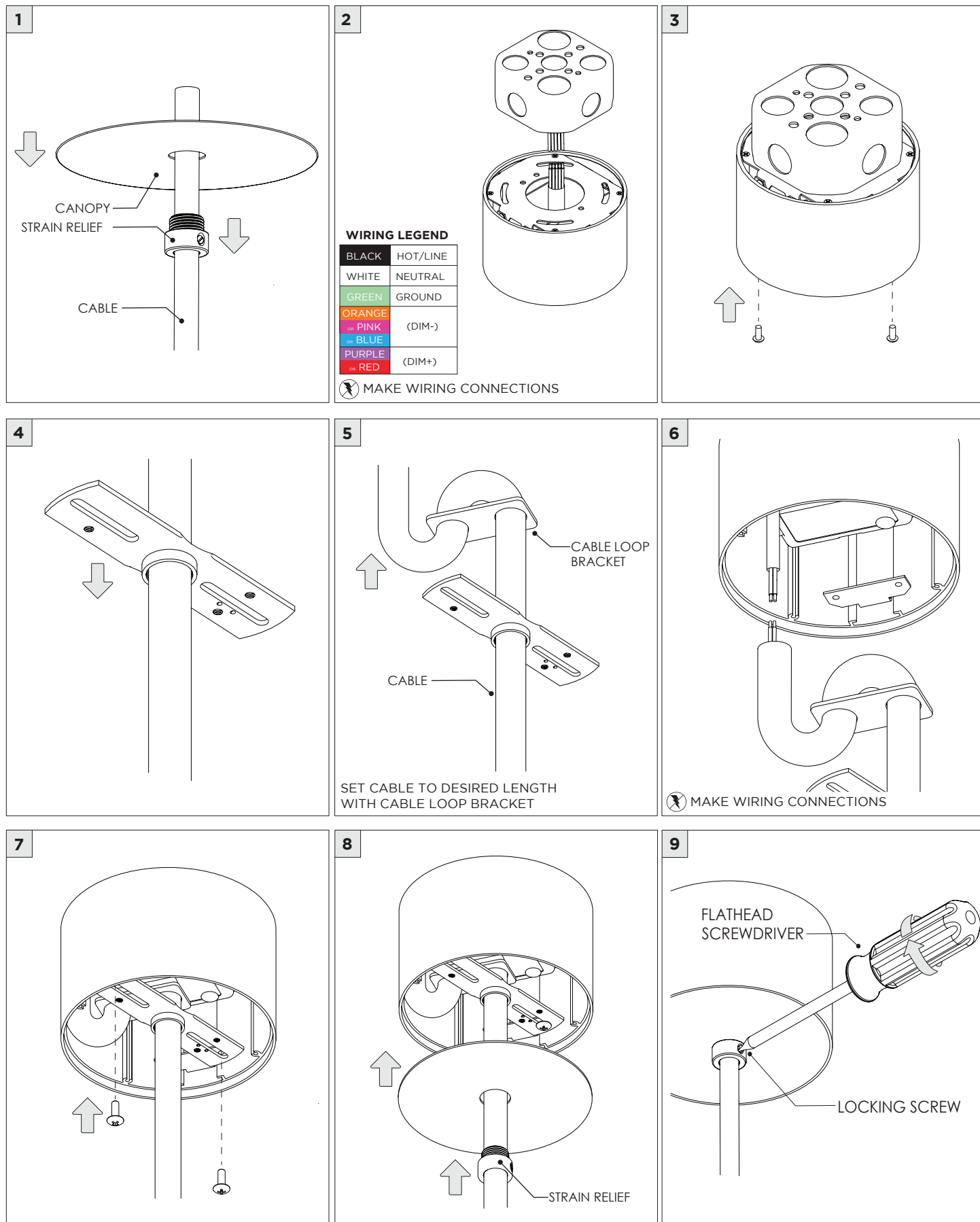

1 CONDUIT FEED CANOPY

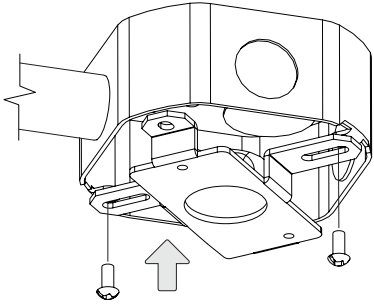

2

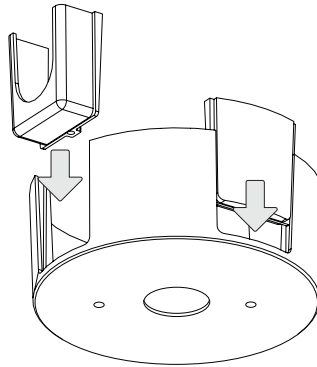

3

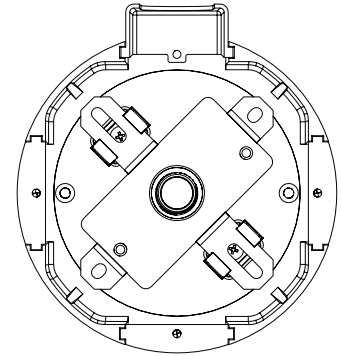

ENSURE CANOPY CLIPS ALIGN WITH BRACKET

4

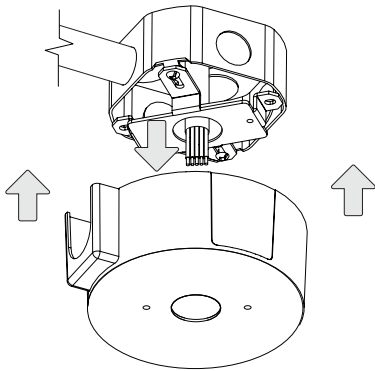

CONNECT CANDUIT CANOPY AND FEED
JUNCTION BOX WIRES THROUGH HOLE

5

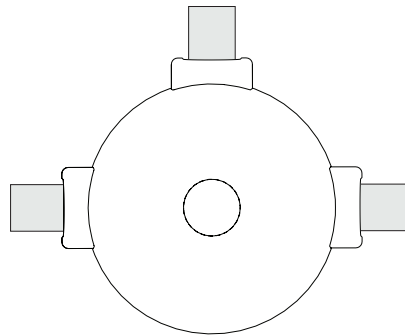

! CANOPY IS SUITABLE FOR
MAXIMUM 3 CONDUIT FEEDS

6 POWER CANOPY

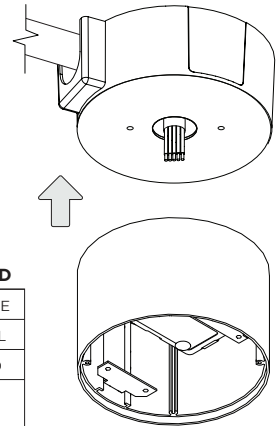

WIRING LEGEND

BLACK	HOT/LINE
WHITE	NEUTRAL
GREEN	GROUND
ORANGE	(DIM-)
PINK	(DIM-)
BLUE	(DIM-)
PURPLE	(DIM+)
RED	(DIM+)

⚡ MAKE WIRING CONNECTIONS

7

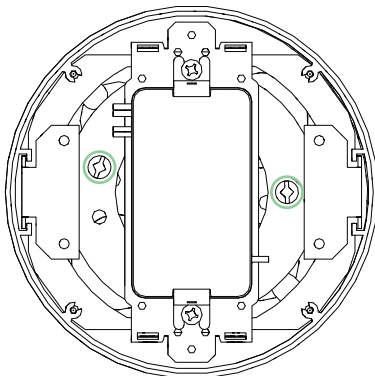

8

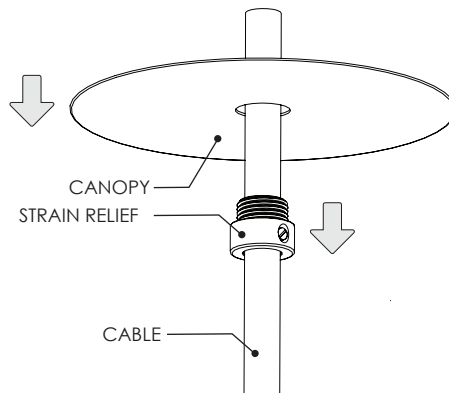

CANOPY
STRAIN RELIEF
CABLE

9

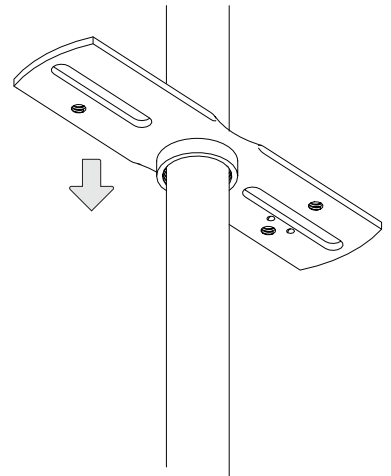

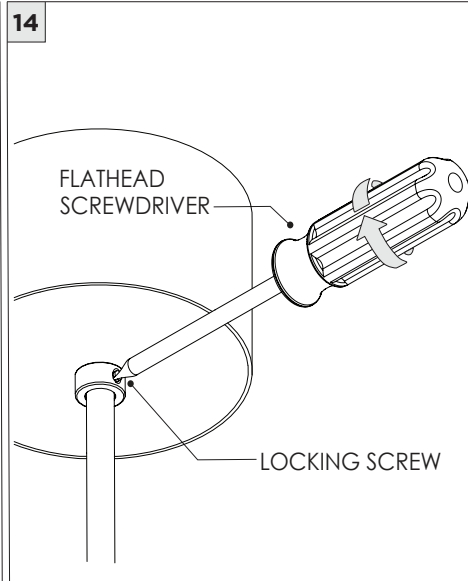
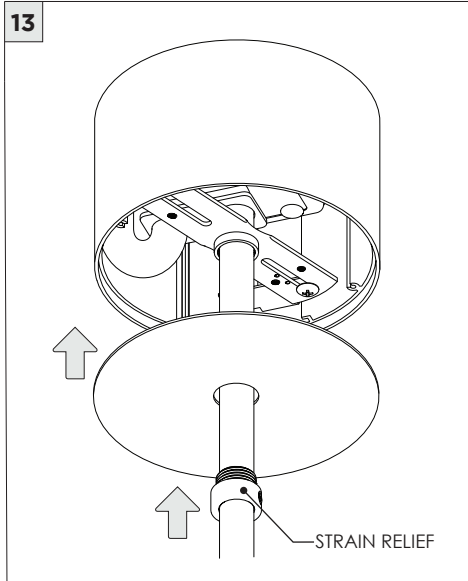
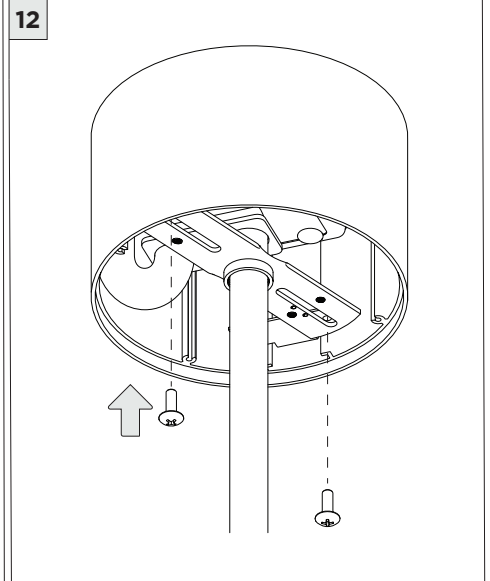
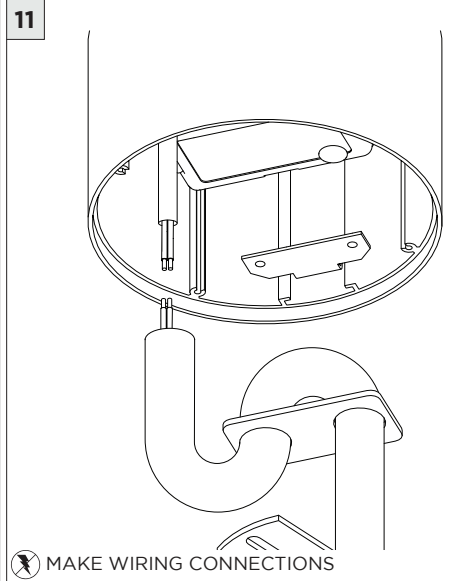
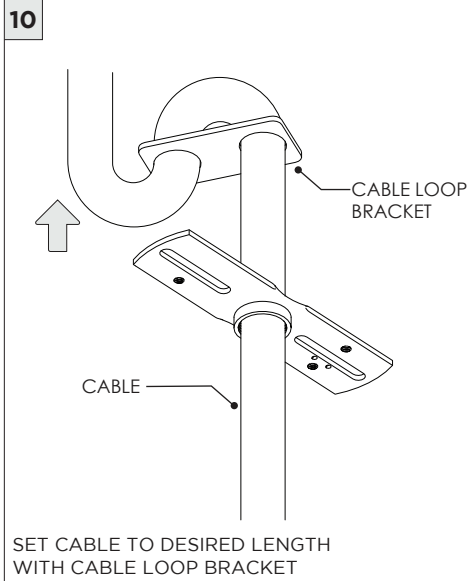

DRIVER SERVICING

1A

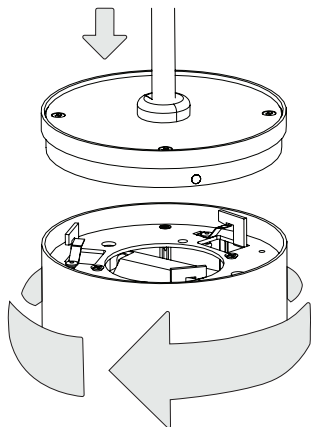

2

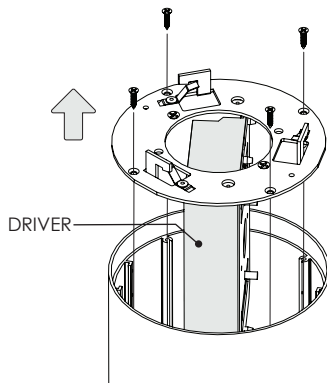

LED SERVICING

1

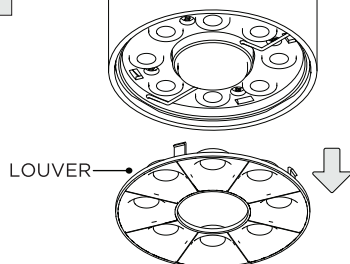

UNCLIP LOUVER FROM LED ASSEMBLY

2

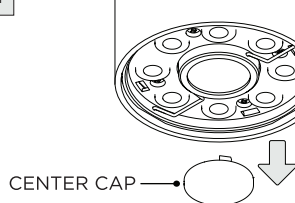

UNCLIP CENTER CAP FROM LED ASSEMBLY

3

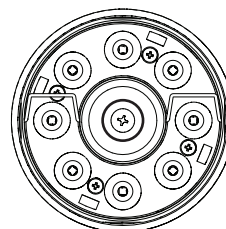

LOCATE CENTER SCREW

4

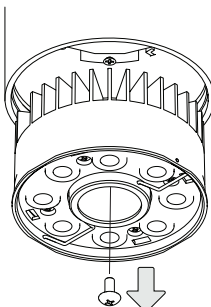

UNSCREW CENTER SCREW TO REMOVE LED ASSEMBLY

5

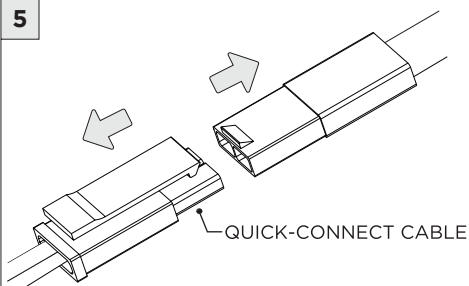

DISCONNECT QUICK-CONNECT CABLE FROM LED ASSEMBLY

6

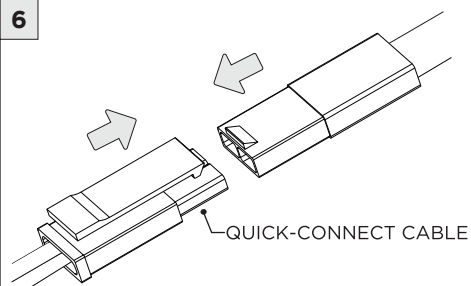

CONNECT QUICK-CONNECT CABLE TO NEW LED ASSEMBLY

7

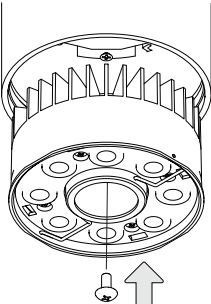

SCREW NEW LED ASSEMBLY INTO CYLINDER

8

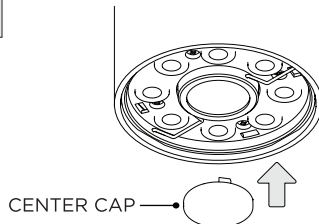

CENTER CAP

9

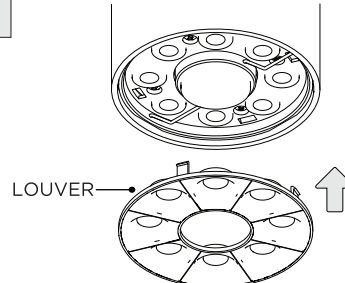

LOUVER

DRIVER SERVICING

1

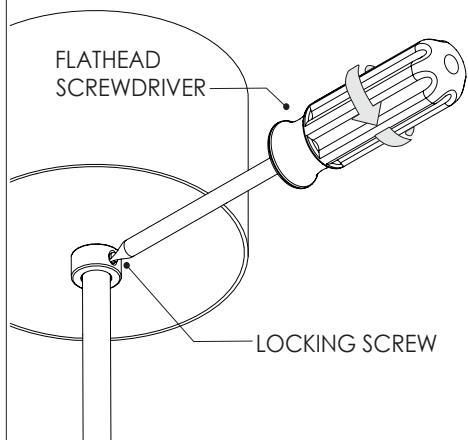

2

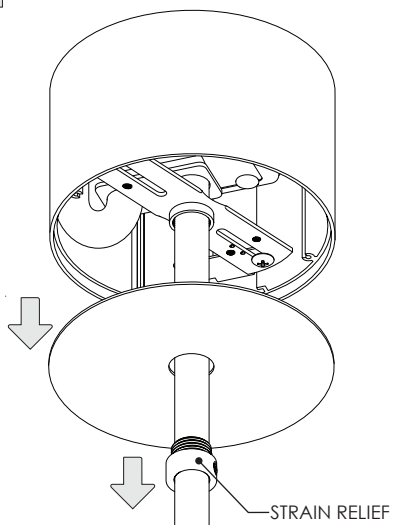

3

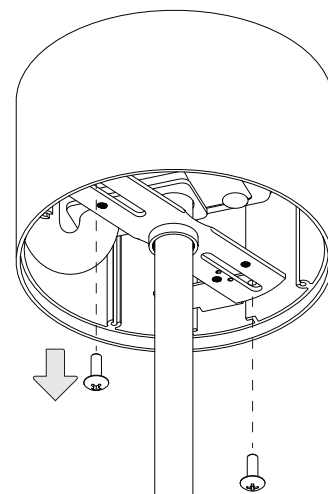

4

