

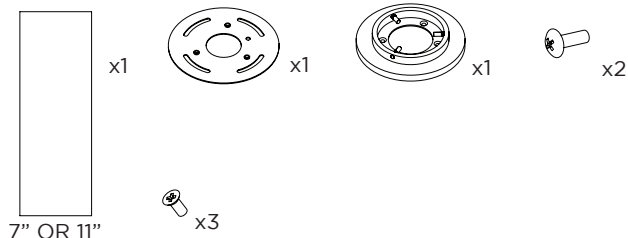

THE IMAGES SHOWN ARE FOR ILLUSTRATION ONLY AND MAY NOT BE AN EXACT REPRESENTATION OF THE PRODUCT

#### COMPONENTS

##### STANDARD CANOPY



##### CONDUIT FEED CANOPY

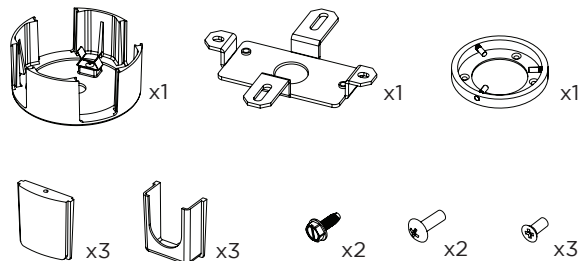

##### SEAMLESS CANOPY (FOR NEW CONSTRUCTION ONLY)

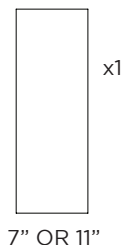
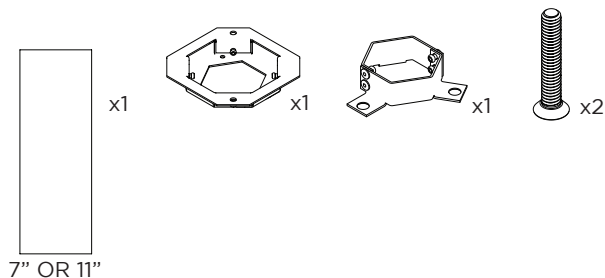

#### 4" OCTAGONAL J-BOX REQUIRED FOR INSTALLATION

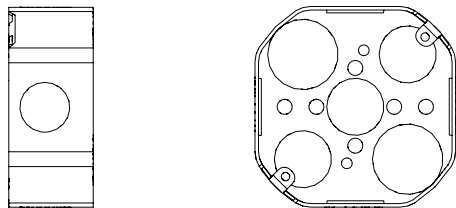

JUNCTION BOX (BY OTHERS)

INSTRUCTION KEY	INFORMATION
⚠ ADDITIONAL	INSTALLATION SHOULD ONLY BE PERFORMED BY A CERTIFIED ELECTRICIAN
ⓘ ATTENTION	REFER TO LOCAL/NATIONAL CODES FOR PROPER INSTALLATION
⚡ POWER ON	FAILURE TO FOLLOW INSTALLATION INSTRUCTION MAY VOID THE WARRANTY
⚡ POWER OFF	DO NOT TOUCH LEDS. LEDS MUST BE PROTECTED FROM MECHANICAL STRESS OR DEBRIS
	TURN OFF POWER DURING INSTALLATION OR SERVICING

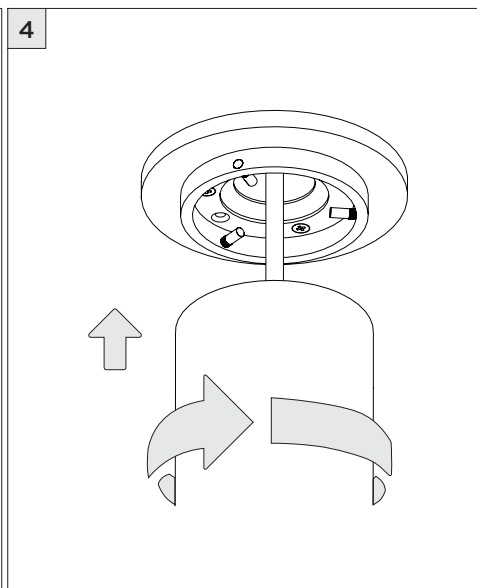
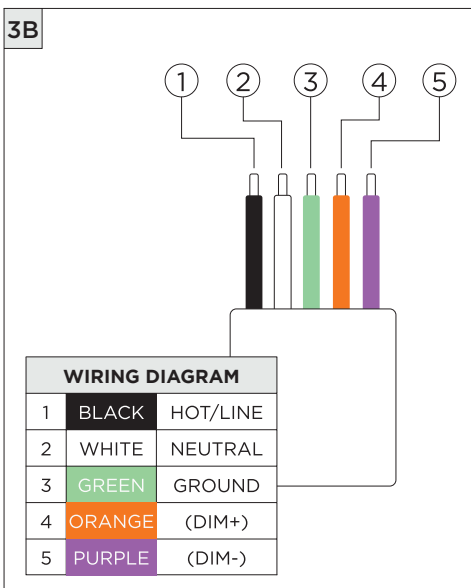
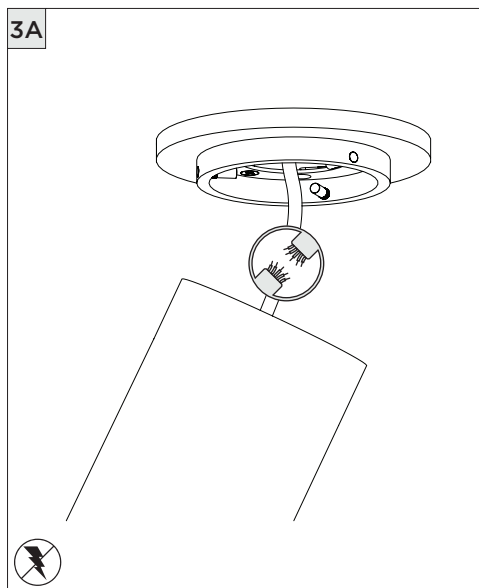
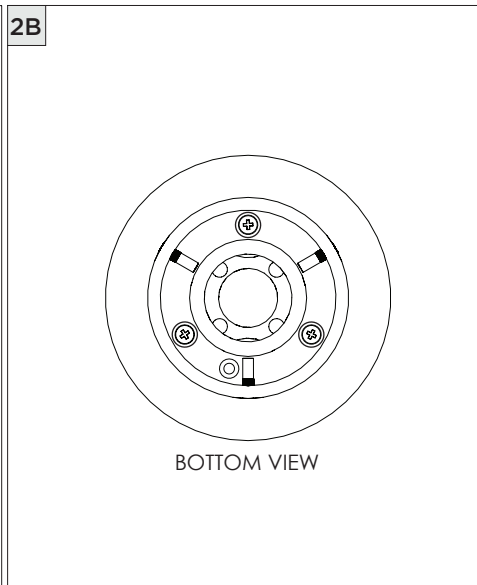
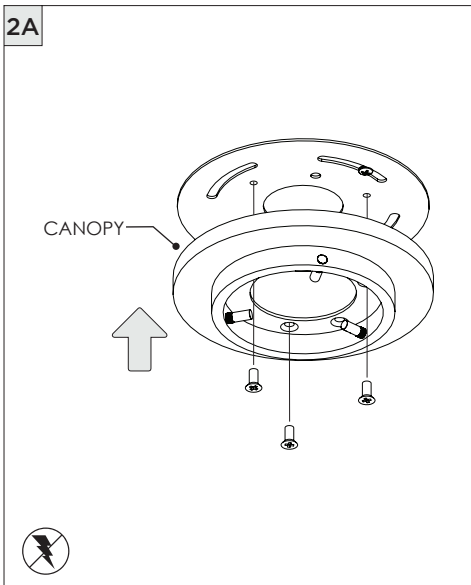
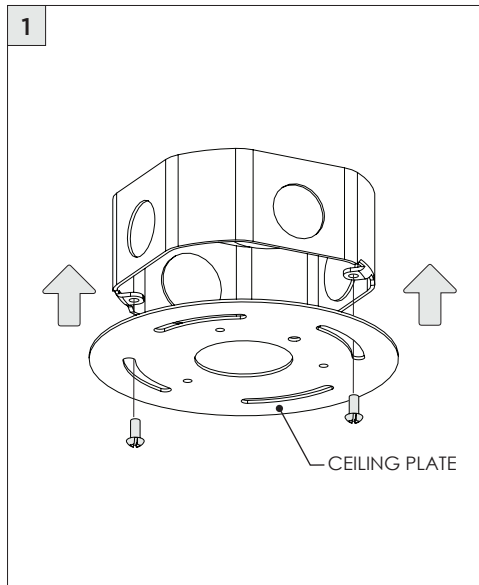

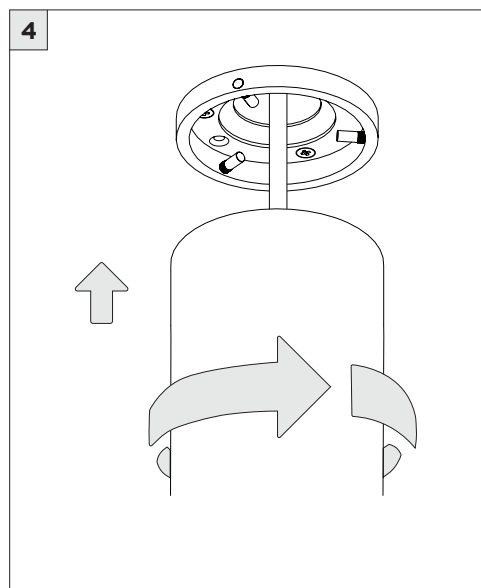
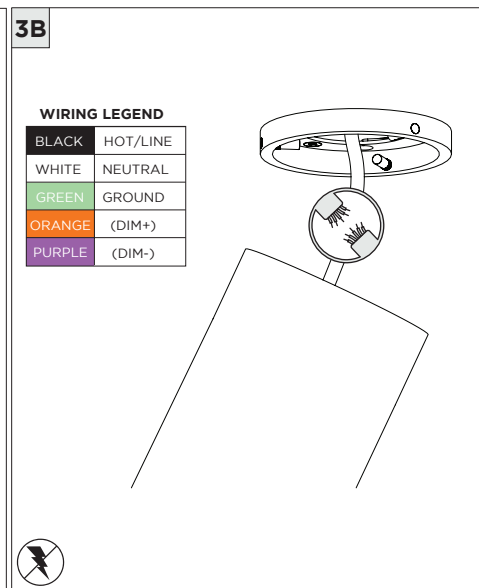
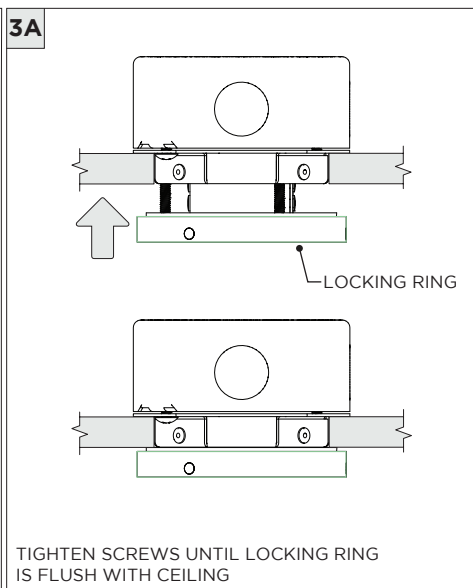
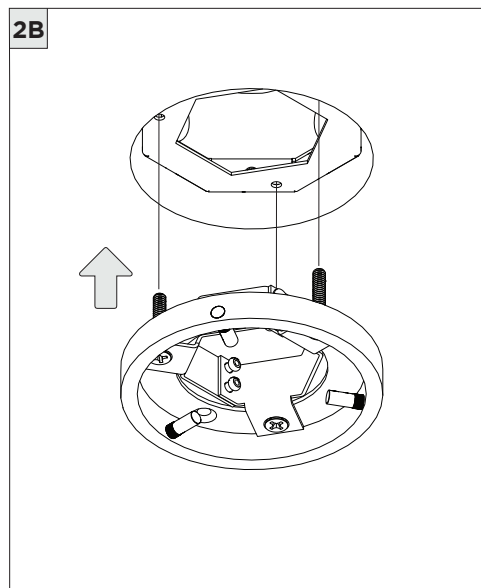
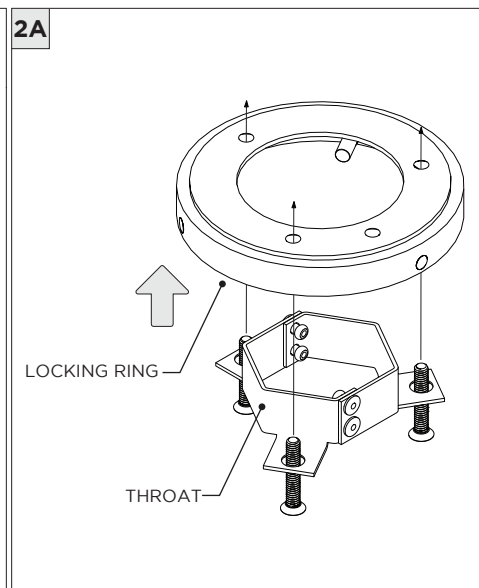
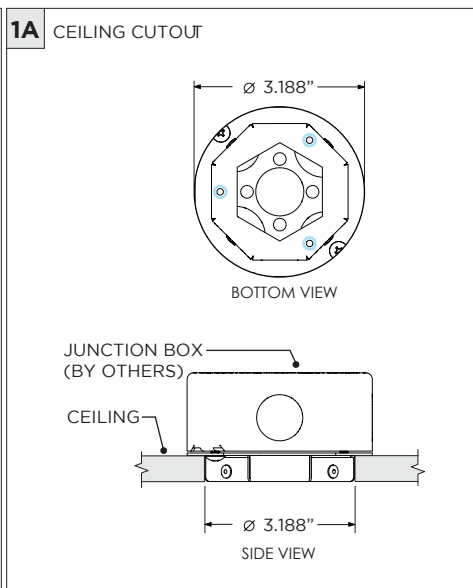
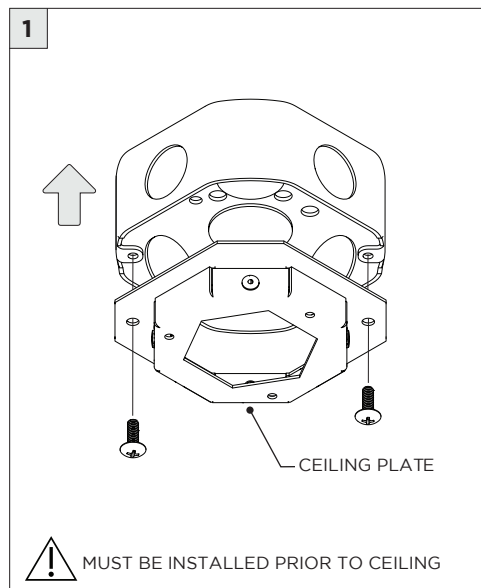

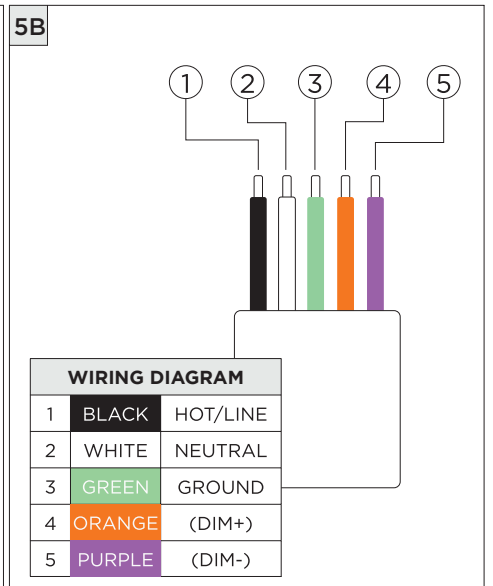
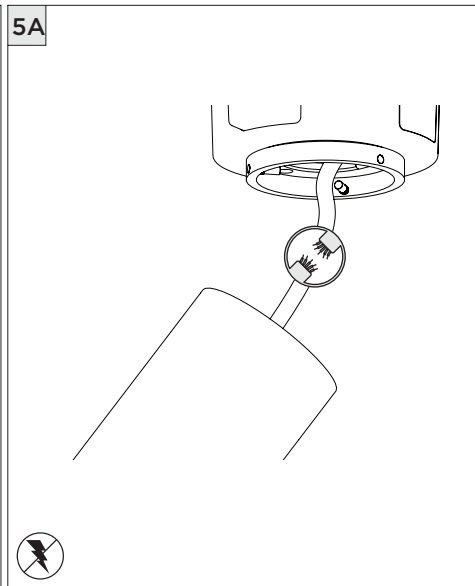
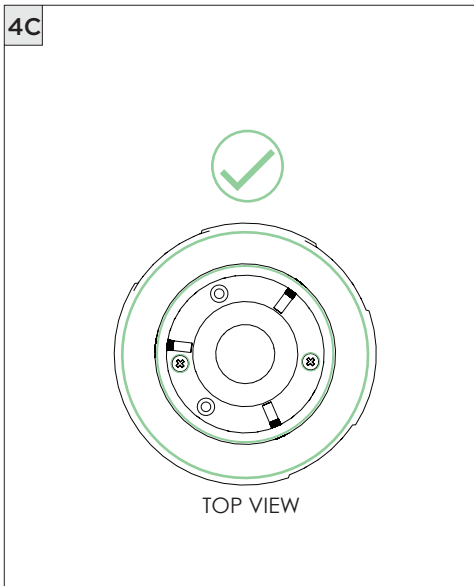
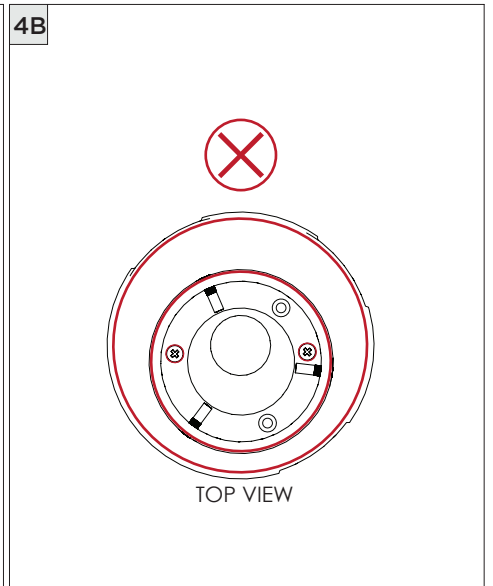
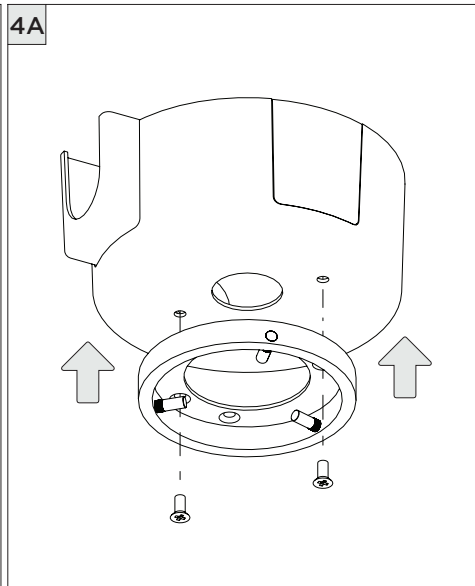
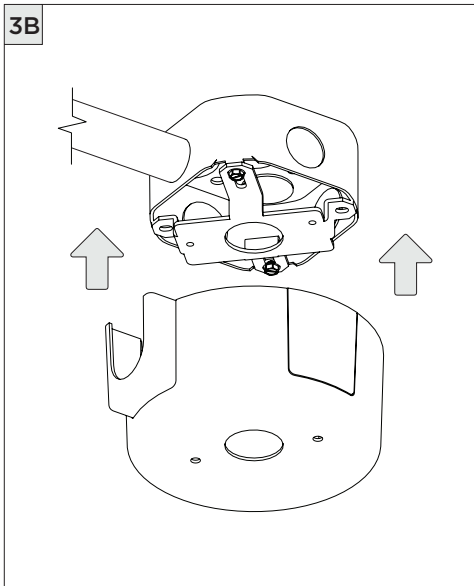
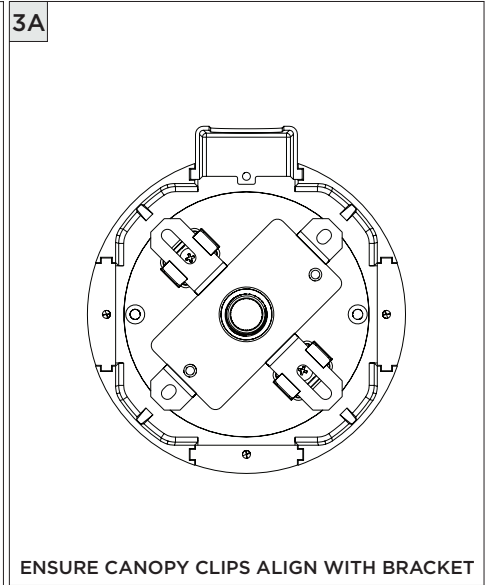
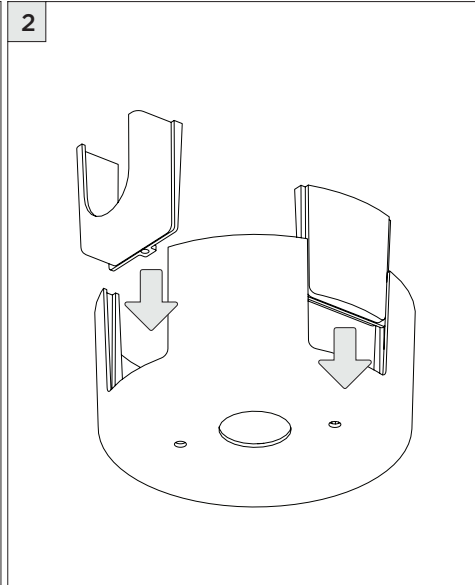
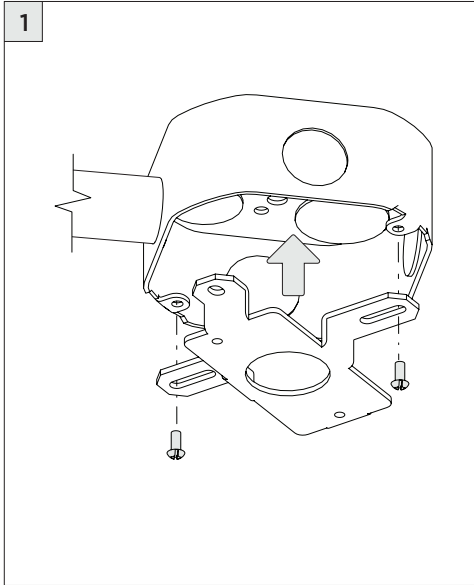

6

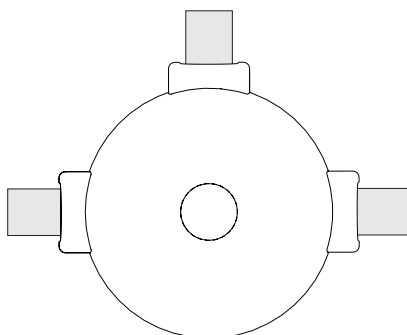
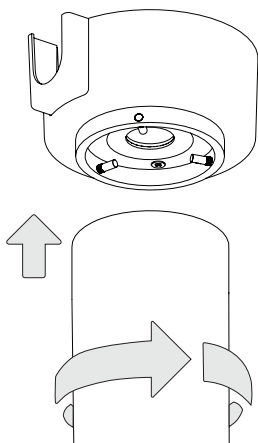

CANOPY IS SUITABLE FOR  
MAXIMUM 3 CONDUIT FEEDS

## DRIVER SERVICING

1

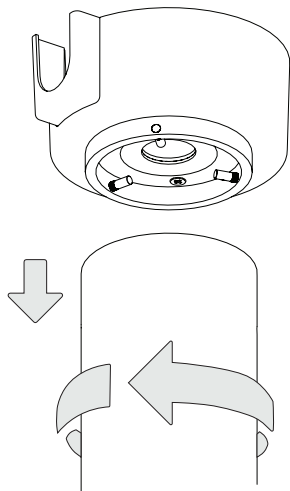

2

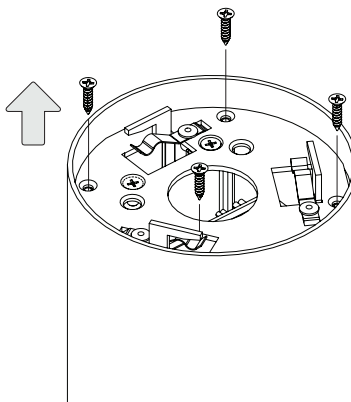

3

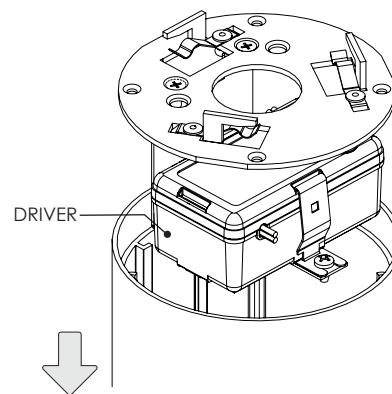

## LED SERVICING

1

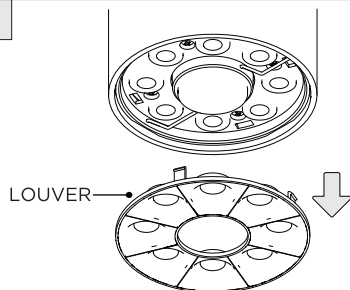

UNCLIP LOUVER FROM LED ASSEMBLY

2

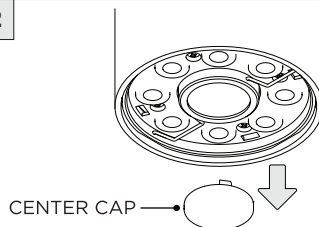

UNCLIP CENTER CAP FROM LED ASSEMBLY

3

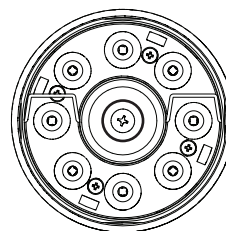

LOCATE CENTER SCREW

4

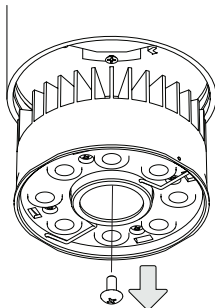

UNSCREW CENTER SCREW TO REMOVE LED ASSEMBLY

5

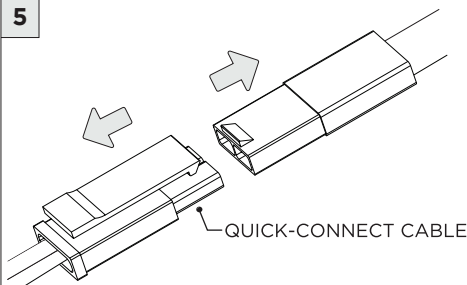

DISCONNECT QUICK-CONNECT CABLE FROM LED ASSEMBLY

6

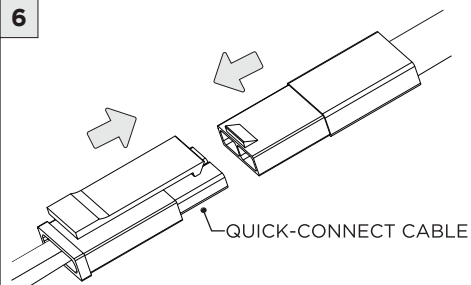

CONNECT QUICK-CONNECT CABLE TO NEW LED ASSEMBLY

7

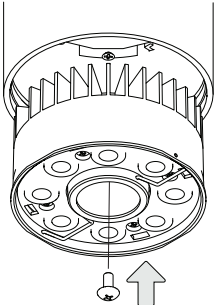

SCREW NEW LED ASSEMBLY INTO CYLINDER

8

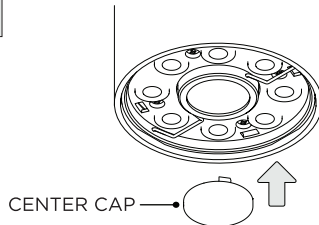

9

