

THE IMAGES SHOWN ARE FOR ILLUSTRATION ONLY AND MAY NOT BE AN EXACT REPRESENTATION OF THE PRODUCT

COMPONENTS	
<div>STANDARD CANOPY</div> <div> </div>	<div>CONDUIT FEED CANOPY</div> <div> </div>
4" OCTAGONAL J-BOX REQUIRED FOR INSTALLATION	
<div> </div> <div>JUNCTION BOX (BY OTHERS)</div>	

INSTRUCTION KEY	INFORMATION
<div> <div>⚠</div> <div>ADDITIONAL</div> </div> <div> <div>ⓘ</div> <div>ATTENTION</div> </div> <div> <div>⚡</div> <div>POWER ON</div> </div> <div> <div>⏻</div> <div>POWER OFF</div> </div>	<div>INSTALLATION SHOULD ONLY BE PERFORMED BY A CERTIFIED ELECTRICIAN</div> <div>REFER TO LOCAL/NATIONAL CODES FOR PROPER INSTALLATION</div> <div>FAILURE TO FOLLOW INSTALLATION INSTRUCTION MAY VOID THE WARRANTY</div> <div>DO NOT TOUCH LEDS. LEDS MUST BE PROTECTED FROM MECHANICAL STRESS OR DEBRIS</div> <div>TURN OFF POWER DURING INSTALLATION OR SERVICING</div>

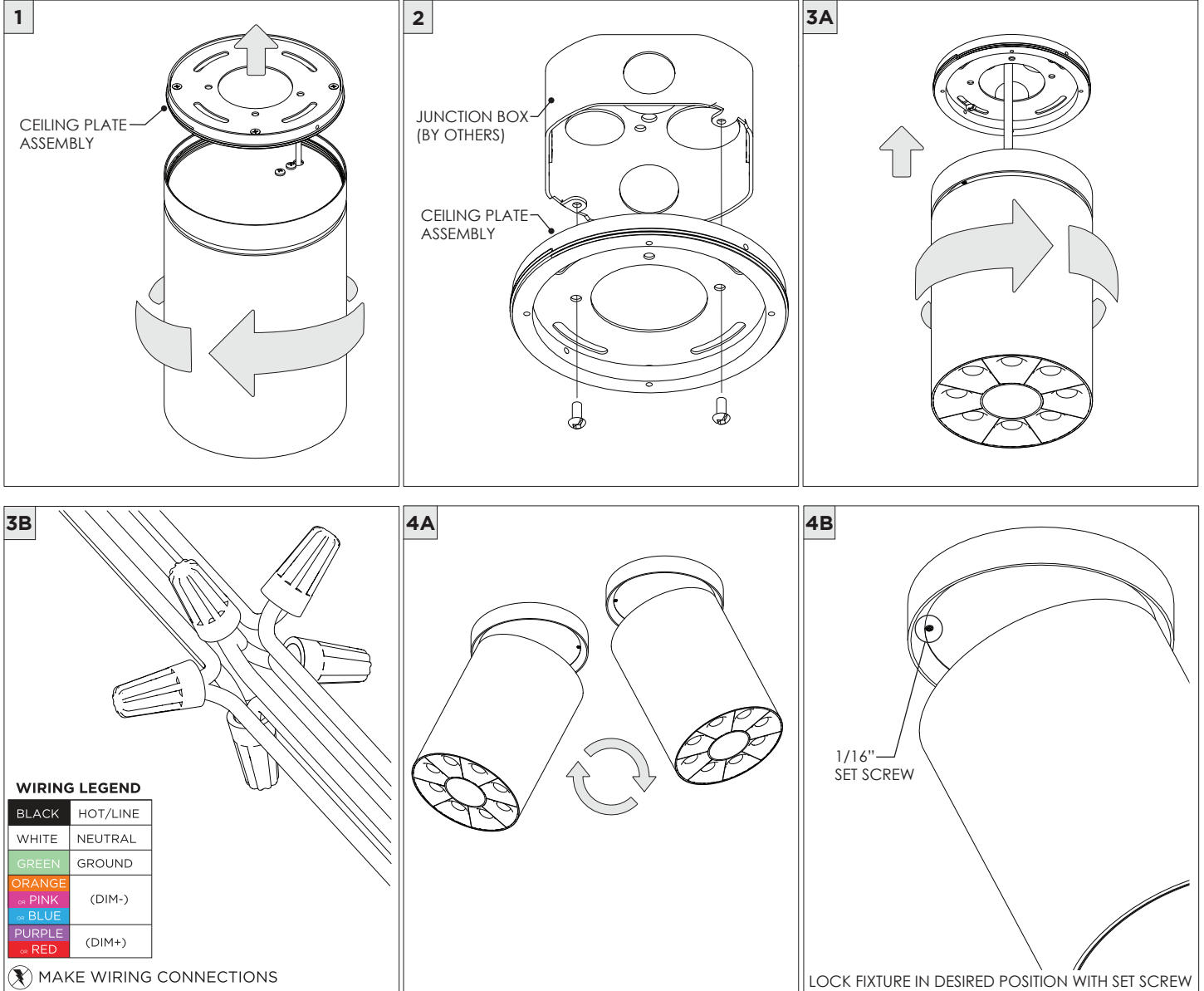

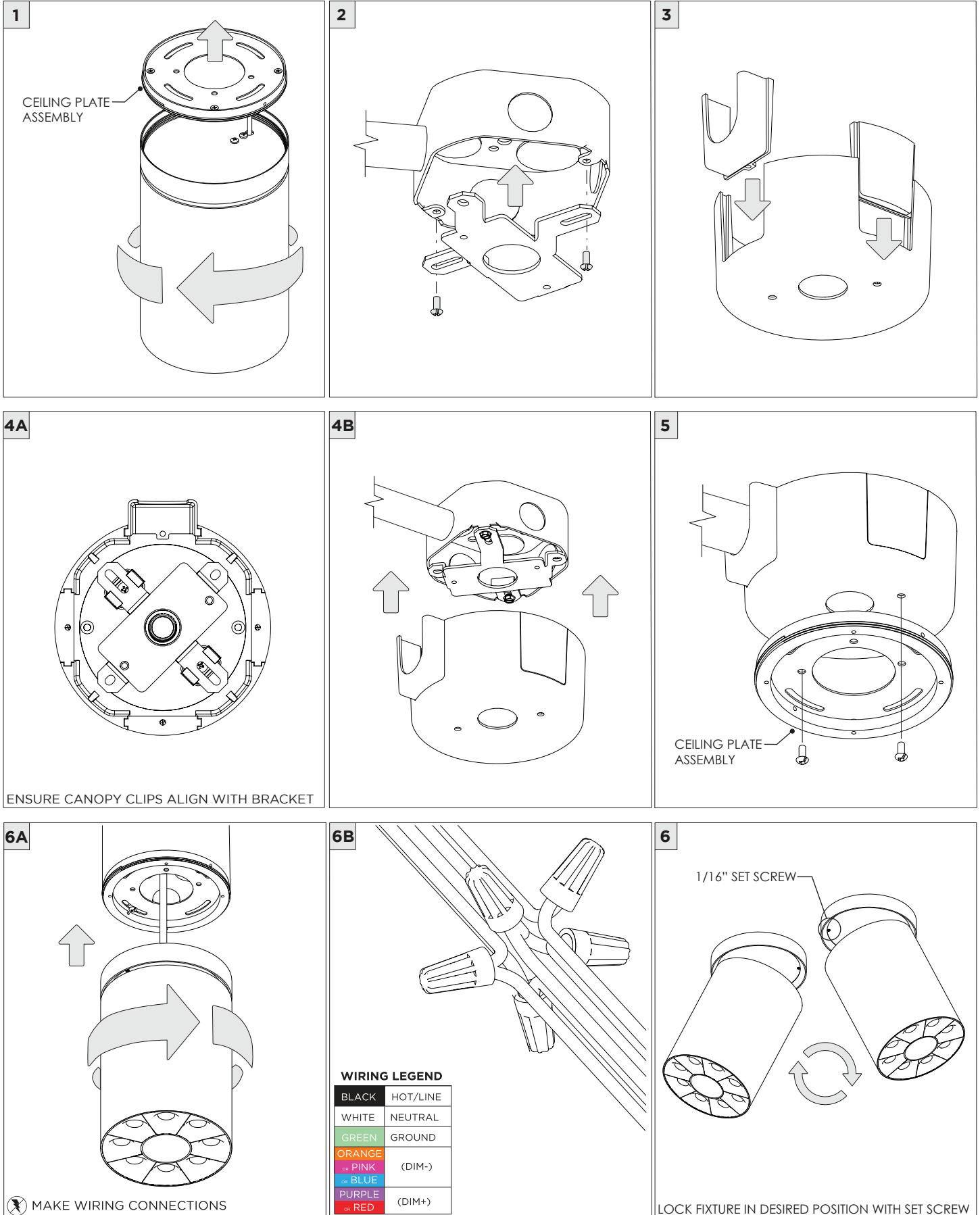

**DRIVER SERVICING**

1

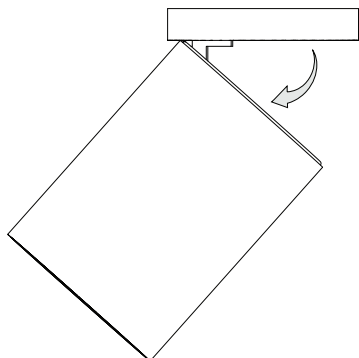

2

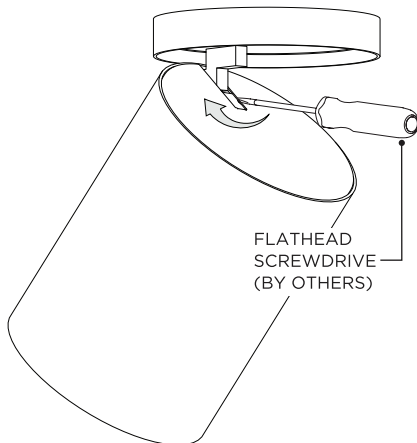

REMOVE MAGNETIC PLATE

3

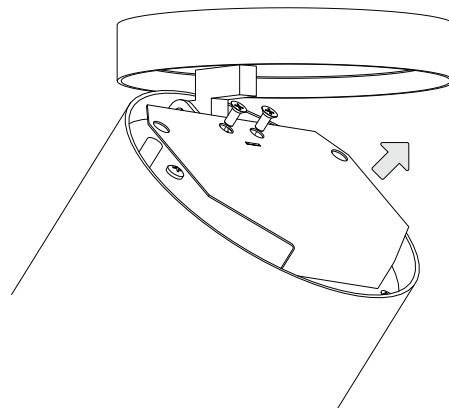

4

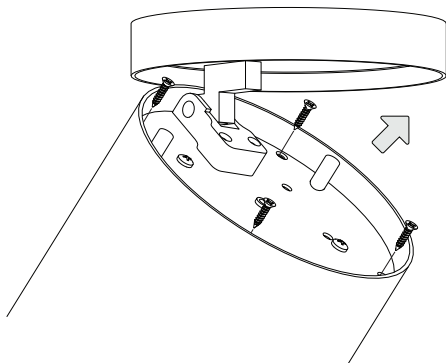

5

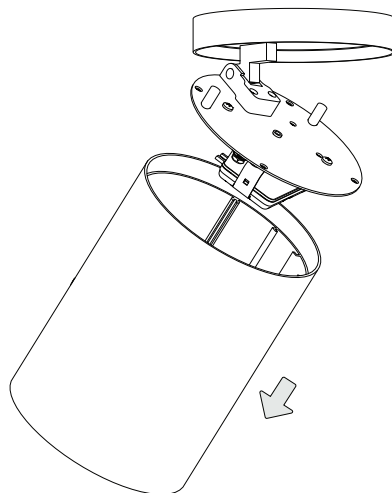

6

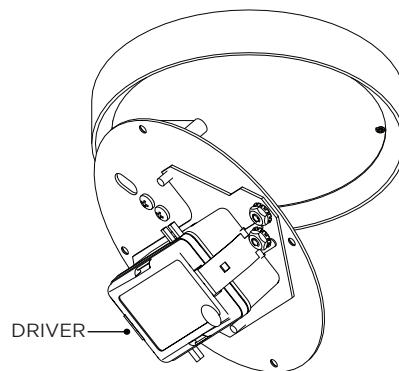

**LED SERVICING**

**1**

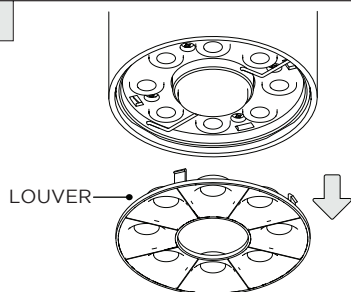

UNCLIP LOUVER FROM LED ASSEMBLY

**2**

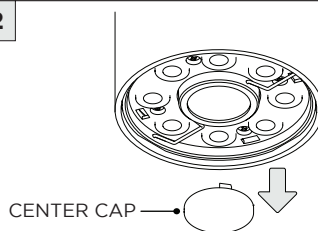

UNCLIP CENTER CAP FROM LED ASSEMBLY

**3**

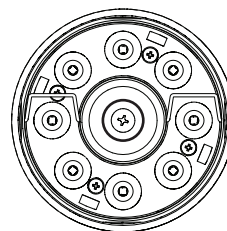

LOCATE CENTER SCREW

**4**

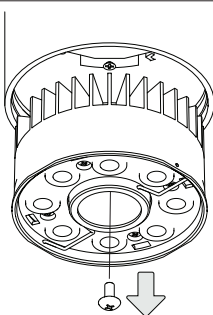

UNSCREW CENTER SCREW TO REMOVE LED ASSEMBLY

**5**

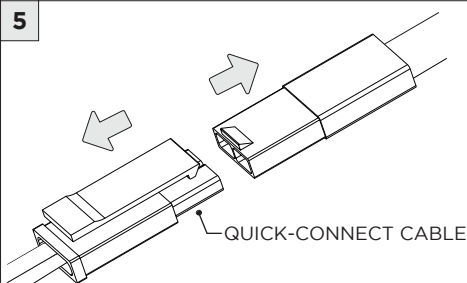

DISCONNECT QUICK-CONNECT CABLE FROM LED ASSEMBLY

**6**

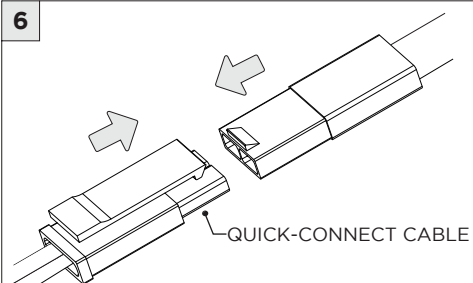

CONNECT QUICK-CONNECT CABLE TO NEW LED ASSEMBLY

**7**

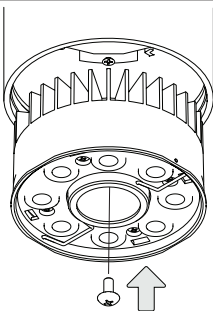

SCREW NEW LED ASSEMBLY INTO CYLINDER

**8**

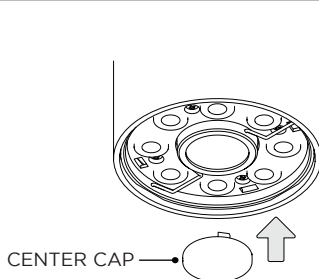

**9**

