

3G LIGHTING

3G-2RPE

2" RECESSED PERIMETER

Extruded aluminum housing with narrow 2" aperture
Designed for continuous runs in various configurations
12" fully illuminated end filler option is field cuttable for odd lengths
Standard 80+ CRI and 90+ CRI LED system
Delivered lumen range up to 1000lm/FT with performance up to 133 LPW
Lens position available in flush, 1", 2", and 3" regressed options
High performance asymmetric optic provides room side distribution

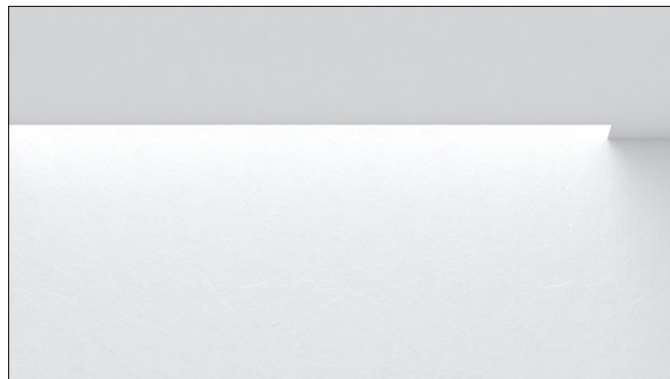

WT - TRIM

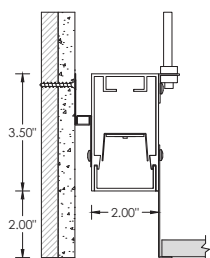

XTR - TRIMLESS

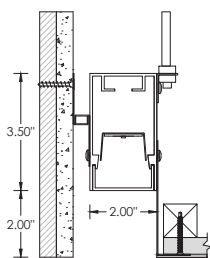

FX - FLANGELESS

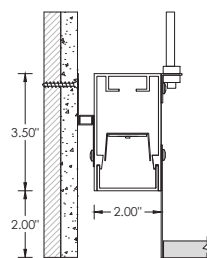

GCX - GRID CEILING

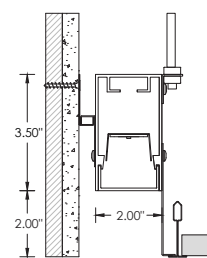

OPTICS

FLUSH

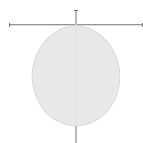

1" REGRESSED

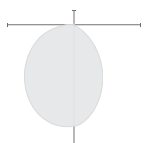

2" REGRESSED

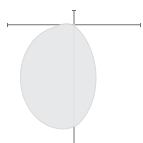

3" REGRESSED

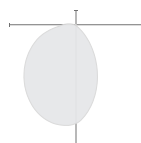

**FLUSH
ASYMMETRIC**

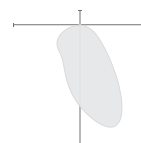

**1" REGRESSED
ASYMMETRIC**

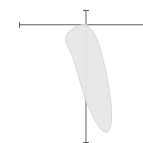

PATTERNS

Specify pattern shape and overall dimensions as shown below. Patterns are connected with fully illuminated 12"x12" L and U-shaped sections
Please consult factory for custom patterns and shapes not shown below.

L-SHAPE	U-SHAPE
<p>Provide dimensions of AxB Example: L - 6'x8'</p>	<p>Provide dimensions of AxBxC Example: U - 8'x10'x6"</p>

PROJECT:		TYPE:	
CATALOG#:		DATE:	QTY:

CAT. NO	LUMEN OUTPUT	CRI	COLOR TEMP
3G-2RPE	D250 - 250 LM/FT ¹ D500 - 500 LM/FT D750 - 750 LM/FT D1000 - 1000 LM/FT DC___ - CUSTOM OUTPUT (SPECIFY LM/FT) * <small>*Specify custom lumen outputs in 50lm increments (ie: DC600, DC650, DC700) Custom output cannot exceed D1000 DLC minimum lumen output is 500lm/ft</small>	S80 - 80+ CRI H90 - 90+ CRI <small>*DLC listing available with 80CRI</small>	27K - 2700K 30K - 3000K 35K - 3500K 40K - 4000K <small>*DLC listing available with 35K</small>

VOLTAGE	DRIVER	FLANGE TYPE	LENS OPTION
UNV - 120/277V 347 - 347V ²	DIM - 0-10V (100-1%) D01 - 0-10V (100-0.1%) DALI - DALI (100-1%) ³ DHL2 - LUTRON HI-LUME (1% ECOSYSTEM) DMX - DMX (100-0%)	GCX - GRID CEILING * (UNIVERSAL MOUNT) WT - WHITE TRIM FLANGE XTR - TRIMLESS (MUD-IN DRYWALL) FX - FLANGELESS <small>*Universal mounting brackets used for all grid ceiling types only. See mounting section for details</small>	FL - FLUSH RG1 - 1" REGRESSED RG2 - 2" REGRESSED RG3 - 3" REGRESSED

OPTIONS	RUN TYPE
CP - CHICAGO PLENUM DASY - ASYMMETRIC LENS ⁴ (ROOM SIDE DISTRIBUTION) EF - 12" END FILLER (FOR ODD LENGTHS) EMB - EMERGENCY BATTERY * (INTEGRAL) EMC - EMERGENCY CIRCUIT <small>*Minimum 4' and maximum 6' section</small>	S - ___' (STRAIGHT) * L - ___'X ___' (L-SHAPE) U - ___'X ___'X ___' (U-SHAPE) <small>*Individual units available from 2' to 8' Use "EF" (End Filler) options for continuous runs with odd lengths Example: 12'4" long fixture run specified as EF-S-12'</small>



DLC listing starting at 500 lumens per foot (D500)
Available with 80CRI and 3500K

- ¹ D250 (250LM/FT) not available in 2' and 3' lengths (Specify minimum DC400 when outputs lower than 500LM/FT are required)
² 347 available in "DIM" 0-10V only (100-1%)
³ DALI-2 (Type 6) provided as standard. Please consult factory for DALI (Type 8) options
⁴ Asymmetric lens option only available with Flush and 1" Regressed lens position

ILLUMINATED END FILLERS AND CORNERS

Optional, 12" fully illuminated, telescoping end filler is designed to be easily cut in field. Suitable for straight, L-shape, and U-shape run lengths
Rectangular runs lengths are provided with "joiner" section fillers (x4)

PERFORMANCE

	FLUSH		1" REGRESSED		2" REGRESSED		3" REGRESSED		FLUSH ASYMMETRIC		1" REGRESSED ASYMMETRIC	
DELIVERED LUMENS	SYSTEM WATTS	EFFICACY (LPW)	SYSTEM WATTS	EFFICACY (LPW)	SYSTEM WATTS	EFFICACY (LPW)	SYSTEM WATTS	EFFICACY (LPW)	SYSTEM WATTS	EFFICACY (LPW)	SYSTEM WATTS	EFFICACY (LPW)
250	2.0	125	2.0	123	2.0	120	2.1	118	1.9	133	2.2	131
500	4.0	125	4.1	123	4.1	120	4.3	118	3.8	133	4.4	131
750	6.6	114	6.3	119	6.5	117	6.6	115	5.7	132	5.9	128
1000	8.7	114	8.8	115	8.8	114	9.1	111	7.8	128	8.0	125

DELIVERED LUMENS PER FOOT BASED ON 80+ CRI, 3500K
Lumen output and actual wattage may vary +/- 5%

LUMEN OUTPUT MULTIPLIERS

80+ CRI COLOR TEMP		90+ CRI COLOR TEMP	
2700K	N/A	2700K	0.78
3000K	0.97	3000K	0.83
3500K	1.00	3500K	1.00
4000K	1.02	4000K	1.02

HOUSING

Extruded aluminum housing with narrow 2" aperture
Designed for continuous runs in various configurations
12" fully illuminated end filler option is field cuttable for odd lengths
Trim flange with power coated finish and 0.400" overlap
Trimless model features a perforated galvanized mudding flange
24-gauge LED reflector with high reflectance white finish
Standard polyester powder coated matte white finish

OPTICS

Extruded, acrylic lens provides optimal performance and glare control
High performance asymmetric lens provides room side distribution
Lens option available in flush, 1", 2", and 3" regressed options

LED SYSTEM

Standard 80+ CRI. Optional 90+ CRI
Color consistency <3 SDCM
Available in 27K, 30K, 35K, and 40K
R9 value of 56 for 90+CRI
L90 > 60,000 hours

LISTING

ETL listed and conforms to UL1598 standard
Certified to CSA22.2 No.250.0.
Rated for dry or damp locations
DLC certified. Consult factory for details

WARRANTY

5 Year Warranty on LED and drivers
LED system rated for operation in ambient environments up to 25°C

ELECTRICAL

Standard 0-10V, constant current drivers with 100-1% dimming range and >0.9 power factor
Standard 120/277V universal voltage with several driver options
Luminaires are pre-wired with factory installed quick connects and branch circuit wiring
All drivers are integral and easily accessible through luminaire aperture

EMERGENCY

Integral batteries operate minimum 4' and maximum 6' sections.
15W output (1875lm) for 90 minutes. Title 24 Certified
4' section (+/- 465lm per foot at 80+ CRI)
5' section (+/- 375lm per foot at 80+ CRI)
6' section (+/- 310lm per foot at 80+ CRI)

MOUNTING

New construction housing suspended via 1/4" threaded rod or suspension cables (by others)
Trim fixture designed for use in drywall, wood, and other architectural ceiling materials
Trimless fixture designed for use in drywall, mud-in ceiling applications
Flangeless fixture designed for use in wood ceilings
Suitable for various grid ceiling applications (see mounting details)
Standard mounting available in flush and regressed options up to 3"
Fixture weight: +/- 4 lbs/ft. Consult 3G for modifications

HARD CEILING (SHOWN WITH 2" REGRESSED LENS OPTION)

WT - TRIM

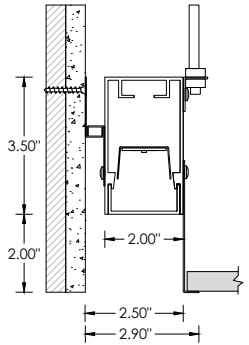

RECOMMENDED CEILING
OPENING 2.60"

XTR - TRIMLESS

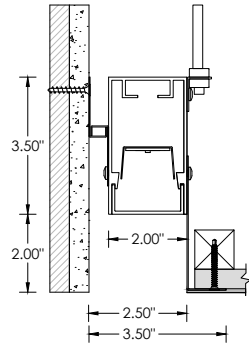

RECOMMENDED CEILING
OPENING 2.75"

FX - FLANGELESS

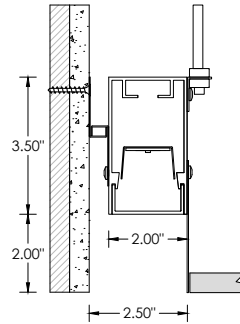

RECOMMENDED CEILING
OPENING 2.57"

GRID CEILING (SHOWN WITH 2" REGRESSED LENS OPTION)

9L - 9/16" LAYIN

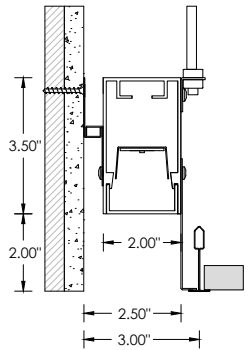

9TG - 9/16" TEGULAR

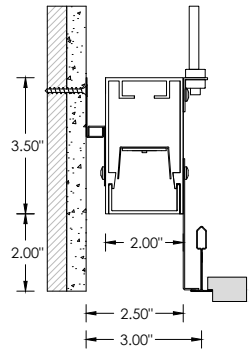

**9ST - 9/16" SLOT TEE
TEGULAR**

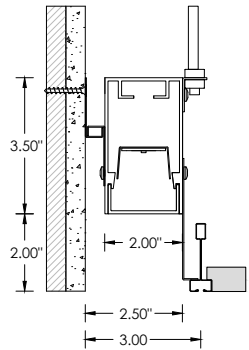

15L - 15/16" LAYIN

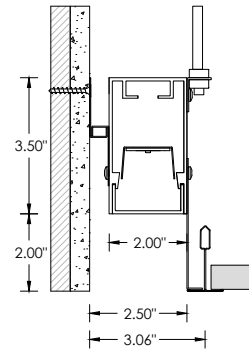

15TG - 15/16" TEGULAR

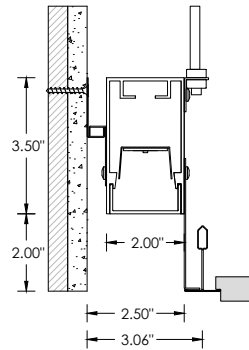

LENS OPTION

FL - FLUSH

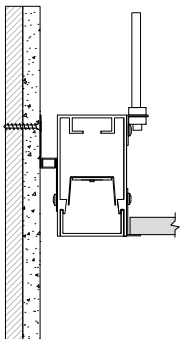

RG1 - 1" REGRESSED

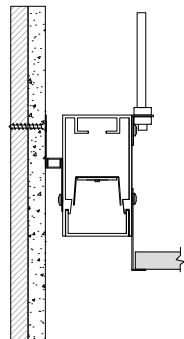

RG2 - 2" REGRESSED

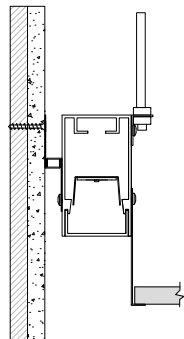

RG3 - 3" REGRESSED

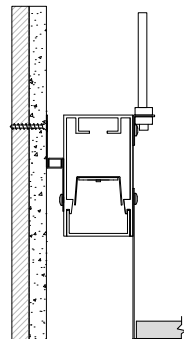

**FL - FLUSH
ASYMMETRIC OPTIC
ROOM SIDE**

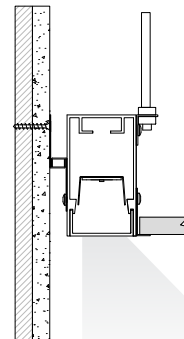

**RG1 - 1" REGRESSED
ASYMMETRIC OPTIC
ROOM SIDE**

