

4.5" WALLWASH CYLINDER

SURFACE MOUNT



COMPONENTS

STANDARD CANOPY

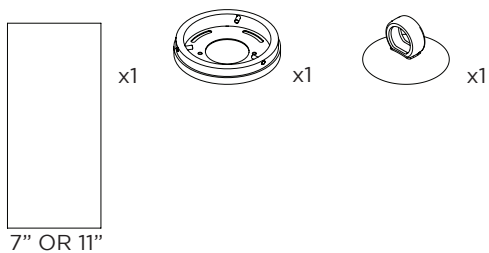

CONDUIT FEED CANOPY

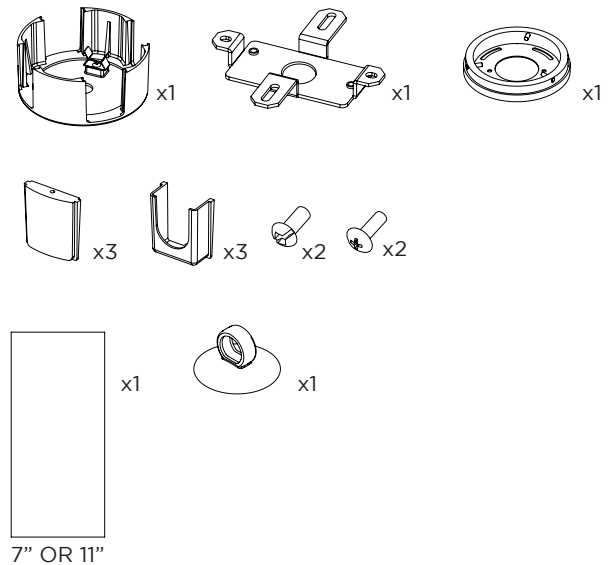

4" OCTAGONAL J-BOX REQUIRED FOR INSTALLATION

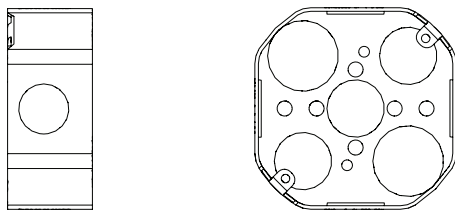

JUNCTION BOX (BY OTHERS)

INSTRUCTION KEY	INFORMATION
⚠ ADDITIONAL	INSTALLATION SHOULD ONLY BE PERFORMED BY A CERTIFIED ELECTRICIAN
ⓘ ATTENTION	REFER TO LOCAL/NATIONAL CODES FOR PROPER INSTALLATION
⚡ POWER ON	FAILURE TO FOLLOW INSTALLATION INSTRUCTION MAY VOID THE WARRANTY
⏻ POWER OFF	DO NOT TOUCH LEDS. LEDS MUST BE PROTECTED FROM MECHANICAL STRESS OR DEBRIS
	TURN OFF POWER DURING INSTALLATION OR SERVICING

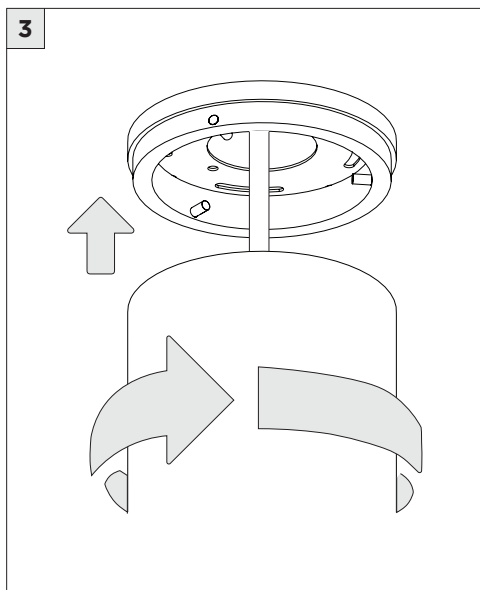
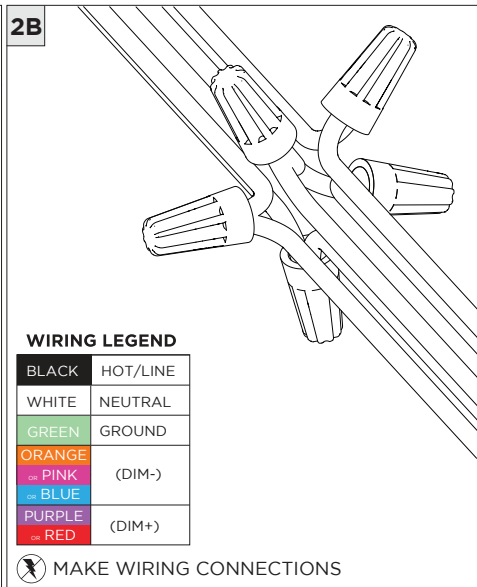
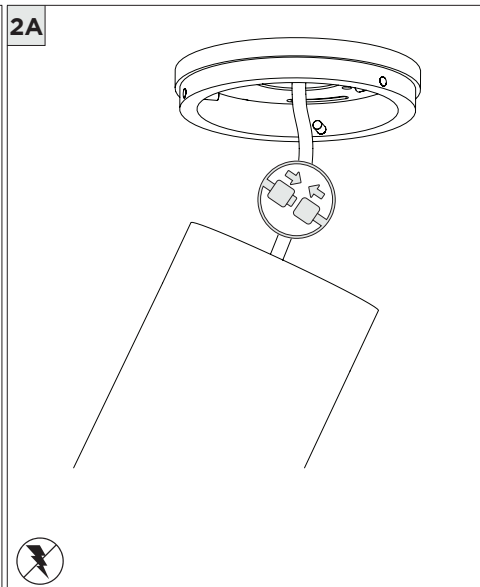
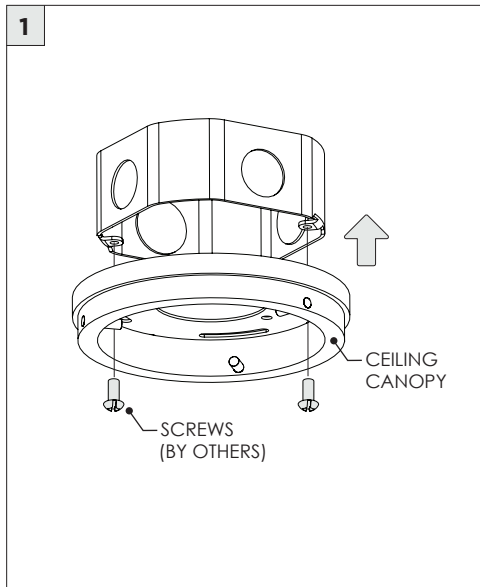

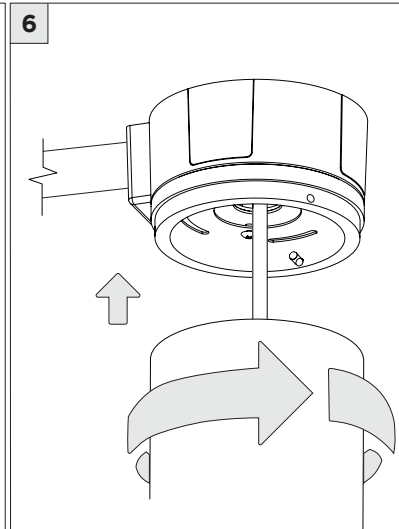
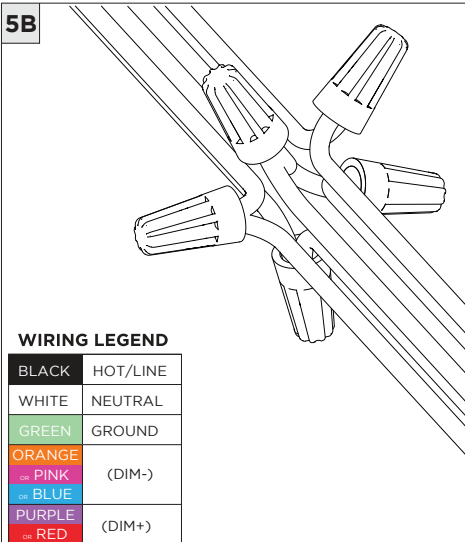
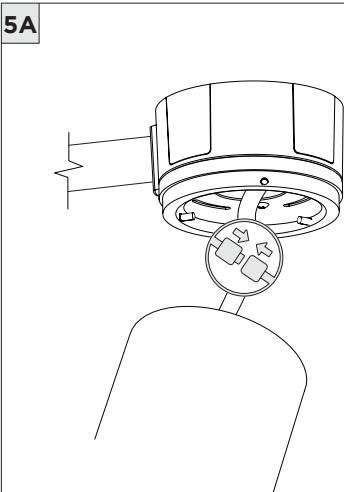
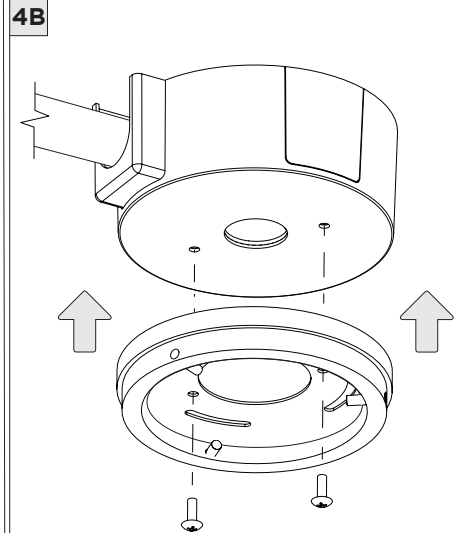
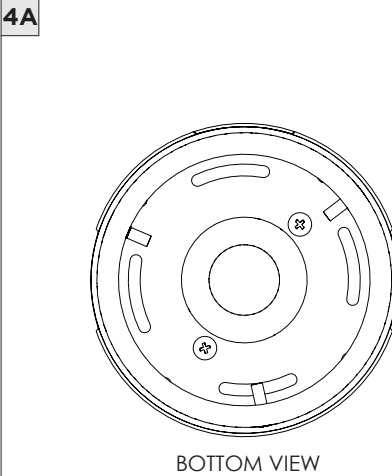
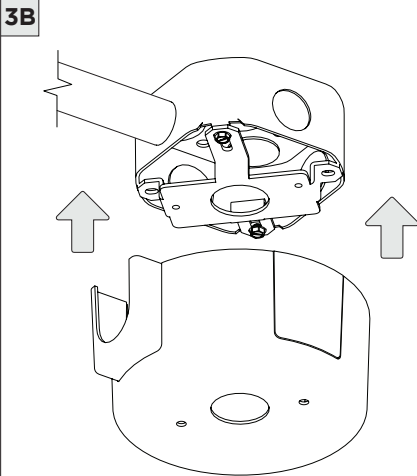
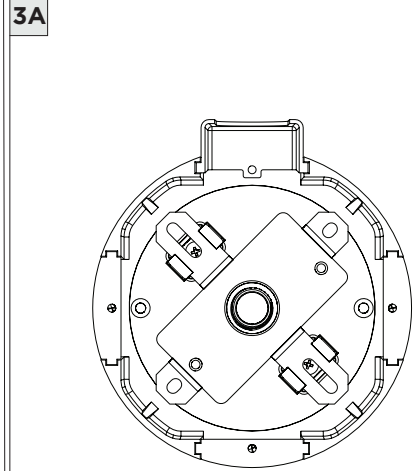
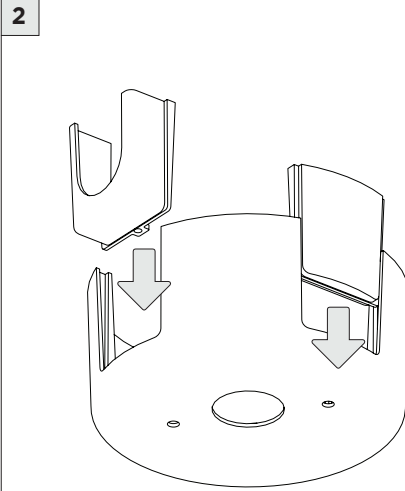
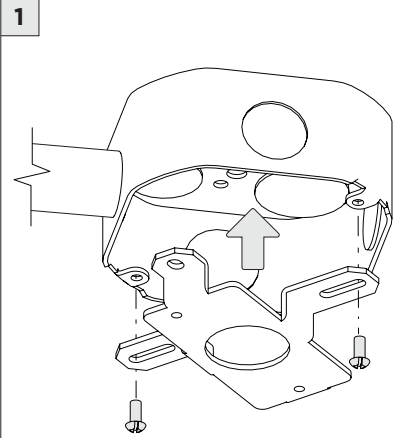

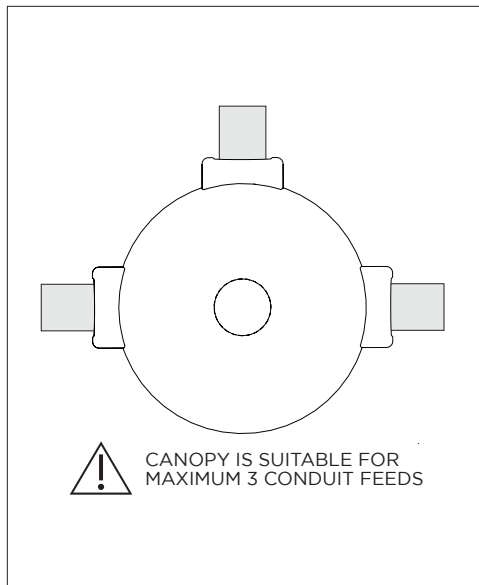

DRIVER SERVICING

1

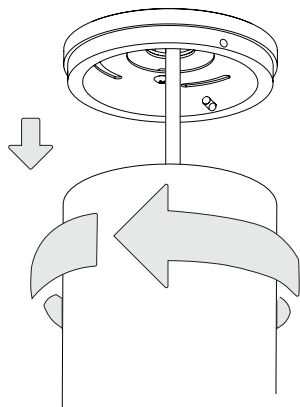

2

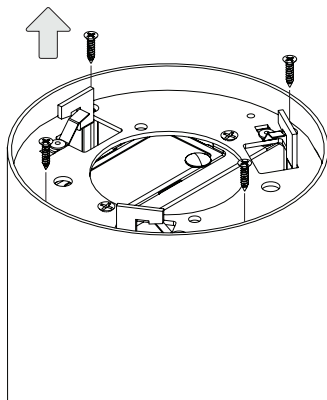

2

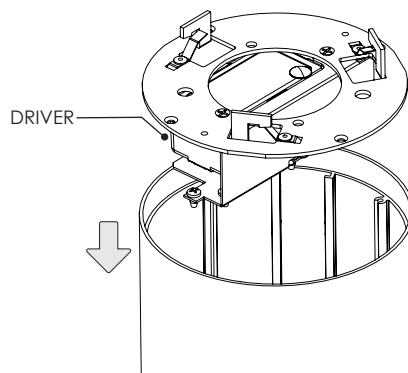

DRIVER SERVICING

1

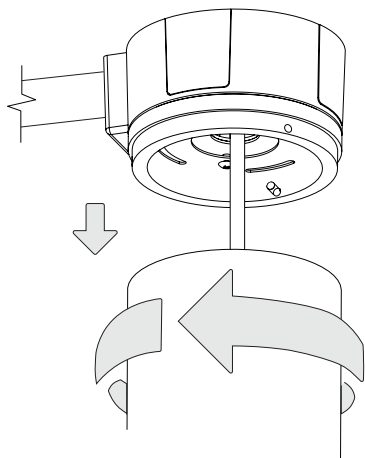

2

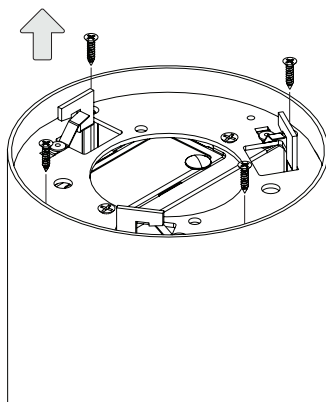

2

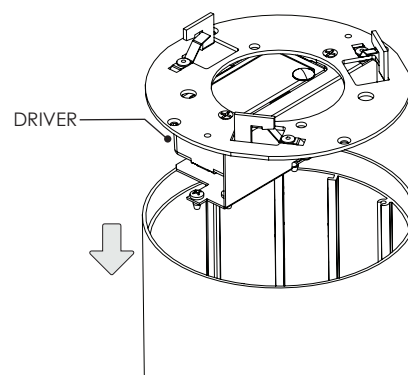

LED SERVICING

1

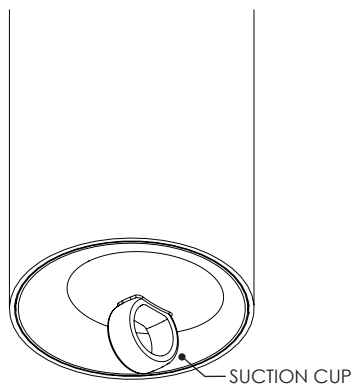

SUCTION CUP

2

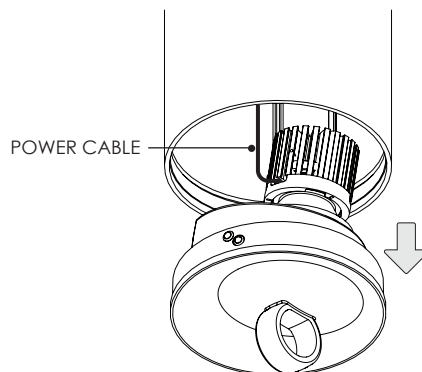

POWER CABLE

ENSURE TO DISCONNECT POWER CABLE

3

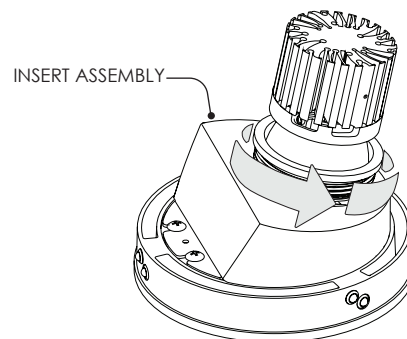

INSERT ASSEMBLY

4

REPLACE LED ASSEMBLY

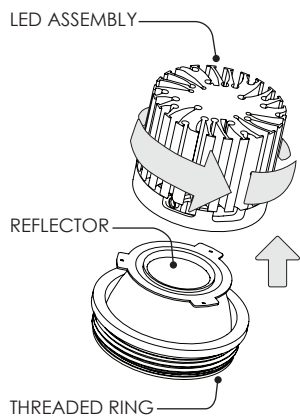

LED ASSEMBLY

REFLECTOR

THREADED RING

5

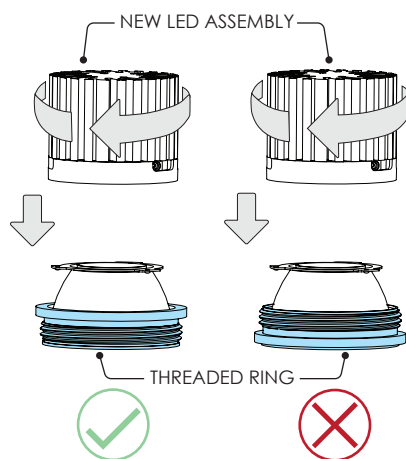

NEW LED ASSEMBLY

THREADED RING

6

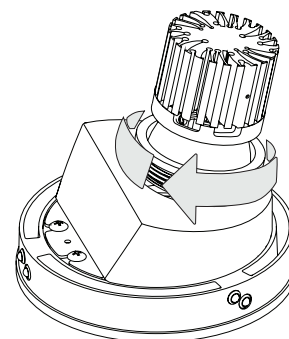

ENSURE THE HEAT SINK IS ALIGNED WITH INSERT ASSEMBLY AND FULLY TIGHTEN THE THREADED RING

7

2200 LUMEN
LED ASSEMBLY

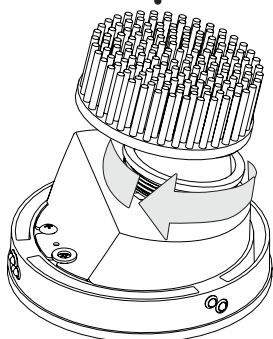

FOR 2200 LUMEN FIXTURES

7A

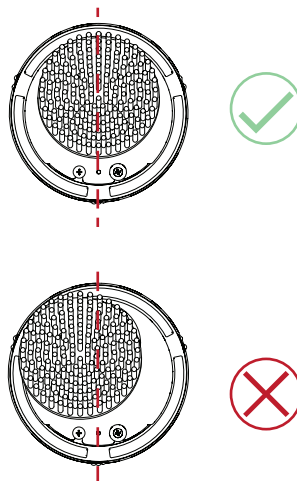

8

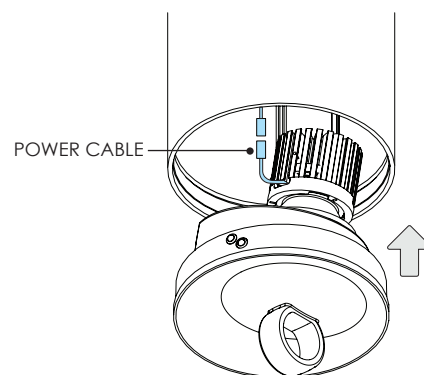

POWER CABLE

EXACT LED MODEL MAY VARY