

3Gi-1PSL-D

1.5" INTEGRATED PENDANT SLOT
DIRECT

SPECIFY PRODUCT USING ONLINE CONFIGURATOR

1.5" aperture with one piece extruded aluminum housing
Individual or continuous runs available. See online configurator
Direct distribution with multiple source options and various lumen outputs
Integrated options include Linia, Zoie, Zoie Wall Wash and non-illuminated faceplates
Extruded acrylic lens with optimal performance and glare control
Asymmetric optics available
1% dimming standard with several driver options



INTEGRATED OPTIONS

1.5" LINIA DIRECT



NON ILLUMINATED FACEPLATE



LINEAR ZOIE



ZOIE WALL WASH



CONFIGURATION OPTIONS (SPECIFY PRODUCT USING ONLINE CONFIGURATOR)

SE - START- END

Integrated options located at start and end of run only. Available in 1' increments starting at 4'. See online configurator for length options

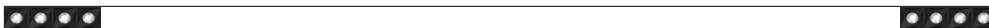

OC - ON CENTER SPACING

Integrated options with on center spacing starting at 4' (OC4) through 8' (OC8). See online configurator for run length options



1LI - 1.5" LINIA DIRECT



1N - NON ILLUMINATED

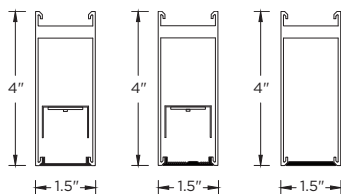

APERTURE SIZE: 1.5"
COLOR TEMP: 27K, 30K, 35K, 40K
CRI: 90+

DELIVERED LUMENS: 250-1000 LM/FT
EFFICACY: 91 - 100 LPW *
WATTAGE: 2.5 - 10.9 W/FT *

OPTICS: FLUSH, ASYMMETRIC

* Based on 90+ CRI and 3500K

Z4 - 4" ZOIE



Z8 - 8" ZOIE



Z12 - 12" ZOIE

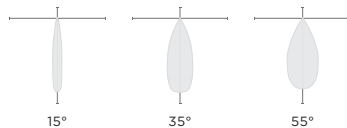
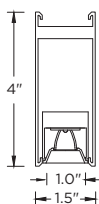

APERTURE SIZE: 1.0"
COLOR TEMP: 27K, 30K, 35K, 40K
CRI: 90+

DELIVERED LUMENS: 500 - 2500 LM
EFFICACY: 94 - 125 LPW *
WATTAGE: 5.6 - 24.7 W *

OPTICS: 15°, 35°, 55°

* Based on 90+ CRI, 35° and 3500K

Z4WW - 4" ZOIE WALL WASH



Z8WW - 8" ZOIE WALL WASH



Z12WW - 12" ZOIE WALL WASH

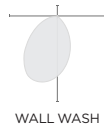
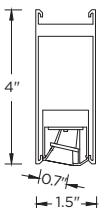

APERTURE SIZE: 0.7"
COLOR TEMP: 27K, 30K, 35K, 40K
CRI: 90+

DELIVERED LUMENS: 500 - 3000 LM
EFFICACY: 77 - 91 LPW *
WATTAGE: 6.2 - 35.0 W *

OPTICS: WALL WASH

* Based on 90+ CRI and 3500K

OPTICS

1.5" LINIA DIRECT

Extruded, satin acrylic lens designed for optimal performance and glare control
High performance asymmetric optics

LINEAR ZOIE

4", 8", and 12" high performance Zoie downlights
1" apertures with matte black or matte white multi-faceted louvers
Regressed LED source for enhanced glare control
Proprietary polycarbonate multi-faceted reflectors
Available in 15°, 35° and 55°
UGR <16

ZOIE WALL WASH

4", 8", and 12" high performance Zoie Wall Wash downlight
0.7" aperture with matte black or matte white louver finish
Regressed LED source for enhanced glare control
Proprietary high performance wall wash optic and lens
Smooth, direct and uniform illumination across the top and down the wall

HOUSING

Extruded aluminum housing with 1.5" aperture
Die cast aluminum endcaps add 1/4" to each end of luminaire
24-gauge LED reflector with high reflectance white powder coated finish
Standard polyester powder coated finishes include matte white, black, and silver
Non-illuminated option features an extruded aluminum faceplate with powder coated finish

MOUNTING

Toolless installation with 3G's proprietary mounting system
Internal, toolless joiner system (latch and hook) easily connects multiple sections together
LED reflectors remain in each section during installation with 3G's locking spring system
Adjustable aircraft cable suspension with locking fasteners (60" length standard)
Standard, 18-gauge, 5 conductor single circuit power feed (clear braided finish)
All mounting canopies provided in white finish as standard
Suitable for various architectural ceilings (see mounting details)
Fixture weight: +/- 2.5 lbs/ft

LED SYSTEM

1.5" LINIA DIRECT

Proprietary LED system with color consistency < 3 SDCM
Available in 27K, 30K, 35K, and 40K
Standard 90+ CRI with R9 value of 56
L90 > 60,000 hours

LINEAR ZOIE

Osram LED source
Available in 27K, 30K, 35K, and 40K
Standard 90+ CRI
Color consistency < 2 SDCM
L90 > 60,000 hours

ZOIE WALL WASH

Cree LED source
Available in 27K, 30K, 35K, and 40K
Standard 90+ CRI
Color consistency < 2 SDCM
L90 > 60,000 hours

ELECTRICAL

Luminaires are pre-wired with factory installed quick connects and branch circuit wiring
Standard 0-10V, constant current drivers with 100-1% dimming range and >0.9 power factor
120V Forward Phase/Reverse Phase driver option with 100-1% dimming range
Standard 120/277V universal voltage with several driver options
All drivers are integral and easily accessible through luminaire aperture

LISTING

ETL listed and conforms to UL1598 standard. Certified to CSA22.2 NO.250.0.
Rated for indoor dry or damp locations

WARRANTY

5 Year Warranty on LED and drivers Manufacturer
1 Year Warranty for defects in material and workmanship under normal use
Ambient temperature at fixture should not exceed 25°C

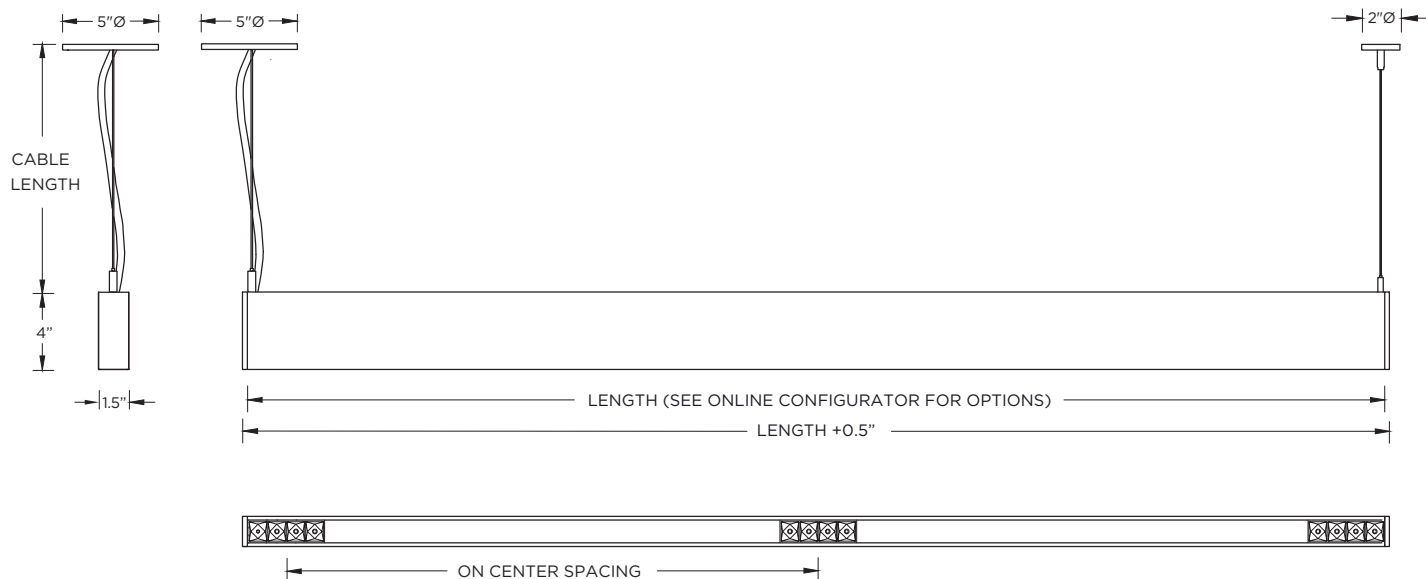

SPECIFY PRODUCT USING ONLINE CONFIGURATOR

INSTALLATION & MOUNTING

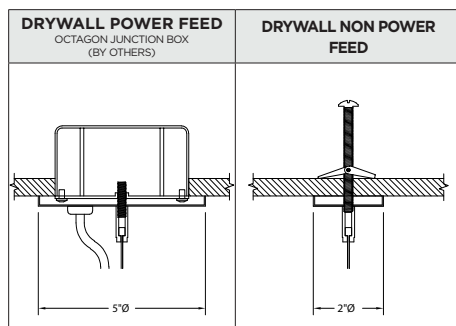
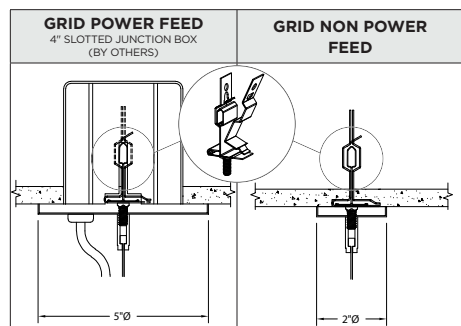
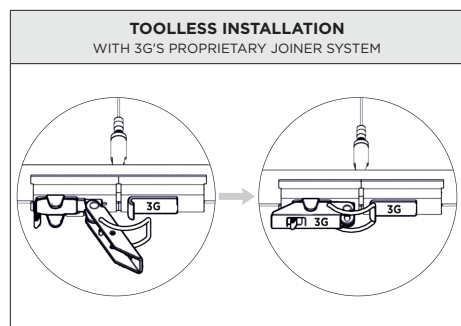

1.5" LINIA - DELIVERED LUMENS PER FOOT BASED ON 90+ CRI AND 3500K SOURCE

LENS OPTION	DELIVERED LUMENS	SYSTEM WATTS (W/FT)	EFFICACY (LPW)
FLUSH	250	2.5	99
	500	5.0	100
	750	7.9	95
	1000	10.9	91
ASYMMETRIC	250	2.5	96
	500	5.0	95
	750	7.9	93
	1000	10.9	89

COLOR TEMP	
2700K	0.94
3000K	0.97
3500K	1.00
4000K	1.01

LINEAR ZOIE - BASED ON 90+ CRI, 3500K, 35D OPTIC

FIXTURE TYPE	LUMEN OUTPUT	DELIVERED LUMENS	SYSTEM WATTS	EFFICACY (LPW)
Z4 - 4" ZOIE	500	539	5.6	97
	1000	1025	10.9	94
Z8 - 8" ZOIE	1000	1000	8.0	125
	1500	1500	13.7	109
	2000	2026	18.9	107
Z12 - 12" ZOIE	1000	1000	8.8	114
	1500	1500	13.3	112
	2000	2000	19.4	103
	2500	2500	24.7	101

BEAM ANGLE	
15D	0.94
35D	1.00
55D	0.80

COLOR TEMP	
2700K	0.94
3000K	0.97
3500K	1.00
4000K	1.07

ZOIE WALL WASH - BASED ON 90+ CRI, 3500K, WALL WASH OPTIC

FIXTURE TYPE	LUMEN OUTPUT	DELIVERED LUMENS	SYSTEM WATTS	EFFICACY (LPW)
Z4WW - 4" ZOIE WW	500	506	6.2	81
	1000	1000	13.0	77
Z8WW - 8" ZOIE WW	1000	1000	11.2	89
	1500	1500	17.1	88
	2000	2000	23.3	86
Z12WW - 12" ZOIE WW	1000	1000	10.9	91
	1500	1500	17.0	88
	2000	2000	22.9	87
	2500	2500	29.0	86
	3000	3000	35.0	86

COLOR TEMP	
2700K	0.92
3000K	0.97
3500K	1.00
4000K	0.98