

3.3"/4.5" ADJUSTABLE ZOE CYLINDER PENDANT

STEM PENDANT MOUNT



THE IMAGES SHOWN ARE FOR ILLUSTRATION ONLY AND MAY NOT BE AN EXACT REPRESENTATION OF THE PRODUCT

COMPONENTS

STANDARD CANOPY

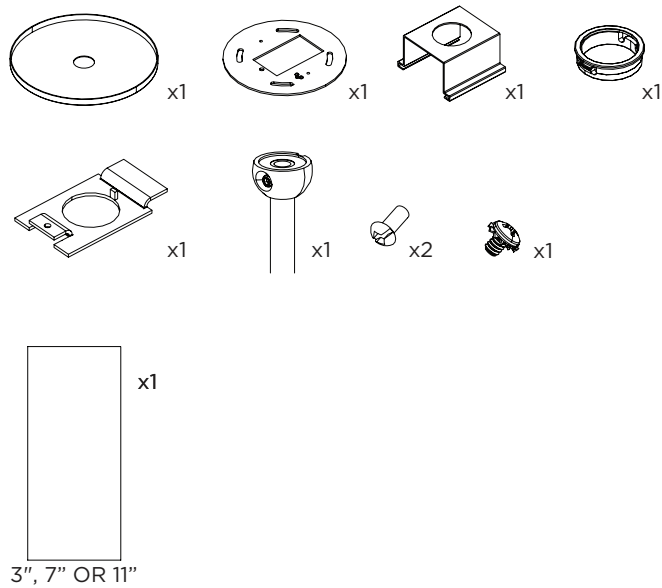

CONDUIT FEED CANOPY

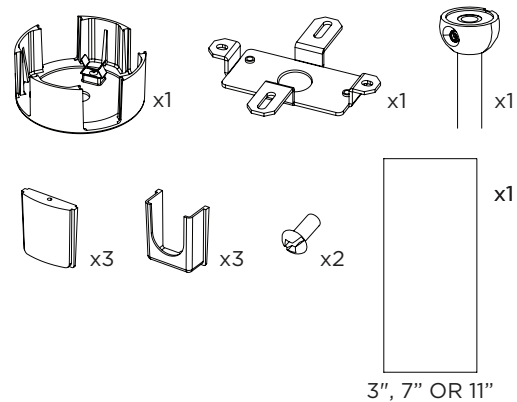

! Ž) ~ \$ CANOPY

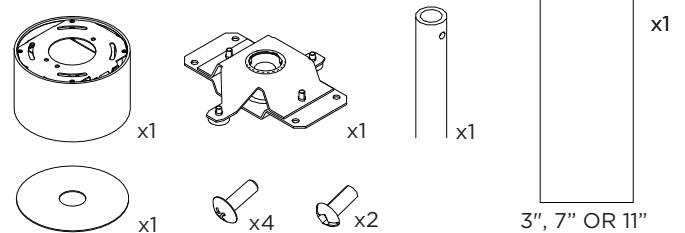

4" OCTAGONAL J-BOX REQUIRED FOR INSTALLATION

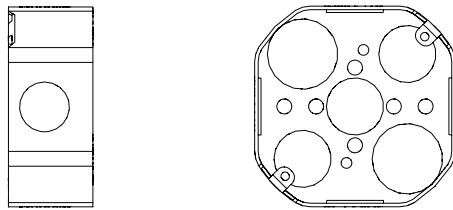

JUNCTION BOX (BY OTHERS)

SUITABLE FOR SLOPED CEILING

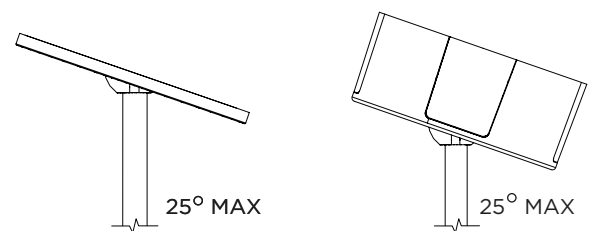

INSTRUCTION KEY

INFORMATION

- ⚠ ADDITIONAL
- ⓘ ATTENTION
- ⚡ POWER ON
- ⓧ POWER OFF

INSTALLATION SHOULD ONLY BE PERFORMED BY A CERTIFIED ELECTRICIAN
REFER TO LOCAL/NATIONAL CODES FOR PROPER INSTALLATION
FAILURE TO FOLLOW INSTALLATION INSTRUCTION MAY VOID THE WARRANTY
DO NOT TOUCH LEDS. LEDS MUST BE PROTECTED FROM MECHANICAL STRESS OR DEBRIS
TURN OFF POWER DURING INSTALLATION OR SERVICING

1A

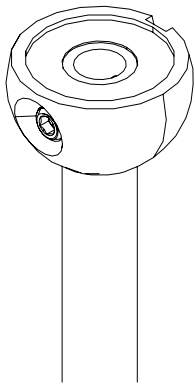

CUT STEM LENGTH
IF APPLICABLE

1B

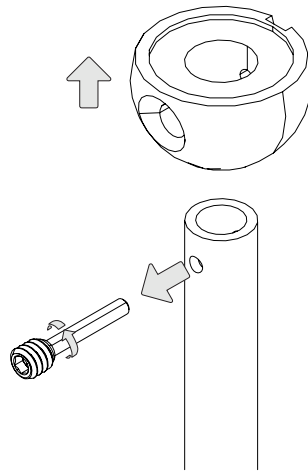

1C

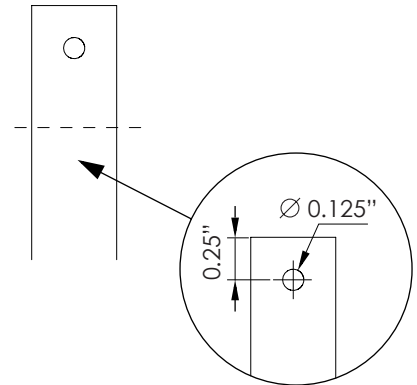

2

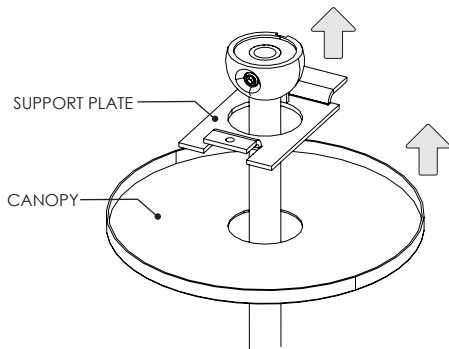

3

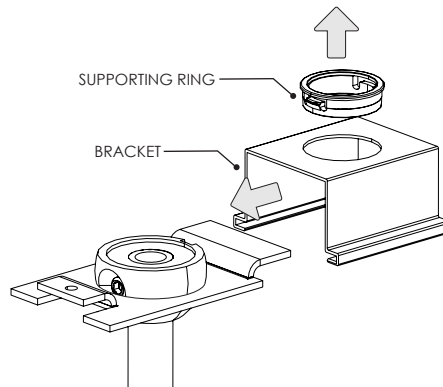

4A

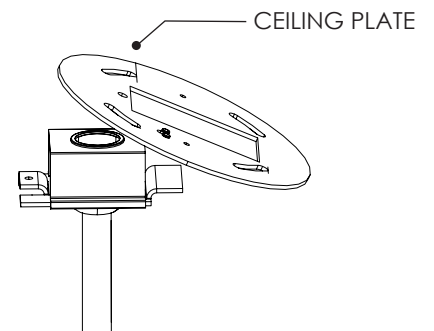

4B

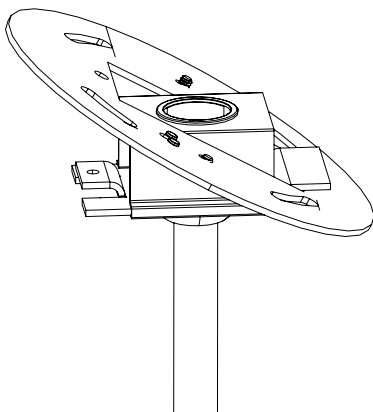

4C

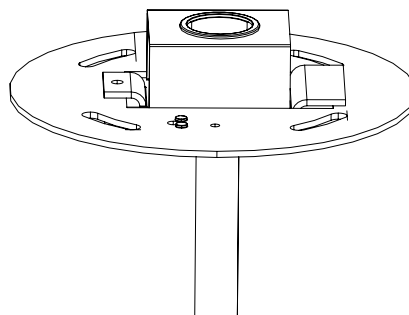

5

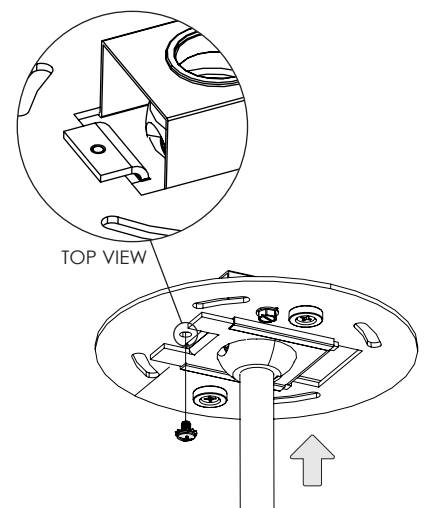

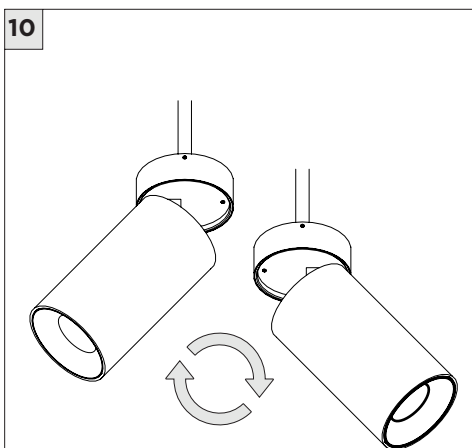
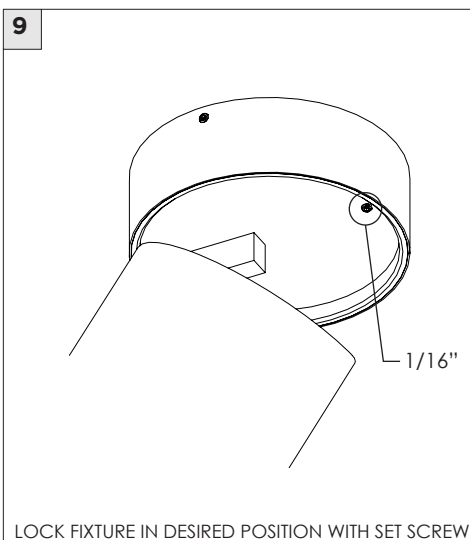
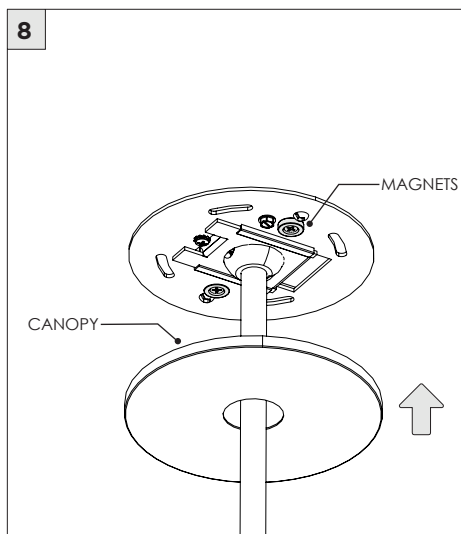
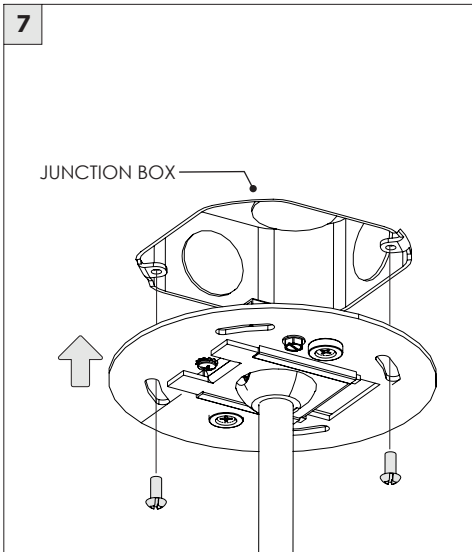
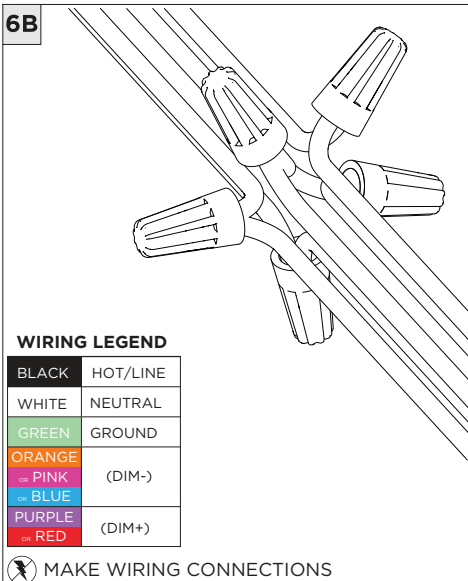
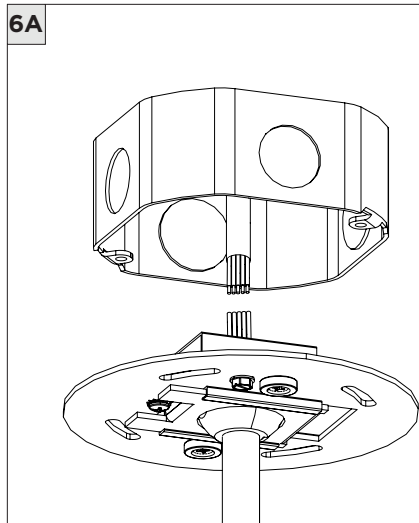

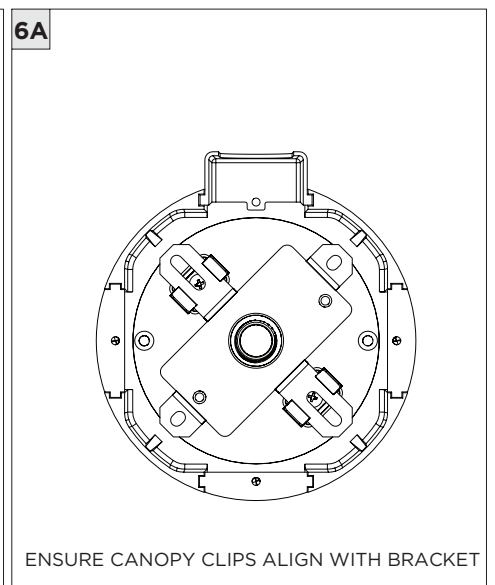
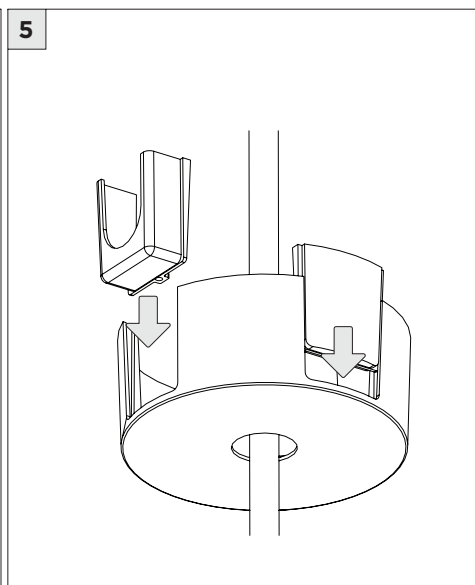
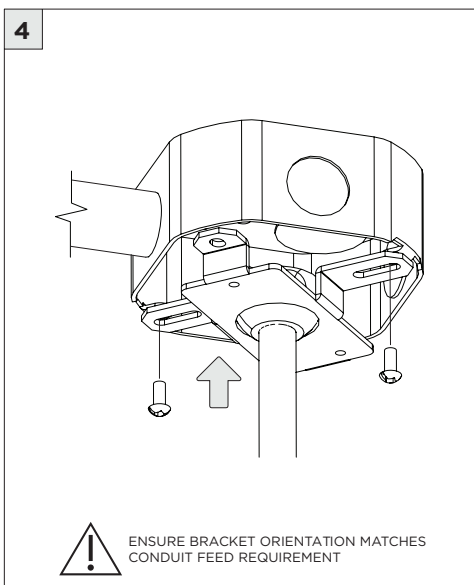
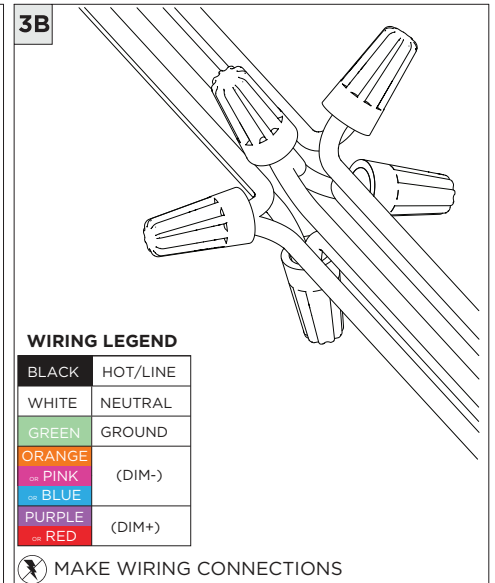
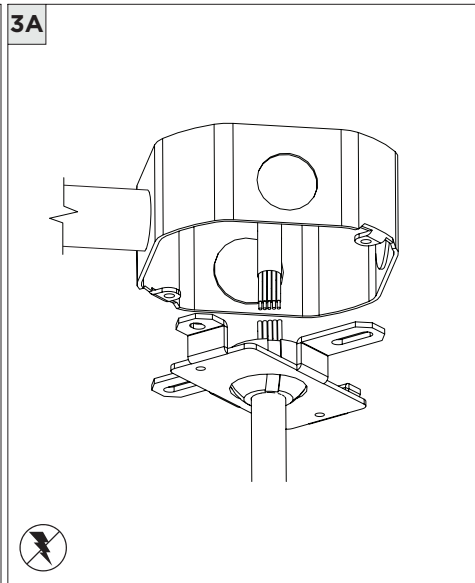
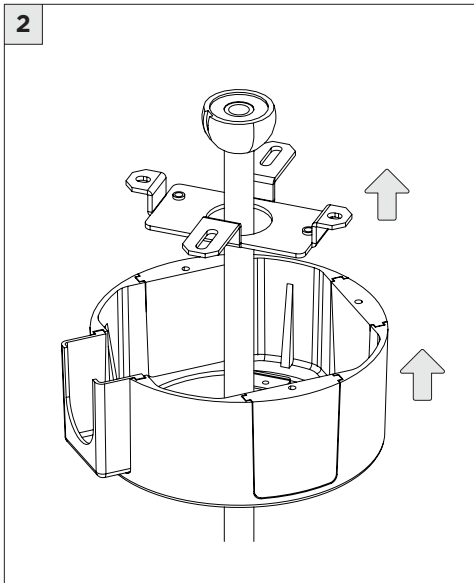
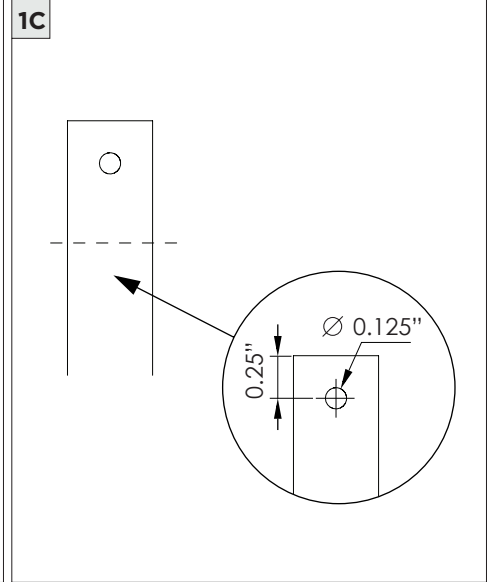
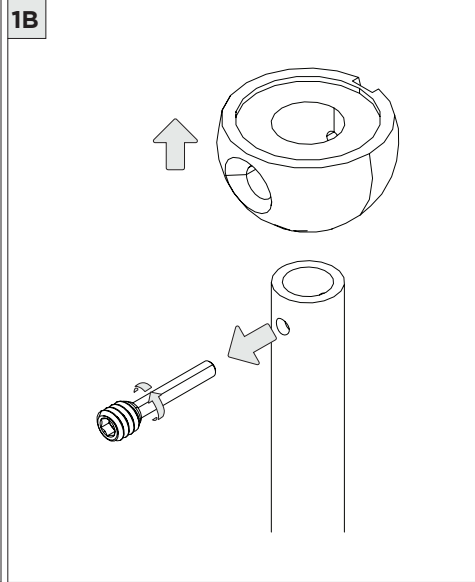
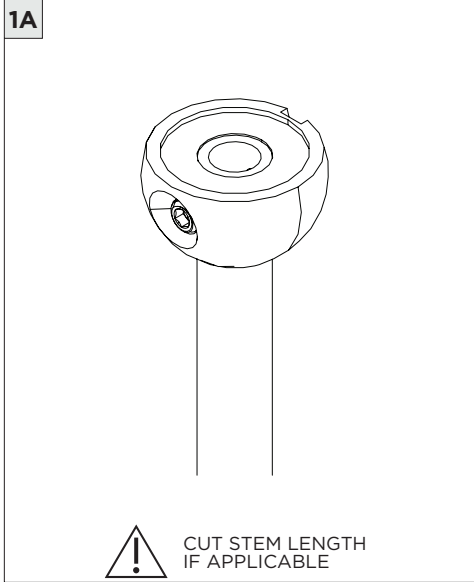

6B

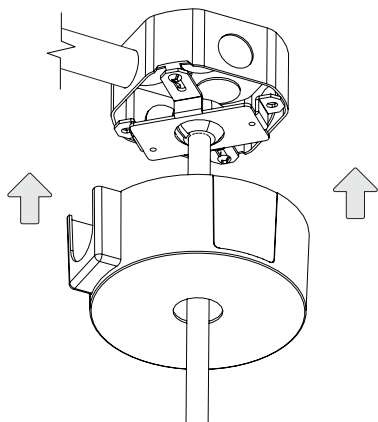

7

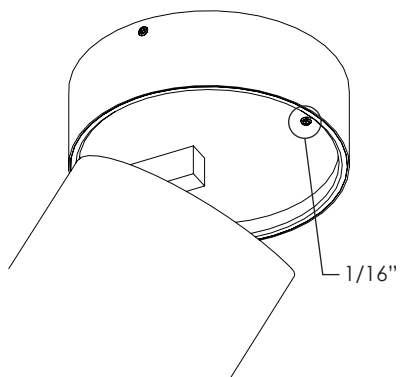

LOCK FIXTURE IN DESIRED POSITION WITH SET SCREW

8

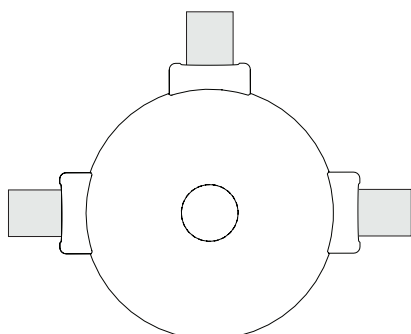
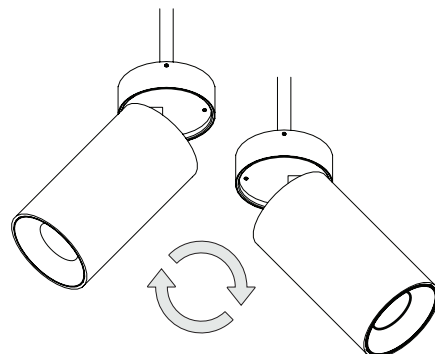

CANOPY IS SUITABLE FOR
MAXIMUM 3 CONDUIT FEEDS

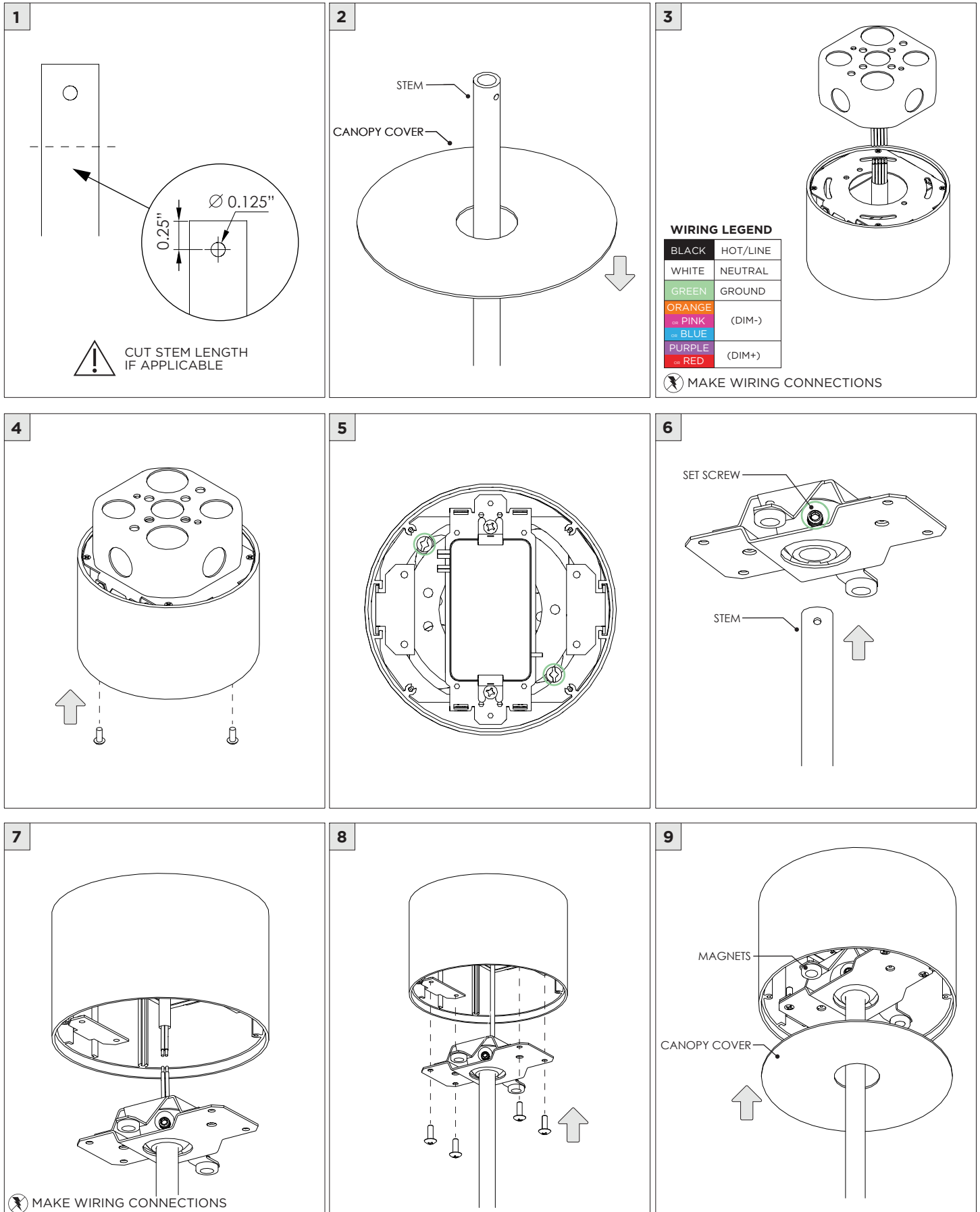

1 CONDUIT FEED CANOPY

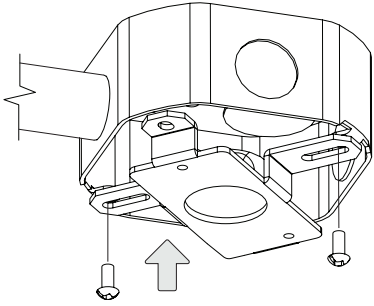

2

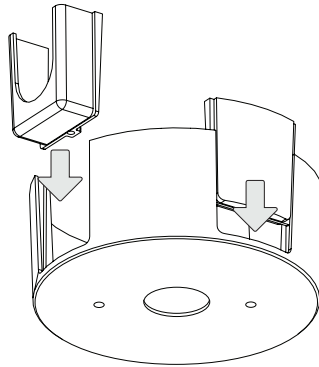

3

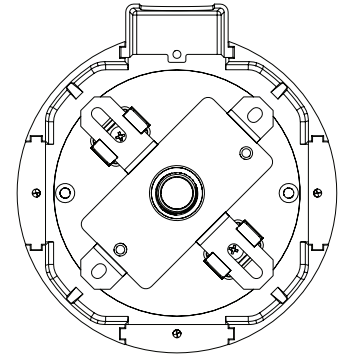

ENSURE CANOPY CLIPS ALIGN WITH BRACKET

4

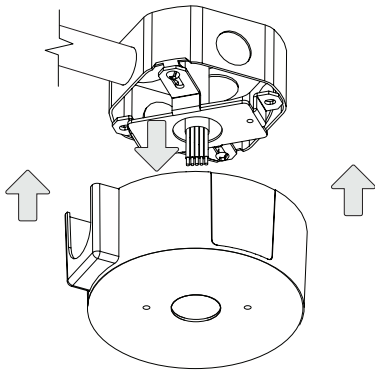

CONNECT CANDUIT CANOPY AND FEED
JUNCTION BOX WIRES THROUGH HOLE

5

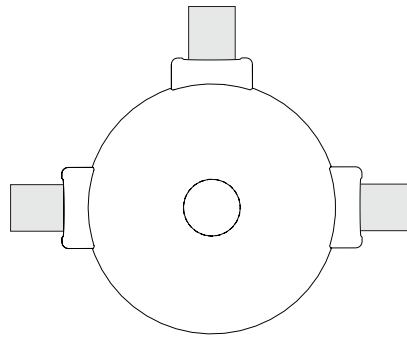

! CANOPY IS SUITABLE FOR
MAXIMUM 3 CONDUIT FEEDS

6 POWER CANOPY

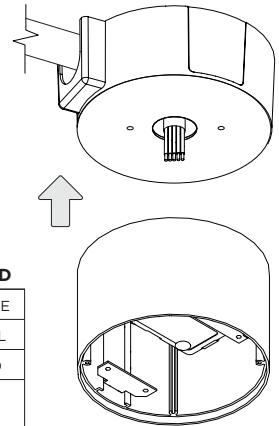

WIRING LEGEND

BLACK	HOT/LINE
WHITE	NEUTRAL
GREEN	GROUND
ORANGE	(DIM-)
PINK	(DIM-)
BLUE	(DIM-)
PURPLE	(DIM+)
RED	(DIM+)

! MAKE WIRING CONNECTIONS

7

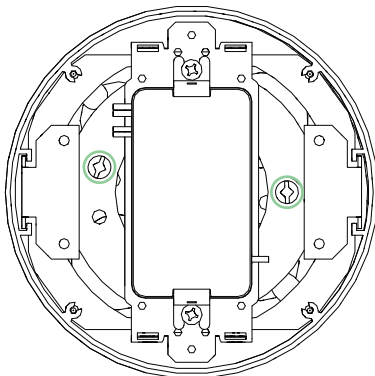

8

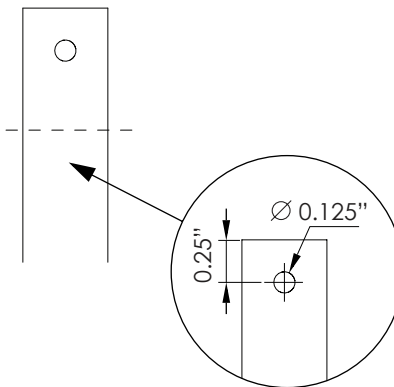

! CUT STEM LENGTH
IF APPLICABLE

9

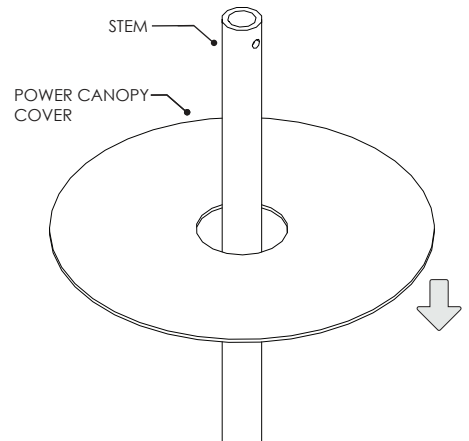

10

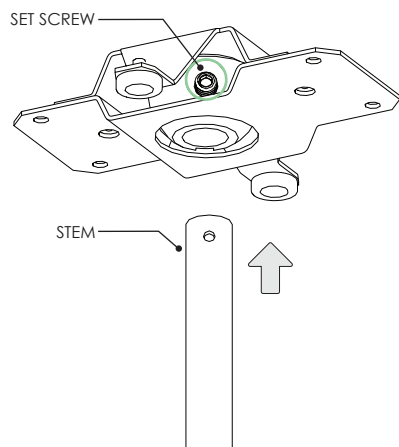

11

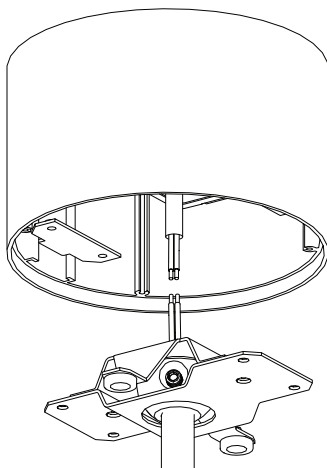

12

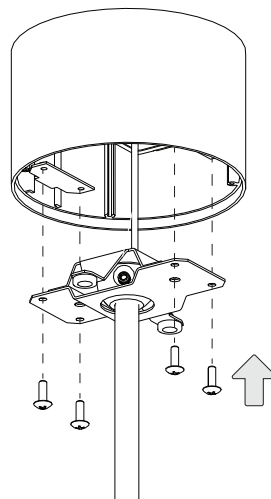

13

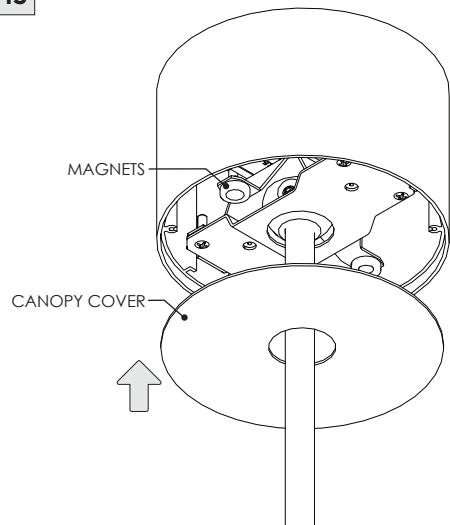

DRIVER SERVICING

1

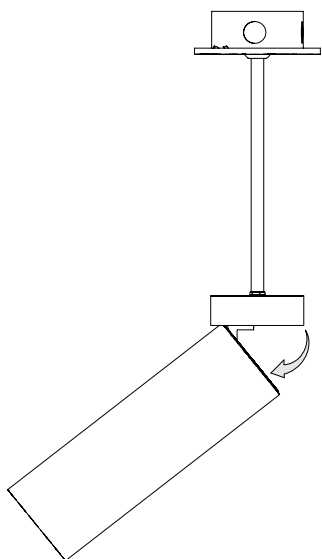

2

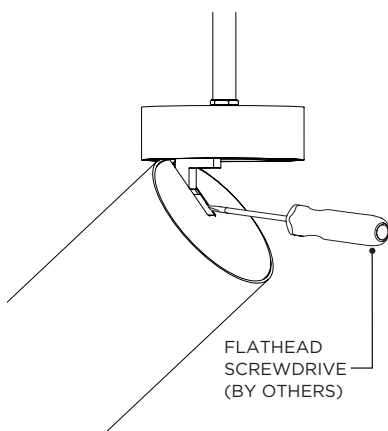

REMOVE MAGNETIC PLATE

3

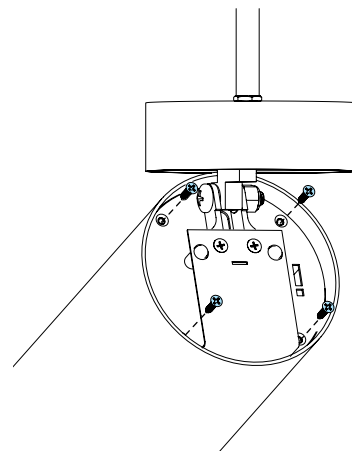

4

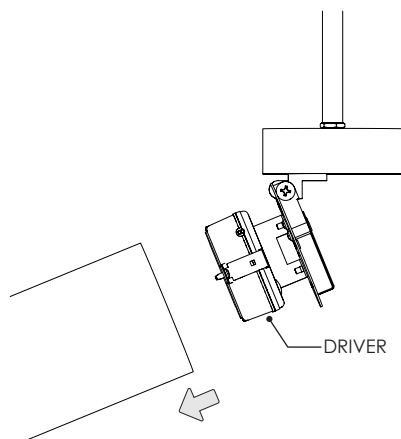

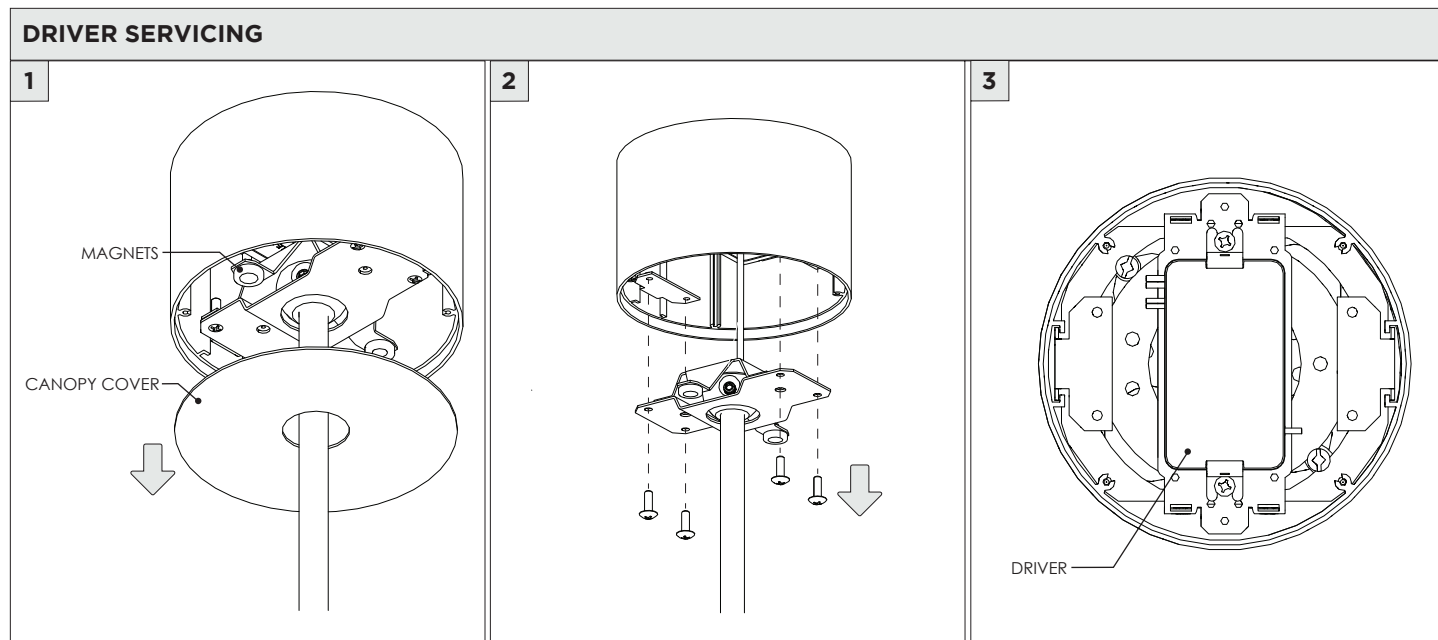

LED SERVICING

1

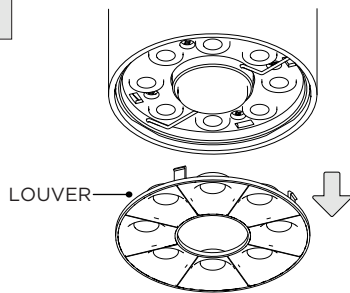

UNCLIP LOUVER FROM LED ASSEMBLY

2

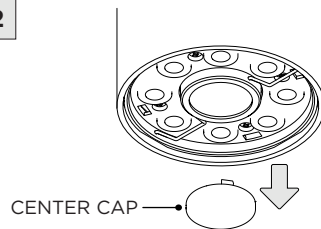

UNCLIP CENTER CAP FROM LED ASSEMBLY

3

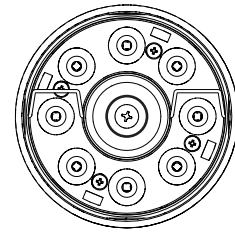

LOCATE CENTER SCREW

4

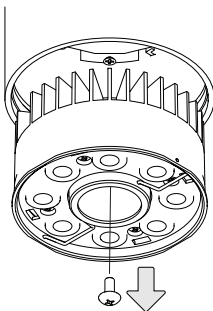

UNSCREW CENTER SCREW TO REMOVE LED ASSEMBLY

5

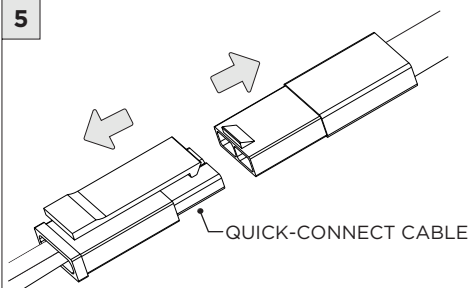

DISCONNECT QUICK-CONNECT CABLE FROM LED ASSEMBLY

6

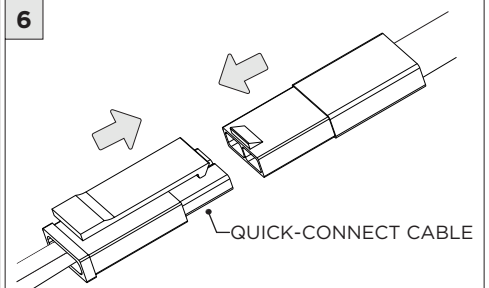

CONNECT QUICK-CONNECT CABLE TO NEW LED ASSEMBLY

7

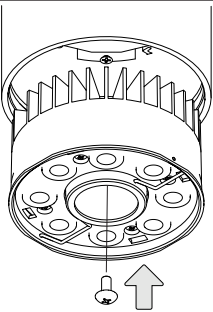

SCREW NEW LED ASSEMBLY INTO CYLINDER

8

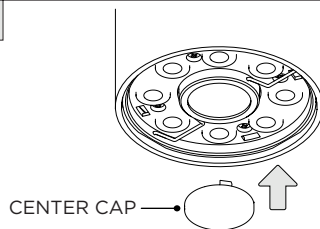

9

