

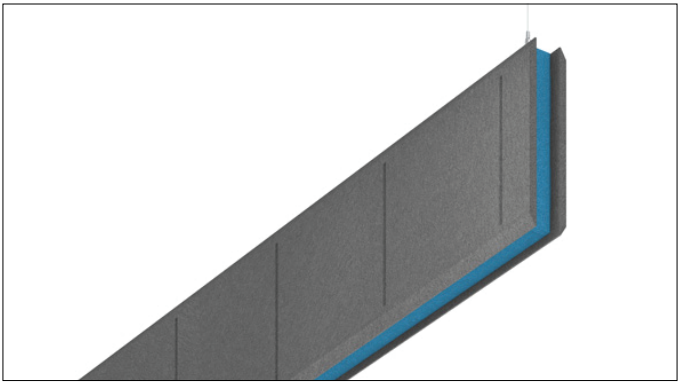









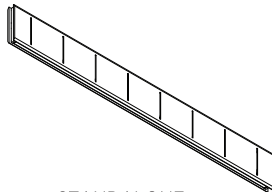







**3G-1PLA-AC**  
**1.5" ACOUSTIC PENDANT**  
BAFFLE ONLY



FIXTURE TYPES		INCLUDED COMPONENTS	
13G-1PLA-PROFILE		<b>Standalone Fixtures (2' to 8')</b>  STANDALONE	
Non - Power feed kit			
 x1  x1  x1  x1   x1  x1   FOR GRID CEILING APPLICATION   x1  x1			
INSTRUCTION KEY		INFORMATION	
 ADDITIONAL	INSTALLATION SHOULD ONLY BE PERFORMED BY A CERTIFIED ELECTRICIAN		
 ATTENTION	REFER TO LOCAL/NATIONAL CODES FOR PROPER INSTALLATION		
 POWER ON	FAILURE TO FOLLOW INSTALLATION INSTRUCTION MAY VOID THE WARRANTY		
 POWER OFF	DO NOT TOUCH LEDS. LEDS MUST BE PROTECTED FROM MECHANICAL STRESS OR DEBRIS		
		TURN OFF POWER DURING INSTALLATION OR SERVICING	

**SUSPENSION CABLE LOCATION**

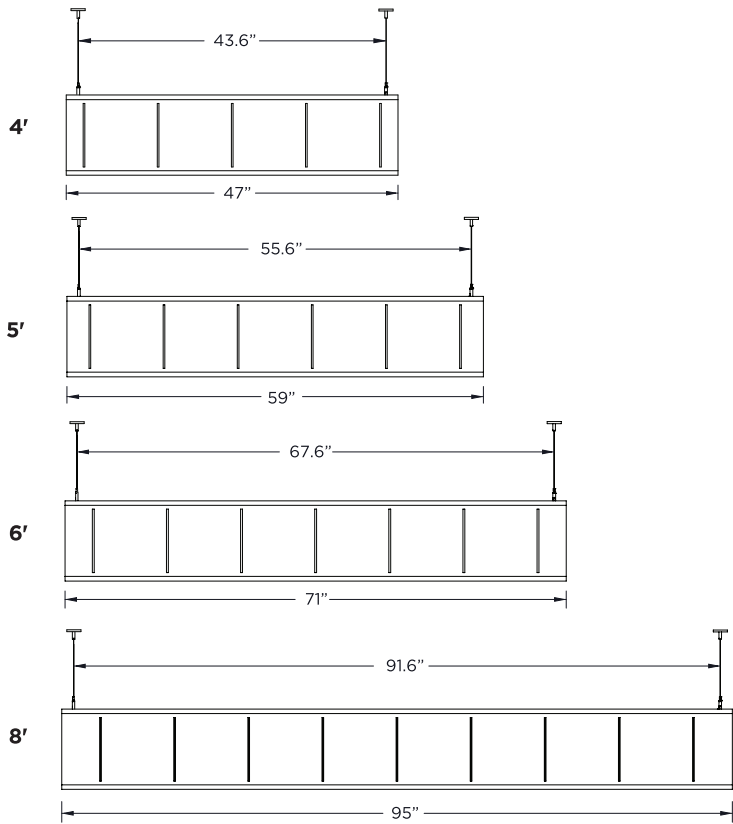

**1** DRYWALL SUSPENSION - NON-POWER FEED

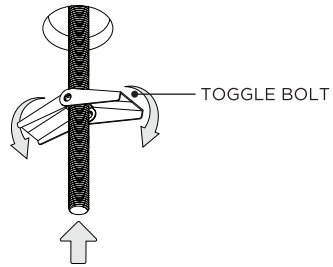

**1A**

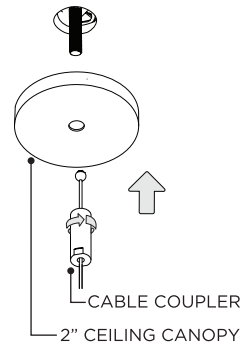

**2**

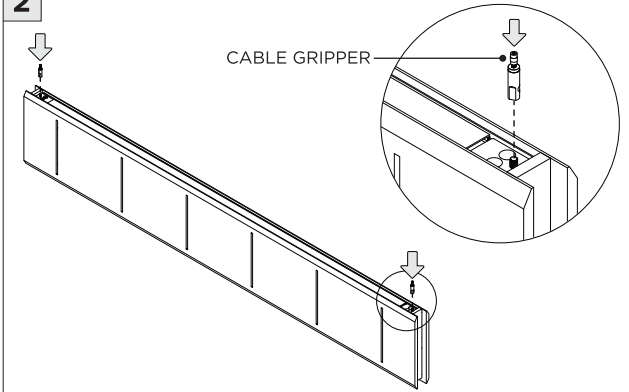

**3**

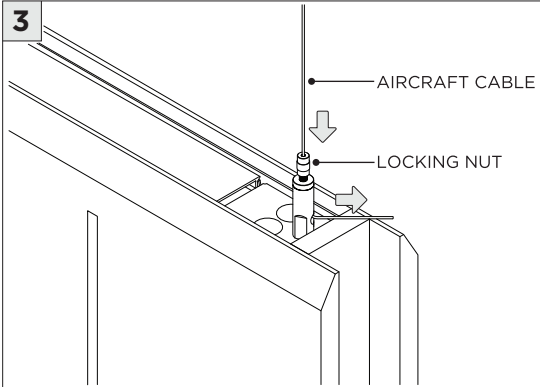

**i** ADJUST CABLE LENGTH AND LOCK IN PLACE WITH LOCKING NUT

**4**

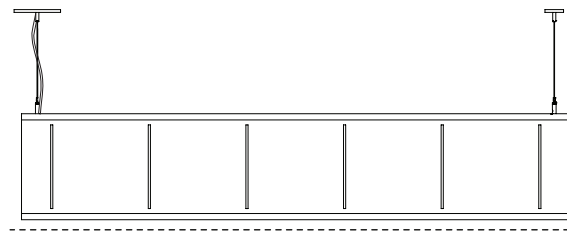

**i** ENSURE FIXTURE IS LEVEL

**1** GRID CEILING SUSPENSION - NON-POWER FEED

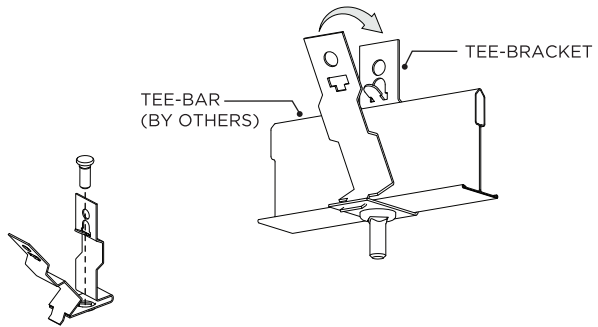

**1A**

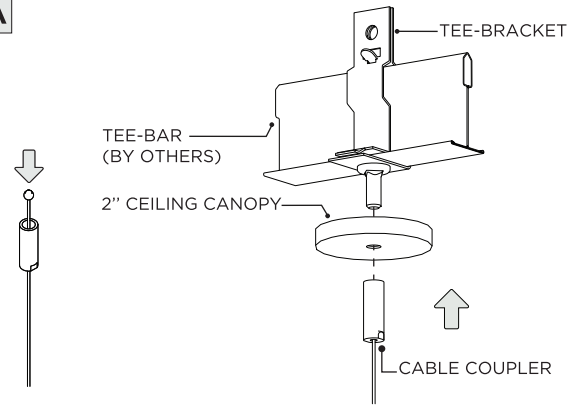

**2**

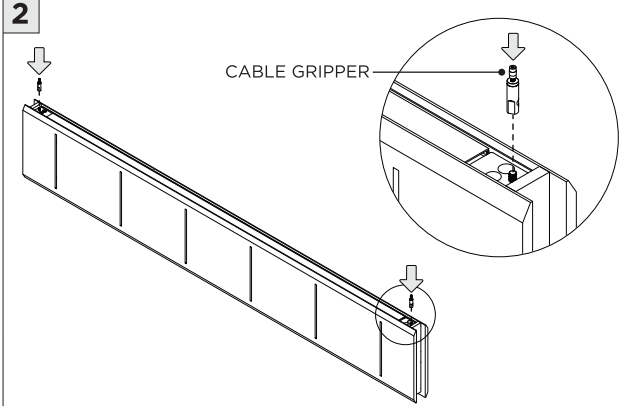

**3**

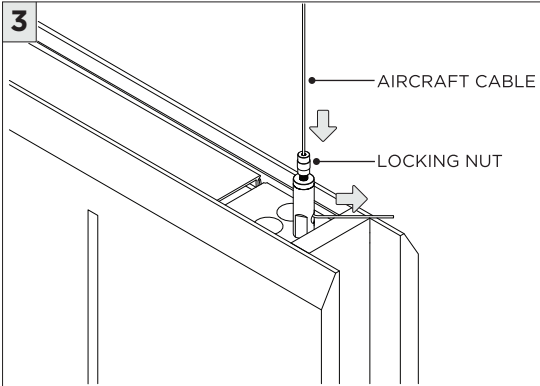

**i** ADJUST CABLE LENGTH AND LOCK IN PLACE WITH LOCKING NUT

**4**

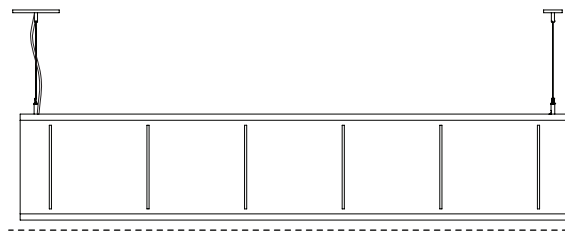

**i** ENSURE FIXTURE IS LEVEL