

# 3G LIGHTING

## 3G-48RDSL-S

4.8" RECESSED DOWNLIGHT SLOT  
3" SQUARE DOWNLIGHTS

4.8" Recessed Downlight Slot designed for continuous runs  
Machined aluminum faceplate with square, trimless downlight integration  
3" square adjustable or 3" square fixed downlight option  
Standard 95+ CRI LED system with performance up to 133 LPW  
Delivered lumen range up to 3000lm at 95+ CRI  
10° to 90° beam angle options suitable for various applications  
Companion to 3G-DL33S downlight and cylinder families



### WT - TRIM

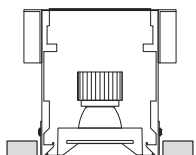

### XTR - TRIMLESS

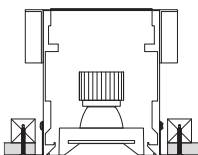

### FX - FLANGELESS

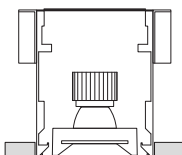

### GCX - GRID CEILING

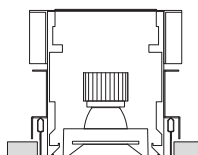

### OPTICS

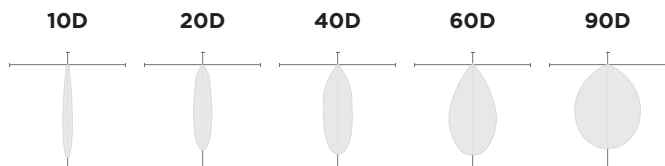

### PERFORMANCE

LUMEN OUTPUT	DELIVERED LUMENS	SYSTEM WATTS	EFFICACY (LPW)
1000	1000	9.3	114
1500	1500	13.6	112
2000	2000	18.4	109
2500	2500	23.9	104
3000	3000	29.9	100

BASED ON FIXED DOWNLIGHT OPTION  
WITH 95+ CRI, 35K, 40D OPTIC AND SOFTENING LENS  
Lumen output and actual wattage may vary +/- 5%

### PATTERNS

Specify pattern shape and overall dimensions as shown below. Patterns are connected with 12"x12" mitered corner sections (Downlights not available). Please consult factory for custom patterns and shapes not shown below.

L-SHAPE	U-SHAPE	RECTANGLE/SQUARE
<p>Provide dimensions of AxB Example: <b>L</b> - 6'x8'</p>	<p>Provide dimensions of AxBxC Example: <b>U</b> - 8'x10'x6"</p>	<p>Provide dimensions of AxB Example: <b>R</b> - 10'x8'</p>

<b>PROJECT:</b>		<b>TYPE:</b>	
<b>CATALOG#:</b>		<b>DATE:</b>	<b>QTY:</b>

CAT. NO	DOWNLIGHT TYPE	LUMEN OUTPUT (DELIVERED)	CRI
<b>3G-48RDSL-S</b>	<b>33SF</b> - 3" SQUARE FIXED <b>33SA</b> - 3" SQUARE ADJUSTABLE  33SA (adjustable) option available up to 1500lm	<b>10</b> - 1000 LUMENS <b>15</b> - 1500 LUMENS <b>20</b> - 2000 LUMENS <b>25</b> - 2500 LUMENS <b>30</b> - 3000 LUMENS  All lumen outputs are delivered lumens at 95+ CRI	<b>H95</b> - 95+ CRI

COLOR TEMP	BEAM ANGLE	VOLTAGE	DRIVER
<b>27K</b> - 2700K <b>30K</b> - 3000K <b>35K</b> - 3500K <b>40K</b> - 4000K	<b>10D</b> - 10° <sup>1</sup> <b>20D</b> - 20° <sup>1</sup> <b>40D</b> - 40° <b>60D</b> - 60° <b>90D</b> - 90° *  *90D optic supplied with lens Not available with other lens options Not available with 33RA (adjustable)	<b>UNV</b> - 120/277V <b>120</b> - 120V <b>347</b> - 347V <sup>2</sup>	<b>DIM</b> - 0-10V (100-1%) <b>LE</b> - PHASE DIM <sup>3</sup> (TRIAC/ELV, 100-1%) <b>D01</b> - 0-10V (100-0.1%) <b>DALI</b> - DALI (100-1%) <sup>4</sup> <b>DHL2</b> - LUTRON HI-LUME (1% ECOSYSTEM) <b>DMX</b> - DMX (100-0%)

FLANGE TYPE	HOUSING AND FACEPLATE	DOWNLIGHT INSERT	OPTIONS
<b>WT</b> - WHITE TRIM (STANDARD) <b>BT</b> - BLACK TRIM <b>XTR</b> - TRIMLESS (MUD-IN DRYWALL) <b>FX</b> - FLANGELESS <b>GCX</b> - GRID CEILING * (UNIVERSAL MOUNT)  *Universal mounting brackets used for grid ceiling types only. See mounting details	<b>BK</b> - BLACK (STANDARD) <b>WH</b> - WHITE	<b>BI</b> - BLACK <b>WI</b> - WHITE <b>SI</b> - SILVER	<b>SF</b> - SOFTENING LENS * (SUPPLIED STANDARD) <b>LS</b> - LINEAR SPREAD LENS <b>SB</b> - SANDBLASTED LENS <b>2C</b> - 2 CIRCUIT <b>3C</b> - 3 CIRCUIT <b>CP</b> - CHICAGO PLENUM <b>EMR</b> - EMERGENCY BATTERY <sup>5</sup> (REMOTE)  *Softening lens not provided with 90D optic Maximum 1 optical accessory

RUN TYPE	DOWNLIGHT SPACING
<b>S</b> - ____' (STRAIGHT) <b>L</b> - ____'X ____' (L-SHAPE) <b>U</b> - ____'X ____'X ____' (U-SHAPE) <b>R</b> - ____'X ____' (RECTANGLE/SQUARE)  U-Shape and R-Rectangle/Square not available with grid ceiling applications Continuous runs available in 6" increments	<b>12</b> - 12" ON CENTER <b>18</b> - 18" ON CENTER <b>24</b> - 24" ON CENTER <b>36</b> - 36" ON CENTER <b>48</b> - 48" ON CENTER <b>CUS(xx)</b> - CUSTOM SPACING *  *Specify number of downlights (XX)

- <sup>1</sup> 10D and 20D reflector available up to 2000lm  
<sup>2</sup> 347 available in "DIM" 0-10V only (100-1%)  
<sup>3</sup> Phase dimming options available in 120V only  
<sup>4</sup> DALI-2 (Type 6) provided as standard  
<sup>5</sup> Supplied with enclosure with Emergency Battery and driver. Installed remotely by others. Not accessible through fixture aperture

## PERFORMANCE

### 3" SQUARE FIXED DOWNLIGHT

LUMEN OUTPUT	DELIVERED LUMENS	SYSTEM WATTS	EFFICACY (LPW)
1000	1000	9.3	114
1500	1500	13.6	112
2000	2000	18.4	109
2500	2500	23.9	104
3000	3000	29.9	100

BASED ON 95+ CRI, 3500K, 40D OPTIC WITH SOFTENING LENS  
Lumen output and actual wattage may vary +/- 5%

### 3" SQUARE ADJUSTABLE DOWNLIGHT

LUMEN OUTPUT	DELIVERED LUMENS	SYSTEM WATTS	EFFICACY (LPW)
1000	1000	9.6	104
1500	1500	15.6	96

BASED ON 95+ CRI, 3500K, 40D OPTIC WITH SOFTENING LENS  
Lumen output and actual wattage may vary +/- 5%

## MULTIPLIERS

BEAM ANGLE	
10D	0.90
20D	1.17
40D	1.00
60D	0.97
90D	0.85

COLOR TEMP	
2700K	0.98
3000K	1.00
3500K	1.00
4000K	1.02

BEAM ANGLE	
10D	0.93
20D	1.25
40D	1.00
60D	0.98

COLOR TEMP	
2700K	0.98
3000K	1.00
3500K	1.00
4000K	1.02

## HOUSING

Housing constructed in extruded aluminum and cold rolled steel  
Designed for continuous runs in various configurations  
Maximum ceiling thickness of 1.75". Consult factory for modifications  
Machined aluminum faceplates with trimless downlight integration  
Standard matte black powder coated housing and faceplate finish  
Trim flange with power coated finish and 0.400" overlap  
Trimless model features a perforated galvanized mudding flange

## DOWNLIGHT INSERT

Cast aluminum beveled insert with matte powder coated finish  
3" aperture with regressed LED source for enhanced glare control

## ADJUSTABILITY

Adjustable downlight option with 40 degree tilt along length of channel and 25 degree tilt across the width  
Proprietary hot aiming mechanism with sliding center beam optimization and 360° rotation

## OPTICS

Proprietary anodized, aluminum reflectors  
Beam angle available in 10°, 20°, 40°, 60° and 90°  
Reflectors are field replaceable (10° reflector not interchangeable)  
Softening lens supplied standard

## LED SYSTEM

Standard 95+ CRI  
Color consistency <2 SDCM  
Available in 27K, 30K, 35K, and 40K  
L90 > 50,000 hours

## ELECTRICAL

Standard 0-10V, constant current drivers  
100-1% dimming range and > 0.9 power factor  
Standard 120/277V universal voltage with several driver options  
120V Forward Phase/Reverse Phase driver option (100-1%)  
Integral drivers are easily accessible through channel aperture

## EMERGENCY

Title 24 Certified. 7W output for 90 minutes  
800lm at 95+ CRI (fixed DL) and 765lm at 95+ CRI (adjustable DL)  
Remote emergency battery (not accessible through fixture aperture)  
Maximum remote mounting distance:  
3000lm or below - 50ft (12AWG) or 25ft (14AWG)  
Caution: Emergency Battery utilizes more than one power source and servicing should be performed by qualified personnel

## MOUNTING

New construction housing suspended via 1/4" threaded rod or suspension cables (by others)  
Trim fixture designed for use in drywall, wood, and other architectural ceiling materials  
Trimless fixture designed for use in drywall, mud-in ceiling applications  
Flangeless fixture designed for use in wood ceilings  
Suitable for various grid ceiling applications (see mounting details)

## LISTING

ETL listed and conforms to UL1598 standard  
Certified to CSA22.2 No.250.0.  
JA8 certified  
Rated for dry or damp locations

## WARRANTY

5 Year Warranty on LED and drivers  
LED system rated for operation in ambient environments up to 25°C

**HARD CEILING**

**WT - TRIM**

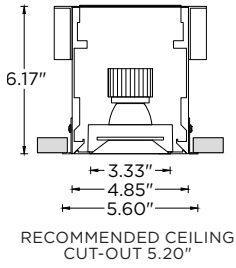

**XTR - TRIMLESS**

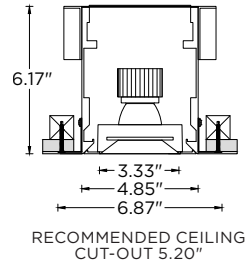

**FX - FLANGELESS**

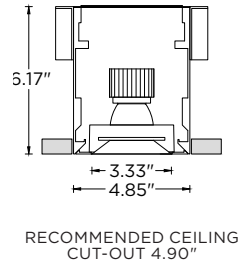

**TRIM**

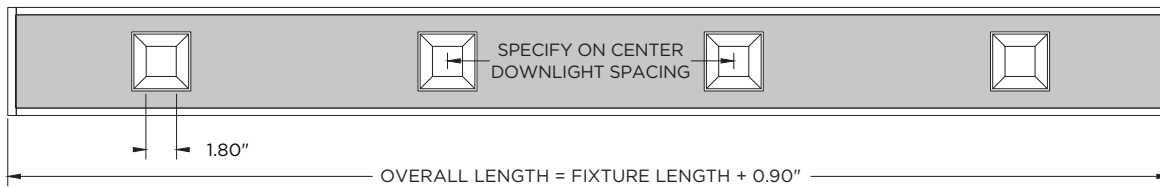

**TRIMLESS (MUD-IN DRYWALL)**

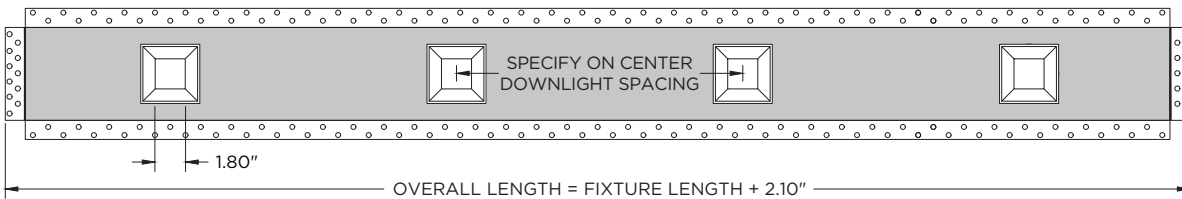

**FLANGELESS**

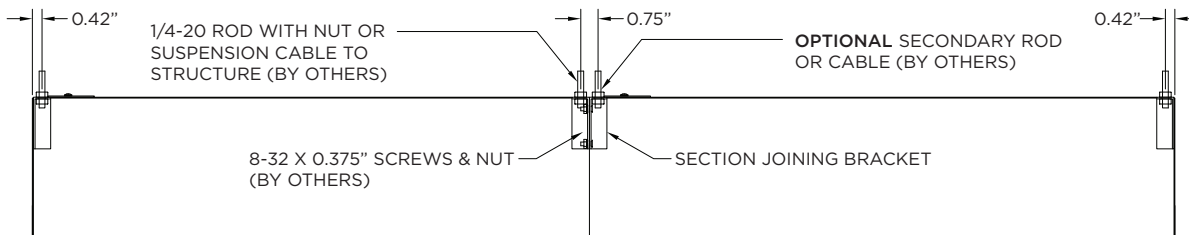
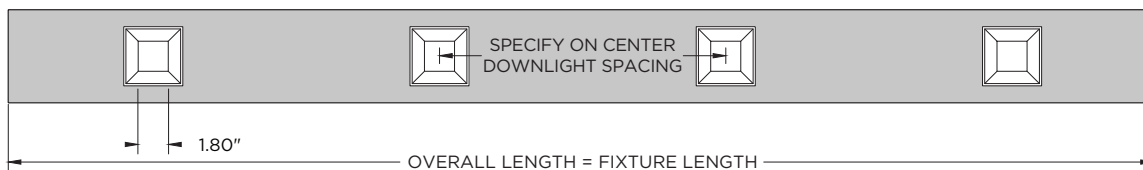

**GRID CEILING**

**9L - 9/16" LAYIN**

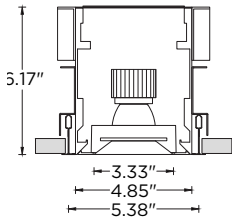

**9TG - 9/16" TEGULAR**

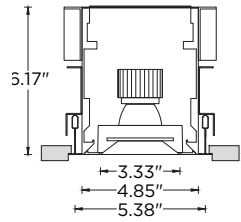

**15L - 15/16" LAYIN**

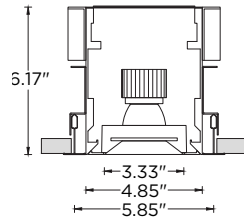

**15TG - 15/16" TEGULAR**

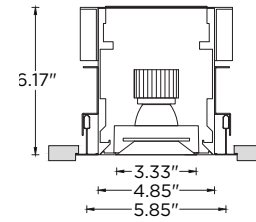

**9ST - 9/16" SLOT TEE TEGULAR**

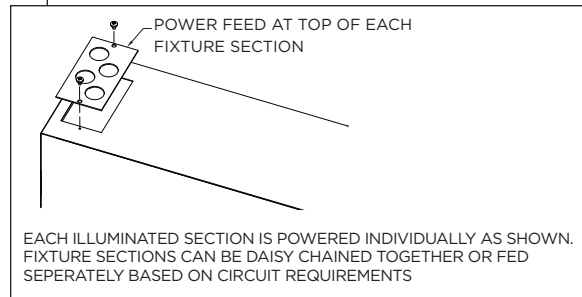
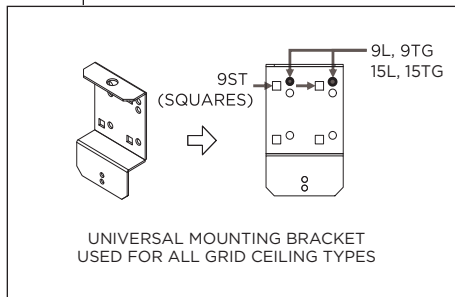
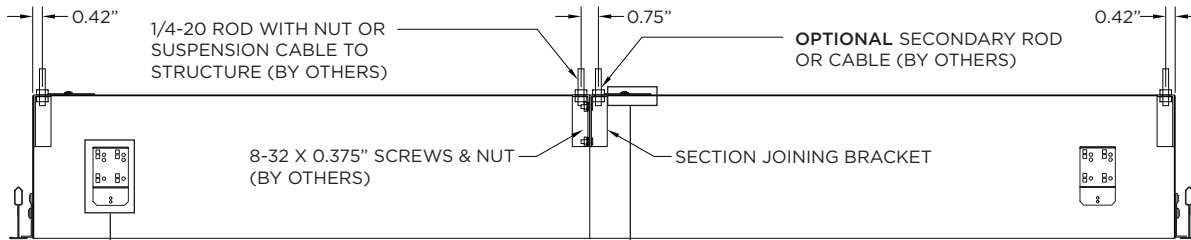
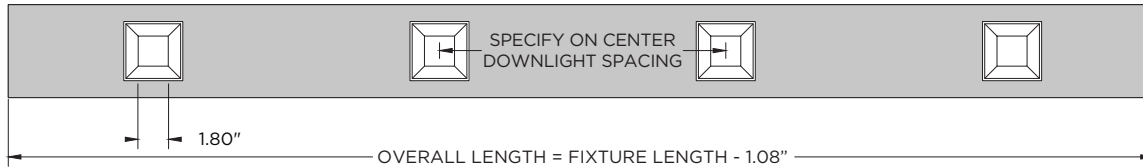
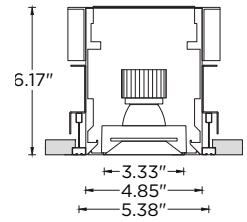

**DOWNLIGHT ADJUSTABILITY**

**WIDTH**

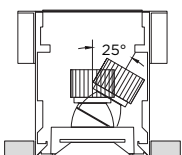

**LENGTH**

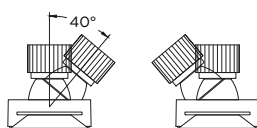

**ROTATION**

