

3.3" WALL WASH CYLINDER

SURFACE MOUNT



COMPONENTS

STANDARD CANOPY

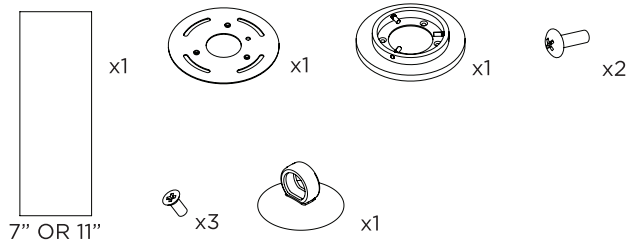

CONDUIT FEED CANOPY

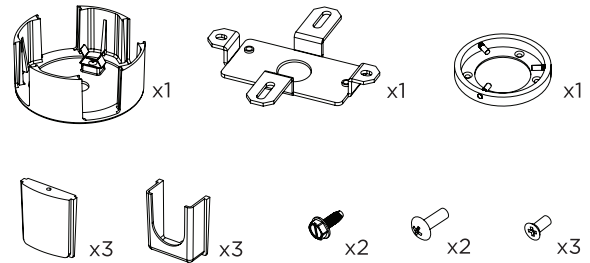

SEAMLESS CANOPY (FOR NEW CONSTRUCTION ONLY)

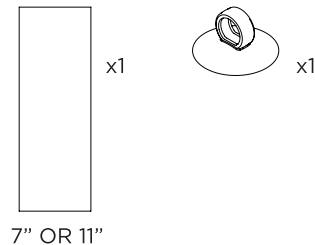
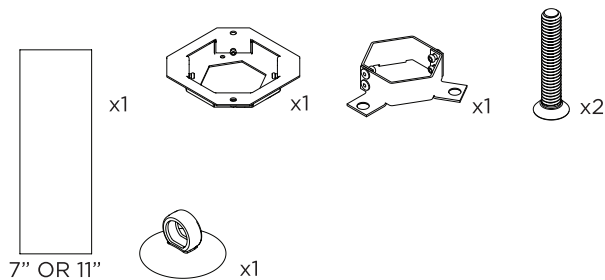

4" OCTAGONAL J-BOX REQUIRED FOR INSTALLATION

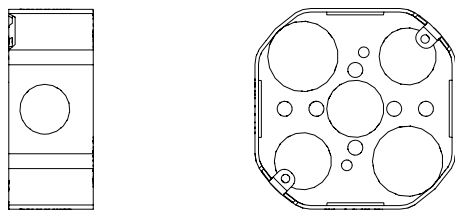

JUNCTION BOX (BY OTHERS)

INSTRUCTION KEY

INFORMATION

- ⚠️ ADDITIONAL
- ⓘ ATTENTION
- ⚡ POWER ON
- ⚡ POWER OFF

INSTALLATION SHOULD ONLY BE PERFORMED BY A CERTIFIED ELECTRICIAN
REFER TO LOCAL/NATIONAL CODES FOR PROPER INSTALLATION
FAILURE TO FOLLOW INSTALLATION INSTRUCTION MAY VOID THE WARRANTY
DO NOT TOUCH LEDS. LEDS MUST BE PROTECTED FROM MECHANICAL STRESS OR DEBRIS
TURN OFF POWER DURING INSTALLATION OR SERVICING

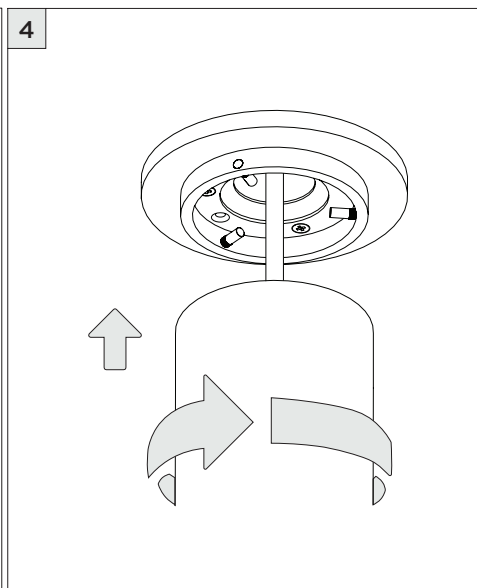
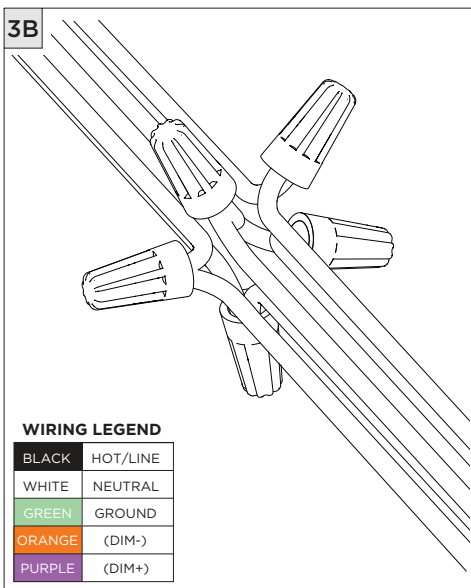
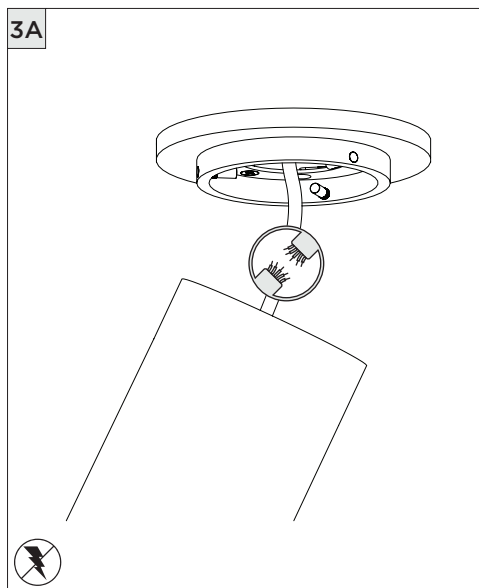
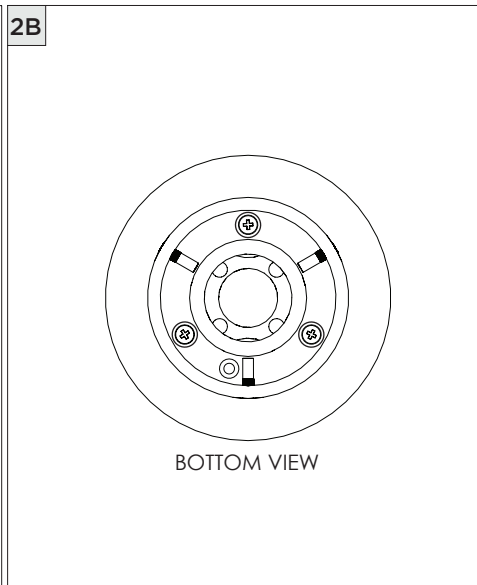
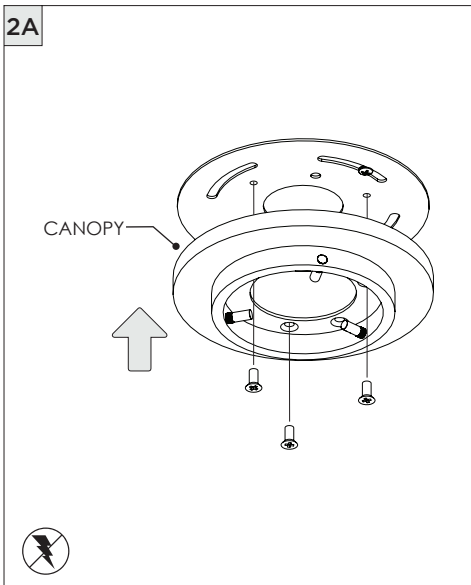
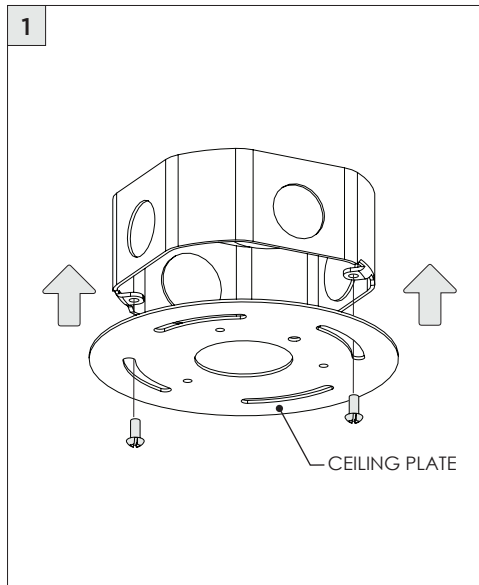

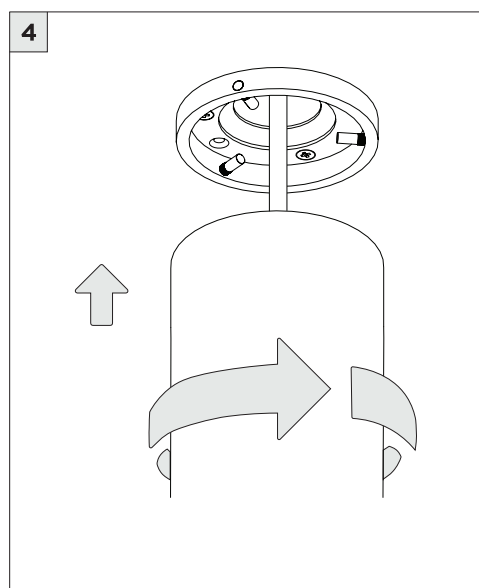
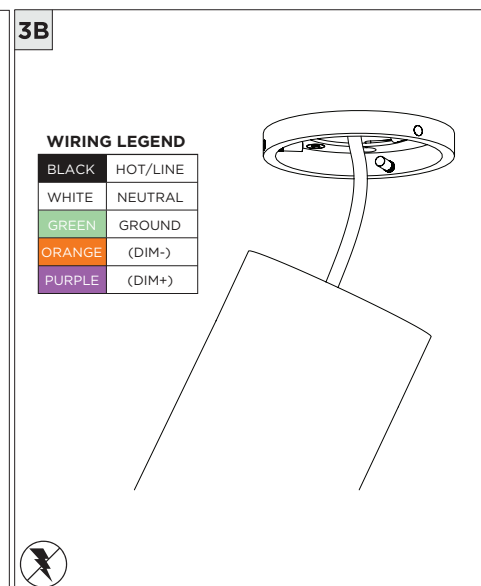
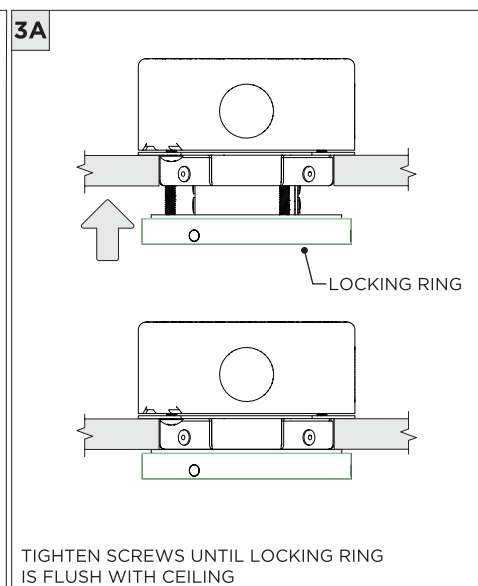
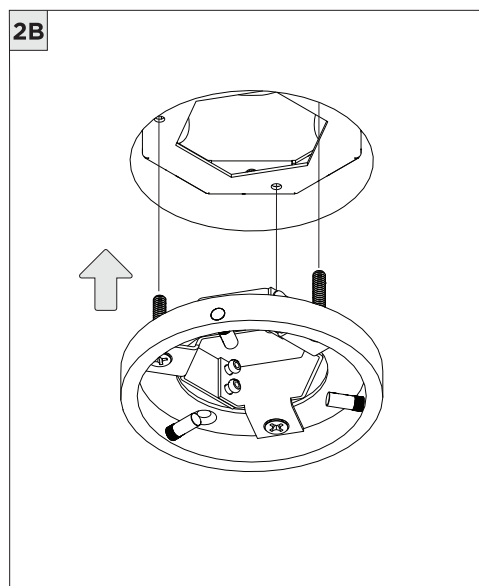
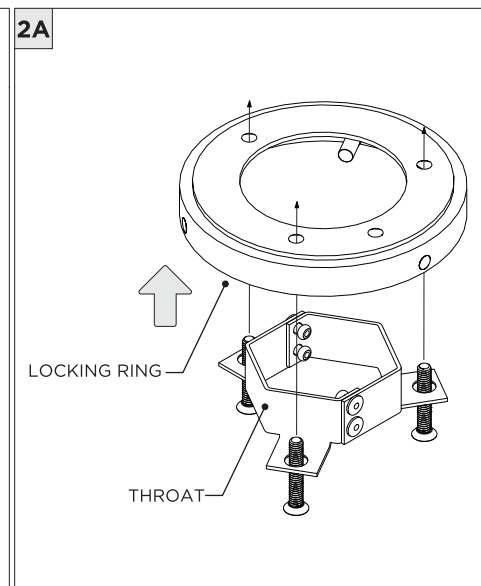
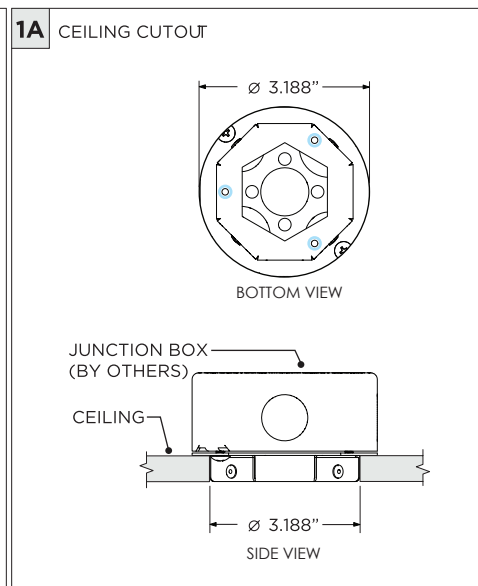
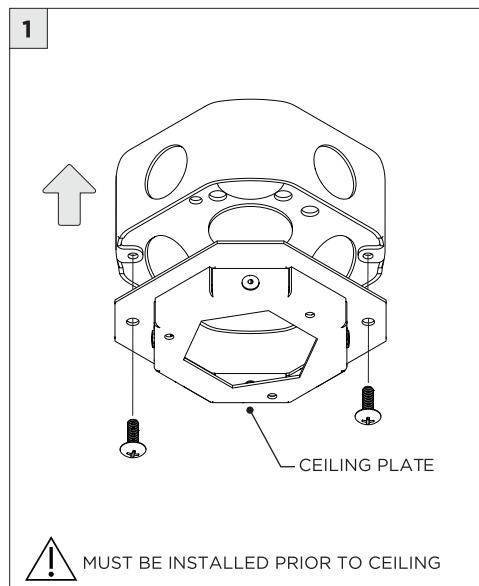

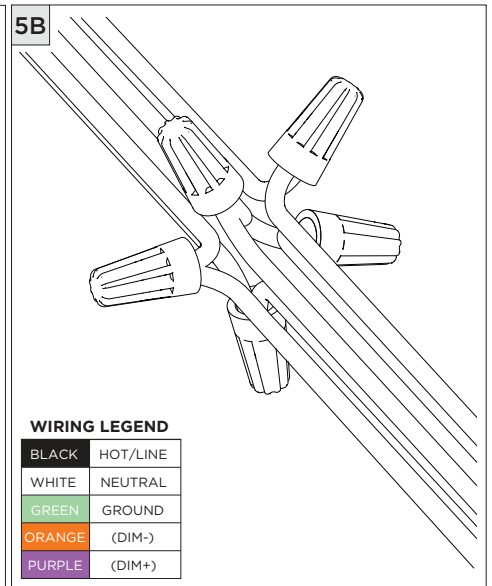
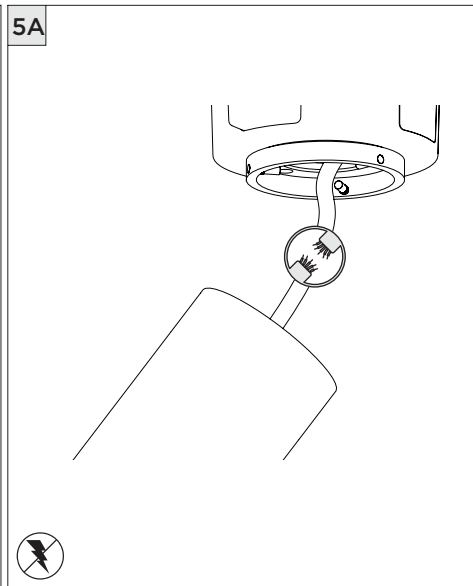
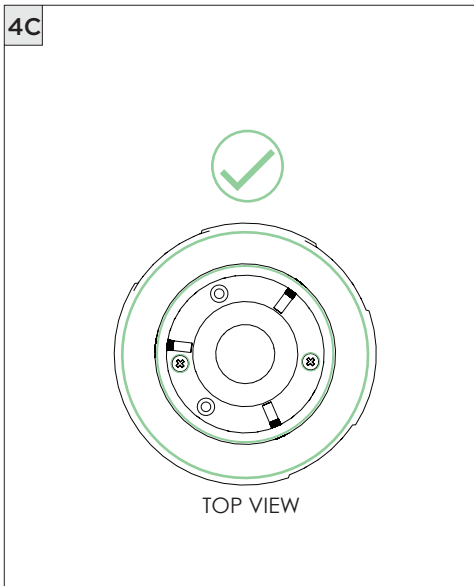
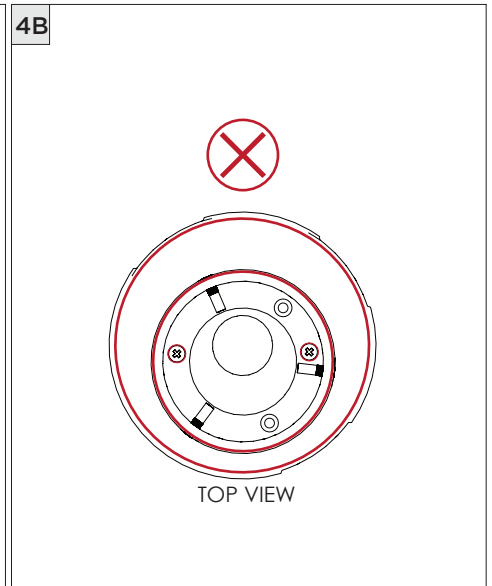
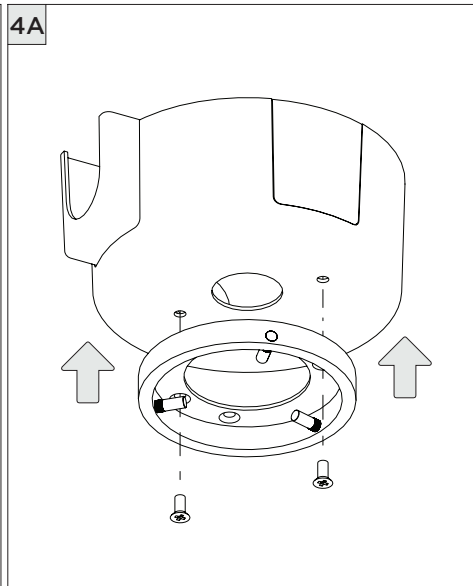
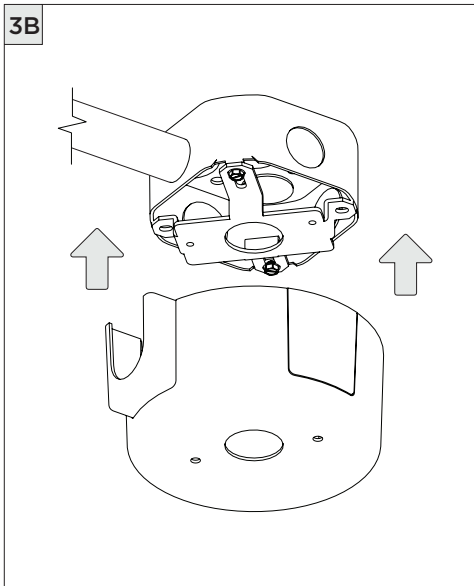
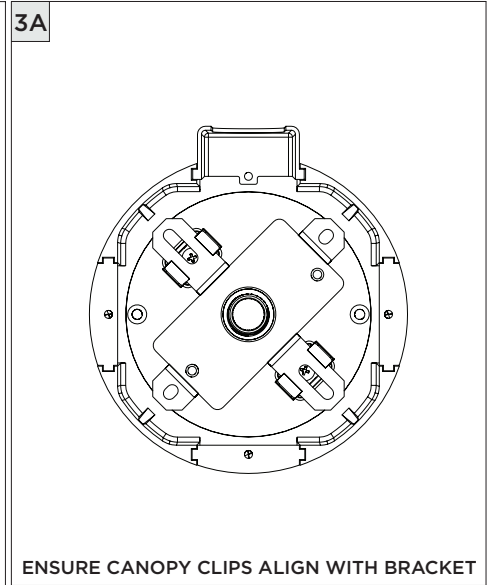
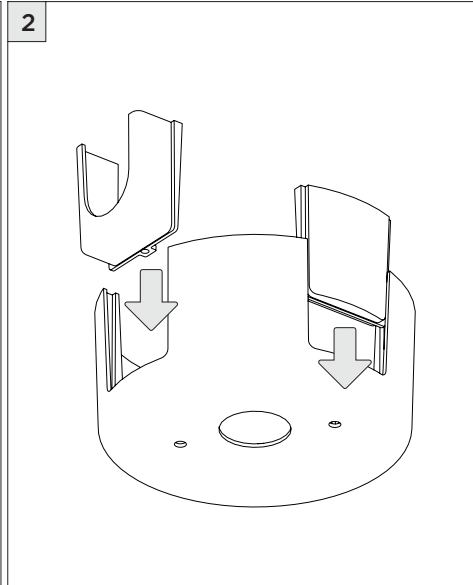
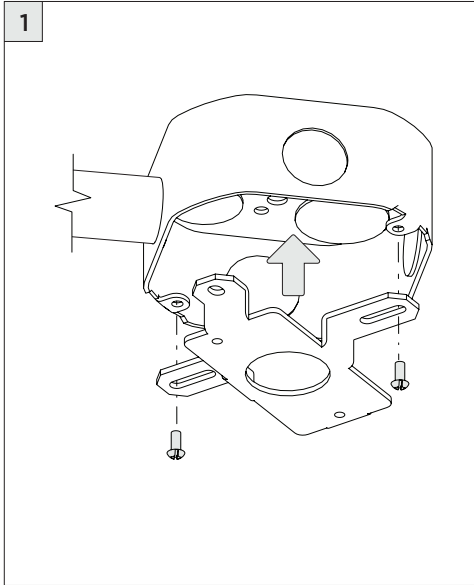

6

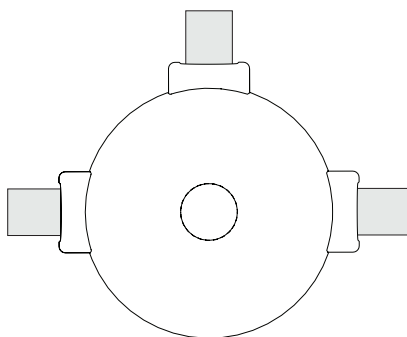
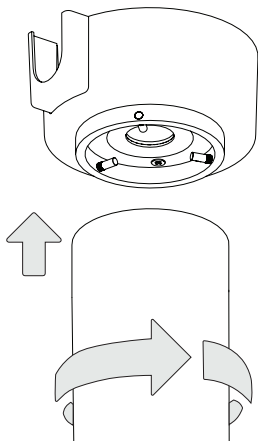

CANOPY IS SUITABLE FOR
MAXIMUM 3 CONDUIT FEEDS

DRIVER SERVICING

1

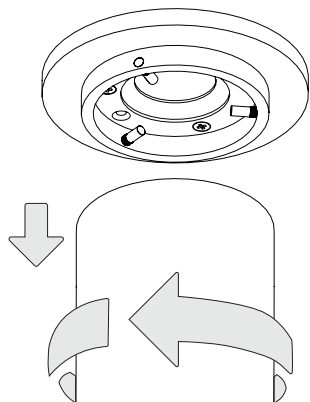

2

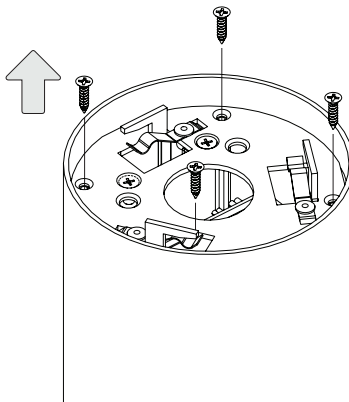

3

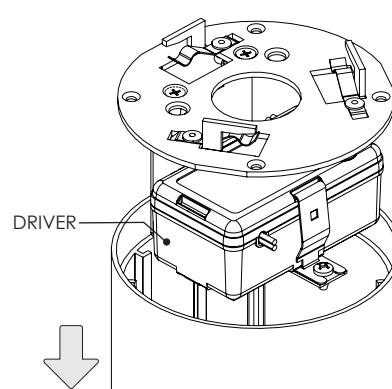

LED SERVICING

1

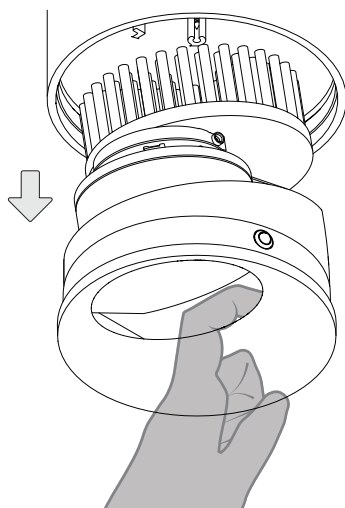

DISCONNECT LED WIRES AND REMOVE LED INSERT

2

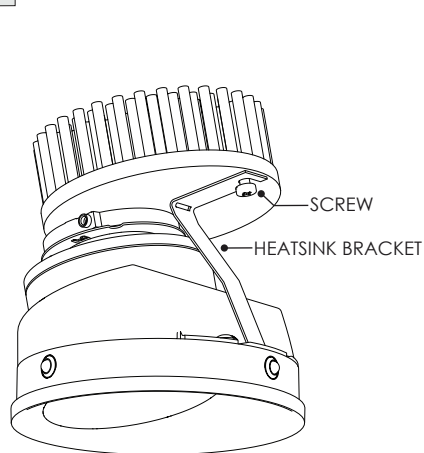

LOOSEN HEATSINK BRACKET SCREW

3

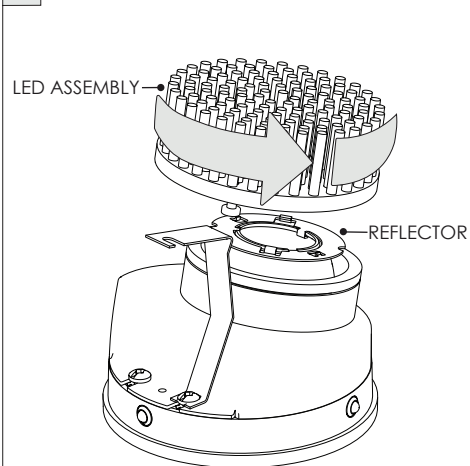

TWIST AND REMOVE LED ASSEMBLY
FROM REFLECTOR

DRIVER SERVICING

1

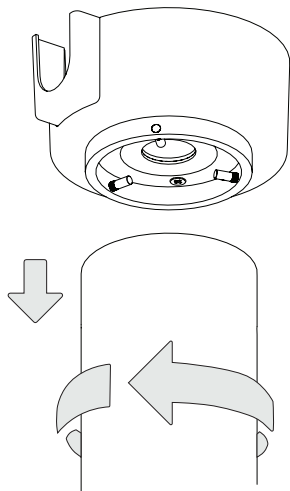

2

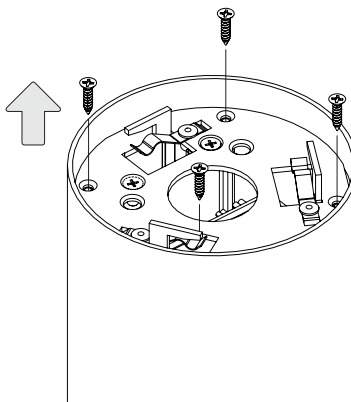

3

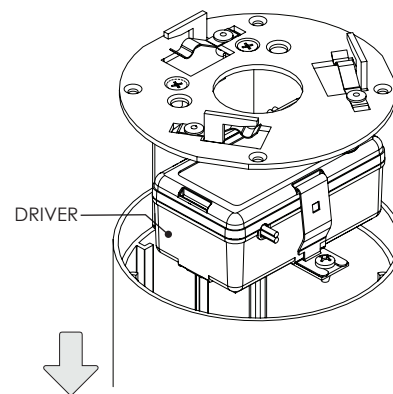

LED SERVICING

1

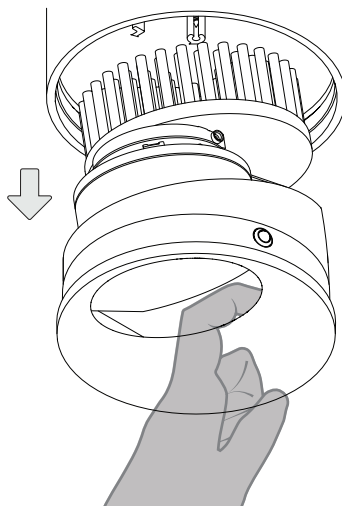

DISCONNECT LED WIRES AND REMOVE LED INSERT

2

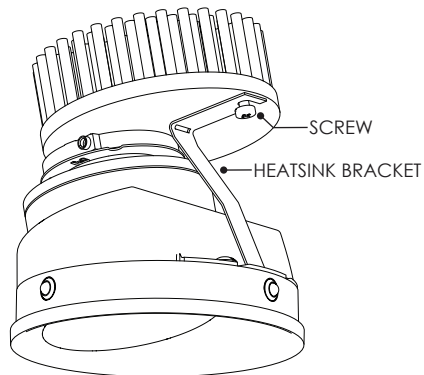

LOOSEN HEATSINK BRACKET SCREW

3

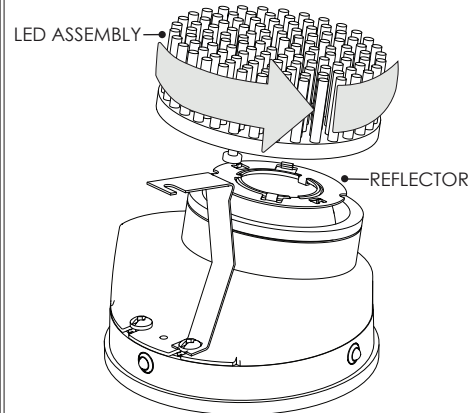

TWIST AND REMOVE LED ASSEMBLY
FROM REFLECTOR