

THE IMAGES SHOWN ARE FOR ILLUSTRATION PURPOSES ONLY AND MAY NOT BE AN EXACT REPRESENTATION OF THE PRODUCT

INCLUDED COMPONENTS

NCF - NEW CONSTRUCTION FRAME (FOR NEW CONSTRUCTION ONLY)

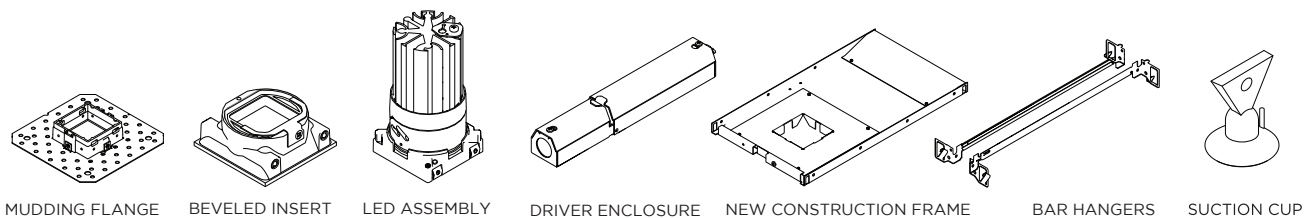

NC - NEW CONSTRUCTION HOUSING (FOR NEW CONSTRUCTION ONLY)

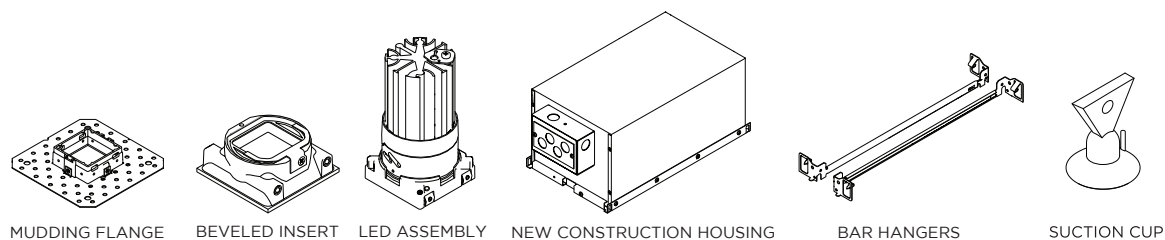

RMD - REMODEL

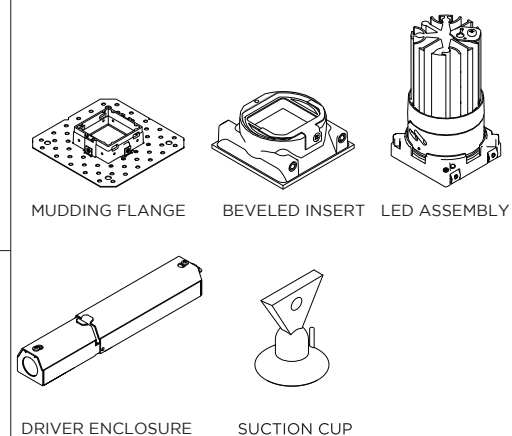

INSTRUCTION KEY	INFORMATION
⚠ ADDITIONAL	INSTALLATION SHOULD ONLY BE PERFORMED BY A CERTIFIED ELECTRICIAN
ⓘ ATTENTION	REFER TO LOCAL/NATIONAL CODES FOR PROPER INSTALLATION
⚡ POWER ON	FAILURE TO FOLLOW INSTALLATION INSTRUCTION MAY VOID THE WARRANTY
🔌 POWER OFF	DO NOT TOUCH LEDS. LEDS MUST BE PROTECTED FROM MECHANICAL STRESS OR DEBRIS
	TURN OFF POWER DURING INSTALLATION OR SERVICING

RMD - REMODEL

1

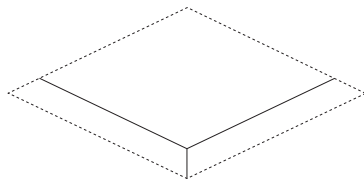

FIXTURE TYPE	CEILING HOLE SIZE
DL20RF	2.625" x 2.625"

2

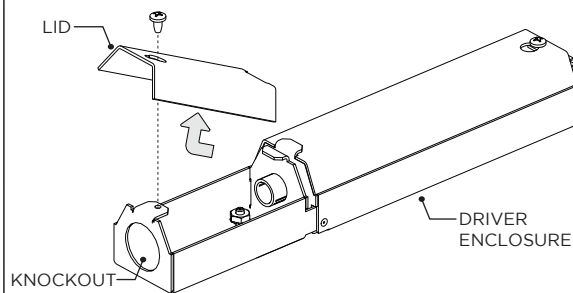

REMOVE LID AND KNOCKOUT FROM DRIVER ENCLOSURE

3

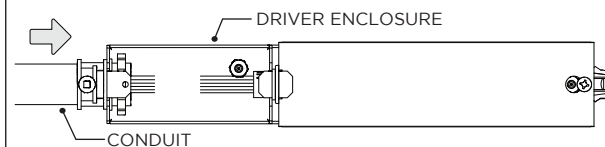

WIRING LEGEND

BLACK	HOT/LINE
WHITE	NEUTRAL
GREEN	GROUND
ORANGE	(DIM-)
PURPLE	(DIM+)

CONNECT CONDUIT TO DRIVER ENCLOSURE AND MAKE WIRING CONNECTIONS

4

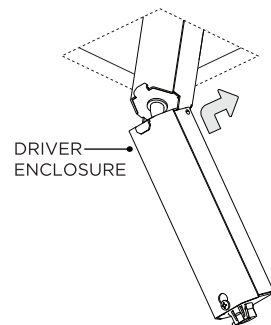

SECURE LID ONTO DRIVER ENCLOSURE AND INSERT INTO CEILING

5

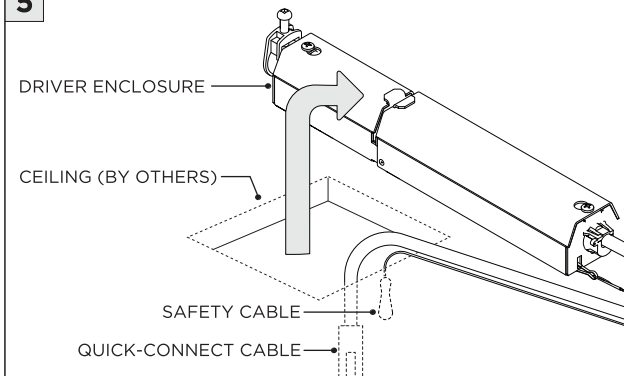

PLACE DRIVER ENCLOSURE ABOVE CEILING

6A

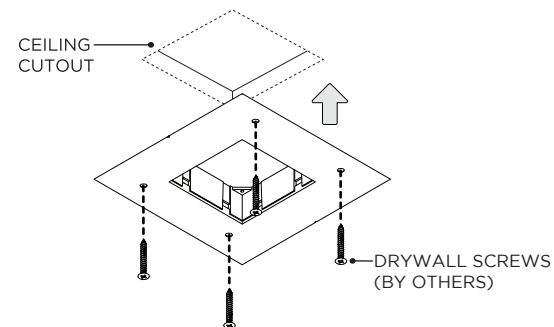

SECURE MUDDING FLANGE TO CEILING

6B

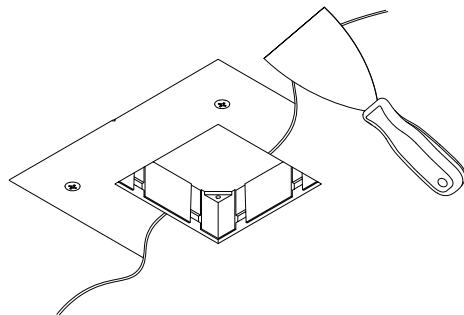

APPLY MUDDING COMPOUND (BY OTHERS) TO CEILING

7A

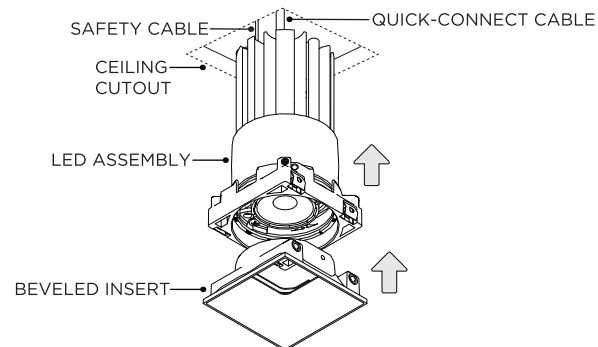

7B

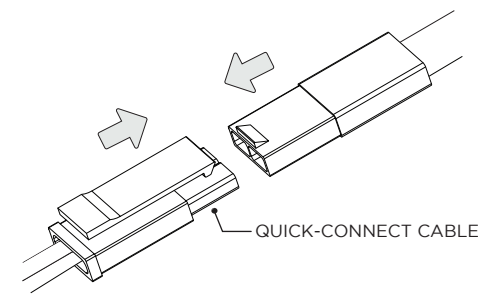

CONNECT SAFETY CABLE & QUICK-CONNECT CABLE TO LED ASSEMBLY

NCF - NEW CONSTRUCTION FRAME (FOR NEW CONSTRUCTION ONLY)

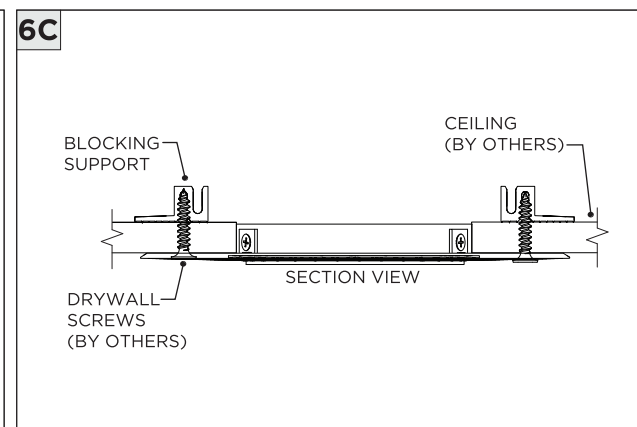
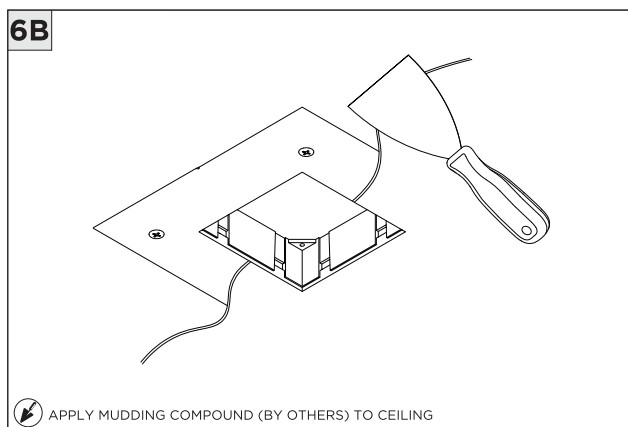
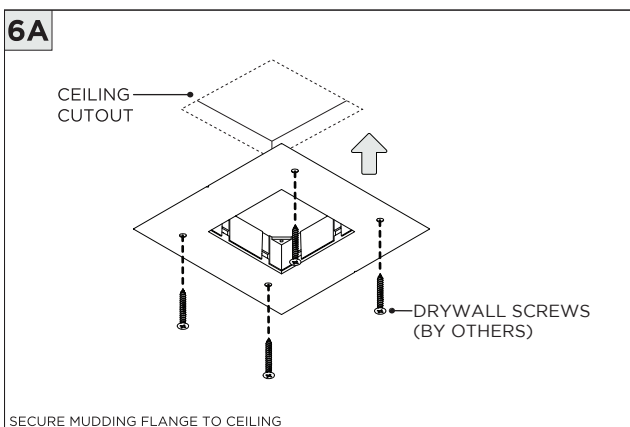
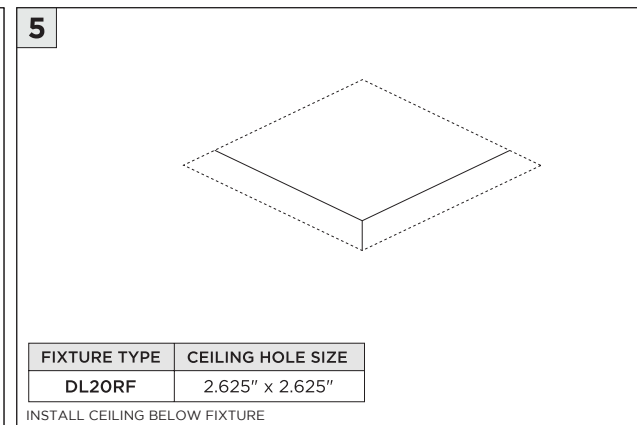
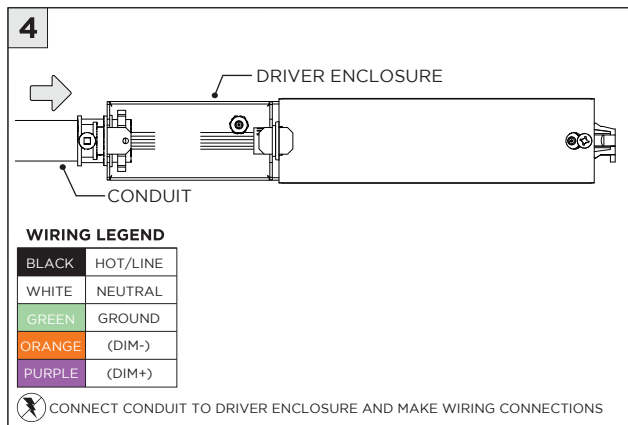
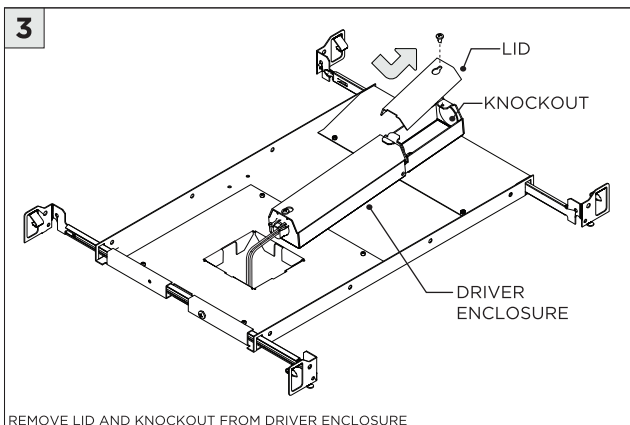
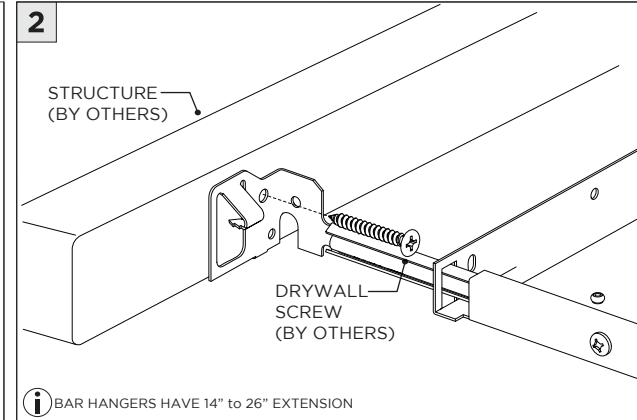
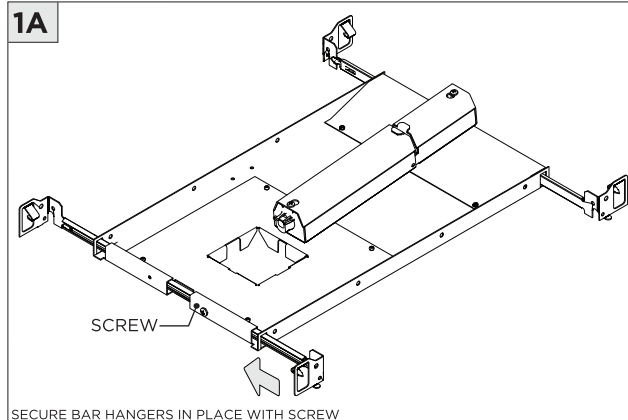
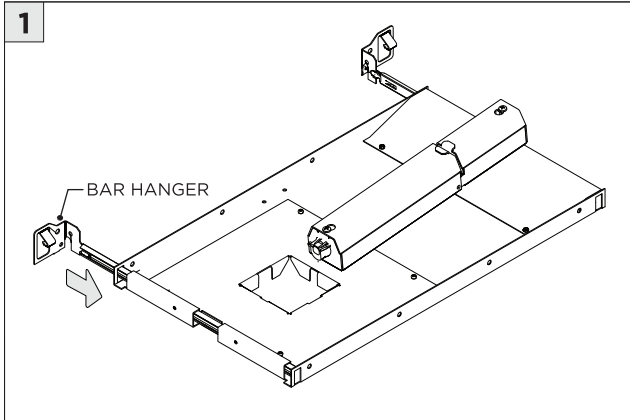

NCF - NEW CONSTRUCTION FRAME (FOR NEW CONSTRUCTION ONLY)

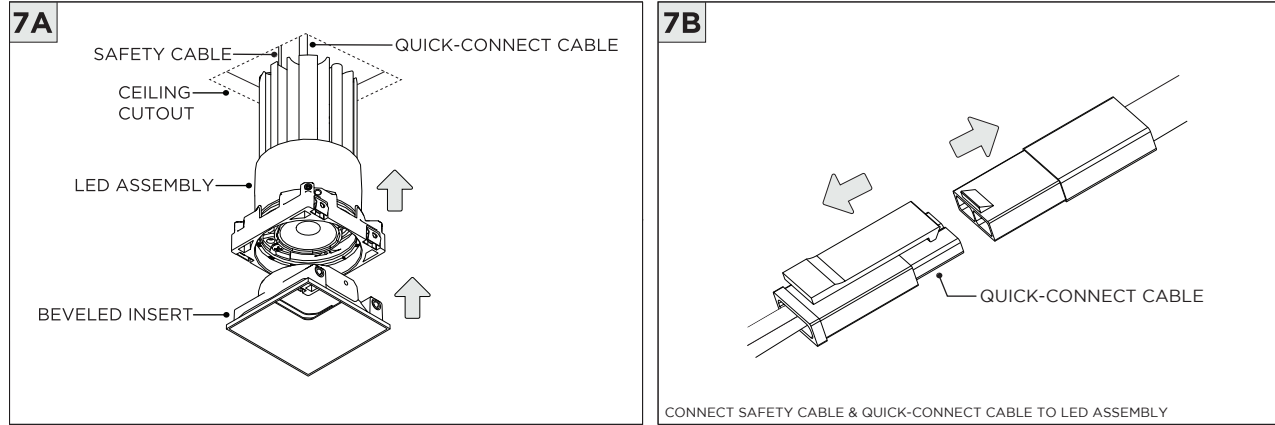

NC/IC - NEW CONSTRUCTION HOUSING (FOR NEW CONSTRUCTION ONLY)

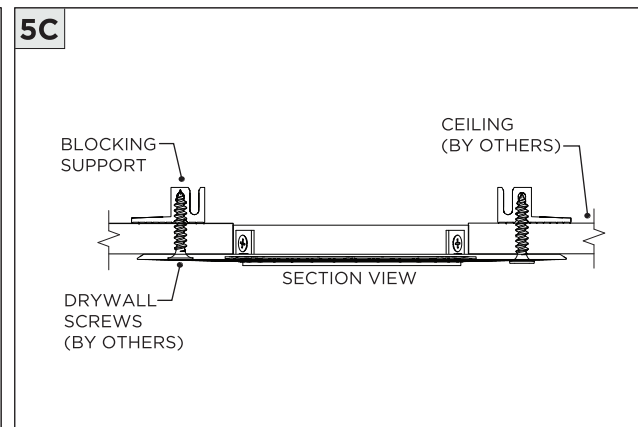
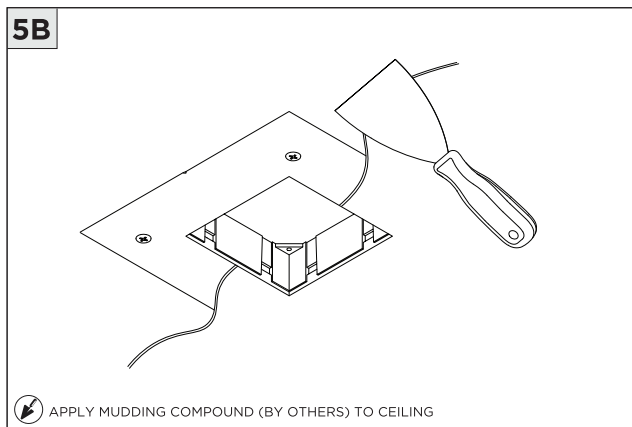
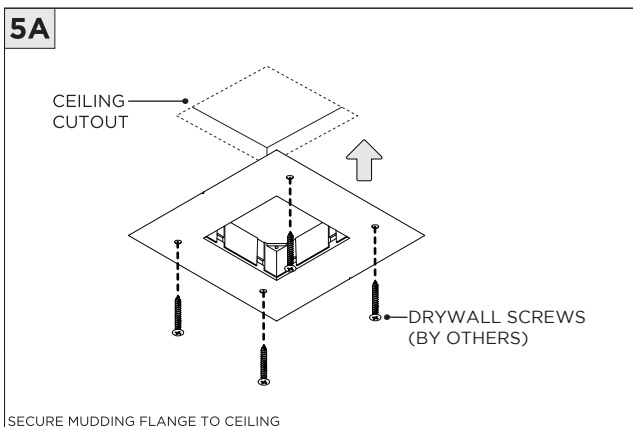
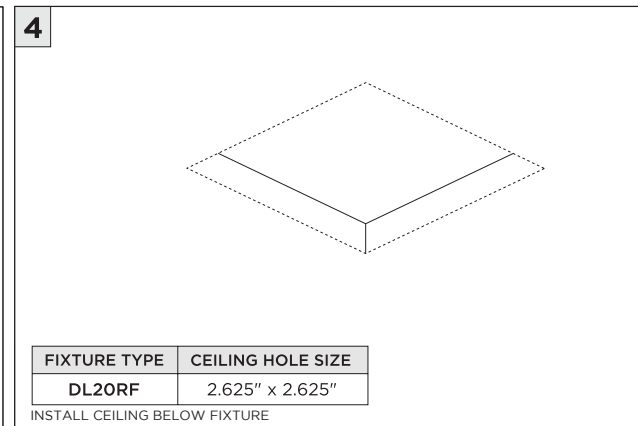
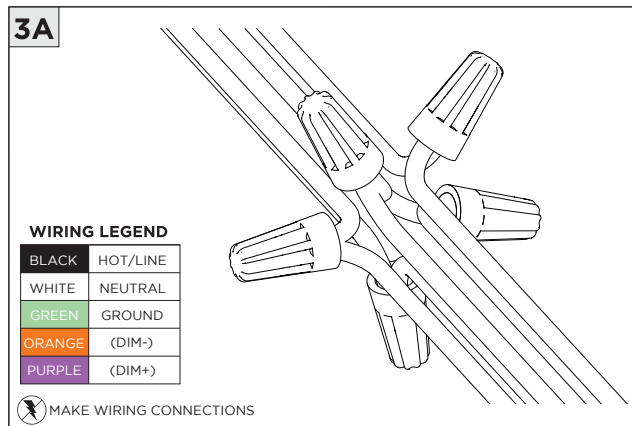
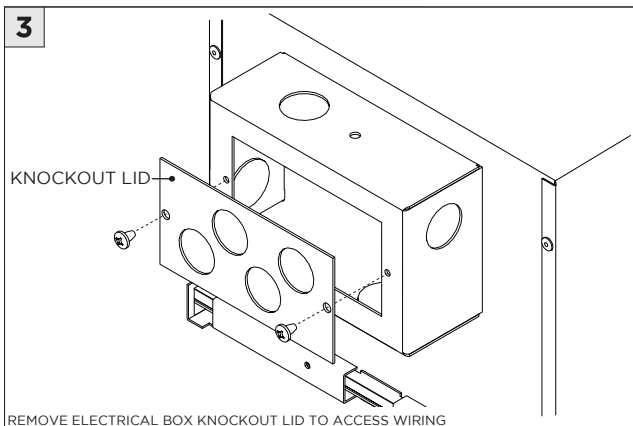
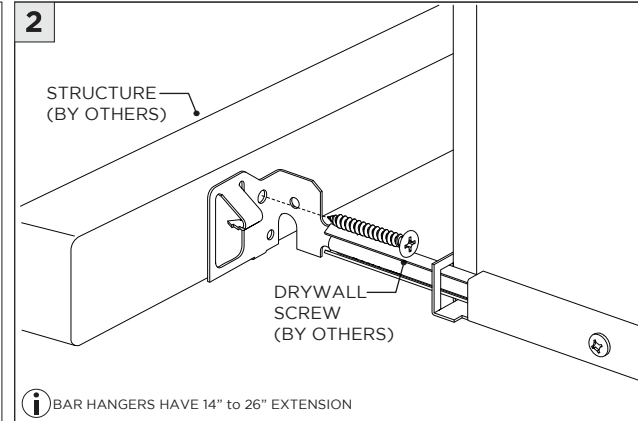
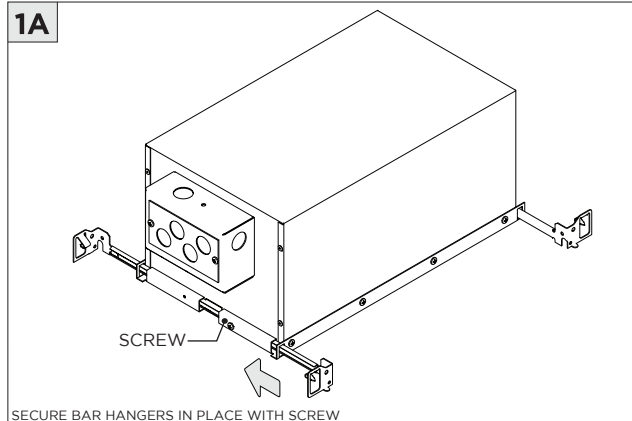
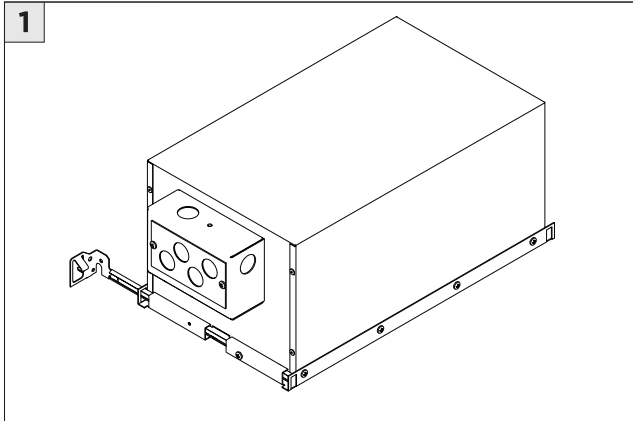

NC/IC - NEW CONSTRUCTION HOUSING (FOR NEW CONSTRUCTION ONLY)

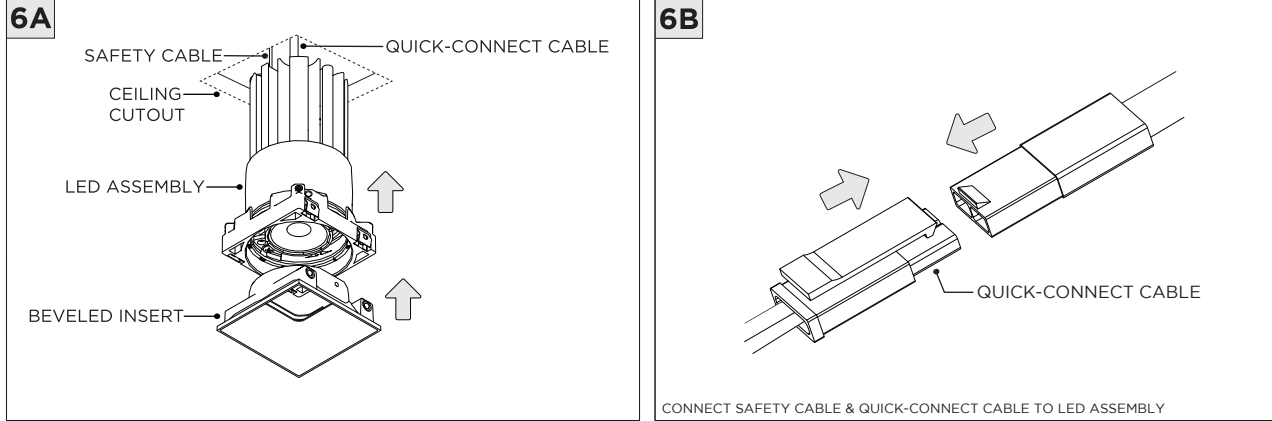

LED ADJUSTMENT

1

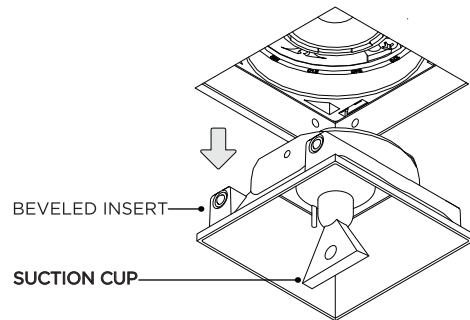

REMOVE BEVELED INSERT FROM CEILING WITH PROVIDED SUCTION CUP

2

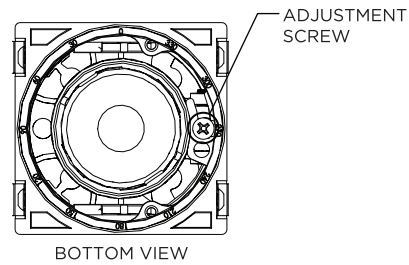

ROTATE SCREW TO ADJUST LED ANGLE

2A

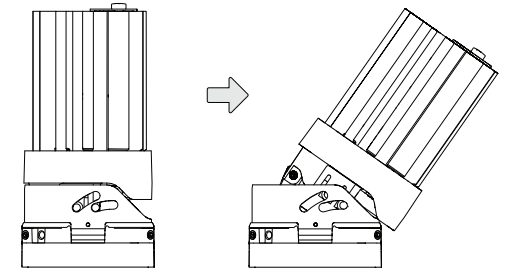

LED SERVICING

1

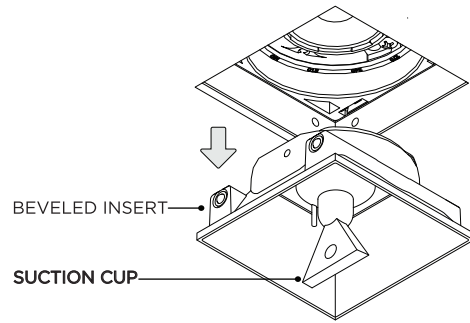

REMOVE BEVELED INSERT FROM CEILING WITH PROVIDED SUCTION CUP

2

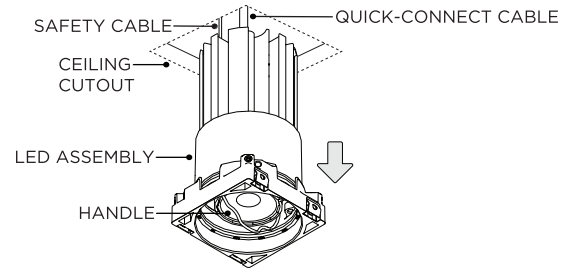

REMOVE LED ASSEMBLY FROM CEILING BY PULLING ON HANDLE

2A

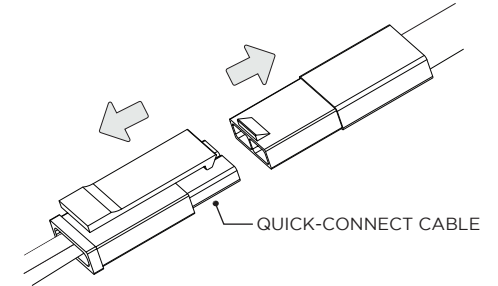

DISCONNECT SAFETY CABLE & QUICK-CONNECT CABLE FROM LED ASSEMBLY

3

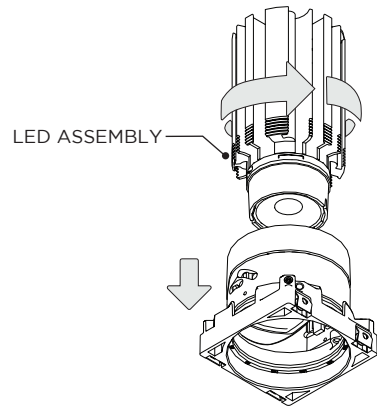

4

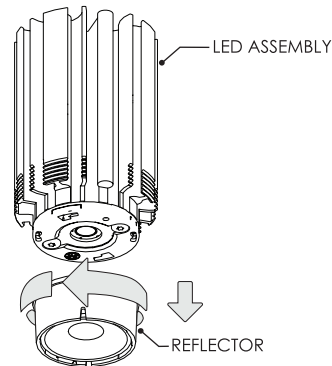

REMOVE REFLECTOR AND REPLACE LED ASSEMBLY

DRIVER SERVICING

1 RMD - REMODEL

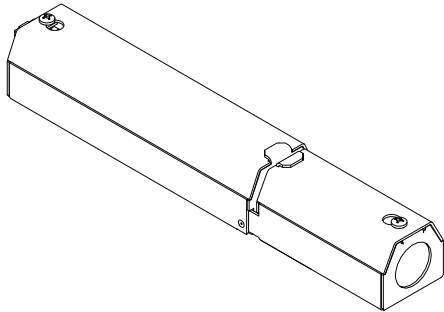

⚡ DISCONNECT POWER BEFORE SERVICING

2

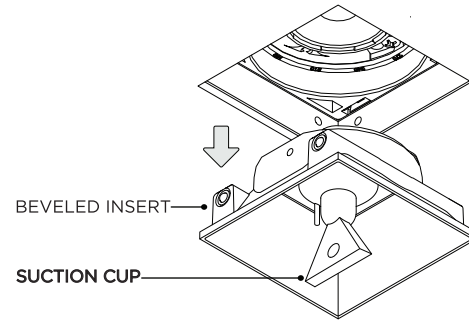

REMOVE BEVELED INSERT FROM CEILING WITH PROVIDED SUCTION CUP

3

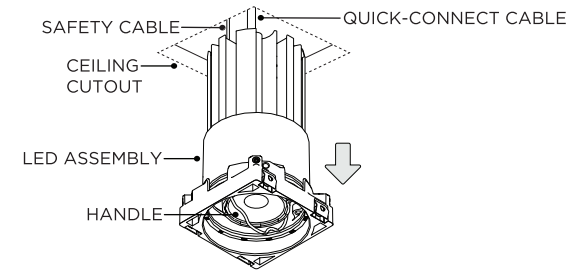

REMOVE LED ASSEMBLY FROM CEILING BY PULLING ON HANDLE

3A

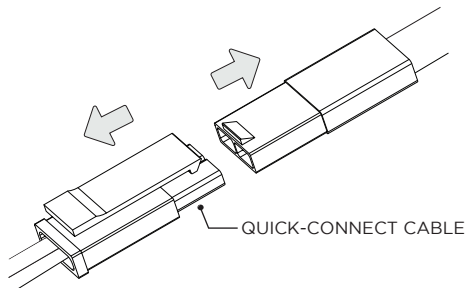

DISCONNECT SAFETY CABLE & QUICK-CONNECT CABLE FROM LED ASSEMBLY

4

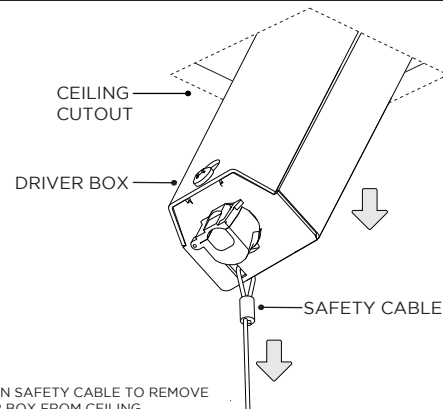

PULL ON SAFETY CABLE TO REMOVE DRIVER BOX FROM CEILING

5

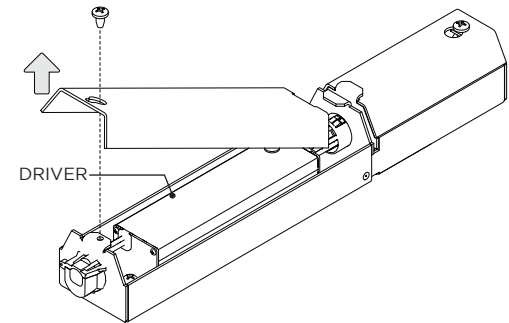

DRIVER SERVICING

1 NCF - NEW CONSTRUCTION FRAME

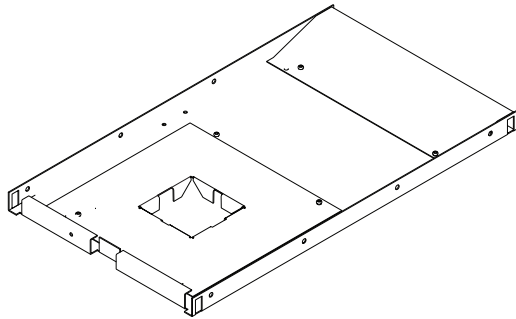

⚡ DISCONNECT POWER BEFORE SERVICING

2

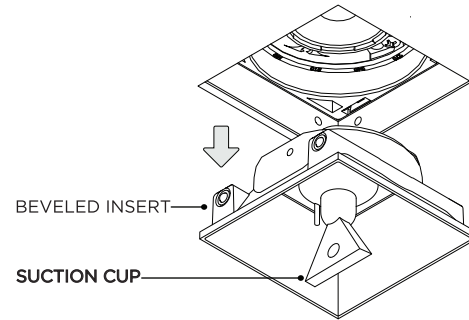

REMOVE BEVELED INSERT FROM CEILING WITH PROVIDED SUCTION CUP

3

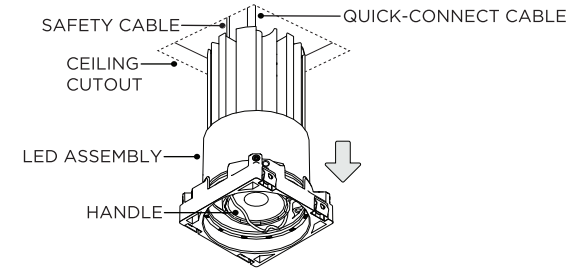

REMOVE LED ASSEMBLY FROM CEILING BY PULLING ON HANDLE

3A

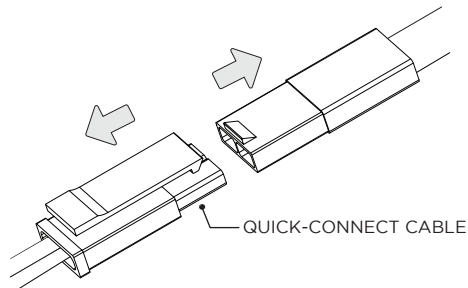

DISCONNECT SAFETY CABLE & QUICK-CONNECT CABLE FROM LED ASSEMBLY

4

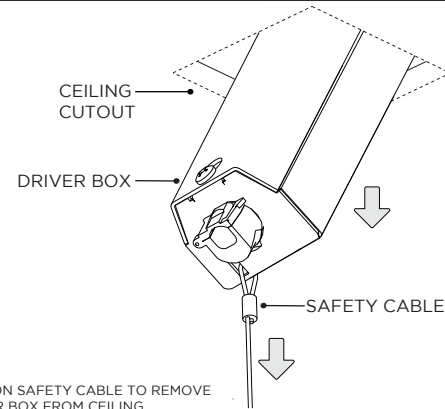

PULL ON SAFETY CABLE TO REMOVE DRIVER BOX FROM CEILING

5

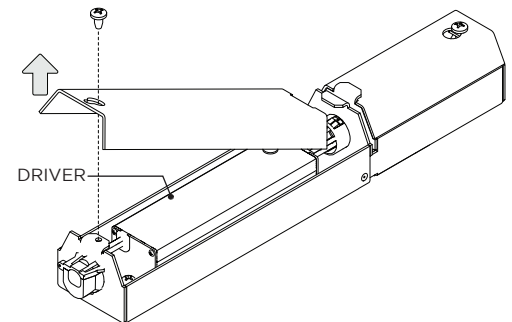

DRIVER SERVICING

1 NC - NEW CONSTRUCTION HOUSING

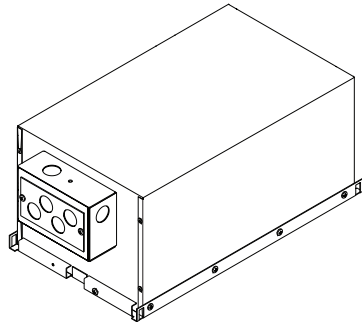

DISCONNECT POWER BEFORE SERVICING

2

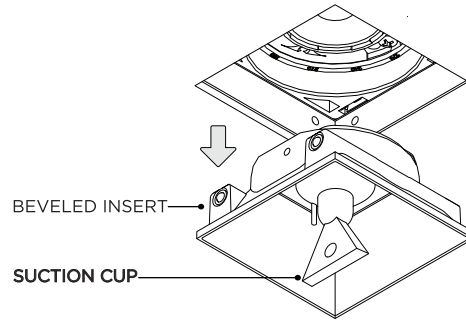

REMOVE BEVELED INSERT FROM CEILING WITH PROVIDED SUCTION CUP

3

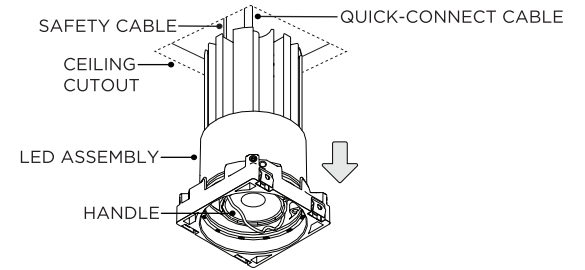

REMOVE LED ASSEMBLY FROM CEILING BY PULLING ON HANDLE

3A

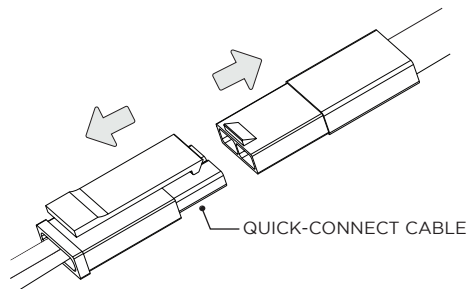

DISCONNECT SAFETY CABLE & QUICK-CONNECT CABLE FROM LED ASSEMBLY

4

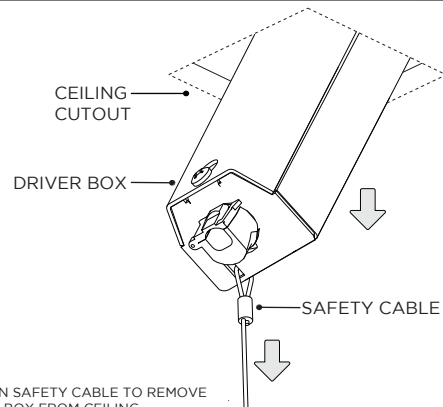

PULL ON SAFETY CABLE TO REMOVE DRIVER BOX FROM CEILING

4A

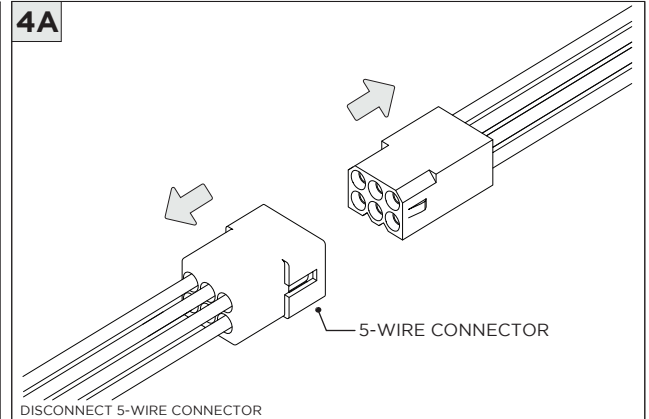

DISCONNECT 5-WIRE CONNECTOR

5

