

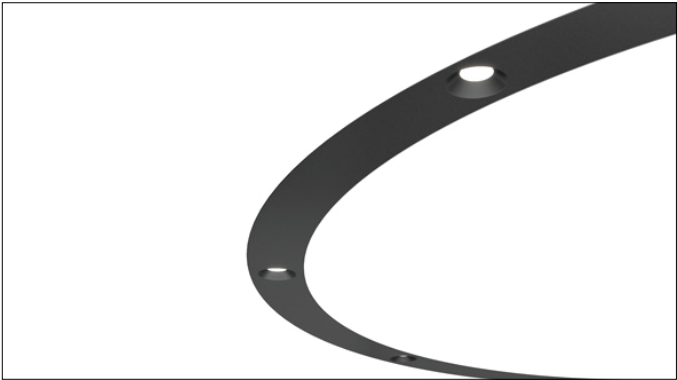

3G-58RMSL, 3G-48RMSL
5.8", 4.8" CURVED RECESSED SLOT
TRIMLESS



⚠ FOR **NEW CONSTRUCTION** INSTALLATION ONLY

ℹ THE IMAGES SHOWN ARE FOR ILLUSTRATION PURPOSES ONLY AND MAY NOT BE AN EXACT REPRESENTATION OF THE PRODUCT

FIXTURE TYPES		INCLUDED COMPONENTS
<div>58RSL PROFILE</div> <div>48RSL PROFILE</div>		<div>STARTER</div> <div>JOINER</div> <div>ENDER</div>

INSTRUCTION KEY	INFORMATION
⚠	ADDITIONAL
ℹ	ATTENTION
⚡	POWER ON
⏻	POWER OFF
INSTALLATION SHOULD ONLY BE PERFORMED BY A CERTIFIED ELECTRICIAN REFER TO LOCAL/NATIONAL CODES FOR PROPER INSTALLATION FAILURE TO FOLLOW INSTALLATION INSTRUCTION MAY VOID THE WARRANTY DO NOT TOUCH LEDS. LEDS MUST BE PROTECTED FROM MECHANICAL STRESS OR DEBRIS TURN OFF POWER DURING INSTALLATION OR SERVICING	

OVERVIEW

TRIMLESS - XTR

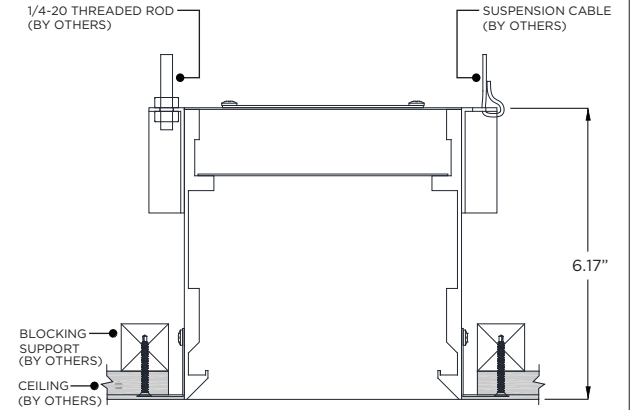
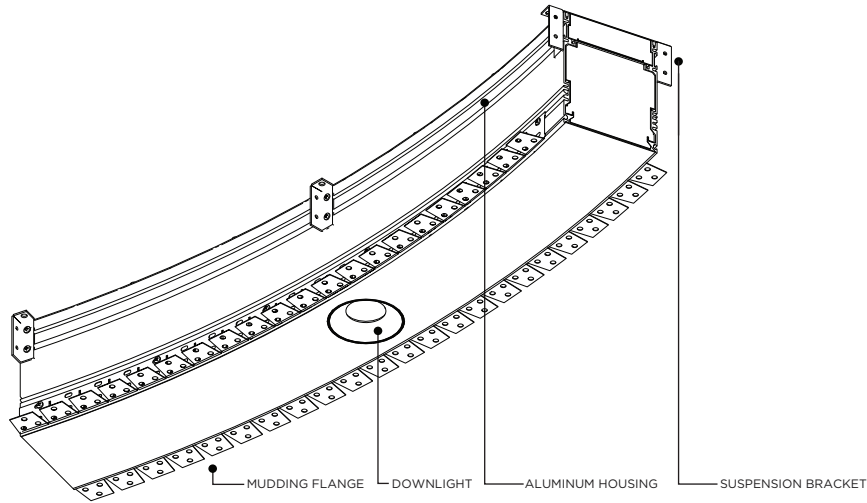

TRIMLESS - XTR - CEILING CUT-OUT DIMENSIONS

FIXTURE TYPE	WIDTH	LENGTH
3Gi-48RSL	4.95"	LENGTH + 0.40"
3Gi-58RSL	5.95"	LENGTH + 0.40"

THREADED ROD LOCATION

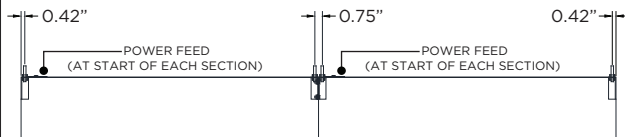

IDENTIFICATION AND PREPARATION

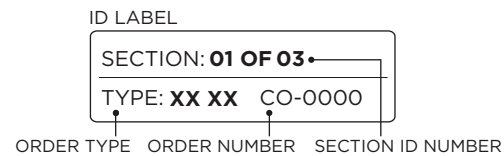

i IDENTIFY FIXTURE SECTIONS BY THE ID LABELS FOUND ON THE BOX INSIDE THE SECTIONS

ID LABEL

SECTION: **01 OF 03**
TYPE: **XX XX** CO-0000



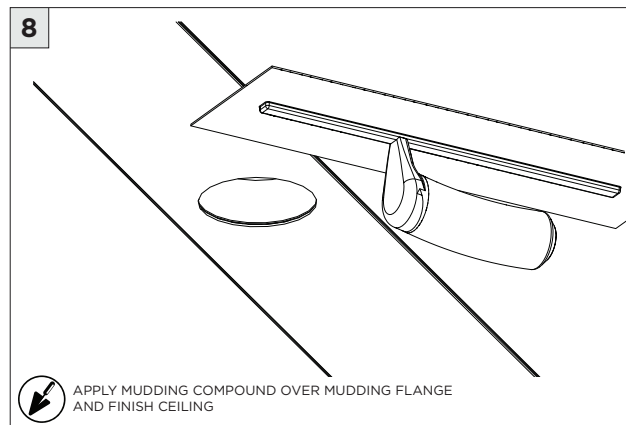
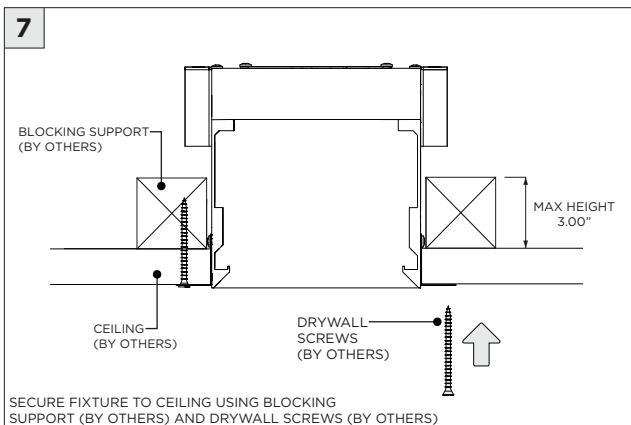
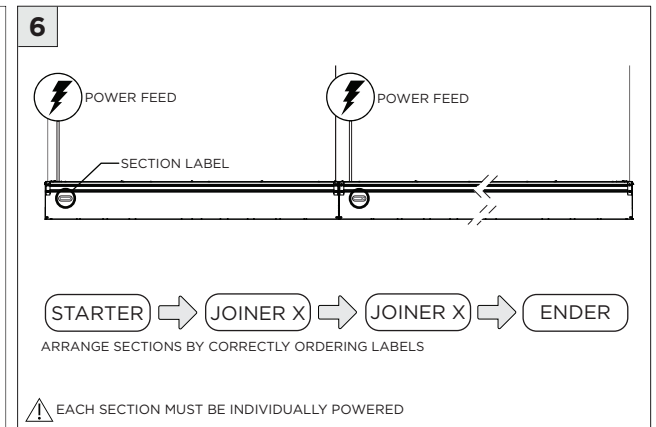
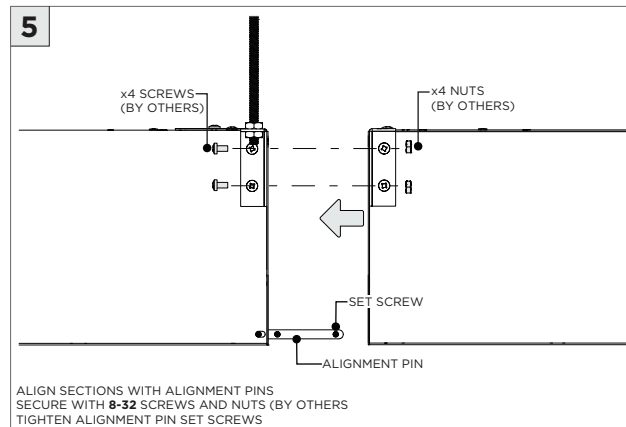
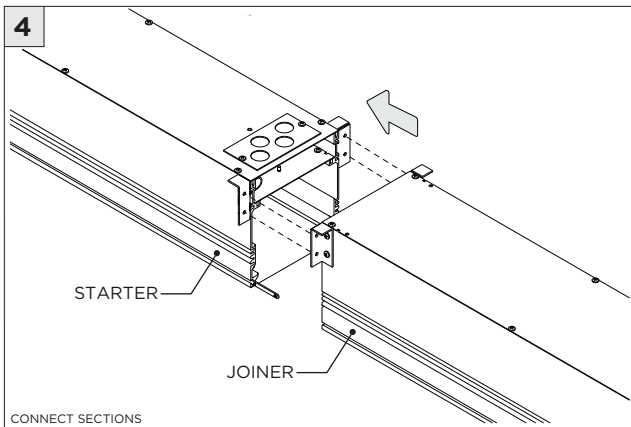
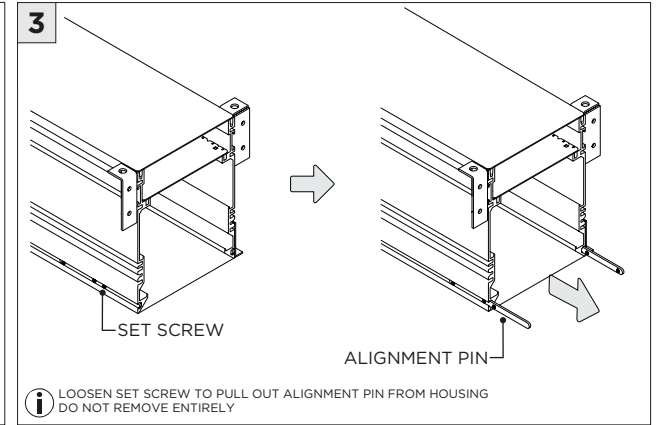
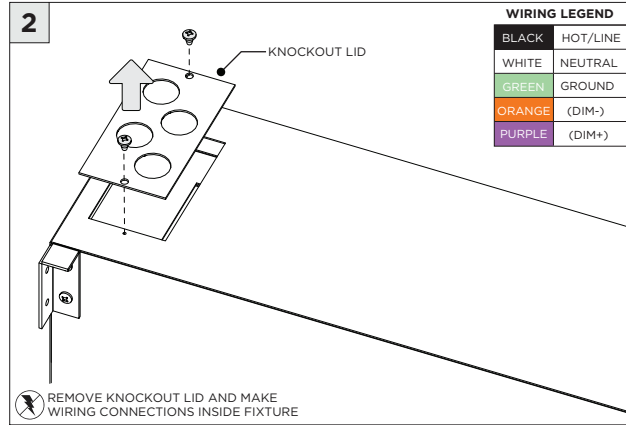
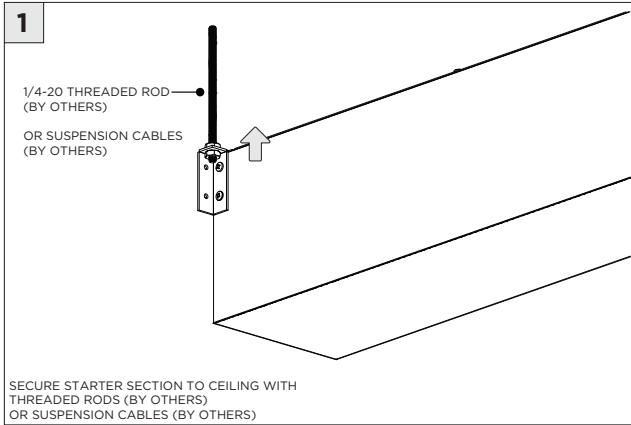

LED ADJUSTMENT

1

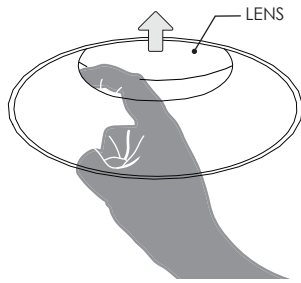

LIFT LENS AND DETATCH INSERT FROM CEILING AS SHOWN

1A

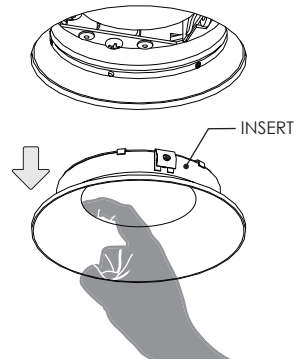

2

ANGLE ADJUSTMENT

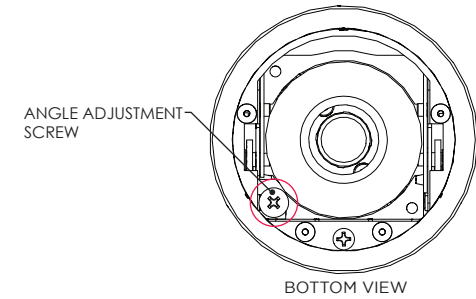

TURN SCREW TO ADJUST LED ANGLE

2A

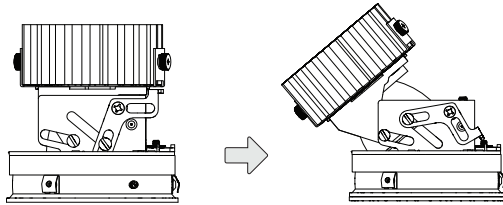

3

ROTATION ADJUSTMENT

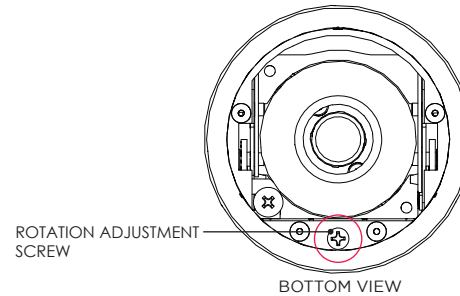

LOOSEN SCREW TO UNLOCK LED ASSEMBLY ROTATION

3A

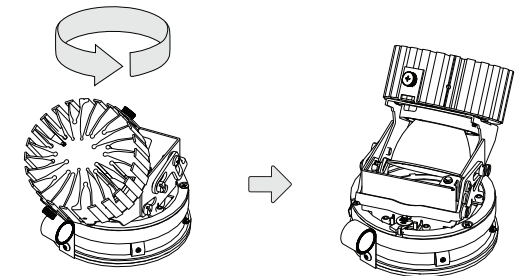

TIGHTEN SCREW AFTER ROTATING LED ASSEMBLY

LED SERVICING - DL33R

1

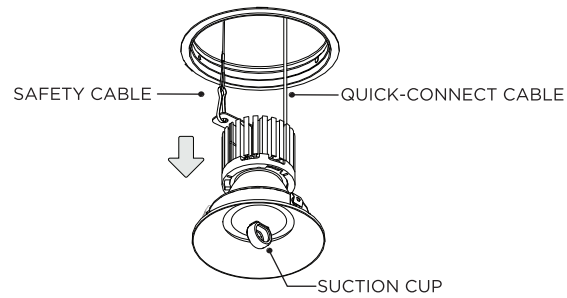

REMOVE LED ASSEMBLY FROM CEILING

2

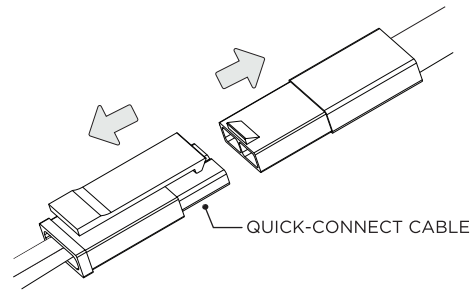

DISCONNECT SAFETY CABLE & QUICK-CONNECT CABLE FROM LED ASSEMBLY

3

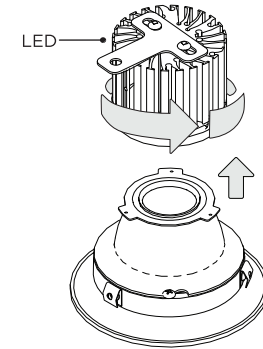

LED SERVICING - DL33RA

1

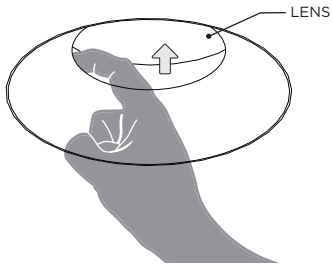

LIFT LENS AND DETATCH INSERT FROM LED ASSEMBLY

2

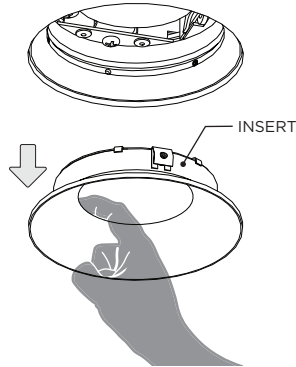

3

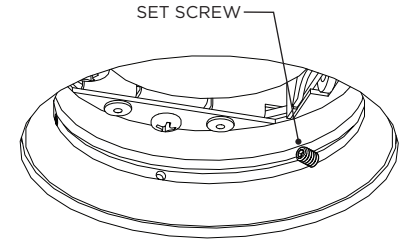

LOOSEN THREE SET SCREWS INSIDE ADAPTER RING

⚠ DO NOT FULLY REMOVE SET SCREWS FROM ADAPTER RING

4

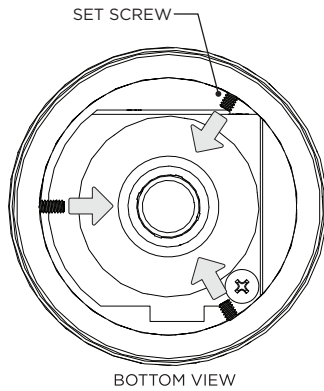

BOTTOM VIEW

5

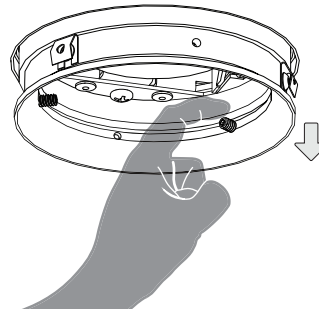

UNCLIP ADAPTER RING FROM CEILING BY PULLING DOWN ON EACH SET SCREW

6

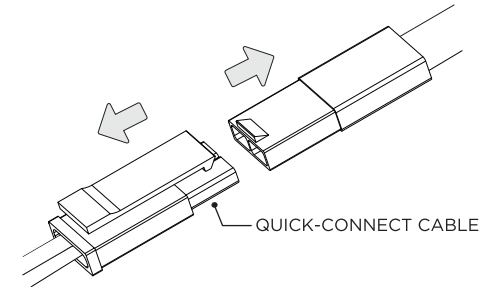

DISCONNECT QUICK-CONNECT CABLE FROM LED ASSEMBLY

7

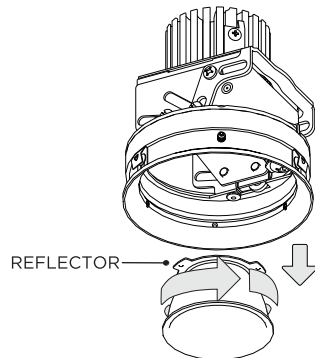

TWIST REFLECTOR TO REMOVE

8

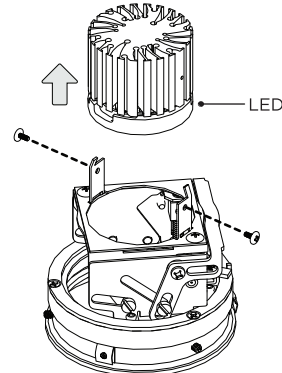

DRIVER SERVICING

