



3G-RMZ1

1 LIGHT MINI ZOIE
TRIM & TRIMLESS

1.14" aperture high performance mini downlight
Features matte black or matte white multi-faceted louvers
Regressed LED source with enhanced glare control, UGR <16
Shallow housing standard along with remodel housing option
Remote driver options with standard 1% dimming range



ORDERING INFORMATION

PROJECT:

TYPE:

CATALOG #:

DATE:

CAT. NO	LUMEN OUTPUT	CRI	COLOR TEMP	BEAM ANGLE	VOLTAGE
3G-RMZ1	02 - 200 LUMENS <				

¹ DALI-2 (Type 6) provided as standard. Please consult factory for DALI (Type 8) options

DECEMBER 11, 2023

PERFORMANCE CHART BASED ON 33° 90+CRI AND 3500K SOURCE

LUMEN OUTPUT	COLOR TEMP	TOTAL DELIVERED LUMENS	SYSTEM WATTS	EFFICACY (LPW)
200 LUMENS	27K	177	2.4	74
	30K	185	2.4	77
	35K	197	2.4	82

PHOTOMETRY BASED ON 90+CRI AND 3500K SOURCE

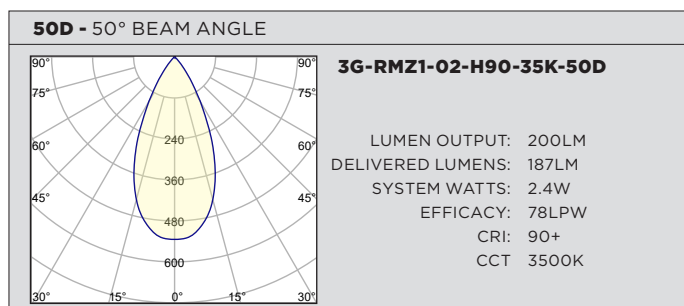
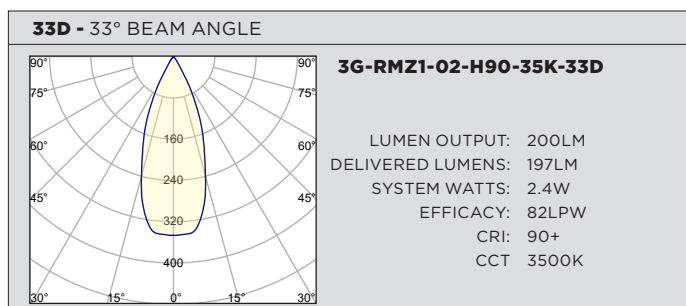

REMOTE POWER SUPPLY OPTIONS

3G DRIVER CODE	DIMMING METHOD	DIMMING RANGE	VOLTAGE	MAX. DISTANCE	3G-RMZ1 (2.4W)	3G-RMZ2 (4.8W)	3G-RMZ4 (9.6W)	3G-RMZ8 (19.2W)	3G-RMZ12 (28.5W)
RDIM	0-10V	100-1%	120-277V	100ft (12 AWG)	4 to 16	2 to 8	1 to 4	1 to 2	1
RD347	0-10V	100-1%	347V	100ft (12 AWG)	3 to 16	2 to 8	1 to 4	1 to 2	1
RDHLP	LUTRON HI-LUME PREMIER ECOSYSTEM	100-0.1%	120-277V	100ft (12 AWG)	5 to 16	3 to 8	2 to 4	1 to 2	1
RDALI	DALI ELDOLED	100-1%	120-277V	100ft (12 AWG)	1 to 16	1 to 8	1 to 4	1 to 2	1
RD01	0-10V ELDOLED	100-0.1%	120-277V	100ft (12 AWG)	1 to 16	1 to 8	1 to 4	1 to 2	1

REMOTE POWER SUPPLY ENCLOSURE

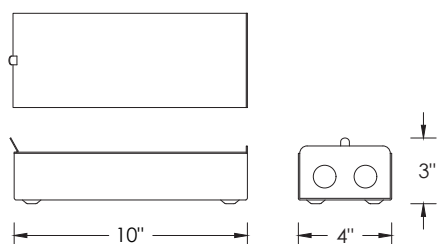

WIRING DIAGRAM

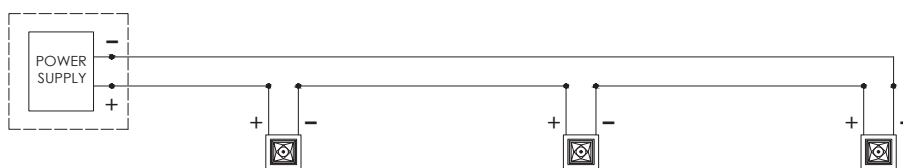

Multiple Zoie fixtures must be connected in series

TECHNICAL**HOUSING**

- IC rated shallow housing and Chicago Plenum housing options available
- Remodel housing available with remote drivers
- Maximum ceiling thickness of 1". Consult factory for modifications
- Housings are rated for #12 AWG, (4 in, 4 out), 90°C conductors and through branch wiring

FACETED LOUVER

- 1.14" aperture with regressed LED source for enhanced glare control
- Matte black or matte white faceted louver finish

TRIM

- Cast aluminum trim flange with powder coated finish and minimal 0.300" overlap

TRIMLESS

- Mudding flange features a perforated surface for easy mud-in application

OPTICS

- Proprietary polycarbonate multi-faceted reflectors
- Available in 33°, and 50°. UGR <16

ELECTRICAL

- Remote 0-10V, driver option (100-1% dimming standard with 100-0.1% option)
- Remote Lutron EcoSystem and eldoLED DALI options (100-1% dimming)

LED SYSTEM

- Osram LED source
- Color consistency <2 SDCM
- Standard 90+CRI
- Available in 27K, 30K, and 35K
- L90 >60,000 hours
- 5 Year Warranty

MOUNTING

- Trim fixture designed for use in drywall, wood, acoustic ceiling tiles, and other ceiling materials
- Trimless fixture designed for use in drywall, mud-in ceiling applications
- Recommended ceiling cut-out for remodel fixture: 1.500" x 1.500"
- Adjustable bar hangers extend from 14" to 26"

LISTING

- ETL listed and conforms to UL1598 standard. Certified to CSA22.2 No.250.0. Rated for indoor locations

WARRANTY

- 5 Year Warranty on LED and drivers
- Manufacturer 1 Year Warranty for defects in material and workmanship under normal use
- Ambient temperature at fixture should not exceed 25°C

TRIM HOUSING OPTIONS (WITH REMOTE DRIVER)

RMDRM - Remodel Fixture (Non-IC) and Remote Driver option

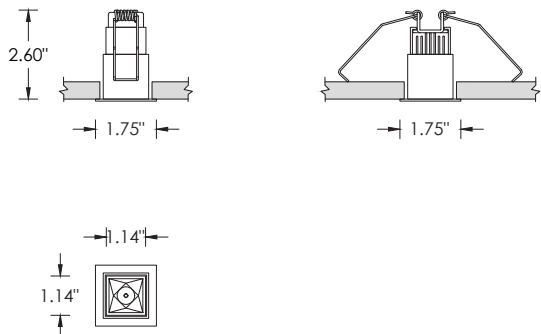

Recommended ceiling cut-out: 1.500" x 1.500"

SHRM - Shallow Housing & Remote Driver option (IC rated and Chicago Plenum rated)

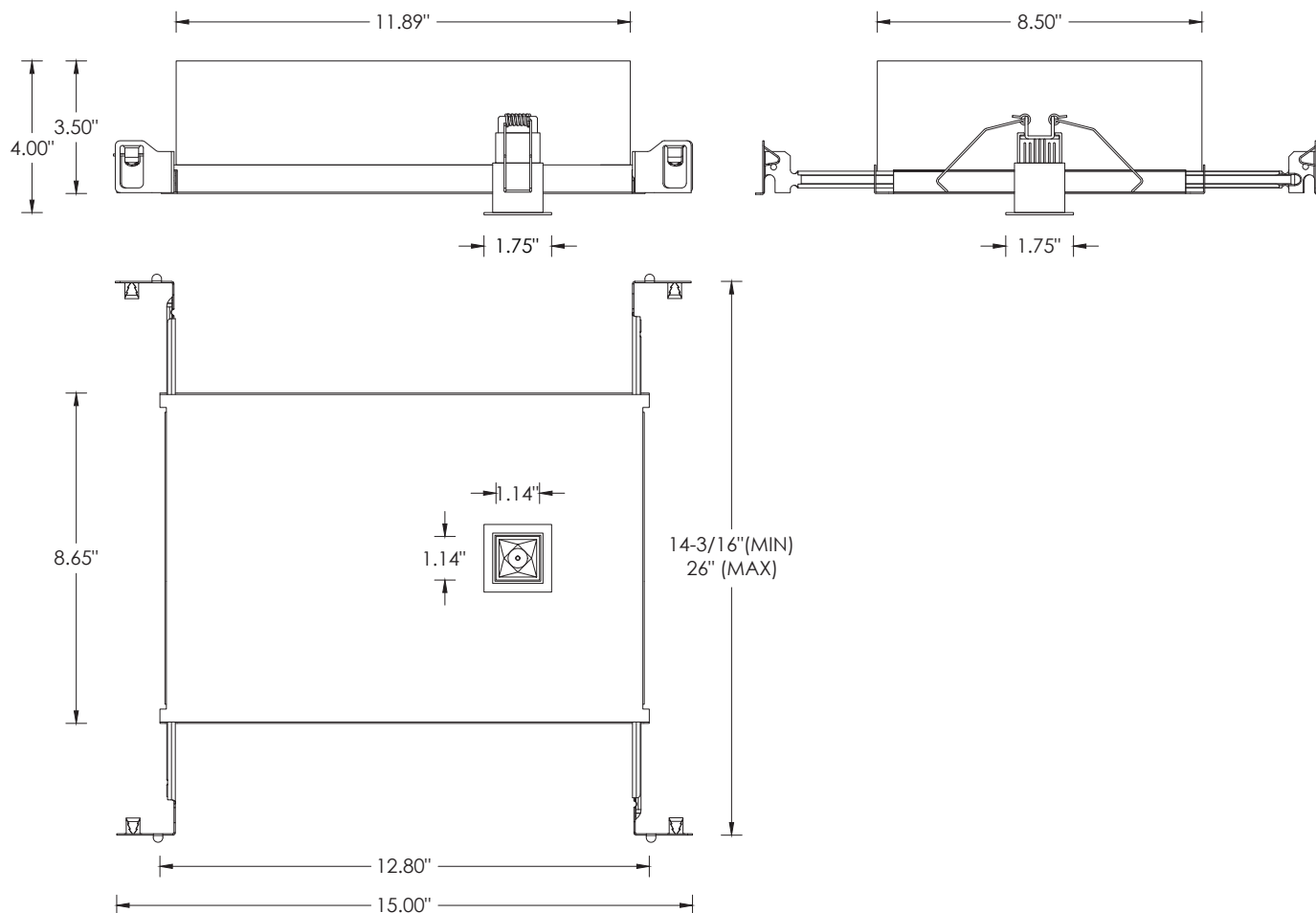

TRIMLESS HOUSING OPTIONS (WITH REMOTE DRIVER)

RMDRM - Remodel Fixture (Non-IC) and Remote Driver option

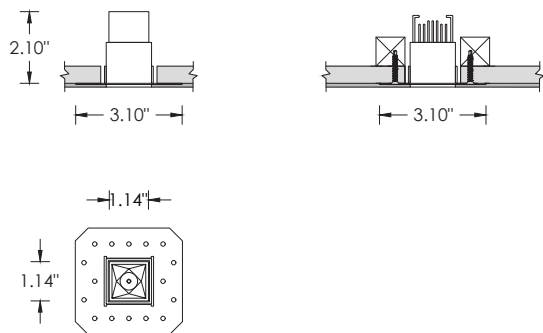

Recommended ceiling cut-out: 1.500" x 1.500"

SHRM - Shallow Housing & Remote Driver option (IC rated and Chicago Plenum rated)

