



## 3G-RMZ4

4 LIGHT RECESSED ZONE

4 Light high performance mini downlight with 1.14" apertures  
Features matte black or matte white multi-faceted louvers  
Regressed LED source with enhanced glare control, UGR <16  
Shallow housing standard along with remodel housing option  
Standard integral drivers and remote driver options with 1% dimming



|           |  |       |      |
|-----------|--|-------|------|
| PROJECT:  |  | TYPE: |      |
| CATALOG#: |  | DATE: | QTY: |

| CAT. NO | LUMEN OUTPUT  | CRI           | COLOR TEMP   | BEAM ANGLE                          | VOLTAGE   |
|---------|---|---------------|--|-------------------------------------|---|
| 3G-RMZ4 | 04 - 400 LUMENS<br>08 - 800 LUMENS<br><br><small>Lumen output based on 35K.<br/>See performance chart for additional info</small> | H90 - 90+ CRI | 27K - 2700K<br>30K - 3000K<br>35K - 3500K<br>40K - 4000K | 15D - 15°<br>35D - 35°<br>55D - 55° | UNV - 120/277V<br>120 - 120V<br>347 - 347V <sup>1</sup> |

| DRIVER   | FLANGE TYPE   | LOUVER FINISH              | HOUSING TYPE   |
|--|---|----------------------------|--|
| DIM - 0-10V (100-1%)<br>LE - PHASE DIM (TRIAC/ELV, 100-1%) <sup>2</sup><br>RDIM - REMOTE 0-10V (100-1%)<br>RD01 - REMOTE 0-10V (100-0.1%)<br>RDALI - REMOTE DALI (100-1%) <sup>3</sup><br>RDHLP - REMOTE LUTRON HI-LUME (1% ECOSYSTEM)<br>RD347 - 347V REMOTE 0-10V (100-1%) | WT - WHITE TRIM<br>BT - BLACK TRIM<br>XTR - TRIMLESS (MUD-IN DRYWALL) | WLV - WHITE<br>BLV - BLACK | SH - SHALLOW HOUSING (INTEGRAL DRIVER)<br>SHRM - SHALLOW HOUSING & REMOTE DRIVER OPTION<br>RMD - REMODEL FIXTURE W/ENCLOSURE (INTEGRAL DRIVER)<br>RMDRM - REMODEL FIXTURE & REMOTE DRIVER OPTION<br><br><small>Shallow Housing is IC Rated</small> |

| OPTIONS             |
|---------------------|
| CP - CHICAGO PLENUM |

<sup>1</sup> 347 available in "DIM" 0-10V only (100-1%)

<sup>2</sup> Remote Forward Phase driver available in 120V only

<sup>3</sup> DALI-2 (Type 6) provided as standard. Please consult factory for DALI (Type 8) options

BASED ON 35°, 90+ CRI AND 3500K SOURCE

| LUMEN OUTPUT    | COLOR TEMP | DELIVERED LUMENS | SYSTEM WATTS | EFFICACY (LPW) |
|-----------------|------------|------------------|--------------|----------------|
| 08 - 800 LUMENS | 27K        | 684              | 9.6          | 71             |
|                 | 30K        | 745              | 9.6          | 78             |
|                 | 35K        | 822              | 9.6          | 86             |

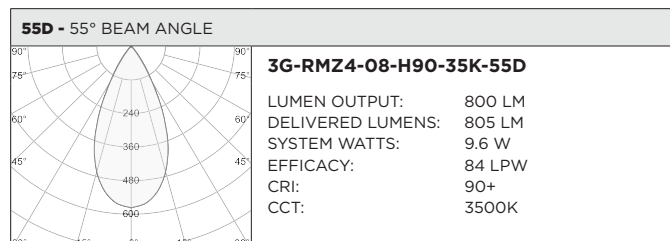
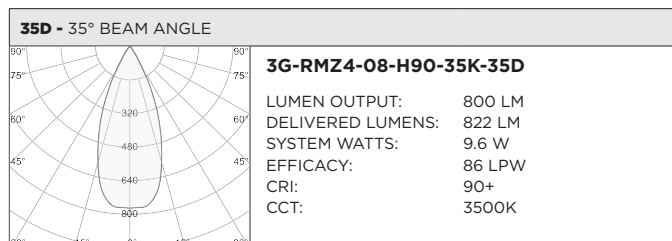

#### REMOTE POWER SUPPLY OPTIONS

| 3G DRIVER CODE | DIMMING METHOD           | DIMMING RANGE | VOLTAGE  | MAX. DISTANCE | 3G-RMZ1 (2.4W) | 3G-RMZ2 (4.8W) | 3G-RMZ4 (9.6W) | 3G-RMZ8 (19.2W) | 3G-RMZ12 (28.5W) |
|----------------|--------------------------|---------------|----------|---------------|----------------|----------------|----------------|-----------------|------------------|
| RDIM           | 0-10V                    | 100-1%        | 120-277V | 100ft (12AWG) | 4 to 16        | 2 to 8         | <b>1 to 4</b>  | 1 to 2          | 1                |
| RD347          | 0-10V                    | 100-1%        | 347V     | 100ft (12AWG) | 3 to 16        | 2 to 8         | <b>1 to 4</b>  | 1 to 2          | 1                |
| RDHLP          | LUTRON HI-LUME ECOSYSTEM | 100-0.1%      | 120-277V | 100ft (12AWG) | 5 to 16        | 3 to 8         | <b>2 to 4</b>  | 1 to 2          | 1                |
| RDALI          | DALI ELDOLED             | 100-1%        | 120-277V | 100ft (12AWG) | 1 to 16        | 1 to 8         | <b>1 to 4</b>  | 1 to 2          | 1                |
| RDO1           | 0-10V ELDOLED            | 100-0.1%      | 120-277V | 100ft (12AWG) | 1 to 16        | 1 to 8         | <b>1 to 4</b>  | 1 to 2          | 1                |

#### REMOTE POWER SUPPLY ENCLOSURE

#### WIRING DIAGRAM

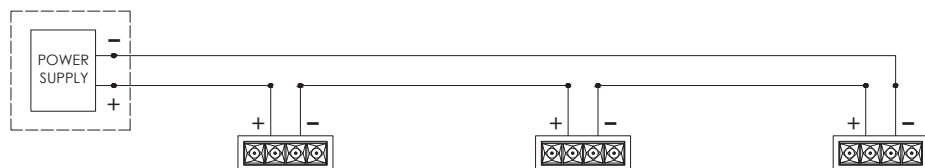
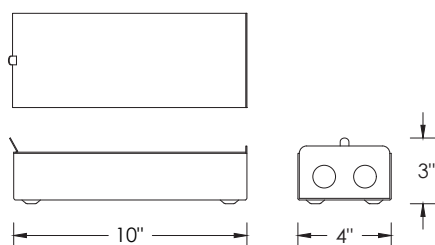

Multiple Zoie fixtures must be connected in series

## HOUSING

IC rated shallow housing and Chicago Plenum housing options available  
Remodel housing available with remote drivers  
Maximum ceiling thickness of 1". Consult factory for modifications  
Housings are rated for #12 AWG, (4 in, 4 out), 90°C conductors and through branch wiring

## FACETED LOUVER

1.14" aperture with regressed LED source for enhanced glare control  
Matte black or matte white faceted louver finish

## TRIM

Cast aluminum trim flange with powder coated finish and minimal 0.300" overlap

## TRIMLESS

Mudding flange features a perforated surface for easy mud-in application

## OPTICS

Proprietary polycarbonate multi-faceted reflectors  
Available in 15°, 35°, and 55°. UGR <16

## LISTING

ETL listed and conforms to UL1598 standard. Certified to CSA22.2 No.250.0. Rated for indoor locations

## ELECTRICAL

Remote 0-10V, driver option (100-1% dimming standard with 100-0.1% option)  
Remote Lutron EcoSystem and eidoLED DALI options (100-1% dimming)  
Remote 120V Forward Phase driver option with 100-1% dimming

## LED SYSTEM

Osram LED source  
Color consistency <2 SDCM  
Standard 90+ CRI  
Available in 27K, 30K, and 35K  
L90 >60,000 hours  
5 year warranty

## MOUNTING

Trim fixture designed for use in drywall, wood, acoustic ceiling tiles, and other ceiling materials  
Trimless fixture designed for use in drywall, mud-in ceiling applications  
Recommended ceiling cut-out for remodel fixture: 1.500" x 4.565"  
Adjustable bar hangers extend from 14" to 26"

## WARRANTY

5 year warranty on LED and drivers  
Manufacturer 1 year warranty for defects in material and workmanship under normal use  
Ambient temperature at fixture should not exceed 25°C

**RMD - REMODEL FIXTURE (NON-IC) WITH ENCLOSURE (INTEGRAL DRIVER)**  
SUITABLE FOR 0-10V, PHASE DIMMING, AND LUTRON HI-LUME PREMIER

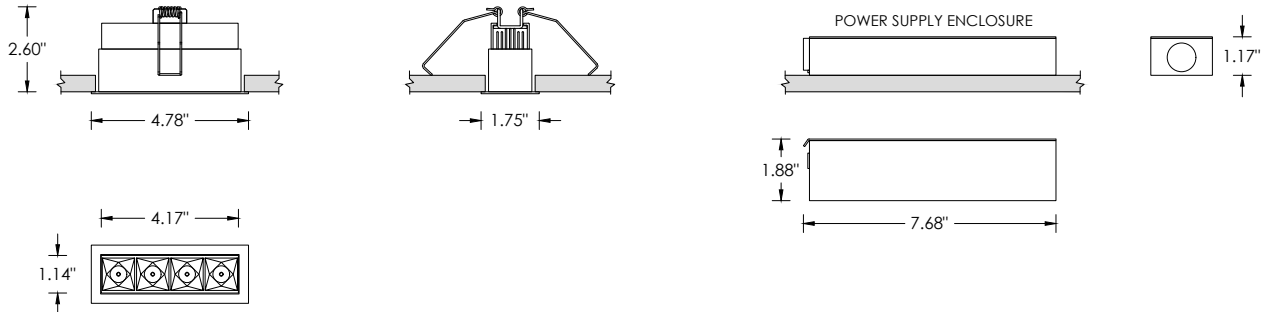

Recommended ceiling cut-out: 1.500" x 4.565"

**SH - SHALLOW HOUSING (INTEGRAL DRIVER) (IC RATED AND CHICAGO PLENUM RATED)**

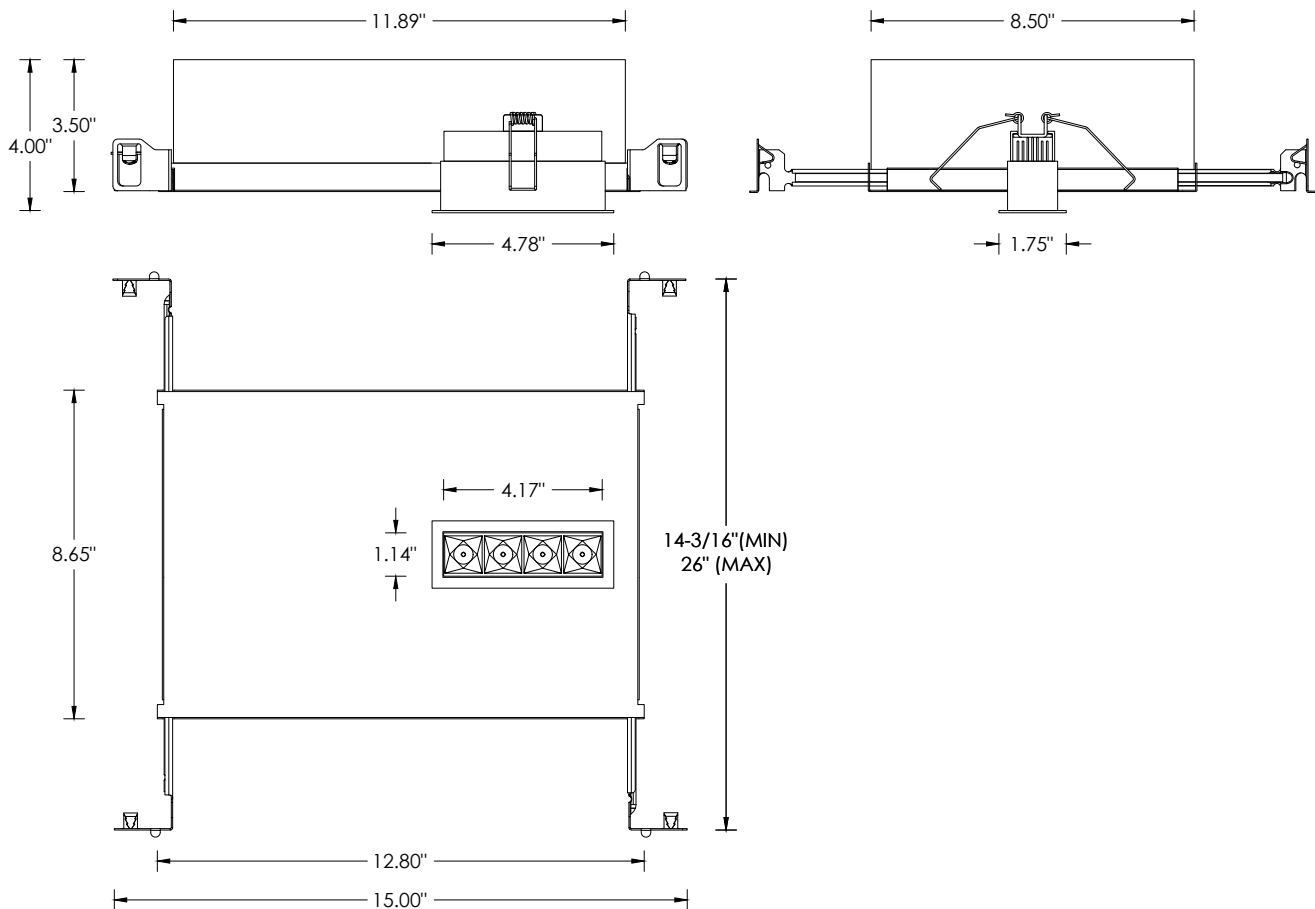

**RMDRM - REMODEL FIXTURE (NON-IC) AND REMOTE DRIVER OPTION**

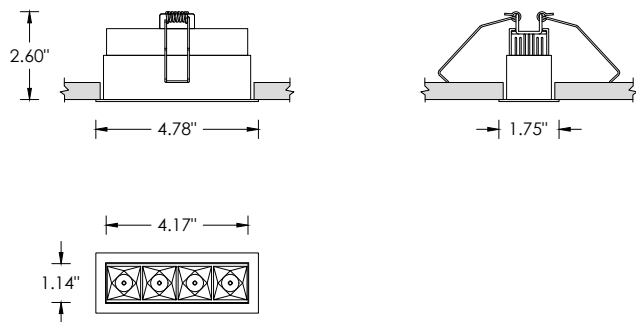

Recommended ceiling cut-out: 1.500" x 4.565"

**SHRM - SHALLOW HOUSING & REMOTE DRIVER OPTION (IC RATED AND CHICAGO PLENUM RATED)**

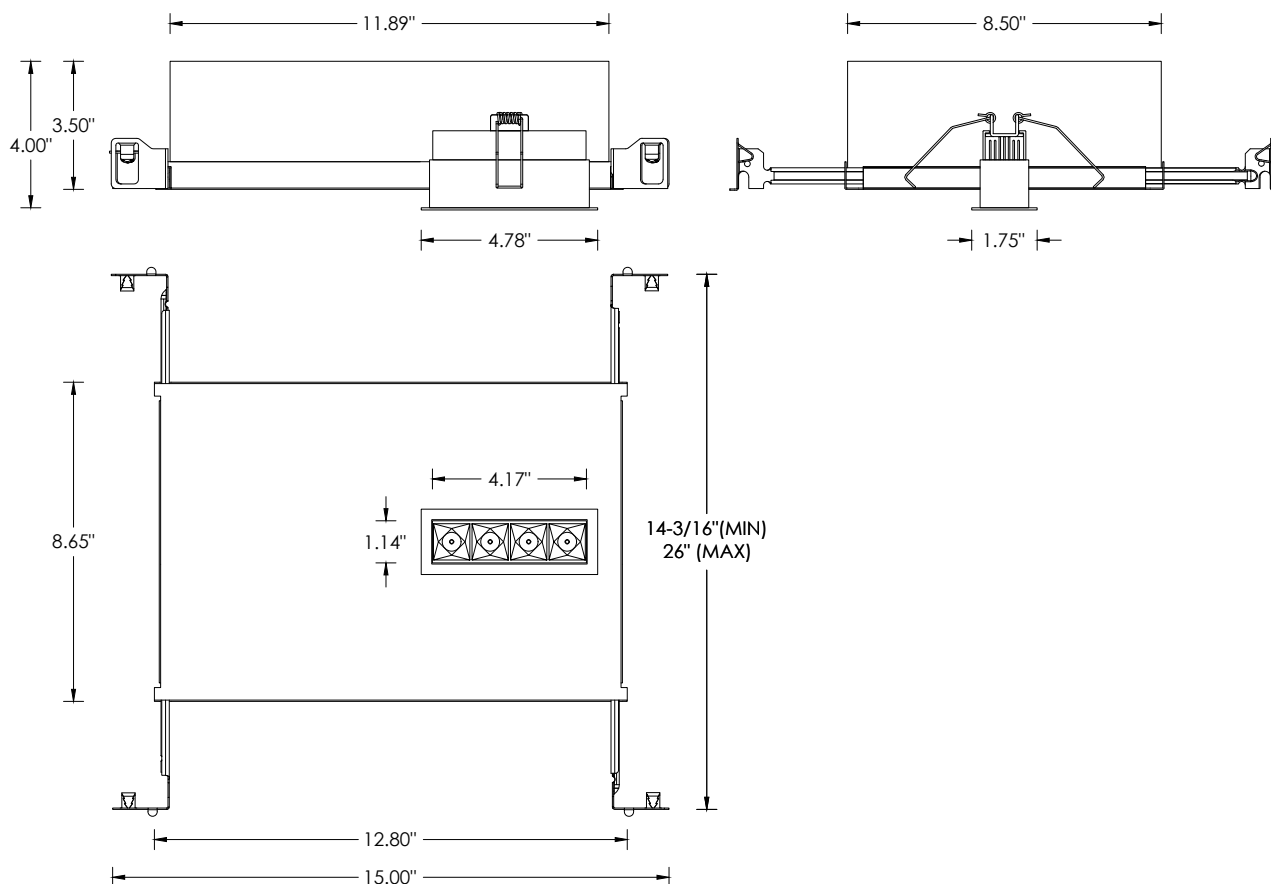



**RMDRM - REMODEL FIXTURE (NON-IC) AND REMOTE DRIVER OPTION**

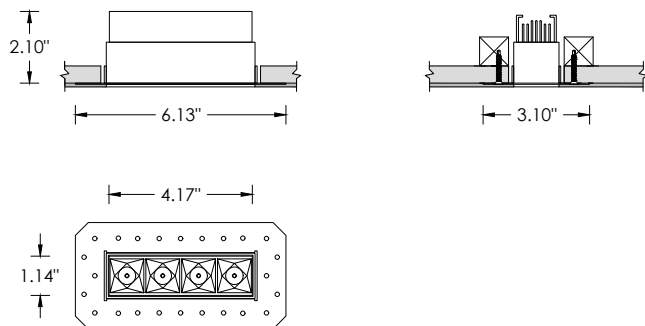

Recommended ceiling cut-out: 1.500" x 4.565"

**SHRM - SHALLOW HOUSING & REMOTE DRIVER OPTION (IC RATED AND CHICAGO PLENUM RATED)**

